

Network-Ready Vision System Series

F210ETN / F500ETN

*Ultimate Power - High Resolution (F500)
Network-Ready Vision System*

- Two digital camera ports, high resolution (1K x 1K) with F500ETN
- Advanced real time data logging and storage functions
- 10/100 Base TX Ethernet Port, USB, RS232/422, 33 digital I/O
- Optional VisionComposerNET for remote configuration/maintenance
- Security tools, audit trail creation in security sensitive environment



Ordering information

| Name | | Model | Remarks |
|-----------------------|---------------------|--------------|---|
| Controller | Standard Resolution | F210-C10-ETN | NPN Input / Output |
| | | F210-C15-ETN | PNP Input / Output |
| | High Resolution | F500-C10-ETN | NPN Input / Output |
| | | F500-C15-ETN | PNP Input / Output |
| Camera | 250 K Pixel | F210-S1 | For F210ETN only |
| | 1 M Pixel | F500-S1 | For F500ETN only |
| Monitor | | F150-M05L | 5.5" color TFT LCD |
| | | F500-M10L | 10.4" color TFT LCD |
| Console | | F150-KP | Standard Console |
| | | F-160-KP | Console with additional function keys |
| Memory Cards | | F160-N64S(S) | Memory capacity 64 MB |
| | | F160-N256S | Memory capacity 256 MB |
| PC-Software | | F500-CD3E | Optional remote configuration software (via ETN) |
| Application Software | | F500-UM3ME | With macro function |
| | | F500-UM3FE | Without macro function |
| High precision Lenses | | F500-LE16 | focal length 16 mm |
| | | F500-LE25 | focal length 25 mm |
| | | F500-LE50 | focal length 50 mm |
| Camera cable | | F500-VS2 | Available lenght 2 m, 5 m, 10 m |
| Monitor cable | | F500-VM | Cable length 2 m |
| Parallel cable | | F160-VP | Loose-wire cable for parallel I/O connectors. Cable length 2 m |

Specifications

Controller

| Model | F210-C10-ETN / F210-C15-ETN | F500-C10-ETN / F500-C15-ETN |
|----------------------------|---|---|
| Connected Camera | F210-S1 | F500-S1 |
| No. of connectable Cameras | 2 | 2 |
| Processing resolution | 512x484 (HxV) | 1024x1024 (HxV) |
| No. of scenes | 32 (Can be increased using Memory Cards.) | 32 (Can be increased using Memory Cards.) |
| Image memory function | 35 images max. | 35 images max. |
| Storage | 64 MB non-volatile memory | 256 MB non-volatile memory |
| Operation and settings | Measurement items installed using Applications Software. Menu operations used to combine measurement items. Vision Composer Net can be used for operation and settings. | Measurement items installed using Applications Software. Menu operations used to combine measurement items. Vision Composer Net can be used for operation and settings. |
| Menu language | Japanese or English (switchable) | Japanese or English (switchable) |
| Serial communications | USB series B: 1 channel RS-232C/422: 1 channel | USB series B: 1 channel RS-232C/422: 1 channel |
| Network communications | Ethernet 100Base-TX/10Base-T | Ethernet 100Base-TX/10Base-T |
| Parallel I/O | 11 inputs, 22 outputs | 11 inputs, 22 outputs |
| Monitor interface | Composite video output: 1 channel, S-VIDEO output: 1 channel | Composite video output: 1 channel, S-VIDEO output: 1 channel |
| Memory Card interface | Compact Flash card slot, 1 channel | Compact Flash card slot, 1 channel |
| Power supply voltage | 20.4 to 26.4 VDC | 20.4 to 26.4 VDC |
| Current consumption | 2.1 A max. (with two F210-S1 Cameras connected) | 2.1 A max. (with two F500-S1 Cameras connected) |
| Ambient temperature | Operating: 0 to +50 °C Storage: -25 to +65 °C with no icing or condensation | Operating: 0 to +50 °C Storage: -25 to +65 °C with no icing or condensation |
| Ambient humidity | Operating/storage: 35% to 85% with no condensation | Operating/storage: 35% to 85% with no condensation |
| Dimensions | 100x198x134 mm (WxHxD) (without connectors and other protrusions) | 100x198x134 mm (WxHxD) (without connectors and other protrusions) |
| Weight | Approx. 1.6 kg (Controller only) | Approx. 1.6 kg (Controller only) |
| Accessories | Ferrite core for Console (1) Setup Manual | Ferrite core for Console (1) Setup Manual |

Digital Interface Cameras

| Model | F210-S1 | F500-S1 |
|--------------------------|--|---|
| Imaging device | 1/3-inch CCD | 2/3-inch CCD |
| Pixel size | 7.4x7.4 μm (HxW) | 6.45x6.45μm (HxW) |
| Shutter | Electronic shutter, 8 shutter speeds (1/60 to 1/12,000 s), changed via menu | Electronic shutter, 10 shutter speeds (1/24 to 1/10,000 s), changed via menu |
| Partial function | Seven settings | Four settings |
| Communications interface | Conforms to Camera Link | Conforms to Camera Link |
| Ambient temperature | Operating: 0 to +50 °C Storage: -25 to +60 °C with no icing or condensation | Operating: 0 to +50 °C Storage: -25 to +60 °C with no icing or condensation |
| Ambient humidity | Operating/storage: 35% to 85% with no condensation | Operating /storage: 35% to 85% with no condensation |
| Dimensions | 43x43x49 mm (WxHxD) (without connectors and other protrusions) | 50x40x90 mm (WxHxD) (without connectors and other protrusions) |
| Weight | Approx. 110 g | Approx. 270 g |
| Accessories | Instruction Manual | Instruction Manual |

















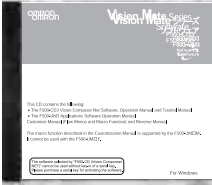

Monitor

| Model | F500-M10L |
|----------------------|--|
| Size in inches | 10.4 inches |
| Type | LCD TFT |
| Resolution | 640 x 480 |
| Brightness | 350 cdm/m (typical) |
| Input signal | NTSC composite video (1.0 V / 75 Ω termination), S-VIDEO |
| Power supply voltage | 20.4 to 26.4 VDC |
| Current consumption | 1.0 A max. |
| Ambient temperature | Operating: 0 to +50 °C Storage: -20 to +65 °C with no icing or condensation |
| Ambient humidity | Operating/storage: 30% to 80% with no condensation |
| Dimensions | 285x225x49 mm (WxHxD) |
| Weight | Approx. 1.8 kg |
| Accessories | Instruction Manual, 4 mounting brackets |

System Requirements for F500-CD3E Vision Composer Net

| | | |
|---------------|--|---|
| CPU | Pentium III 600 MHz min. (Pentium III 1 GHz min. recommended) | |
| OS | Windows 2000 Professional, Service Pack 4 or higher Windows XP Home Edition, Service Pack 2 or higher Windows XP Professional, Service Pack 2 or higher | |
| Memory | 192 MB min. (256 MB min. recommended) | |
| Hard disk | 300 MB min. available space | |
| Monitor | Resolution: 1,024 x 768 min. Display colors: High Color (16-bit) min. (True Color (32-bit) min. recommended) | |
| Network | 10BaseT-compliant network (100Base-TX recommended) | |
| Vision Sensor | Controller | F210-C10-ETN/F210-C15-ETN, F500-C10-ETN / F500-C15-ETN |
| | Application software | F500-UM Version 3.00 or later |

System Configuration

| | | |
|---|--|---|
| <p>CCTV Lenses*2</p>  <p>3Z4S-LE C1614A</p>  <p>3Z4S-LE B2514D</p>  <p>3Z4S-LE B5014A</p> | <p>Controllers</p>  <p>F210-C10-ETN (NPN) F210-C15-ETN (PNP)</p>  <p>F500-C10-ETN (NPN) F500-C15-ETN (PNP)</p> | <p>Application Software</p>  <p>F500-UM 3FE</p>  <p>F500-UM 3MI</p> <p>F500-UM3ME/3FE</p> <p>PC Support Software*1</p>  <p>F500-CD3E</p> |
| <p>High-precision Lenses</p>  <p>F500-LE16</p>  <p>F500-LE25</p>  <p>F500-LE50</p> | <p>Monitors</p>  <p>F500-M10L</p>  <p>F150-M05L</p> | <p>Consoles</p>  <p>F150-KP</p>  <p>F160-KP</p> |
| <p>Digital Interface Cameras</p>  <p>F210-S1</p>  <p>F500-S1</p> | | <p>Camera Cables*3</p> <p>F500-VS2 2M</p>  <p>Monitor Cable</p> <p>F150-VM 2M</p>  |

*1 Vision Composer Net and Vision Composer Watcher are bundled with personal computer software.
 *2 A variety of CCTV Lenses are available in addition to those shown above.
 *3 In addition to the standard 2-meter cable length, 5- and 10-meter lengths are available.

Software

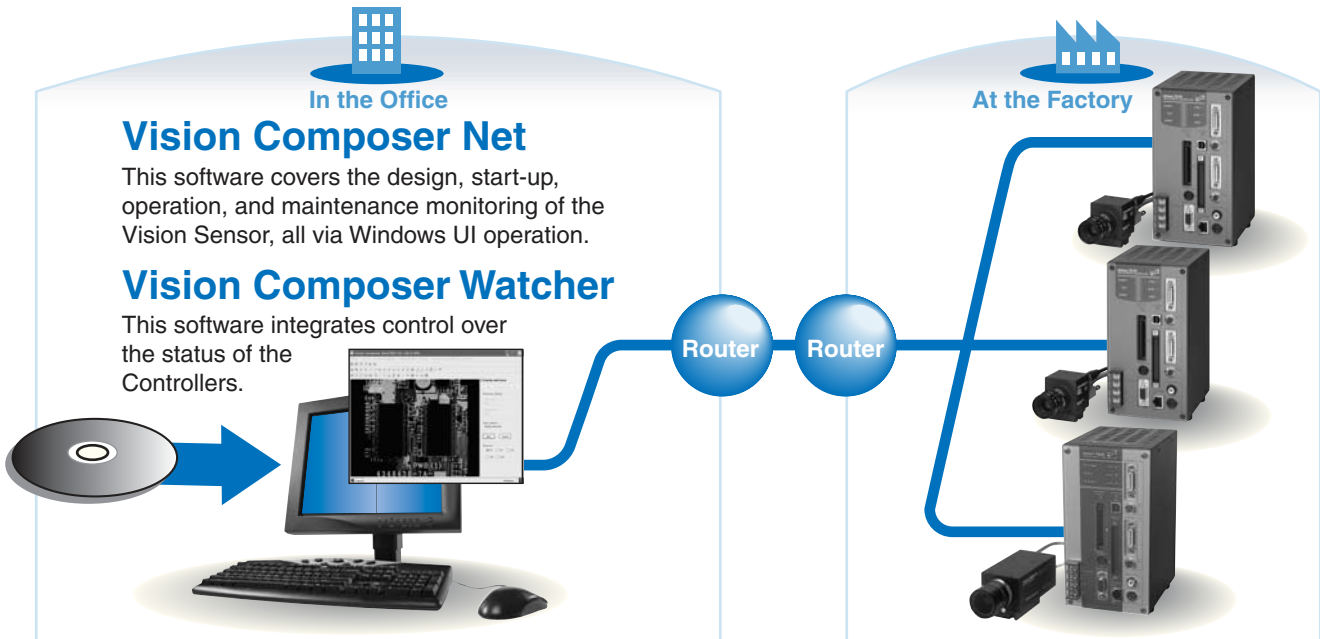

Vision Composer Net

Security Function

The security function allows you to classify the operations of registered users into three ranks (Administrator, Supervisor, or Operator) depending on their access privileges.

| | |
|----------------------|--|
| Administrator | Change system data Register users Add access privileges |
| Supervisor | Add model data Re-register models Change inspection items |
| Operator | Change criteria Change display screens Adjust inspection regions |

Screen Captures

Previously, images were stored via a Compact Flash Card inserted into the Controller. It is now possible to capture network-transferred live images on a personal computer at any desired point in time.

Capture on personal computer

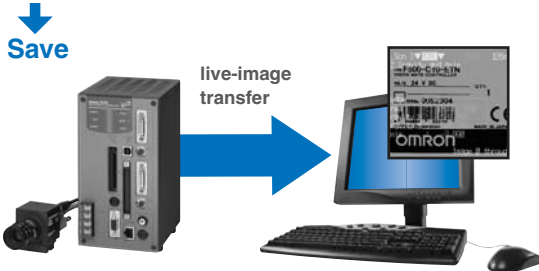

Recording

Live images sent by the Controller can be recorded by a personal computer using the AVI format. Effective for trend control.

Recorded by personal computer

Saved in AVI format

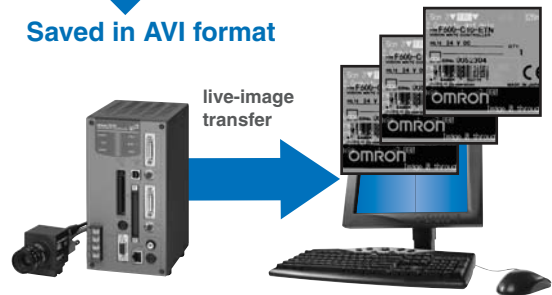

Logging

This function lets you accumulate a variety of production data, including images, measurement values, time stamps, production quantity, and defect rates. The macro function in the Controller then makes it possible to process this into the form of data that you need.

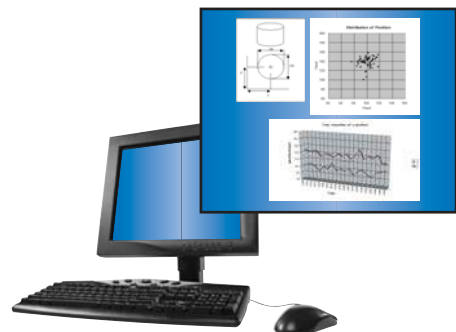

Dimensions

Controller

F210-C10-ETN / F210-C15-ETN
 F500-C10-ETN / F500-C15-ETN

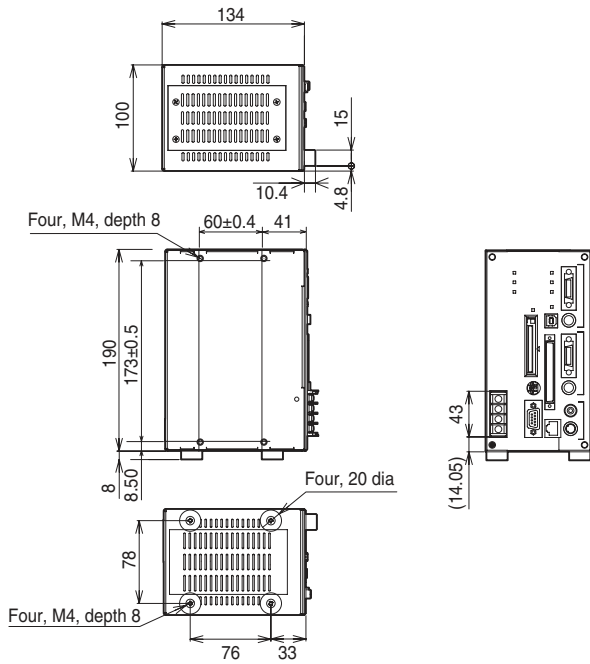

Cameras

F210-S1

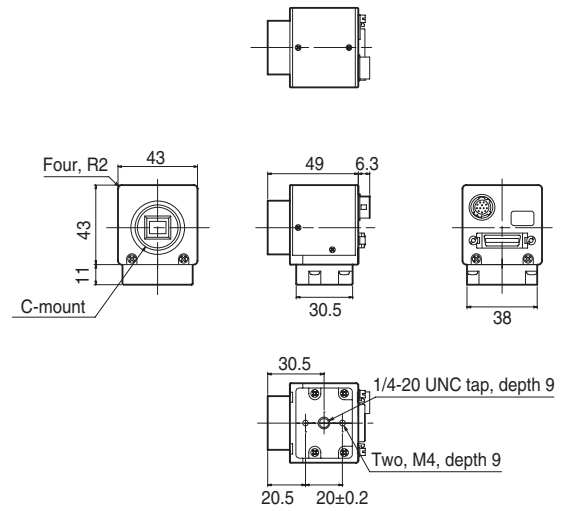

F500-S1

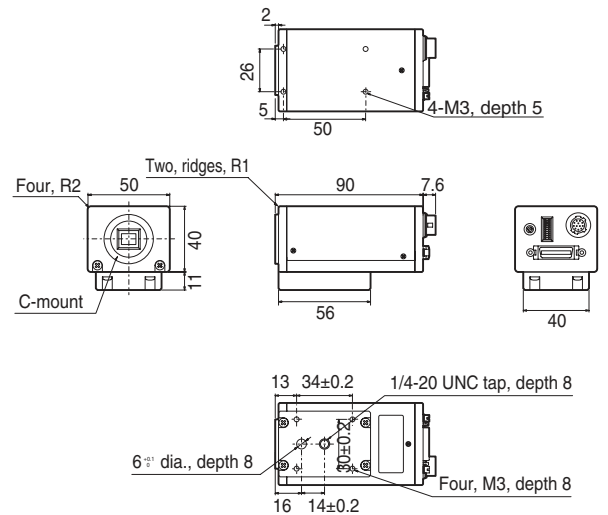

Cat. No. Q143-E2-01-X

In the interest of product improvement, specifications are subject to change without notice.

OMRON EUROPE B.V.

Wegalaan 67-69,
NL-2132 JD, Hoofddorp,
The Netherlands
Phone: +31 23 568 13 00
Fax: +31 23 568 13 88
www.eu.omron.com
