

REVISIONS				
REV.	ECO. NO	DESCRIPTION	DATE	BY
A	2398	INITIAL RELEASE	07/01/2011	LH
B	2477	REMOVE DIM 1.10mm FROM FRONT VIEW ON PAGE 1, CLARIFY RS DIM 1.00mm ON RIGHT VIEW ON PAGE1	12/12/2011	LH
C	2576	UPDATE PART NUMBER CODING	05/10/2012	LH

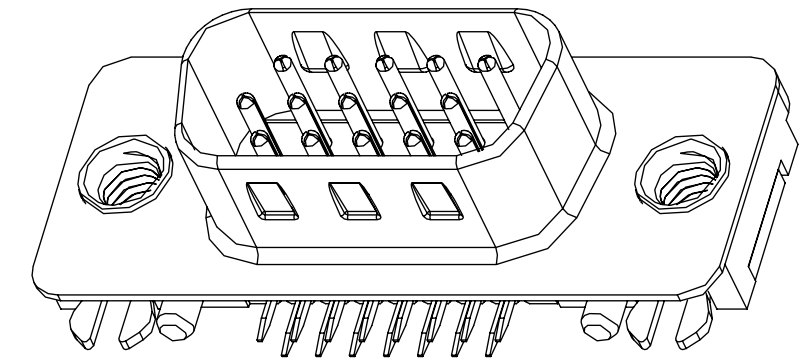

(PN EXAMPLE: SDS224-PRW2-M15-SN13-2)

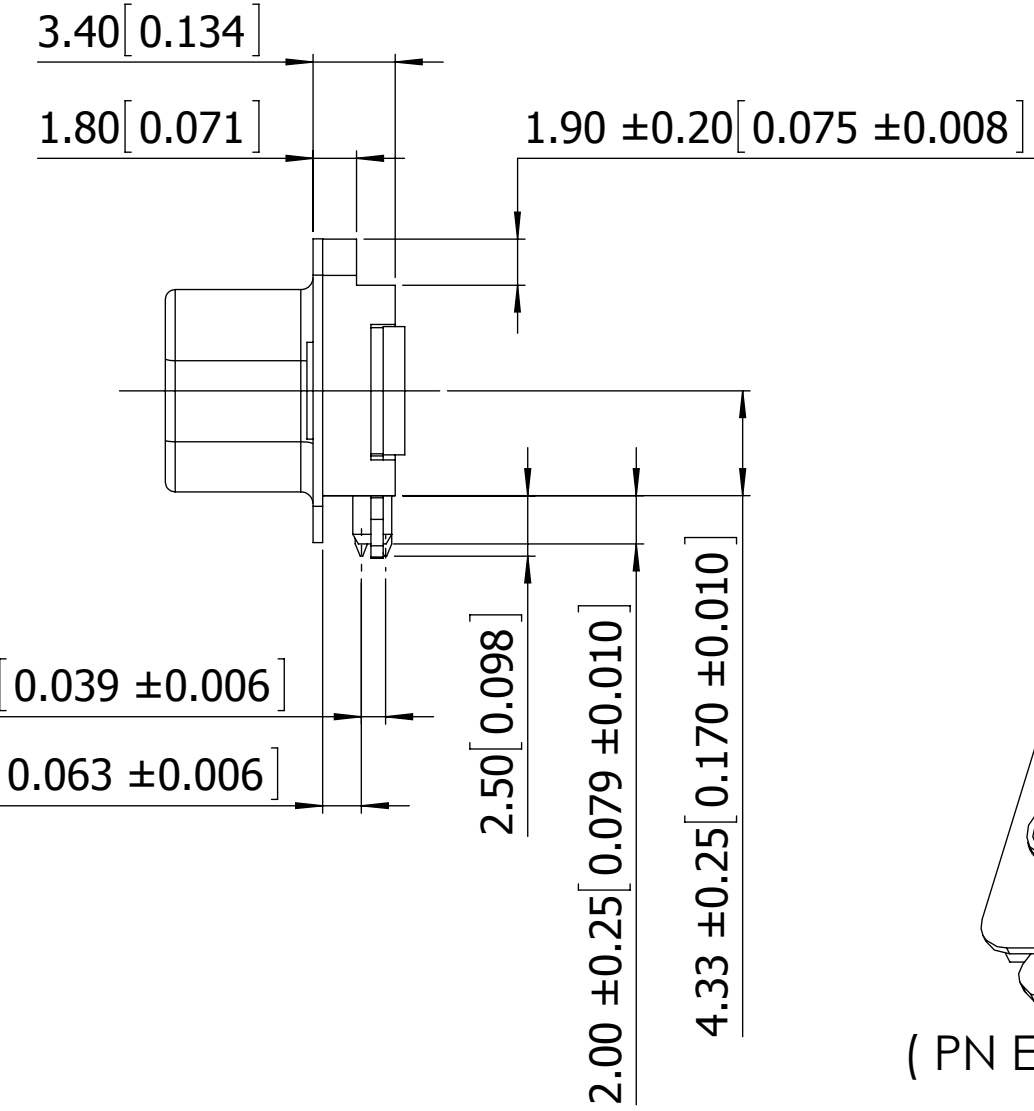
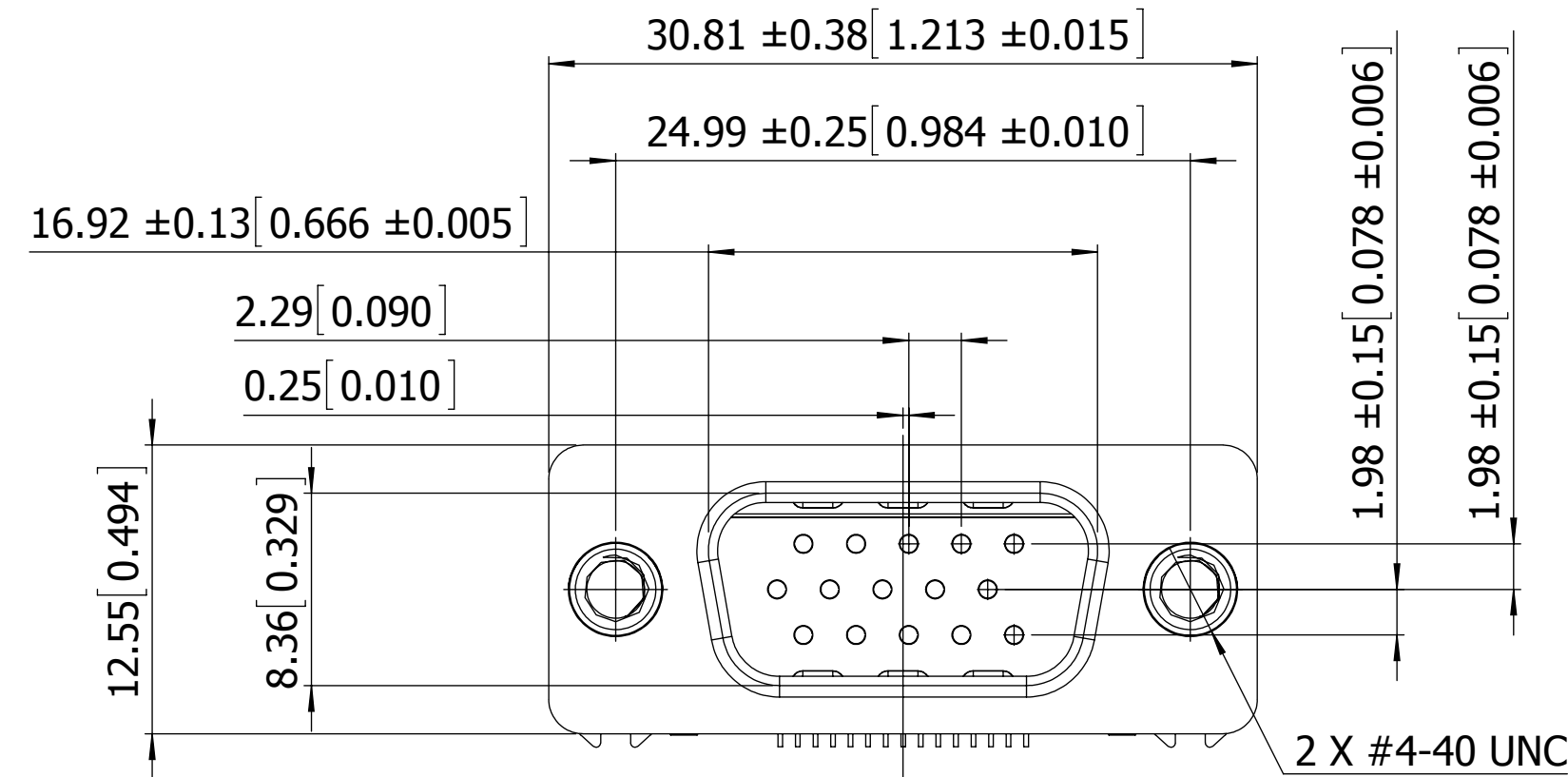
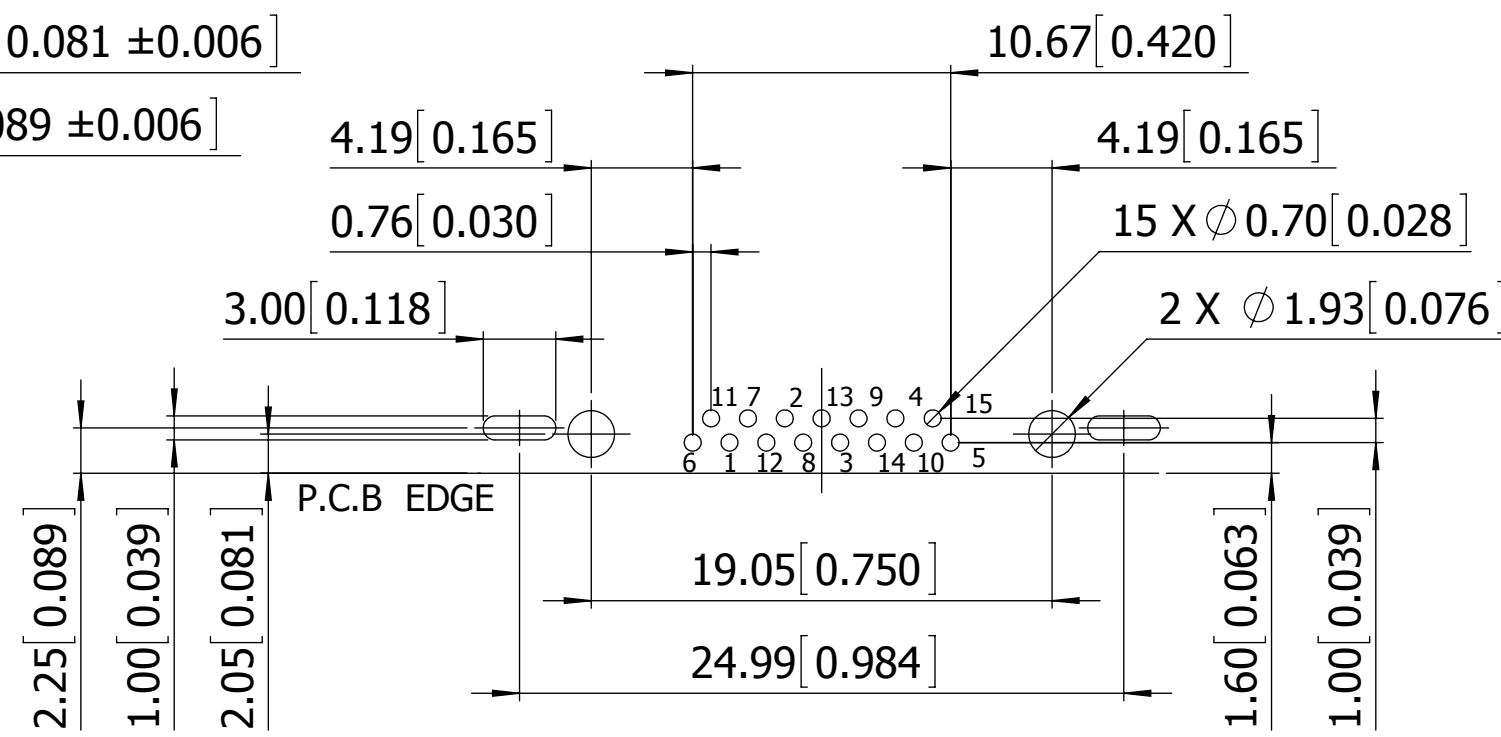
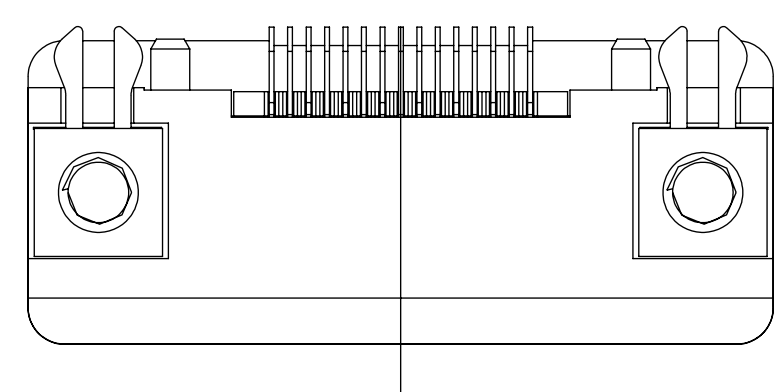
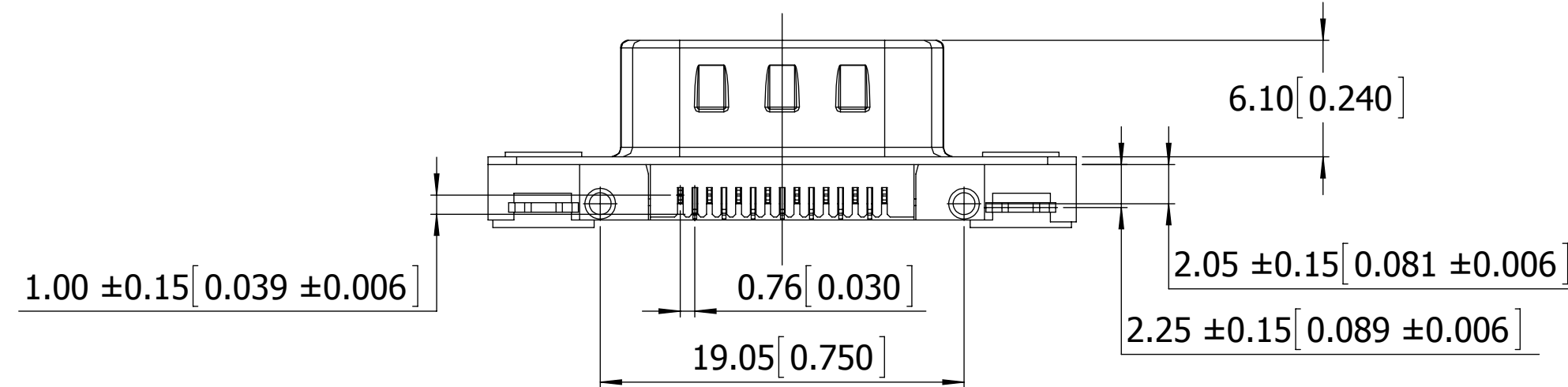

RECOMMENDED PCB LAYOUT

NOTES:
MATERIAL
 INSULATOR : GLASS-FILLED THERMOPLASTIC PBT, UL94V-0
 CONTACT: BRASS
 SHELL : SPCC, .000100" TIN OVER .000050" MIN. COPPER (STANDARD , SEE PAGE 3)
 CLINCH NUT : BRASS, NICKEL PLATED
 BOARDLOCK : BRASS, TIN PLATED
 SCREWLOCK : STEEL, NICKEL PLATED
 OPERATING TEMPERATURE : -55°C TO +105°C

ELECTRICAL
 CONTACT RESISTANCE : 20 MILLIOHMS MAX AT 1 AMP DC
 INSULATION RESISTANCE : 1000 MAGOHMS AT 500 VDC
 DIELECTRIC WITHSTANDING VOLTAGE : 1000 VAC/RMS 60Hz FOR 1 MINUTE
 CURRENT RATING : 3 AMPS
 VOLATGE RATING : 250 VAC/RMS 60Hz



UNLESS OTHERWISE SPECIFIED: DIMENSIONS ARE IN MM [INCHES]	DRAWN	DATE	NAME	
		07/01/2011	LH	
TOLERANCES: ANGULAR: ± 3° DECIMALS X.= ± 0.38 [015] X.= ± 0.25 [010] .XX= ± 0.13 [005]	<small>THE INFORMATION HEREIN CONTAINS PROPRIETARY INFORMATION OF SULLINS ELECTRONICS AND IS NOT TO BE REPRODUCED, USED OR DISCLOSED TO OTHERS FOR ANY PURPOSE EXCEPT AS SPECIFICALLY AUTHORIZED IN WRITING BY AN OFFICER OF SULLINS ELECTRONICS.</small>			TITLE
				224 SERIES D-SUB H.D. RIGHT ANGLE SLIM TYPE
PART NUMBER				SDS224-PRW _ _ 15-SN _ _ _
SIZE	CAGE CODE	DWG. NO.	REV	
C	54453	11804	C	
SCALE: 1:8			SHEET 1 OF 3	

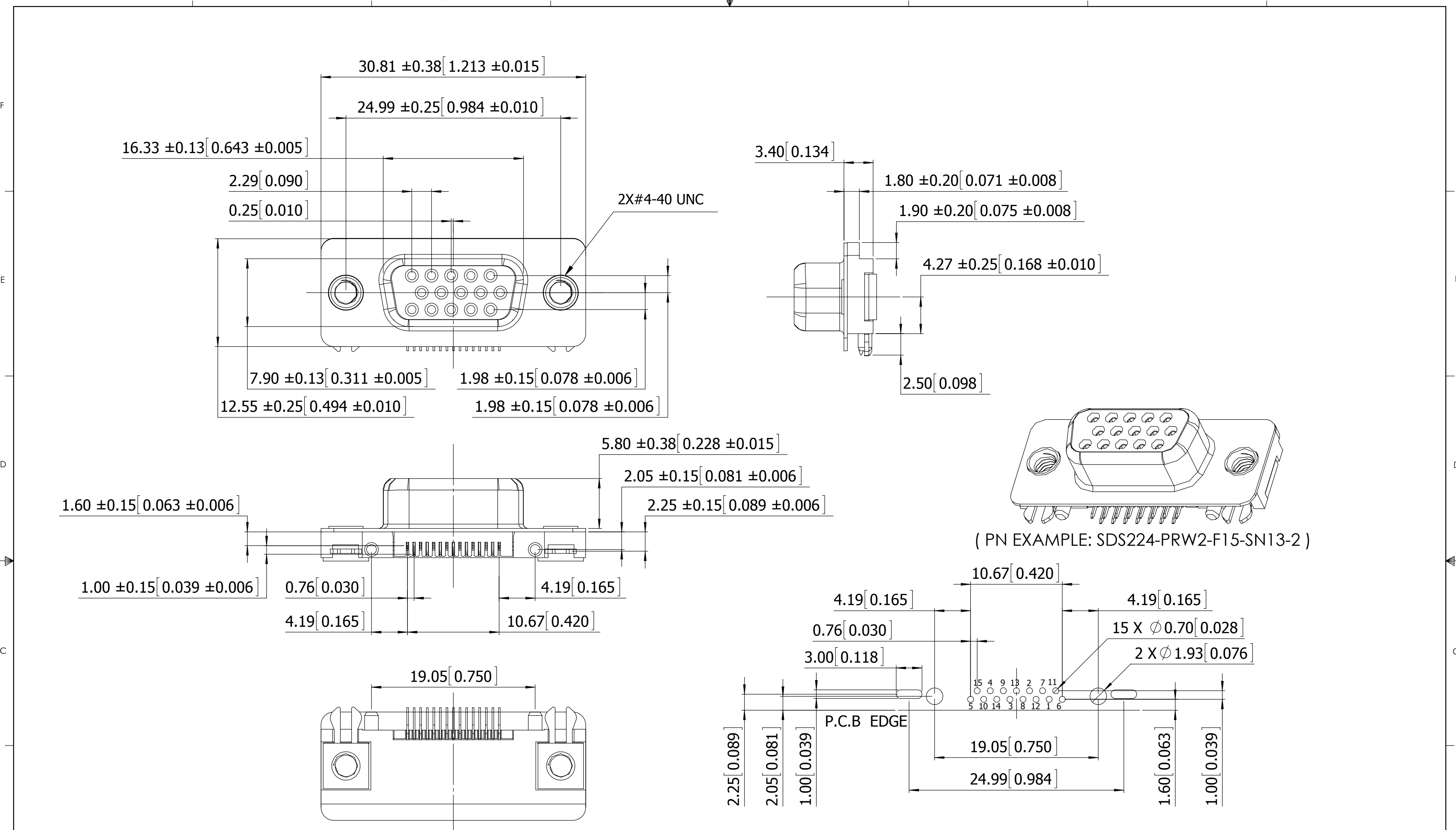

RECOMMENDED PCB LAYOUT



UNLESS OTHERWISE SPECIFIED: DIMENSIONS ARE IN MM [INCHES]		DRAWN	DATE	NAME	
TOLERANCES: ANGULAR: ± 3° DECIMALS X.= ± 0.38 [0.015] X.= ± 0.25 [0.010] .XX= ± 0.13 [0.005]			07/01/2011	LH	
<small>THE INFORMATION HEREIN CONTAINS PROPRIETARY INFORMATION OF SULLINS ELECTRONICS AND IS NOT TO BE REPRODUCED, USED OR DISCLOSED TO OTHERS FOR ANY PURPOSE EXCEPT AS SPECIFICALLY AUTHORIZED IN WRITING BY AN OFFICER OF SULLINS ELECTRONICS.</small>					TITLE 224 SERIES D-SUB H.D. RIGHT ANGLE SLIM TYPE PART NUMBER SDS224-PRW _ _ 15-SN _ _
SIZE	CAGE CODE	DWG. NO.	REV		
C	54453	11804	C		
SCALE: 1:8			SHEET 2 OF 3		

SDS224-PRW _ - _ 15 -S N _ - - _

a b c d e f g h i

a. CONTACT PLATING

W = .000050" NICKEL UNDERPLATE
 GOLD FLASH ON CONTACT SURFACE,
 .000100" PURE TIN ON TERMINATION.

b. SHELL PLATING

1 = NICKEL
 2 = TIN (STANDARD)

c. CONTACT TYPE

M = MALE
 F = FEMALE

d. NO. OF CONTACTS

15 = 15 POSITIONS

e. PIN TYPE

S = STAMPED PIN

f. FERRITE

N = WITHOUT FERRITE

g. FLANGE MOUNTING OPTION

0 = Ø3.05mm [Ø0.120] CLEARANCE HOLE
 1 = #4-40 FEMALE THREAD
 2 = #4-40 UNC (4.8 X 11.8 mm [0.19 X 0.46]) FEMALE SCREWLOCK INSTALLED
 3 = #4-40 UNC (4.8 X 11.8 mm [0.19 X 0.46]) FEMALE SCREWLOCK BULK-PACKED

h. RIVET OPTIONS

0 = NONE
 3 = GROUNDING HOOK BOARDLOCK+2 PRONG

i. INSULATOR COLOR

1 = BLACK
 2 = BLUE (STANDARD)

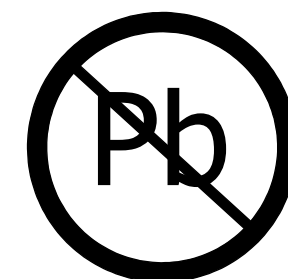

RoHS COMPLIANT

UNLESS OTHERWISE SPECIFIED: DIMENSIONS ARE IN MM [INCHES]		DRAWN	DATE	NAME			
			07/01/2011	LH			
TOLERANCES: ANGULAR: ± 3° DECIMALS X.= ± 0.38 [.015] X.= ± 0.25 [.010] .XX= ± 0.13 [.005]		THE INFORMATION HEREIN CONTAINS PROPRIETARY INFORMATION OF SULLINS ELECTRONICS AND IS NOT TO BE REPRODUCED, USED OR DISCLOSED TO OTHERS FOR ANY PURPOSE EXCEPT AS SPECIFICALLY AUTHORIZED IN WRITING BY AN OFFICER OF SULLINS ELECTRONICS.			TITLE 224 SERIES D-SUB H.D. RIGHT ANGLE SLIM TYPE		
		PART NUMBER SDS224-PRW _ - _ 15-SN _ - - _			SIZE	CAGE CODE	DWG. NO.
			C	54453	11804	C	
		SCALE: 1:8		SHEET 3 OF 3			