

**SCREW ON FEMALE RECEPTACLE**  
**HERMETIC-WITH CYLINDRICAL CONTACT**

**R125.609.001**

Series : SMA

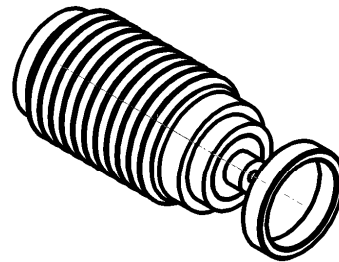
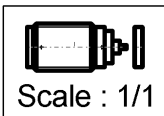
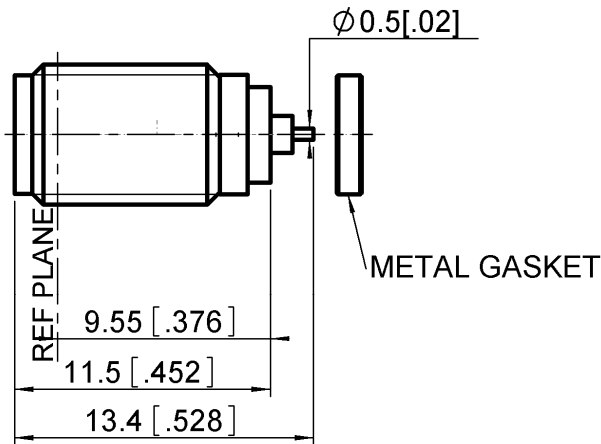

All dimensions are in mm.

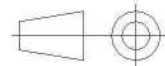

COMPONENTS	MATERIALS	PLATINGS ( $\mu\text{m}$ )
BODY	STAINLESS STEEL.	PASSIVATED.
CENTER CONTACT	BERYLLIUM COPPER	GOLD 1.3 OVER NICKEL2
OUTER CONTACT	-	-
INSULATOR	PTFE	
GASKET	ALUMINIUM ALLOY	
OTHERS PARTS	BERYLLIUM COPPER	GOLD 1.3 OVER NICKEL2
-	-	-
-	-	-

Issue : 1942 D

In the effort to improve our products, we reserve the right to make changes judged to be necessary.



**SCREW ON FEMALE RECEPTACLE**  
**HERMETIC-WITH CYLINDRICAL CONTACT**

**R125.609.001**

Series : SMA

**PACKAGING**

**SPECIFICATION**

Standard	Unit	Other
<b>1</b>	-	<b>Contact us</b>

**ELECTRICAL CHARACTERISTICS**

Impedance	<b>50</b>	$\Omega$
Frequency	<b>0-26.5</b>	GHz
VSWR	<b>1.10 + 0,0100</b>	x F(GHz) Maxi
Insertion loss	<b>0.3</b>	$\sqrt{F}(\text{GHz})$ dB Maxi
RF leakage	- ( <b>100</b> )	- F(GHz)) dB mini
Voltage rating	<b>500</b>	Veff Maxi
Dielectric withstanding voltage	<b>1000</b>	Veff mini
Insulation resistance	<b>5000</b>	M $\Omega$ mini

**ENVIRONMENTAL**

Operating temperature	<b>-65/+165</b>	$^{\circ}\text{C}$
Hermetic seal	<b>10-5</b>	Atm.cm <sup>3</sup> /s
Panel leakage	<b>IP68</b>	

**OTHERS CHARACTERISTICS**

Assembly instruction

Others :  
 Coaxial Transmission Line Only

**MECHANICAL CHARACTERISTICS**

Center contact retention		
Axial force – Mating end	<b>27</b>	N mini
Axial force – Opposite end	<b>27</b>	N mini
Torque	<b>2.8</b>	N.cm mini
Recommended torque		
Mating	<b>NA</b>	N.cm
Panel nut	<b>280</b>	N.cm
Mating life	<b>500</b>	Cycles mini
Weight	<b>2,0000</b>	g

Issue : 1942 D

In the effort to improve our products, we reserve the right to make changes judged to be necessary.



**SCREW ON FEMALE RECEPTACLE**  
**HERMETIC-WITH CYLINDRICAL CONTACT**

**R125.609.001**

Series : SMA

PANEL DRILLING

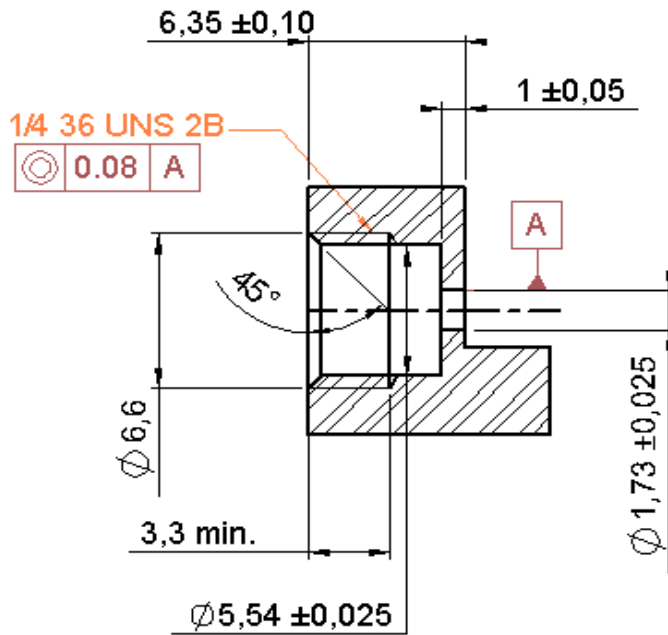

RECOMMENDED MOUNTING HOLE DETAIL

Panel deformation less than 25µ

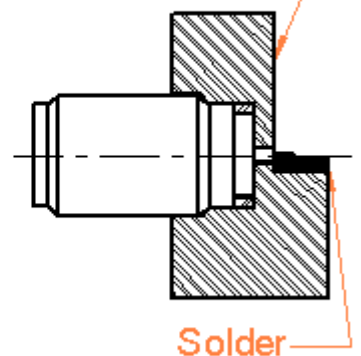

Assemble metal gasket onto connector.  
 Screw both parts into the housing.  
 Tighten the connector up to 280Ncm +or-  
 10Ncm (use special tooling set RADIALL  
 R282 341 012).  
 Thus the connection hermeticity is  
 guaranteed at  $1 \cdot 10^{-5}$ atm. cm<sup>3</sup>/s.  
 Then solder the pin on the track.  
 Be careful not to put too much solder.

Issue : 1942 D

In the effort to improve our products, we reserve the right to make changes judged to be necessary.

