

LOC	DIST	REVISIONS				
P	LTR	DESCRIPTION	DATE	DWN	APVD	
	E	UPDATED PART REVISION	12AUG2014	KR	JC	
	F	UPDATED PART REVISION	18AUG2014	KR	JC	
	G	UPDATED DRAWING	19FEB2015	KR	MZ	
	H	ECR-15-009919 AND ECR-15-010559	16JUL2015	RS	JL	

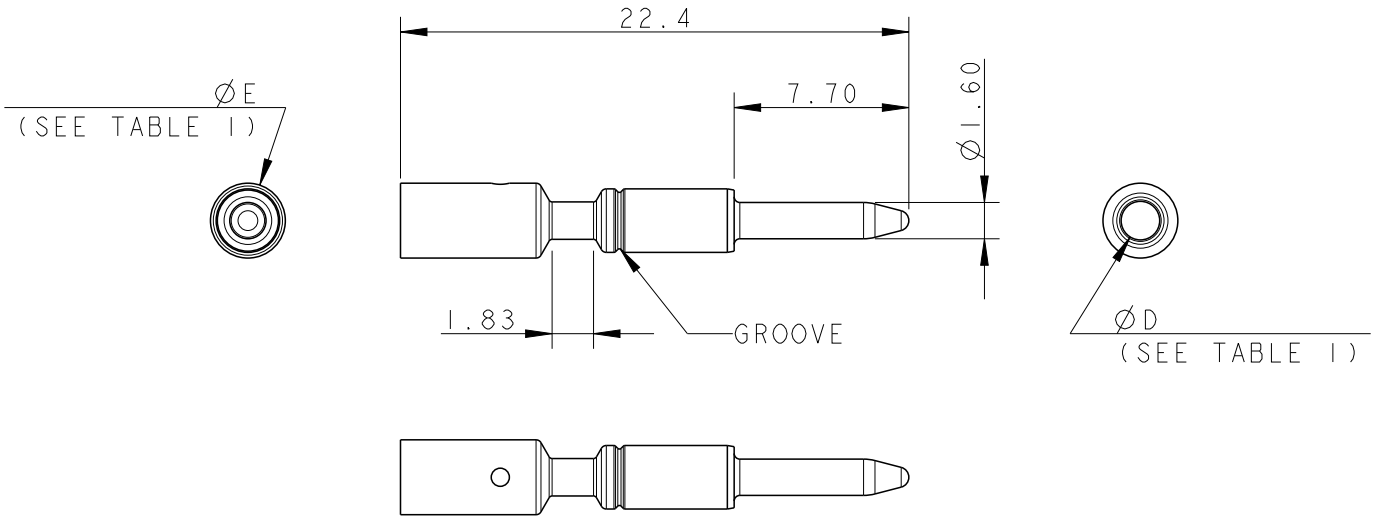

NOTES:

1) PACKAGING: SEE TE PACKAGING SPEC. 107-20294

2) PART NOT YET RELEASED FOR PRODUCTION

		2-293476-2
		1-293476-2
		293476-2
ADDITIONAL VIEWS, FOR REFERENCE	3D VIEWS FOR REFERENCE	PART NUMBER

NOTE	CROSS SECTION (sqmm)	DIMENSION "E"	DIMENSION "D"	NO. OF GROOVES	NET WEIGHT (g)	DESCRIPTION	PART NUMBER
2	4.0	3.9	2.8	0	~0.8	MACHINE PIN CONTACT NECTOR* M-LINE	2-293476-2
	2.5	3.3	2.2	0	~0.7	MACHINE PIN CONTACT NECTOR* M-LINE	1-293476-2
	1.5	3.3	1.7	1	~0.8	MACHINE PIN CONTACT NECTOR* M-LINE	293476-2

2010
RELEASED FOR PUBLICATION
ALL RIGHTS RESERVED.
COPYRIGHT 2010
BY -

DIMENSIONS: mm		DWN M. ZUCCA	22OCT2009	MATERIAL	BRASS	FINISH	TIN PLTD
TOLERANCES UNLESS OTHERWISE SPECIFIED:		CHK M. ZUCCA	22OCT2009	TE Connectivity			
0 PLC	±-	APVD G. TURCO	22OCT2009				
1 PLC	±0.3	PRODUCT SPEC		NAME			
2 PLC	±0.20	108-20304		MACHINED PIN CONTACT NECTOR* M-LINE			
3 PLC	±-	APPLICATION SPEC		SIZE	CAGE CODE	DRAWING NO	RESTRICTED TO
4 PLC	±-	114-20152		A4	00779	C-293476	-
ANGLES	±3°	WEIGHT		Customer Drawing			
		SEE TABLE 1		SCALE	3:1	SHEET	1 OF 1
				REV H			