

10 9 8 7 6 5 4 3 2 1

Part Number	CKT SIZE	VOID POSITION	DIMENSION						PACKING TYPE
			A	B	M	H	T	F	
87951-0001	8	-----	19.90	17.50	10.00	10.30	3.50	23.80	TRAY
87951-0002	8	-----	19.90	17.50	10.00	15.30	3.50	28.80	TRAY

NOTE:

1. WAFER TO BE FLAT WITHIN 0.003in/in or mm/mm.
2. MATERIAL: HSG: PA66, GLASS FILLED, UL-94V-2, COLOR: NATURAL. PIN: COPPER ALLOY
3. PLATING FINISH: 100MNCES MIN TIN OVER 50MNCES MIN NICKEL UNDERPLATE OVERALL.
4. PIN PUSHOUT FORCE: 1KG MIN. IN EITHER DIRECTION.
5. HEADER MAY BE BROKEN TO DESIRE CKT SIZE, SLIGHTLY FLASHES SHOULD BE ACCEPTED.
6. PARTS TO BE PACKED IN TRAY.

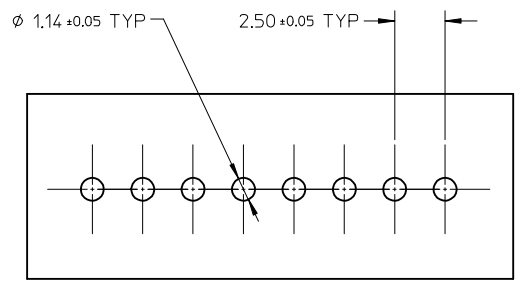
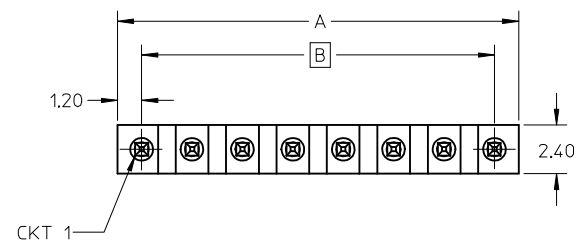

RECOMMENDED P.C.B. HOLE LAYOUT

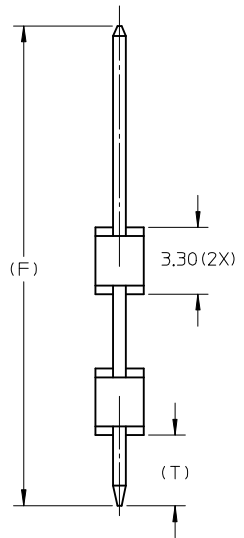
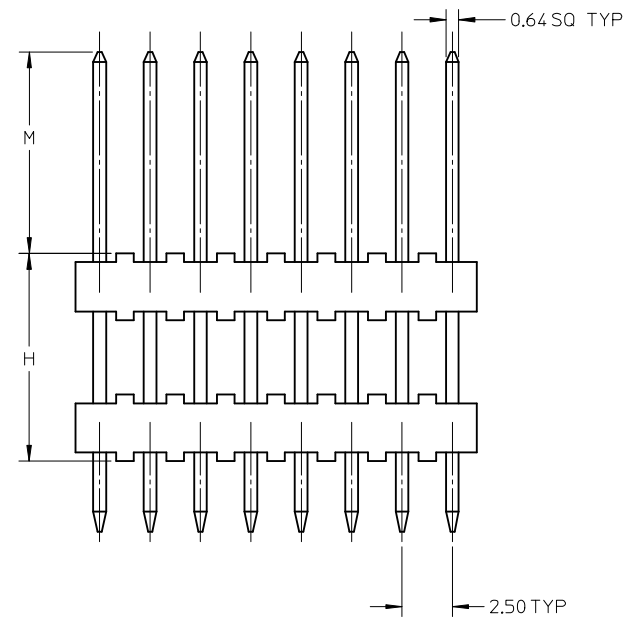

EC NO: S2005-1060 DRWN:CHO 2005/07/22 CHKD:RAOVLN 2005/07/22 APPR:PTLIJ 2005/07/25 A1	DESCRIPTION REV	QUALITY SYMBOLS	GENERAL TOLERANCES (UNLESS SPECIFIED)	DIMENSION STYLE	SCALE	DESIGN UNITS	THIRD ANGLE PROJECTION	
		$\nabla=0$ $\text{C}=0$	mm    INCH 4 PLACES ± --- ± --- 3 PLACES ± --- ± --- 2 PLACES ± 0.25 ± --- 1 PLACE ± --- ± --- ANGULAR ± 3 °	MM ONLY	NTS	METRIC		
			DRAFT WHERE APPLICABLE MUST REMAIN WITHIN DIMENSIONS	DRAWN BY: YLQ1A0    DATE: 2004/10/20 CHECKED BY: KMG0H    DATE: 2004/10/26 APPROVED BY: SCL0W    DATE: 2004/10/26	TITLE	SALES DRAWING SINGLE ROW DUAL WAFER 2.50MM PITCH, T/H		
				MATERIAL NO.    DOCUMENT NO.    SHEET NO. SEE TABLE    SD-87951-001    1 OF 1	MOLEX INCORPORATED			
				SIZE	THIS DRAWING CONTAINS INFORMATION THAT IS PROPRIETARY TO MOLEX INCORPORATED AND SHOULD NOT BE USED WITHOUT WRITTEN PERMISSION			

9 8 7 6 5 4 3 2 1