

# Printed-circuit board connector - MC 0,5/16-G-2,54 P20 THR R56 - 1821384

Please be informed that the data shown in this PDF Document is generated from our Online Catalog. Please find the complete data in the user's documentation. Our General Terms of Use for Downloads are valid (<http://phoenixcontact.com/download>)

Header, Nominal current: 6 A, Rated voltage (III/2): 160 V, Number of positions: 16, Pitch: 2.54 mm, Color: black, Contact surface: Gold, Mounting: THR soldering, Sample values available under SAMPLE MC...



The illustration shows the 10-position version

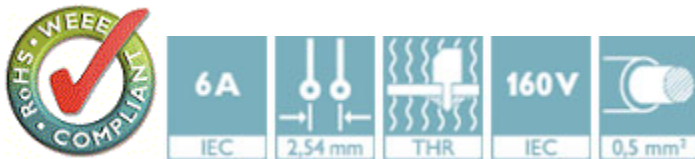

## Key Commercial Data

Packing unit	1 STK
Minimum order quantity	465 STK
Custom tariff number	85366990
Country of origin	Germany

## Technical data

### Environmental Product Compliance

China RoHS	No hazardous substances above threshold values
------------	--

### Dimensions

Length	7.1 mm
Pitch	2.54 mm
Dimension a	38.1 mm
Width	45.22 mm
Constructional height	4.85 mm
Height	6.85 mm
Length of the solder pin	2 mm
Pin dimensions	0,64 x 0,64
Pin spacing	2.54 mm

# Printed-circuit board connector - MC 0,5/16-G-2,54 P20 THR R56 - 1821384

## Technical data

### Dimensions

Hole diameter	1.2 mm
---------------	--------

### General

Range of articles	MC 0,5/...-G-THR
Insulating material group	IIIa
Rated surge voltage (III/3)	2.5 kV
Rated surge voltage (III/2)	2.5 kV
Rated surge voltage (II/2)	2.5 kV
Rated voltage (III/3)	32 V
Rated voltage (III/2)	160 V
Rated voltage (II/2)	160 V
Connection in acc. with standard	EN-VDE
Nominal current $I_N$	6 A
Insulating material	LCP
Flammability rating according to UL 94	V0
Color	black
Number of positions	16

### Standards and Regulations

Connection in acc. with standard	EN-VDE
Flammability rating according to UL 94	V0

## Drawings

Drilling diagram

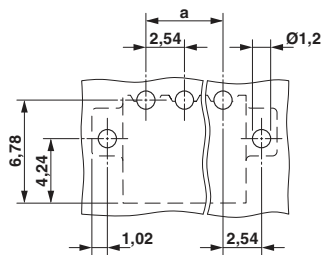

Dimensional drawing

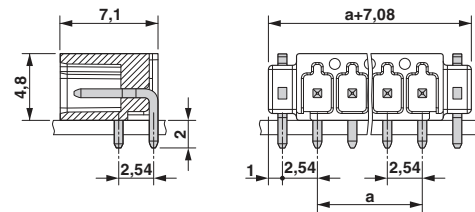

# Printed-circuit board connector - MC 0,5/16-G-2,54 P20 THR R56 - 1821384

Diagram

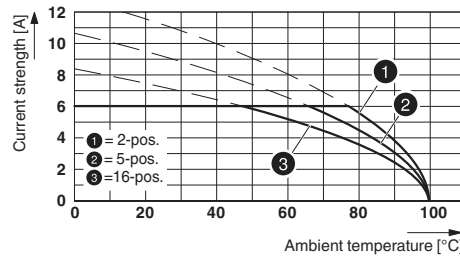

Type: FMC 0,5/...-ST-2,54 with MC 0,5/...-G-2,54 P20 THR R..

## Classifications

eCl@ss

eCl@ss 4.0	272607xx
eCl@ss 4.1	27260701
eCl@ss 5.0	27260701
eCl@ss 5.1	27260701
eCl@ss 6.0	27260704
eCl@ss 7.0	27440402
eCl@ss 8.0	27440402
eCl@ss 9.0	27440402

ETIM

ETIM 3.0	EC001121
ETIM 4.0	EC002637
ETIM 5.0	EC002637

UNSPSC

UNSPSC 6.01	30211810
UNSPSC 7.0901	39121409
UNSPSC 11	39121409
UNSPSC 12.01	39121409
UNSPSC 13.2	39121409

## Approvals

Approvals

# Printed-circuit board connector - MC 0,5/16-G-2,54 P20 THR R56 - 1821384

## Approvals

### Approvals

cULus Recognized / VDE Gutachten mit Fertigungsüberwachung / IECEE CB Scheme / EAC

### Ex Approvals

## Approval details

cULus Recognized <a href="http://database.ul.com/cgi-bin/XYV/template/LISEXT/1FRAME/index.htm">http://database.ul.com/cgi-bin/XYV/template/LISEXT/1FRAME/index.htm</a> E60425-19920306		
	B	C
Nominal current IN	6 A	6 A
Nominal voltage UN	150 V	50 V

VDE Gutachten mit Fertigungsüberwachung  <a href="http://www.vde.de">http://www.vde.de</a> 40042258	
Nominal current IN	6 A
Nominal voltage UN	160 V

IECEE CB Scheme  <a href="http://www.iecee.org/">http://www.iecee.org/</a> DE1-55663-B1	
Nominal current IN	6 A
Nominal voltage UN	160 V

EAC B.01742
-------------

## Accessories

### Accessories

Labeled terminal marker

## Printed-circuit board connector - MC 0,5/16-G-2,54 P20 THR R56 - 1821384

### Accessories

Marker card - SK 2,54/2,8:FORTL.ZAHLEN - 0804853



Marker card, Card, white, labeled, Horizontal: Consecutive numbers 1 - 10, 11 - 20, etc. up to 91 - 99, Mounting type: Adhesive, for terminal block width: 2.54 mm, Lettering field: 2.54 x 2.8 mm

Sample set - SAMPLE MC 0,5/16-G-2,54 P20THR - 1836049



Header, Nominal current: 6 A, Rated voltage (III/2): 160 V, Number of positions: 16, Pitch: 2.54 mm, Color: black, Contact surface: Gold, Mounting: THR soldering

### Additional products

Printed-circuit board connector - FMC 0,5/16-ST-2,54 - 1821232



Plug component, Nominal current: 6 A, Rated voltage (III/2): 160 V, Number of positions: 16, Pitch: 2.54 mm, Connection method: Push-in spring connection, Color: black, Contact surface: Gold