

4

3

2

1

THIS DRAWING IS UNPUBLISHED.

RELEASED FOR PUBLICATION

REVISIONS

© COPYRIGHT - TE Connectivity Ltd.

ALL RIGHTS RESERVED.

P	LTR	DESCRIPTION	DATE	DWN	APVD
	H1	REVISED PER ECR-09-017960	26AUG09	HMR	JR
	H2	REVISED PER ECO-18-006974	08MAY2018	RS	DR

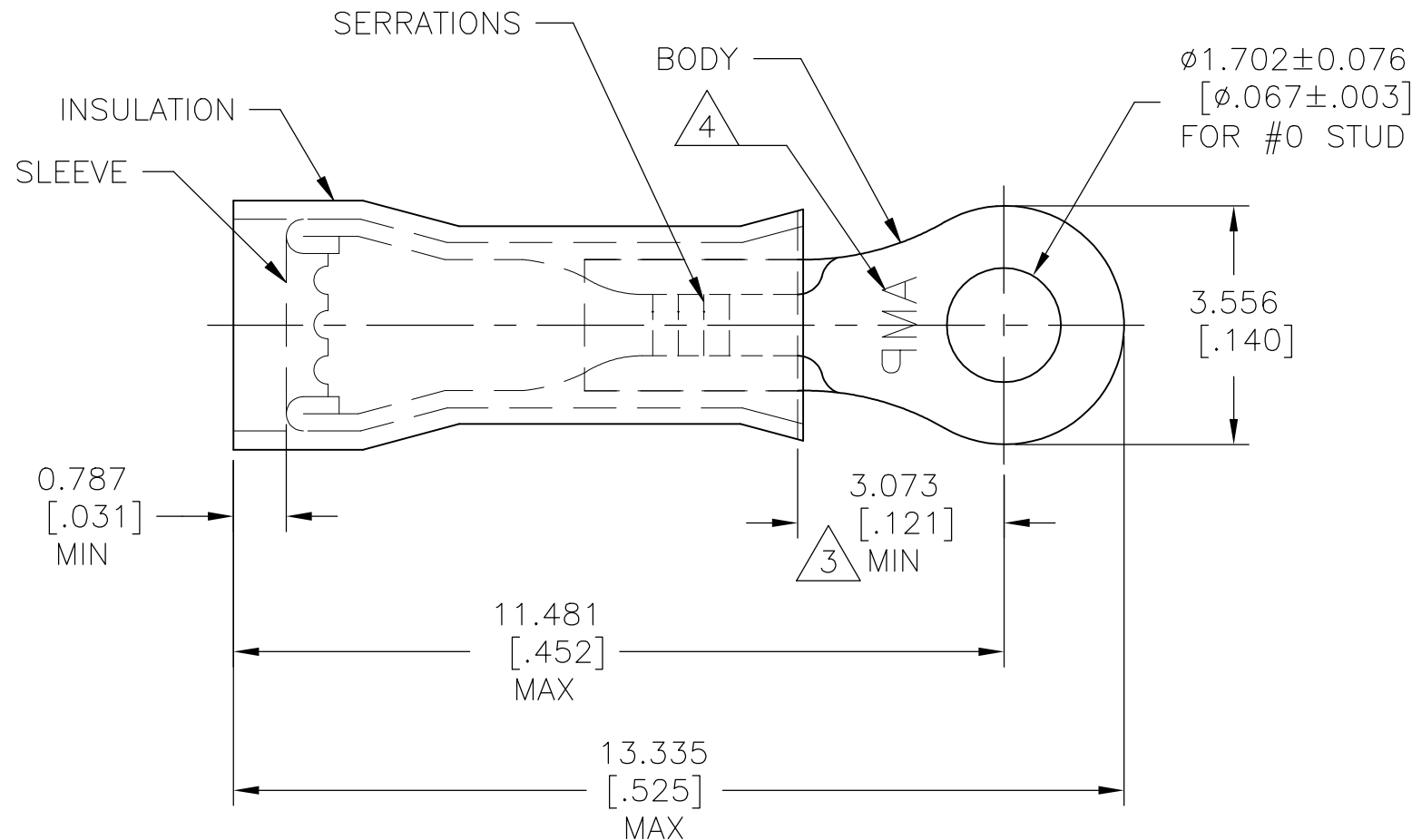

- 1 FOR $\phi 1.270[\phi.050]$ TO $\phi 2.083[\phi.082]$ WIRE INSULATION DIA
- 2 BODY MATERIAL THK: $0.457\pm 0.051[.018\pm.002]$
- 3 APPLIES FROM THE EDGE OF THE METAL BARREL TO THE CENTER OF THE STUD
- 4 STAMP AMP APPROX AS SHOWN

QTY	DESCRIPTION	MATERIAL & FINISH	PART NO
4000	321013 ON TAPE	BODY: COPPER (ASTM-B152) TIN PL (ASTM-B545)	2-321013-1
1000	LOOSE PIECE	SLEEVE: COPPER (ASTM-B152) INSULATION: YELLOW NYLON	321013

AMP INCORPORATED
CUSTOMER SERVICE SYSTEMS

THIS DRAWING IS A CONTROLLED DOCUMENT.

DWN	26AUG09
CHK	RAGHAVENDRA
APVD	26AUG09
APVD	JEFF RUTH
APVD	TOM MICHIELUTTI



FOR ADDITIONAL PRODUCT INFORMATION OR COPIES OF DRAWINGS AND TECHNICAL DOCUMENTS	PRODUCT INFORMATION CENTER 1-800-522-6752
FOR APPLICATION TOOLING INFORMATION	TOOLING ASSISTANCE CENTER 1-800-722-1111
FOR ORDER ENTRY	1-800-526-5142

MAX RECOMMENDED OPERATING TEMPERATURE: 105°C [221°F]
VOLTAGE RATING: 300 V MAX
CIRCULAR MIL AREA: 0.10mm ² -0.41mm ² [202-810]

DIMENSIONS: mm [INCHES]	TOLERANCES UNLESS OTHERWISE SPECIFIED:
	0 PLC ± -
	1 PLC ± -
	2 PLC ± -
	3 PLC ± 0.127[.005]
	4 PLC ± -
	ANGLES ± 5°
MATERIAL SEE TABLE	FINISH SEE TABLE

PRODUCT SPEC	114-2157
APPLICATION SPEC	
WEIGHT	
CUSTOMER DRAWING	

NAME WIRE TERMINAL PIDG - RING TONGUE WIRE SIZE: 26 - 22 AWG			
SIZE	CAGE CODE	DRAWING NO	RESTRICTED TO
A3	00779	C-321013	-
SCALE	10:1	SHEET	1 OF 1
REV	H2		