

REVOLUTIONS				
REV	ECO	DESCRIPTION	DATE	BY
A1	-	RELEASED DRAWING	Sept-7-2016	Ben
A2	-	Updating Drawing	Oct-16-17	Tommy

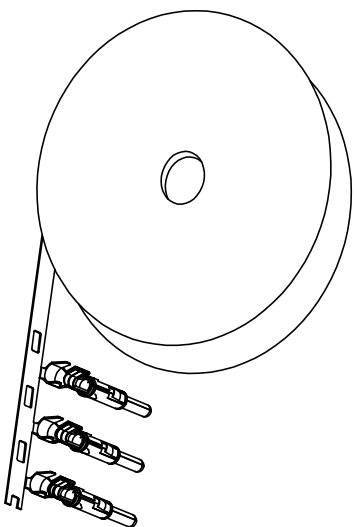

CONTACT ORIENTATION ON ROLL

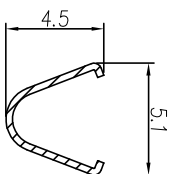

SECTION C-C

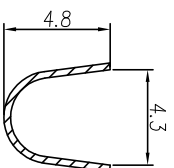

SECTION D-D

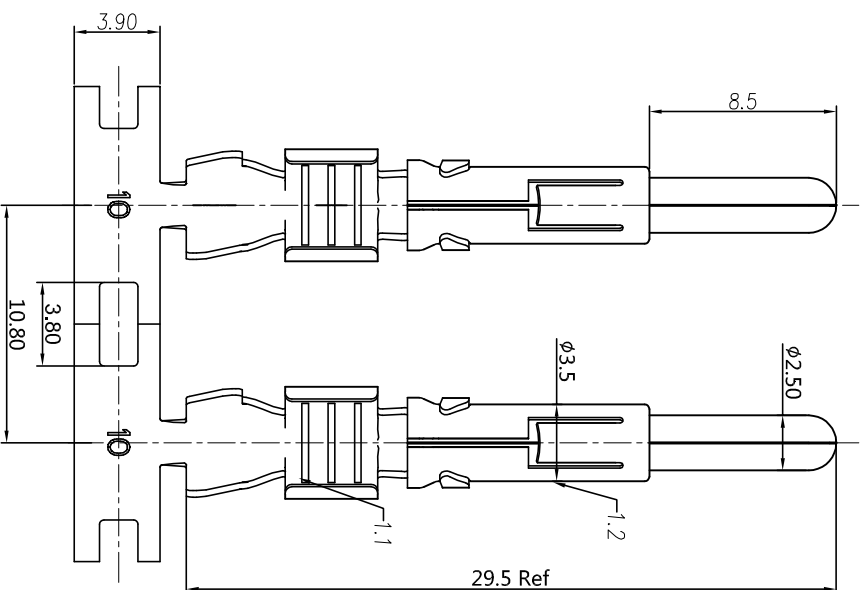

- NOTES : (UNLESS OTHERWISE SPECIFIED)
- MATERIAL :
 - CONTACT BODY : COPPER ALLOY.
 - OUTER SPRING : STAINLESS STEEL.
 - SPECIFICATIONS :
 - CURRENT RATING : 23A MAX.
 - TERMINATION TYPE : CRIMPING.
 - WIRE RANGE : 4.0mm².
 - WIRE INSULATION DIA(MAX) : 4.3mm.
 - ROHS COMPLIANT.
 - ALL DIMENSIONS ARE FOR REFERENCE USE ONLY.

P/N	CONTACT PLATING(MATING AREA)
SP12A1T-10	TIN PLATING OVER NICKEL.
SP12A1F-10	GOLD FLASH PLATING OVER NICKEL.
SP12A1G10-10	10µ" GOLD PLATING OVER NICKEL.
SP12A1G15-10	15µ" GOLD PLATING OVER NICKEL.
SP12A1G30-10	30µ" GOLD PLATING OVER NICKEL.

QUANTITY	PART NUMBER	DESCRIPTION	ITEM
		MATERIALS LIST	
<p>UNLESS OTHERWISE SPECIFIED 1) All dimensions are in millimeters. 2) Tolerances are as follows: 1 Pt. DEC 40.30 Fractions 1/16" 3 Pt. DEC 40.08 Angles 1° 3) Note reference = </p>			
<p>SIGNATURES DATE</p> <p>DRAWN: Ben 00T-16-17</p> <p>CHECKED: Tod 00T-16-17</p> <p>ENGINEER: Tommy 00T-16-17</p> <p>APPROVAL: Tommy 00T-16-17</p> <p>CUSTOMER: Amphenol</p>		<p>ECO-MATE PIN CONTACT, STAMPED, 4.0mm², 2.5mm CONTACT</p>	
<p>SIZE TYPE DWG NO. REVISION</p> <p>B C- SP12A1XX-10 A2</p>			
<p>STAMPED, 4.0mm², 2.5mm CONTACT</p>			
<p>SCALE: NONE SHEET 1 OF 1</p>			

THIS DRAWING IS SUPERSEDED BY THE LATEST REVISIONS. SPECIFICATIONS AND PERFORMANCE DATA ARE THE PROPERTY OF AMPHENOL. REPRODUCTION OR MODIFICATION OF THIS DRAWING WITHOUT THE WRITTEN PERMISSION OF AMPHENOL IS PROHIBITED. ALL DIMENSIONS ARE IN MILLIMETERS UNLESS OTHERWISE SPECIFIED.

AMPHENOL CORPORATION
 44724 Morley Drive
 Clinton Township, MI 48036

Site Systems - www.amphenol-site.com

Next Ass'y:

PROCESS SPECIFICATIONS:

MATERIAL SPECIFICATIONS:

REVISION

DATE

BY

APPR

RELEASED DRAWING

DATE

BY

APPR

Updating Drawing

DATE

BY

APPR

ECO-MATE PIN CONTACT, STAMPED, 4.0mm², 2.5mm

DWG NO:

SP12A1XX-10

REV:

A2

SH:

1

QTY:

1

TTITLE:

ECO-MATE PIN CONTACT, STAMPED, 4.0mm², 2.5mm