

Type CNX-01 PC Board Type Fuse Clip Maxi Auto Blade Fuses



www.optifuse.com (619) 593-5050

Specifications:

Voltage Rating: 500V AC / 250VDC
 Amperage Rating: See Chart
 Body Material: See Chart

Part number:	Material	Amperage Rating
CNX-01	Brass	Current up to 60A
CNX-01-PCU	Phosphor Bronze	Current up to 80A
CNX-01-BECU	Beryllium Bronze	Current up to 100A

Finish: Bright Tin plated
 For Matte Tin plated – Add a **-CE** to end of part number (ie. CNX-01-PCU-**CE**)

For use with Type **APX** Fuses - (Maxi Automotive Blade Type)

Mechanical Dimensions: Inches [mm]

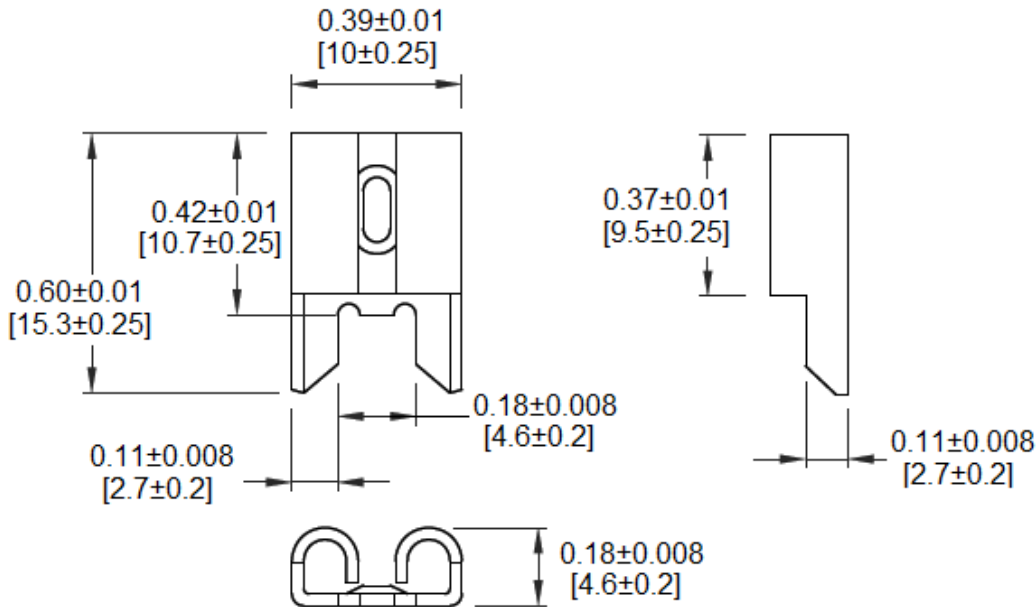

Mounting Detail for Two Clips

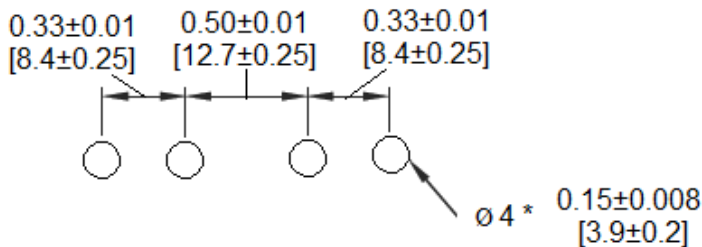

	<p>Warning: -Operation beyond the specified maximum ratings or improper use may result in damage and possible electrical arcing and/or flame.</p>
	<p>-Avoid contact of device with chemical solvent. Prolonged contact will damage the device performance.</p>