

Link for paralleling 3-pole, with bore hole for 3RT1.5

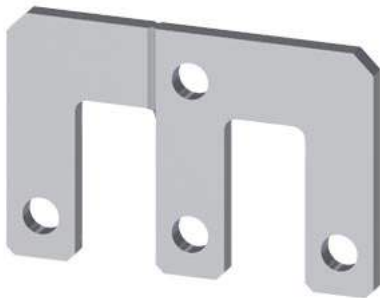

| General technical data | | |
|------------------------|--|---|
| product brand name | | SIRIUS |
| product designation | | Connection jumper |
| design of the product | | Parallel switching connection for contactors S6 |

| Certificates/ approvals | | |
|--------------------------|-----|---------------------------|
| General Product Approval | EMC | Declaration of Conformity |



[Confirmation](#)



| Declaration of Conformity | Test Certificates | Marine / Shipping |
|---------------------------|-------------------|-------------------|
|---------------------------|-------------------|-------------------|



[Special Test Certificate](#)



| other | Railway |
|-------|---------|
|-------|---------|

[Confirmation](#)

[Miscellaneous](#)

[Special Test Certificate](#)

Further information

Information- and Downloadcenter (Catalogs, Brochures,...)

<https://www.siemens.com/ic10>

Industry Mall (Online ordering system)

<https://mall.industry.siemens.com/mall/en/en/Catalog/product?mlfb=3RT1956-4BA31>

Cax online generator

<http://support.automation.siemens.com/WW/CAXorder/default.aspx?lang=en&mlfb=3RT1956-4BA31>

Service&Support (Manuals, Certificates, Characteristics, FAQs,...)

<https://support.industry.siemens.com/cs/ww/en/ps/3RT1956-4BA31>

Image database (product images, 2D dimension drawings, 3D models, device circuit diagrams, EPLAN macros, ...)

http://www.automation.siemens.com/bilddb/cax_de.aspx?mlfb=3RT1956-4BA31&lang=en

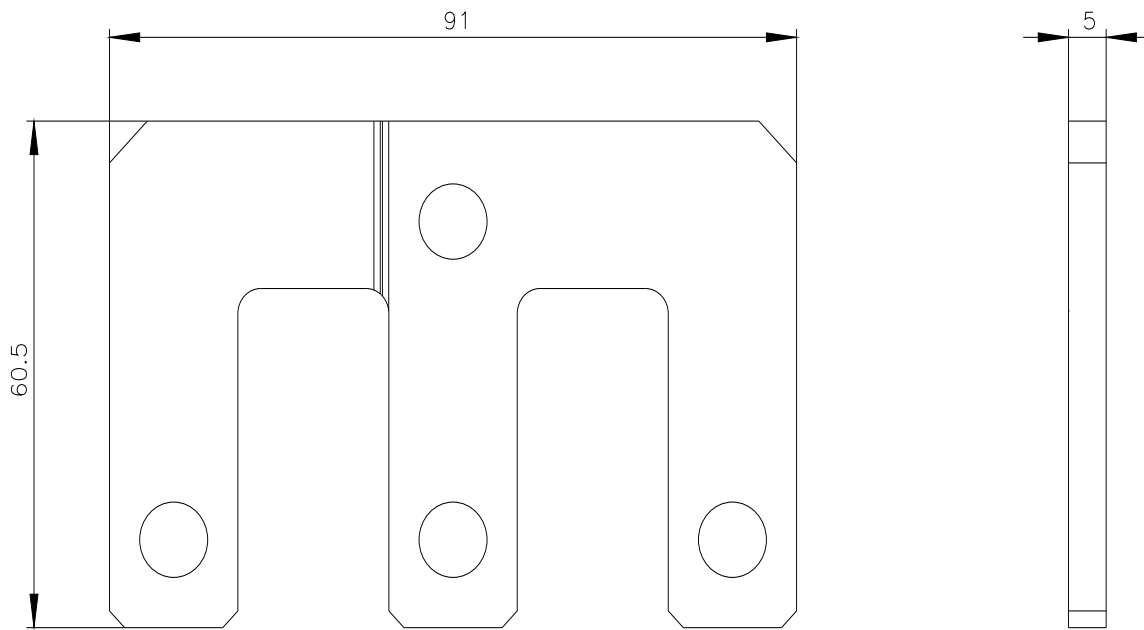

last modified:

12/23/2020 