

LOC	DIST	REVISIONS					
		P	LTN	DESCRIPTION	DATE	DWN	APVD
ES	00	A3		REVISED PER ECO-11-005033	09MAY2011	RK	HMR
		A4		ECR-11-013206	27JUN2011	D.P	C.W
		A5		ECR-13-008246	21MAY2013	CC	CW

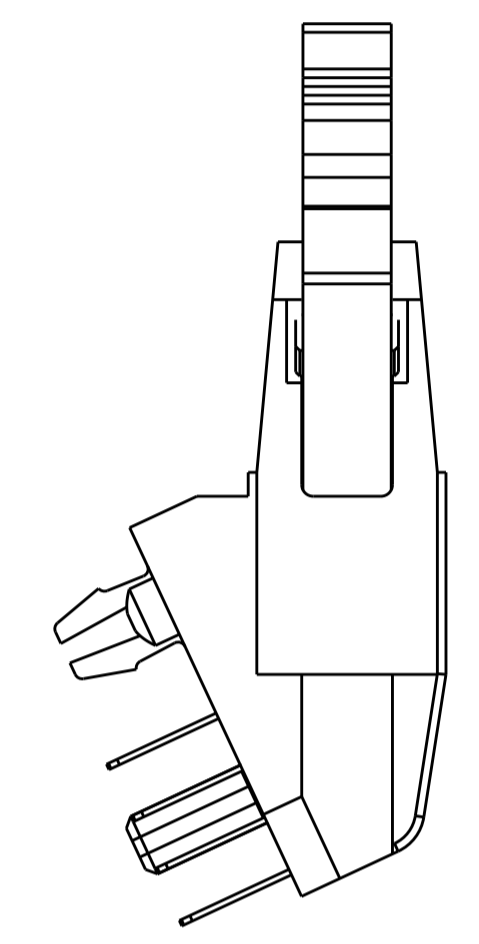

TAIL LENGTHS

- 2.67±0.25 FOR 1.60 (.063") THK PCB
- 3.18±0.25 FOR 2.36 (.093") THK PCB
- 4.00±0.25 FOR 3.18 (.125") THK PCB

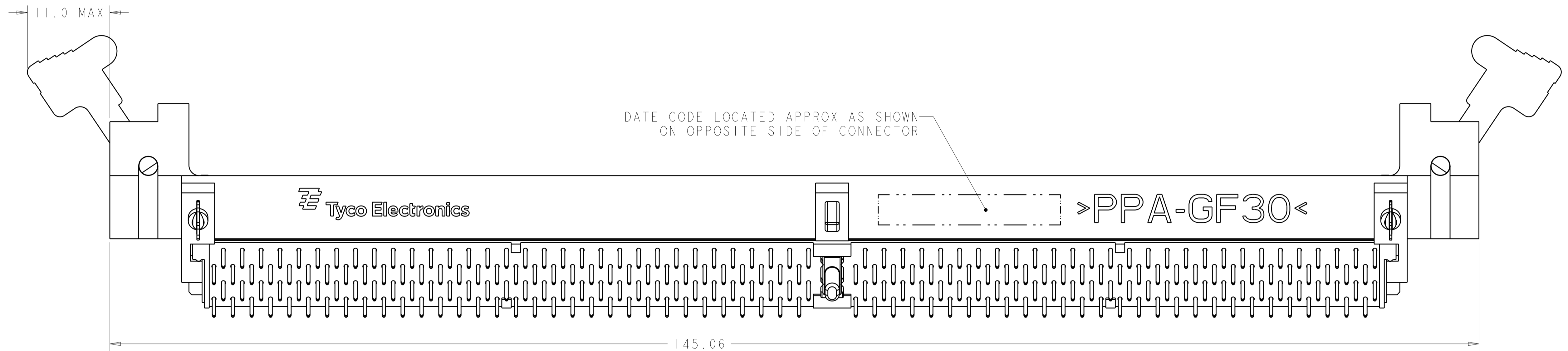
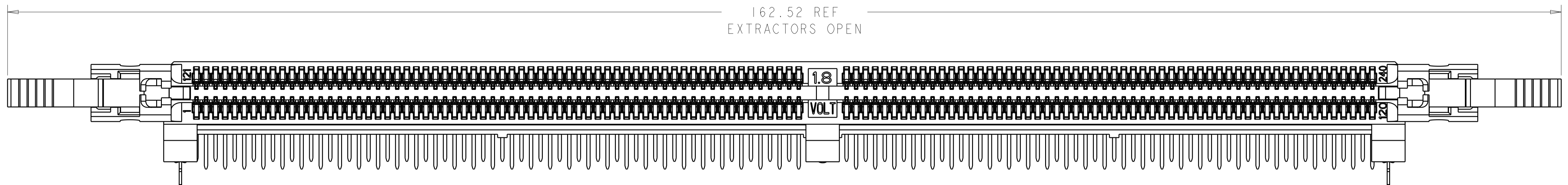
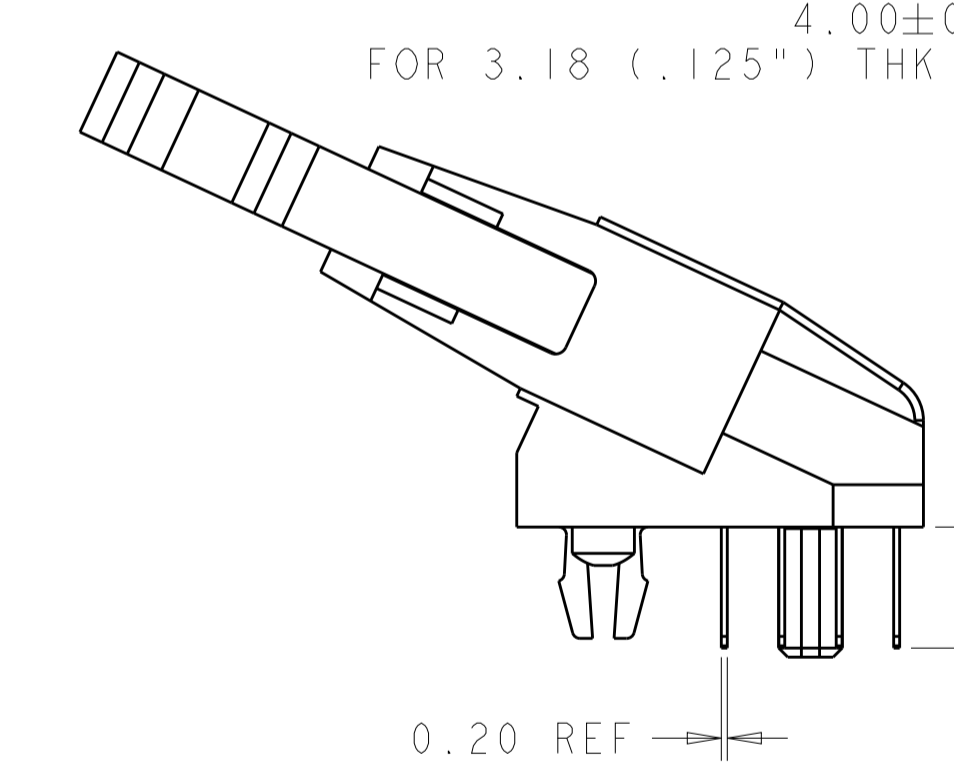
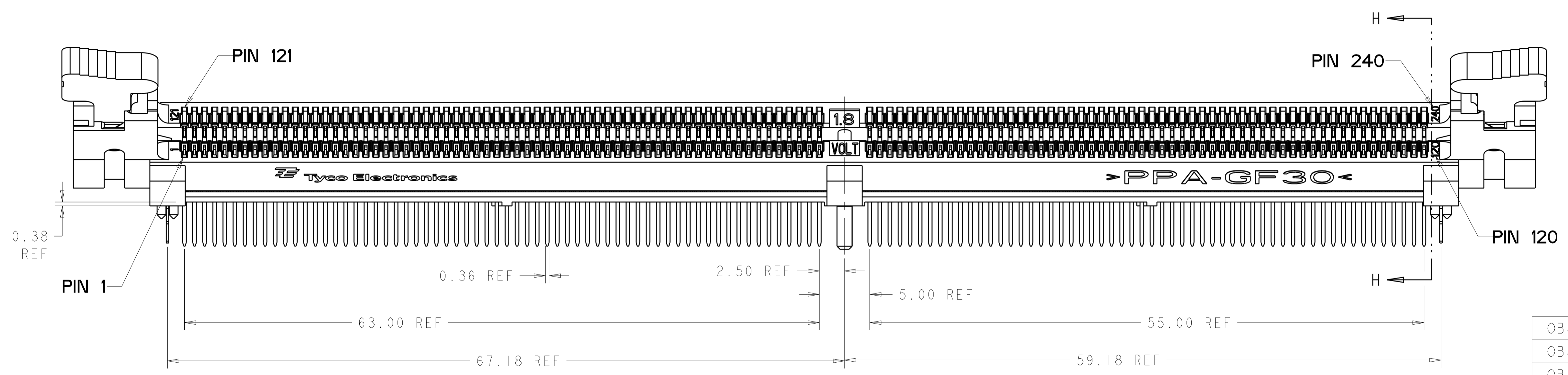

- 1 MATERIALS:  
HOUSING: HIGH TEMPERATURE THERMOPLASTIC, BLACK, UL94 V-0  
EXTRACTOR: HIGH TEMPERATURE THERMOPLASTIC, NATURAL (OFF WHITE)  
CONTACTS: COPPER ALLOY  
RETENTION BARB: COPPER ALLOY
- 2 INTERFACE FINISH:  
0.00076 MIN THK GOLD OVER 0.00127 MIN THK NICKEL.  
0.00038 MIN THK GOLD OVER 0.00127 MIN THK NICKEL.
- 3 SOLDER TAIL FINISH:  
0.00300 MIN THK MATTE LEAD FREE PLATING OVER 0.00127 MIN THK NICKEL.
- 4 RIGHT HOLE IS GLOBAL D-E ORIGIN FOR ALL POSITIONAL TOLERANCES.  
LEFT AND RIGHT NON-PLATED THRU HOLES ESTABLISH [-E-].
- 5 FINISHED HOLE SIZE. Ø0.15 MAXIMUM ANNULAR RING.

- 6 DATUM [-F-] IS CONNECTOR SIDE SURFACE OF PCB.
- 7 PORE BLOCKER APPLIED TO CONTACT INTERFACE

OBSELETE	0.00008 MIN	4.00	1658912-9
OBSELETE	0.00008 MIN	3.18	1658912-8
OBSELETE	0.00008 MIN	2.67	1658912-7
	0.00038 MIN	4.00	1658912-6
	0.00038 MIN	3.18	1658912-5
OBSELETE	0.00038 MIN	2.67	1658912-4
	0.00076 MIN	4.00	1658912-3
	0.00076 MIN	3.18	1658912-2
	0.00076 MIN	2.67	1658912-1
	CONTACT GOLD INTERFACE	TAIL LENGTH	PART NUMBER

THIS DRAWING IS A CONTROLLED DOCUMENT.

DIMENSIONS: mm

TOLERANCES UNLESS OTHERWISE SPECIFIED:

0 PLC	±	
1 PLC	±0.25	
2 PLC	±0.15	
3 PLC	±0.013	
4 PLC	±	
ANGLES	±	

MATERIAL:

FINISH:

OWN: D. RINGLER 28OCT2003  
CHK: J. McCLELLAN 29OCT2003  
APVD: J. McCLELLAN 29OCT2003

PRODUCT SPEC: 108-2168  
APPLICATION SPEC: 114-13130

WEIGHT: -

CUSTOMER DRAWING

TE Connectivity

SOCKET ASSEMBLY  
25 DEGREE DDR II DIMM  
240 POSITION, STANDARD FOOTPRINT

SIZE: A1  
CAGE CODE: 1658912  
DRAWING NO: 100779

RESTRICTED TO: -

SCALE: 1:1 SHEET 1 OF 3 REV: A5

LOC	DIST	REVISIONS					
ES	00	P	LTH	DESCRIPTION	DATE	DWN	APVD
-	-	-	-	SEE SHEET 1	-	-	-

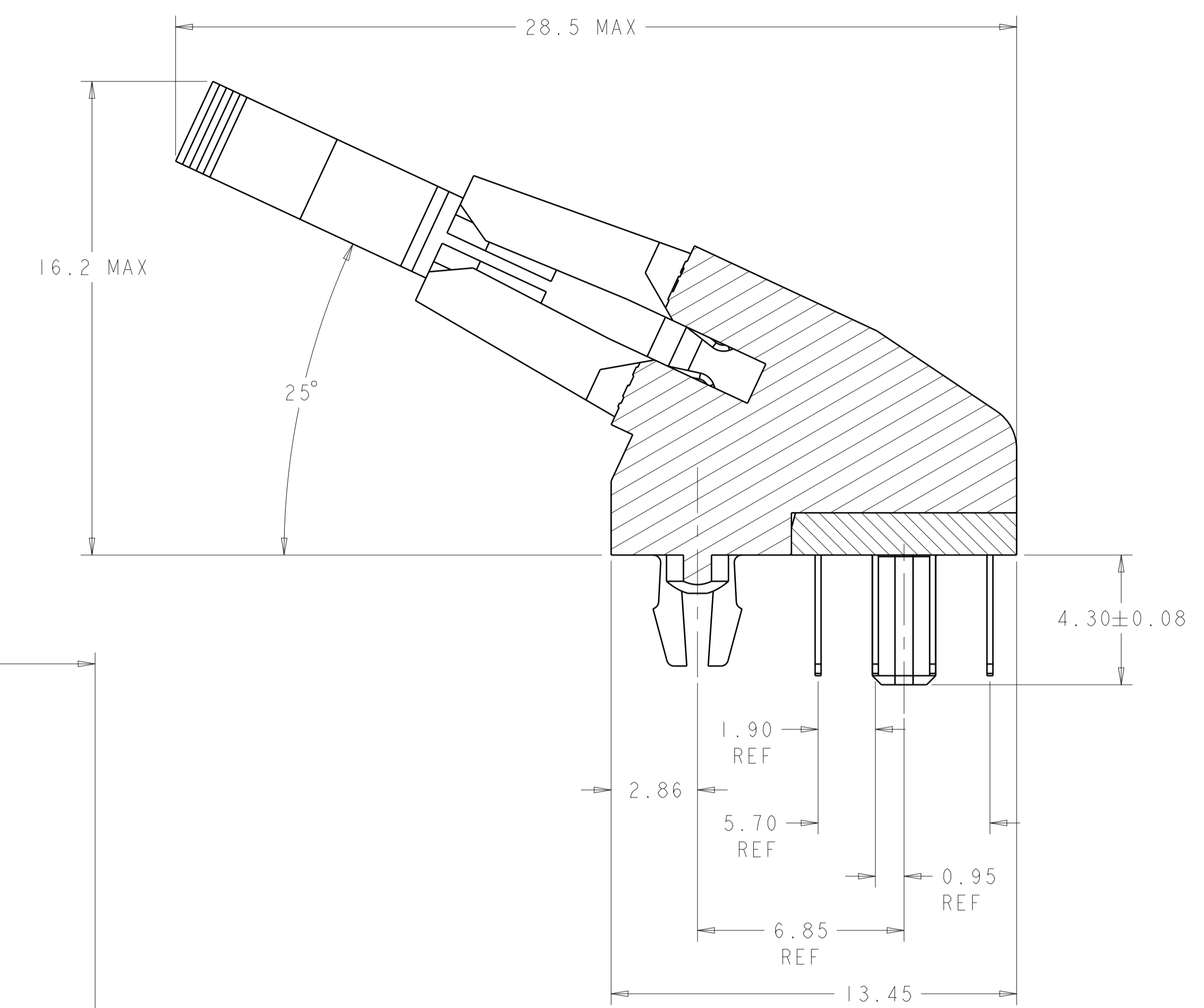
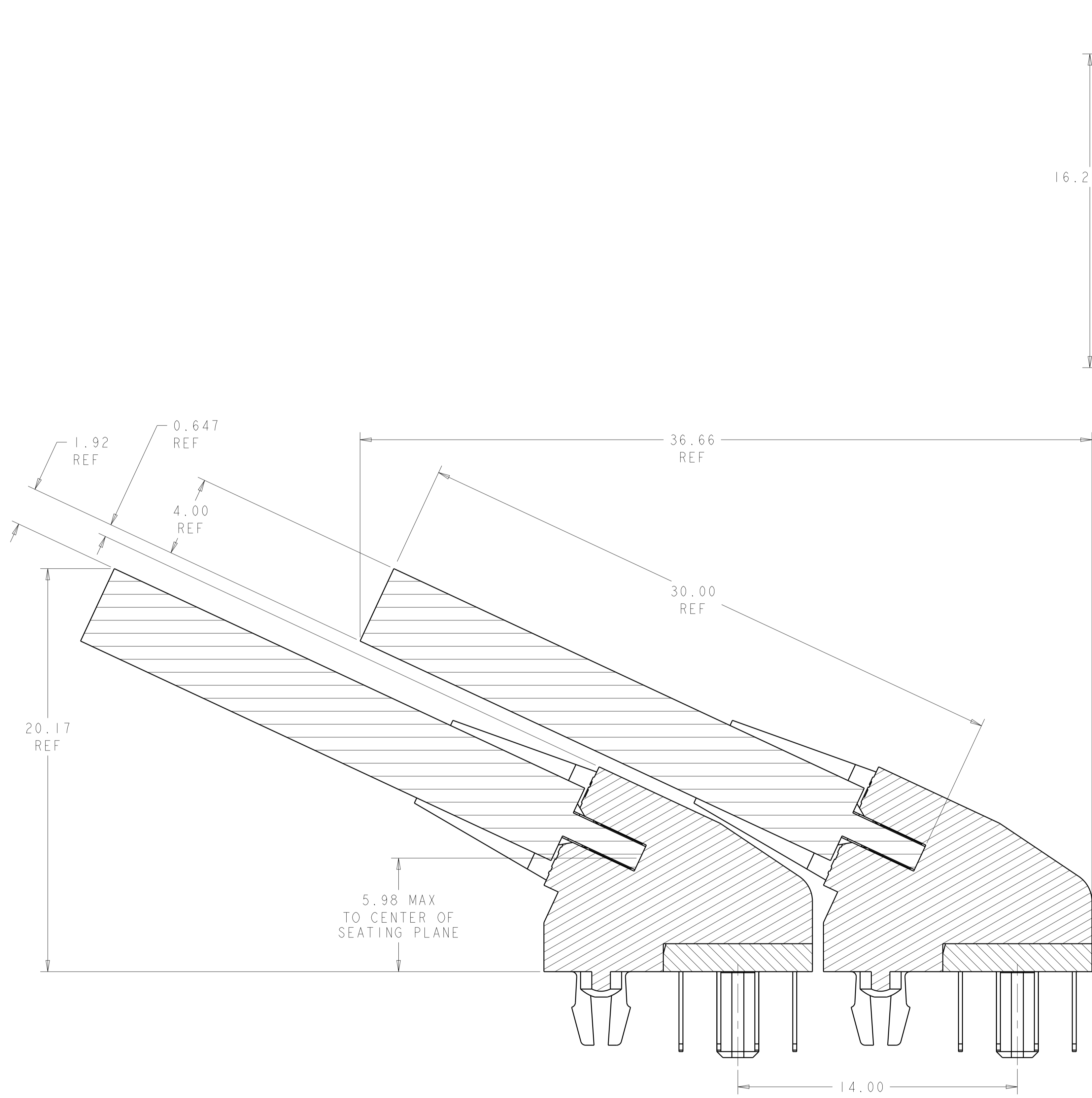

MINIMUM RECOMMENDED ROW TO ROW SPACING FOR 4mm THICK MODULE

SCALE 8:1

THIS DRAWING IS A CONTROLLED DOCUMENT.		DWN D. RINGLER 28OCT2003	TE Connectivity
DIMENSIONS: mm		CHK J. McCLELLAN 29OCT2003	
TOLERANCES UNLESS OTHERWISE SPECIFIED:		APVD J. McCLELLAN 29OCT2003	NAME SOCKET ASSEMBLY
0 PLC ±	0.25	PRODUCT SPEC	25 DEGREE DDR II DIMM
1 PLC ±	0.15	APPLICATION SPEC	240 POSITION, STANDARD FOOTPRINT
2 PLC ±	0.13	SIZE CAGE CODE DRAWING NO	A100779C=1658912
3 PLC ±	0.13	RESTRICTED TO	-
4 PLC ±	0.13	WEIGHT	-
ANGLES ±	0.1	CUSTOMER DRAWING	SCALE 1:1 SHEET 2 OF 3 REV A5
FINISH	-		

LOC	DIST	REV	DATE	BY	APPV
ES	00				

REVISIONS		DATE	BY	APPV
1	SEE SHEET 1			

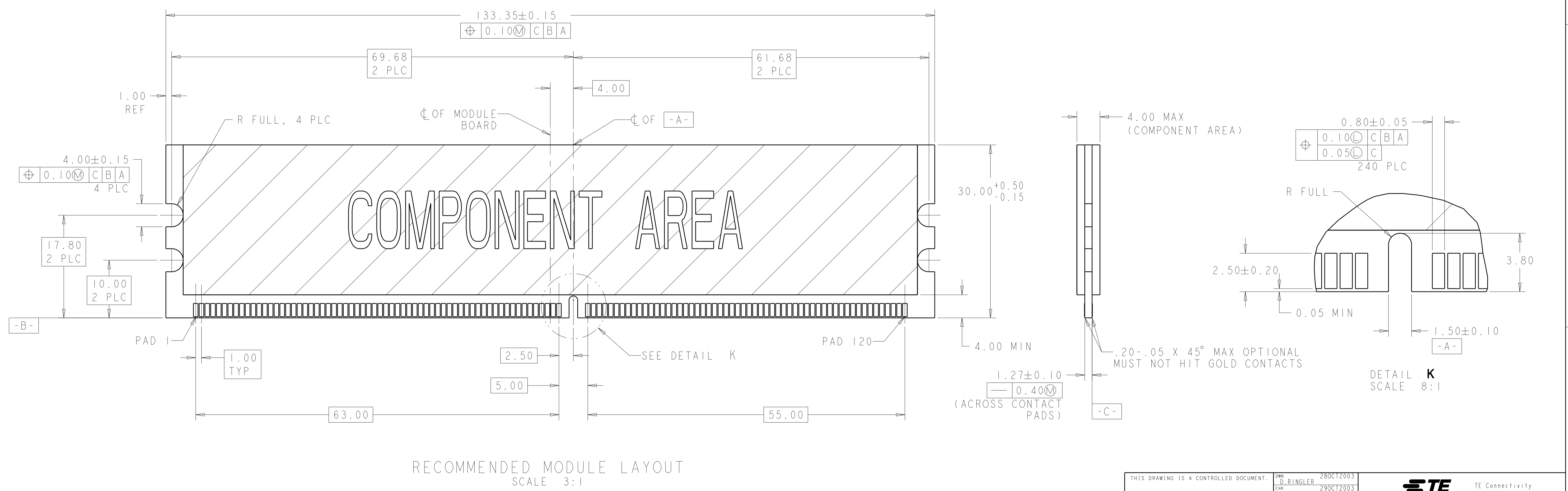
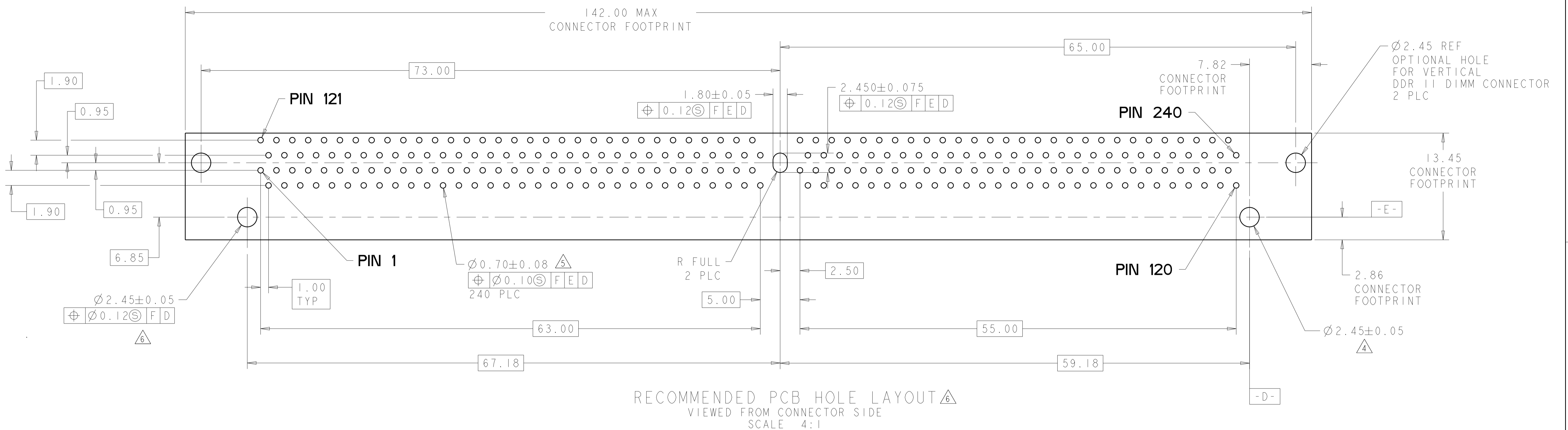

THIS DRAWING IS A CONTROLLED DOCUMENT.		DWN D. RINGLER 28OCT2003	TE Connectivity
DIMENSIONS:		CHK J. McCLELLAN 29OCT2003	
mm	TOLERANCES UNLESS OTHERWISE SPECIFIED:	APVD J. McCLELLAN 29OCT2003	NAME SOCKET ASSEMBLY
Ø	0 PLC ±0.25	PRODUCT SPEC	25 DEGREE DDR II DIMM
PLC	1 PLC ±0.15	APPLICATION SPEC	240 POSITION, STANDARD FOOTPRINT
PLC	2 PLC ±0.15	SIZE	114-13130
PLC	3 PLC ±0.13	WEIGHT	A100779C=1658912
PLC	4 PLC ±0.13	CUSTOMER DRAWING	SCALE 1:1 SHEET 3 OF 3 REV A5
ANGLES	±1		
MATERIAL	FINISH		