

DESIGNED & DIMENSIONED  
IN INCHES[MILLIMETERS]

PRF04-P-C-EP-335-SS-1

DO NOT  
SCALE FROM  
THIS PRINT

SERIES  
-04: TNCA

GENDER  
-P: PLUG

TYPE  
-C: CABLE

FINISH  
-EP: 50µ" EXTRA HEAVY GOLD  
CENTER CONTACT, PASSIVATED  
OUTER CONTACT

OPTION  
-1

TERMINATION  
-S: SOLDER CLAMP

ORIENTATION  
-S: STRAIGHT

CABLE TYPE  
-335: HARBOUR LL335

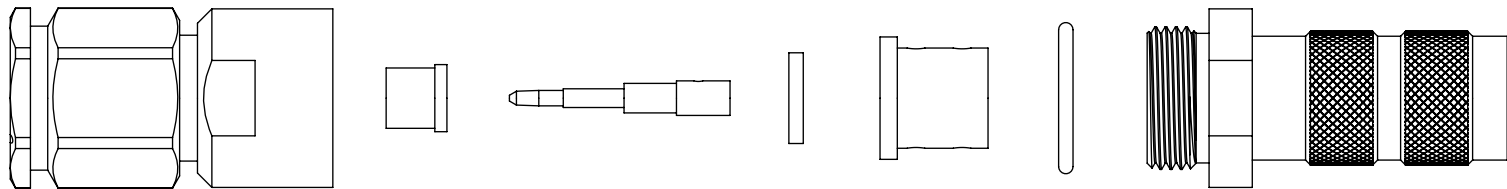
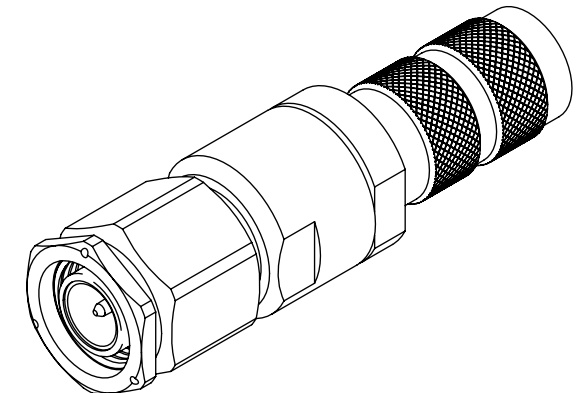
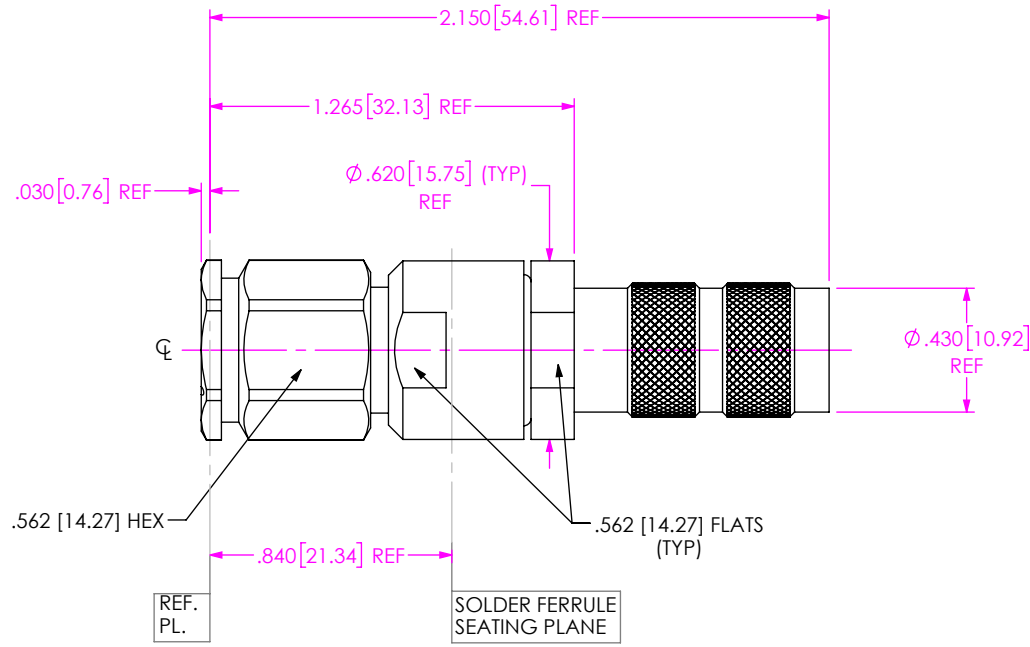

EXPLODED VIEW  
NOT TO SCALE  
(FOR CLARITY ONLY)

NOTES:

- MATERIAL:**  
 BODY, CLAMP NUT, COUPLING NUT: STAINLESS STEEL  
 CONTACT, LOCK RING: BERYLLIUM COPPER  
 SOLDER FERRULE: BRASS ALLOY  
 INSULATOR: PTFE  
 BEAD: PEI  
 O-RING, GASKET: SILICONE RUBBER
- FINISH:**  
 BODY, CLAMP NUT, COUPLING NUT: PASSIVATED  
 CONTACT: 50µ" MIN. GOLD OVER 50µ" MIN. NICKEL PLATE  
 SOLDER FERRULE: 10µ" MIN. GOLD OVER 50µ" MIN. NICKEL PLATE
- PCI P/N: 3230-X

F:\DWG\MISC\MKTG\PRF04-P-C-EP-335-SS-1-MKT.SLDDRW

UNLESS OTHERWISE SPECIFIED,  
DIMENSIONS ARE IN INCHES.  
TOLERANCES ARE:  
DECIMALS                      ANGLES  
.XX: ±.01 [0.3]                      1°  
.XXX: ±.005 [0.13]  
.XXXX: ±.0005 [0.013]

**PROPRIETARY NOTE**  
 THIS DOCUMENT CONTAINS CONFIDENTIAL AND  
 PROPRIETARY INFORMATION AND ALL DESIGN,  
 MANUFACTURING, REPRODUCTION, USE, PATENT RIGHTS  
 AND SALES RIGHTS ARE EXPRESSLY RESERVED BY SAMTEC,  
 INC. THIS DOCUMENT SHALL NOT BE DISCLOSED, IN WHOLE  
 OR PART, TO ANY UNAUTHORIZED PERSON OR ENTITY NOR  
 REPRODUCED, TRANSFERRED OR INCORPORATED IN ANY  
 OTHER PROJECT IN ANY MANNER WITHOUT THE EXPRESS  
 WRITTEN CONSENT OF SAMTEC, INC.

**samtec**  
 520 PARK EAST BLVD., NEW ALBANY, IN 47150  
 PHONE: 812-944-6733    FAX: 812-948-5047  
 e-Mail: info@SAMTEC.com    code 55322

DO NOT SCALE DRAWING	SHEET SCALE: 2:1	DESCRIPTION: TNCA PLUG, SOLDER CLAMP FOR HARBOUR LL335 CABLE
DWG. NO.		PRF04-P-C-EP-335-SS-1
BY: EVE L	08/25/2021	SHEET 1 OF 2

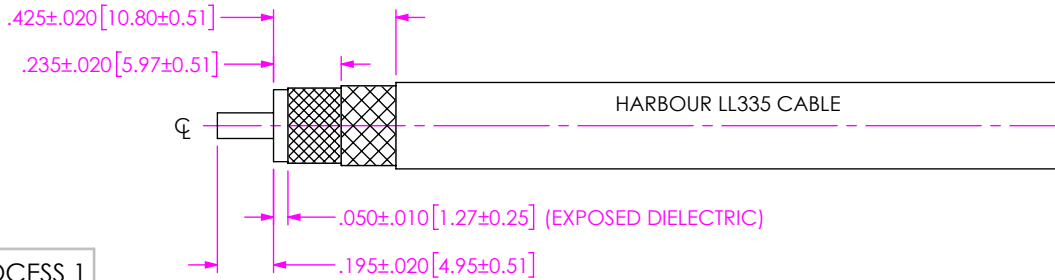

IN-PROCESS 1

1A. TRIM CABLE AS SHOWN.

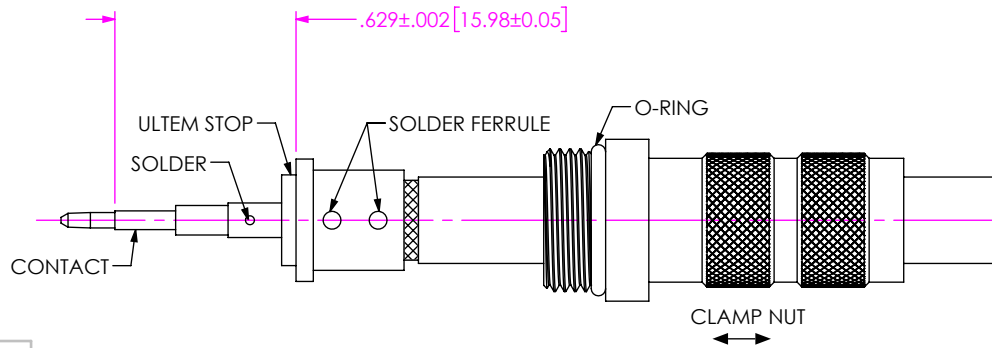

IN-PROCESS 2

2A. SLIDE CLAMP NUT ONTO CABLE AS SHOWN.

2B. INSERT CABLE INTO SOLDER FERRULE UNTIL CABLE DIELECTRIC IS FLUSH WITH FACE OF FERRULE. THEN SOLDER BOTH CABLE BRAIDS WHERE SHOWN.

2C. SLIDE DIELECTRIC STOP OVER CABLE CENTER CONDUCTOR AND SOLDER CONTACT FLUSH AGAINST STOP TO DIMENSION SHOWN.

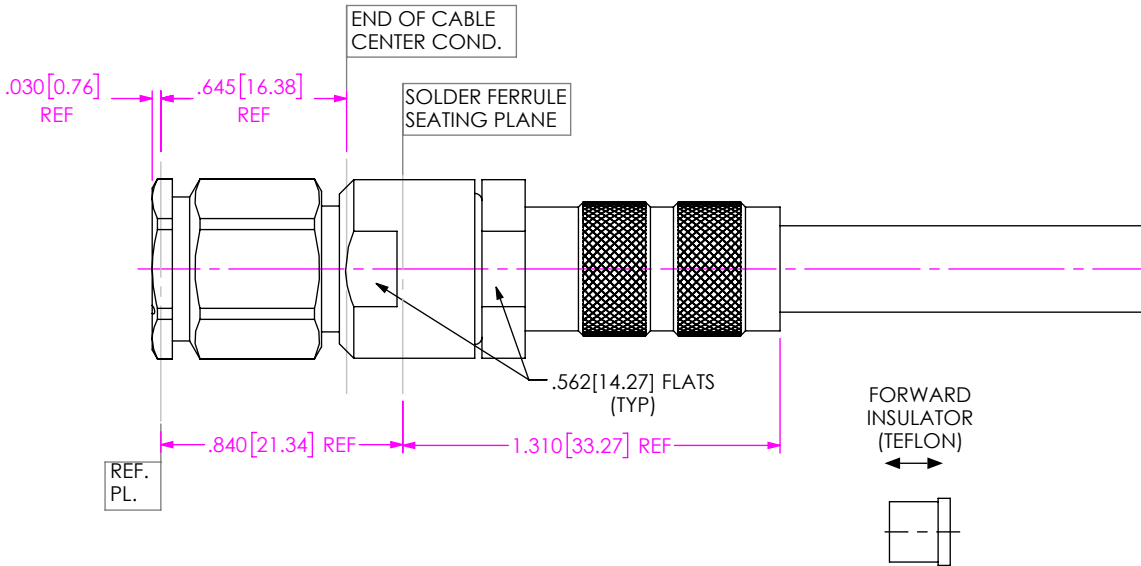

IN-PROCESS 3

3A. INSERT FORWARD INSULATOR INTO CONNECTOR IN ORIENTATION SHOWN.

3B. INSERT CABLE/CONTACT SUB-ASSEMBLY INTO CONNECTOR UNTIL SEATED AND TIGHTEN CLAMP NUT TO 35-45 IN/LBS.

**PROPRIETARY NOTE**  
 THIS DOCUMENT CONTAINS CONFIDENTIAL AND PROPRIETARY INFORMATION AND ALL DESIGN, MANUFACTURING, REPRODUCTION, USE, PATENT RIGHTS AND SALES RIGHTS ARE EXPRESSLY RESERVED BY SAMTEC, INC. THIS DOCUMENT SHALL NOT BE DISCLOSED, IN WHOLE OR PART, TO ANY UNAUTHORIZED PERSON OR ENTITY NOR REPRODUCED, TRANSFERRED OR INCORPORATED IN ANY OTHER PROJECT IN ANY MANNER WITHOUT THE EXPRESS WRITTEN CONSENT OF SAMTEC, INC.



520 PARK EAST BLVD, NEW ALBANY, IN 47150  
 PHONE: 812-944-6733 FAX: 812-948-5047  
 e-Mail info@SAMTEC.com code 55322

DO NOT SCALE DRAWING

SHEET SCALE: 3:2

DESCRIPTION: TNCA PLUG, SOLDER CLAMP FOR HARBOUR LL335 CABLE

DWG. NO. PRF04-P-C-EP-335-SS-1

BY: EVE L 08/25/2021 SHEET 2 OF 2