

THIS DRAWING IS UNPUBLISHED. RELEASED FOR PUBLICATION .19
 BY AMP INCORPORATED. ALL RIGHTS RESERVED.

LOC	DIST	REVISIONS			
P	LTR	DESCRIPTION	DATE	DWN	APVD
AF	50	B1	REVISED PER ECR-18-006427	15MAY2018	BW SV

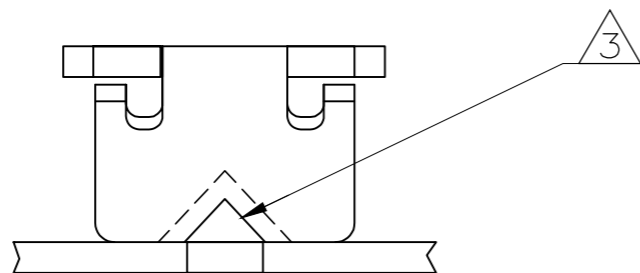

- 1 CONTINUOUS STRIP ON REELS WITH TERMINALS LOCATED ON 5.59±0.08 [.220±.003] CENTERS.
- 2 SLOT ACCEPTS 0.36-0.57mm [#27-#23] AWG COPPER MAGNET WIRE. A SINGLE WIRE ONLY.
ALUMINIUM RANGE IS 0.51-0.64mm [#24-#22] AWG ALUMINIUM WIRE RANGE IS APPLICABLE FOR POST TIN PLATED PART NOS ONLY.
- 3 POKE-IN ACCEPTS A 0.50-0.90mm² [#20-#18] AWG SOLID OR FUSED STRANDED LEAD WIRE.

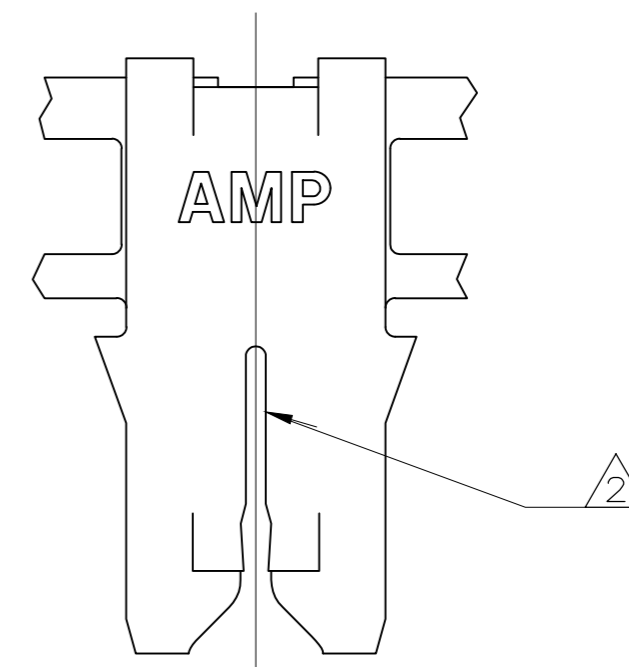
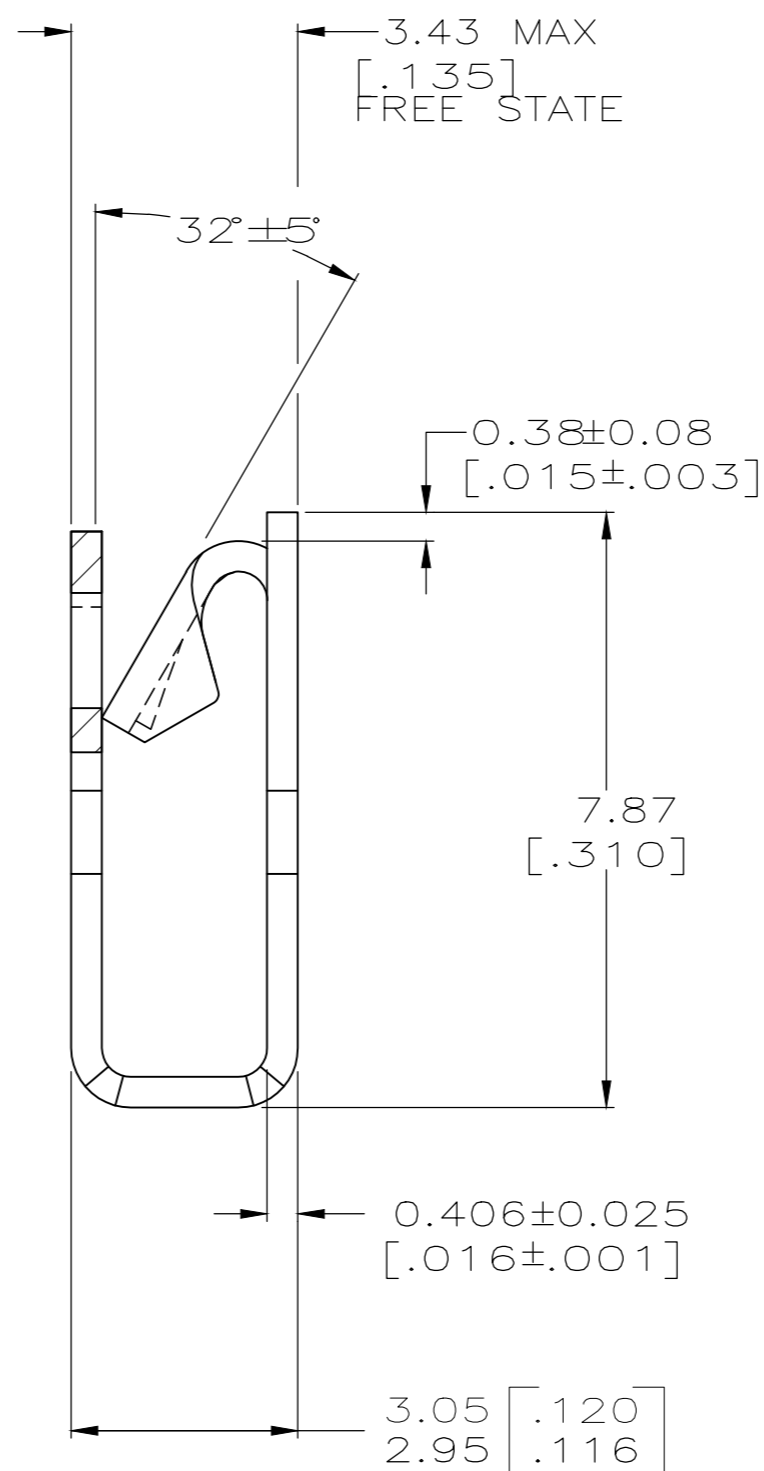
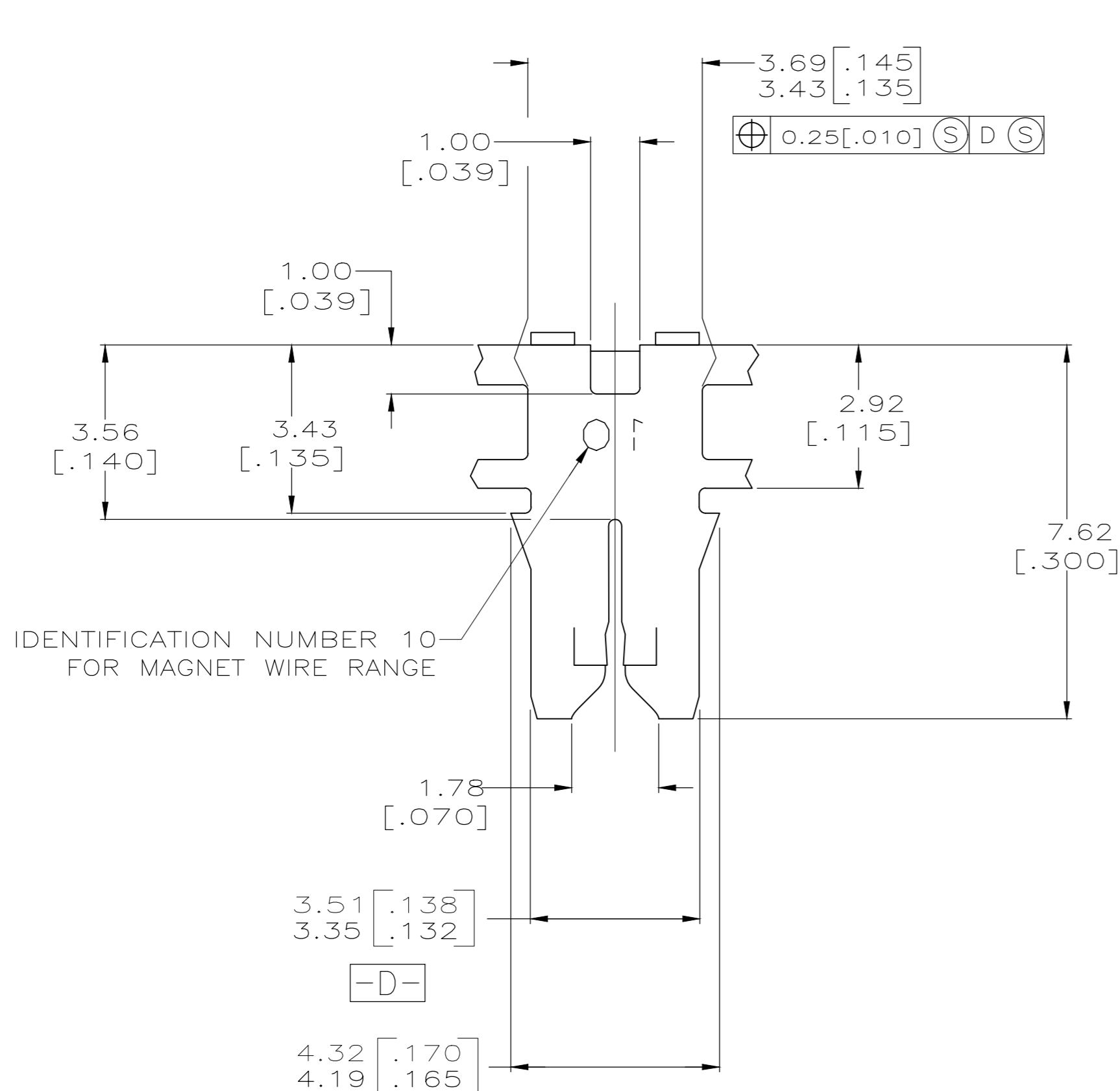

WITHOUT PAPER	1217182-1
REELING	PART NUMBER

THIS DRAWING IS A CONTROLLED DOCUMENT.		DWN	26JUL1999	 TE CONNECTIVITY	TERMINAL, POKE-IN, 300 SERIES MAG-MATE™
DIMENSIONS:		CHK	26JUL1999		
mm [INCHES]		APVD	26JUL1999		
TOLERANCES UNLESS OTHERWISE SPECIFIED:		NAME			
0 PLC	±-	KURT A. RANDOLPH		PRODUCT SPEC	108-2012
1 PLC	±-			APPLICATION SPEC	114-2046
2 PLC	±0.25[.010]			SIZE	A2
3 PLC	±-			CAGE CODE	00779
4 PLC	±-			DRAWING NO	1217182
ANGLES	±-			RESTRICTED TO	-
MATERIAL	4M BRASS	FINISH	0.002032[.000080]	SCALE	10:1
		MIN TIN PLATE		SHEET	1 OF 1
				REV	B1
				CUSTOMER DRAWING	

1217182