

PART NUMBER	REV	FIRST USED
567940-1	C	854040-3

TERMINAL NAME: TAB					
VISIBLE PAD LTR	CRIMP HEIGHT	WIRE SIZE			
A	.039 ±.002 [0.99 ±0.05mm]	20			
B	NOT	USED			
C	NOT	USED			
D	NOT	USED			
CRIMP	SIZE	TYPE	RANGE		
WIRE	.062 [1.57mm]	F	20		
INSUL	.090 [2.29mm]	F	-		
WIRE STRIP LENGTH	TERM APPL SPEC	FEED	APPL INSTRUCTION	SET UP GAGE	LAYOUT
.172-.203	NONE	.395	SEE CUSTOMER MANUAL	NONE	L1975

SIM TO HDM NONE						
QTY	REV	U/M	DWG SIZE	PART NO	DESCRIPTION	ITEM NO
1	-	B		694433-2	PAWL, FEED	56
2	-	A		356734-1	HOLDER, DEPRESSOR	54
2	-	A		1-23147-2	SPRING	53
2	-	A		1213548-1	DEPRESSOR	52
1	-	A		811242-2	BUMPER, HOLDDOWN	51
1	-	A		690753-1	SPACER, TONKER	50
1	-	A		690602-6	CAM, PRE-FEED 1.62 STROKE	48
1	-	A		690191-1	PLUG, NYLON	45
1	-	C		819307-6	RAM	44
1	-	A		690125-1	WASHER, LAMINATED	43
1	-	A		690124-6	WASHER, RAM	42
1	-	A		690686-2	BOLT, CRIMPER (5/16x1.00)	41
1	-	A		23241-6	BALL, STEEL	40
1	-	A		690170-1	SPRING, COMPRESSION	39
1	-	C		690142-2	DISC, INSULATION	38
1	-	D		354777-1	WIRE DISC, PLASTIC	37
1	-	A		22480-5	WASHER, SPRING	36
1	-	B		690212-1	POST, RAM	35
1	-	B		690786-1	SUPPORT, TERMINAL	34
1	-	C		1213547-1	PLATE, BASE SPECIAL	33
1	-	A		690432-3	SCREW, ADJUSTMENT	32
1	-	B		462543-1	BLOCK, SCREW SPECIAL	31
1	-	B		455689-1	BLOCK, STRIP GUIDE ADJ	30
1	-	C		455671-1	PLATE, STRIP GUIDE	29
2	-	A		1-22284-0	SPRING, DRAG	27
1	-	B		690546-1	LEVER, DRAG RELEASE	26
1	-	B		240792-1	DRAG, TERMINAL	25
1	-	D		6-690504-2	GUIDE, STRIP (REAR)	24
1	-	A		690438-1	GUIDE, STRIP (FRONT)	23
1	-	A		463756-1	GUIDE, SCRAP	21
1	-	B		1213546-1	DEPRESSOR, SHEAR	20
1	-	C		904458-2	STRIPPER	19
1	-	B		904225-1	JAW ASSY	18
1	-	A		5-240641-9	SPACER	16
1	-	A		1-21989-4	SCREW, SHLD	15
2	-	A		904274-1	DEPRESSOR	14
2	-	A		4-22281-4	SPRING	13
1	-	B		5-22280-0	SPRING, SHEAR	12
1	-	B		1-690461-6	STOP, SHEAR (FRONT)	11
1	-	B		462548-1	HOLDER, SHEAR (FRONT) SP	10
1	-	B		462547-4	SHEAR, FLOAT (FRONT) SP	9
1	-	C		662184-3	ANVIL	8
1	-	A		904273-1	DEPRESSOR, SHEAR (FRONT) SP	5
1	-	C		1-238011-0	SPACER, CRIMPER	4
1	-	C		1213549-1	CRIMPER, INSULATION	3
2	-	A		455888-2	SPACER, CRIMPER	2
1	-	C		6-458141-5	CRIMPER, WIRE	1

QTY	REV	U/M	DWG SIZE	PART NO	DESCRIPTION	ITEM NO
2	-	C		4-354779-4	PIN, WIRE DISC (.3210)C	129
1	-	A		986950-1	WASHER, FLAT PRECISION	125
1	-	A		217238-3	GENERAL INSTRUCTION PACKAGE	124
1	-	A		4-21028-0	PIN, SLT SPR (Ø.093x.75) ST GDE PL	121
1	-	B		690701-2	PLATE, SERIAL NO.	120
2	-	A		21899-2	WASHER, FLAT (#10) S G ADJ BLK	119
2	-	A		21024-5	WASHER, LOCK (#10) ADJ BLOCK	118
2	-	A		21024-2	WASHER, LOCK (#4) FRONT STP GUIDE	114
REF	-	A		21024-4	WASHER, LOCK (#8) FEED FINGER	113
2	-	A		21024-4	WASHER, LOCK (#8) DEP-HOLD	112
REF	-	A		21024-4	WASHER, LOCK (#8) STRIPPER	111
1	-	A		21018-5	NUT, HEX (#6) HOLD DOWN	108
1	-	A		21009-2	SCR, SKT 5ET (1/4-20x.25 LW) RAM	103
4	-	A		21017-2	SCR, DRIVE (#2x.19) ID PLATE	101
1	-	B		819347-1	PLATE, IDENTIFICATION	100
2	-	A		3-21002-0	SCR, BHC (10-32x.88) DRAG	99
1	-	A		22733-8	SCR, BHC (8-32x.38 LW) ANVIL	98
1	-	A		3-21000-8	SCR, SHC (10-32x.88) MOUNTING	96
1	-	A		2-21002-7	SCR, BHC (10-32x.50) 56 ADJ BLK	95
6	-	A		2-21002-2	SCR, BHC (8-32x.50) SHEAR-TERM SUP	94
1	-	A		1-21002-7	SCR, SHC (6-32x.50) CAM	91
4	-	A		2-21000-7	SCR, SHC (8-32x.50) SCR BLK	90
REF	-	A		2-22603-0	SCR, HEX HD (8-32x.31) FEED FINGER	86
2	-	A		1-21000-3	SCR, SHC (4-40x.25) F ST GUIDE	85
REF	-	A		22733-9	SCR, BHC (8-32x.50 SL) STRIPPER	84
1	-	A		3-22603-1	SCR, HEX (10-32x.38) 56 ADJ BL	81
2	-	B		463310-5	BLADE, STRIPPING (#20)	77
1	-	A		690603-1	SPRING, ASSIST	74
1	-	A		23030-1	SCR, SKT CAP (6-32x.25) CP DSC	73

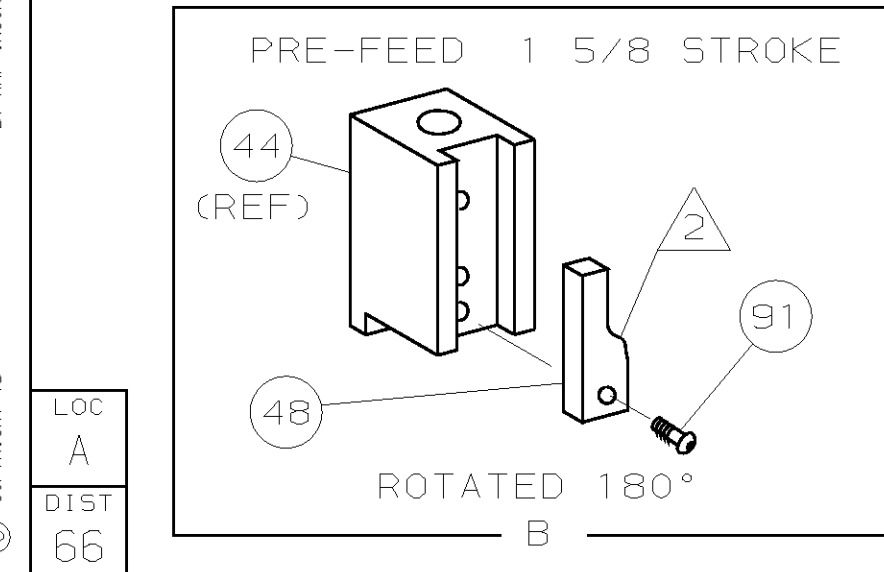
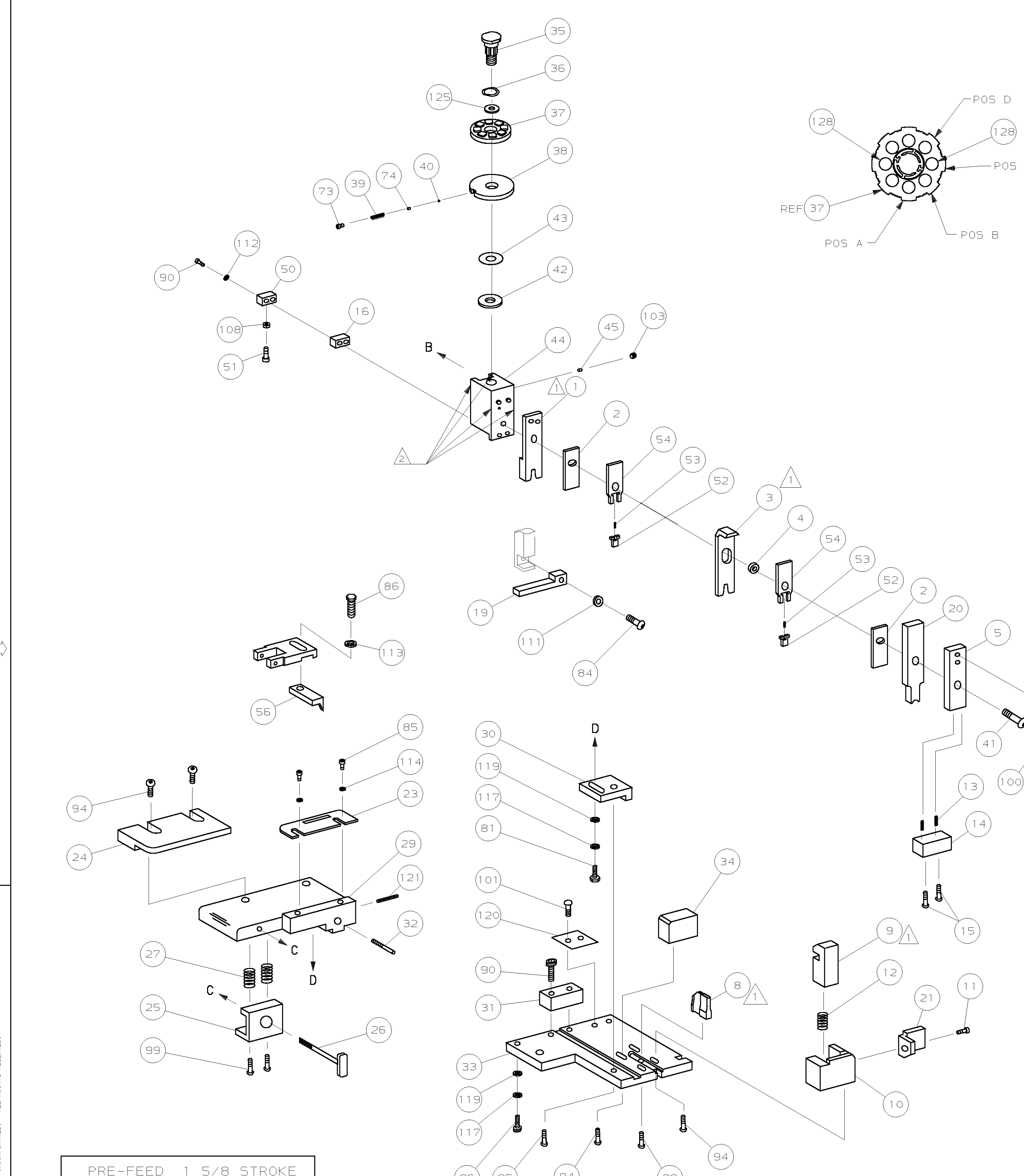

- 1 RECOMMENDED SPARE PARTS.
- 2 GREASE LIGHTLY.
- 3 ITEM NOT SHOWN
- 4 ITEM 18 IS TO BE INSTALLED TO CLEAR THE FLOATING SHEAR HOLDER ITEM 10.

5. ON THE STRIPPER CRIMPER MACHINE, POSITION THE FRONT METAL GUARD ON THE FRONT SIDE OF THE LEXAN DOOR

THIS DRAWING IS A CONTROLLED DOCUMENT.

THIS DRAWING IS UNRELEASED. RELEASED FOR PUBLICATION BY AMP INCORPORATED. ALL RIGHTS RESERVED. LOC A DIST 66

DIMENSIONS IN INCHES. DO NOT SCALE PRINT. TOLERANCES UNLESS OTHERWISE SPECIFIED:		MATL	HT TR	FIN
2 PLC DEC ±	3 PLC DEC ±	DR B.HIGMAN	APP T.ELBIN	
4 PLC DEC ±	ANGLES ±	CHK C.ERISMAN	REL -	
SURF TEXTURE: REMOVE BURRS, BREAK SHARP EDGES R.015 MAX		AMP Incorporated Harrisburg, PA 17105-3608		
NAME STRIPPER CRIMPER APPLICATOR		MACHINE REF STRIPPER CRIMPER		
SCALE	DWG NO 567940	SHEET 1 OF 1		REV C1
CASE CODE 00779		CUSTOMER AND ASSEMBLY DRAWING		RESTRICTED TO