

### Mechanical Dimensions: Inches [mm]

Tolerances  $\pm 0.012$  [0.1] Unless Otherwise Specified

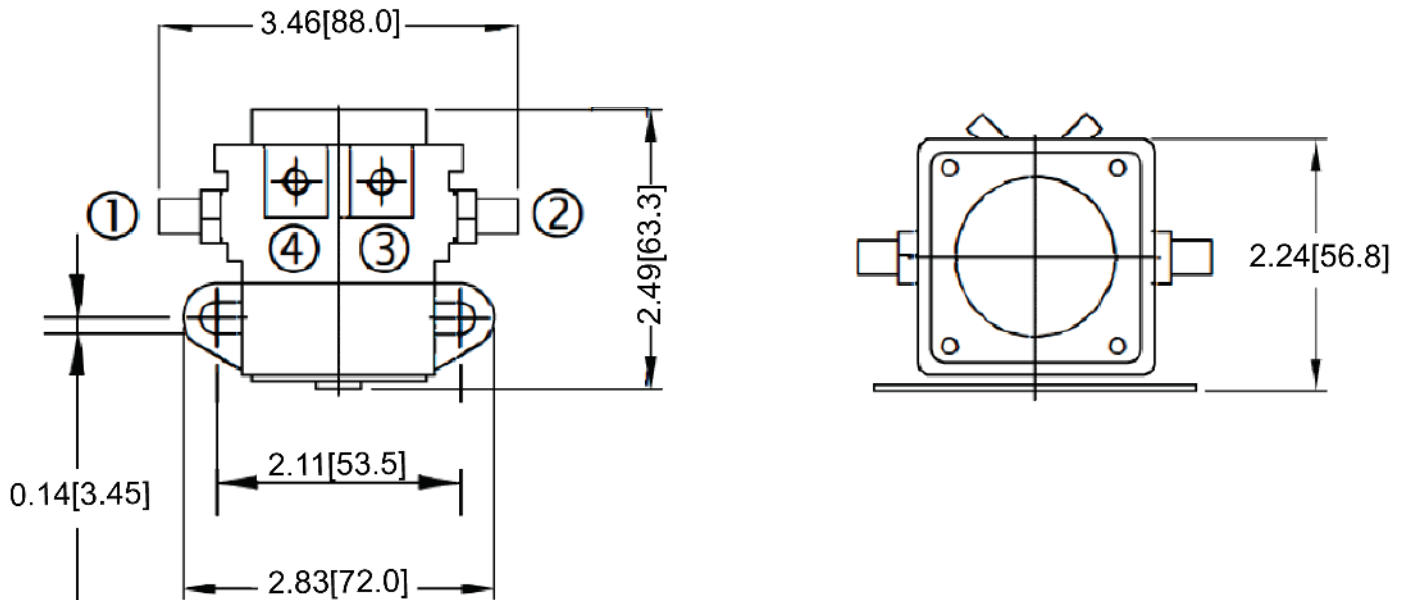

### Circuit Diagram

Intermittent Duty. Grounded base

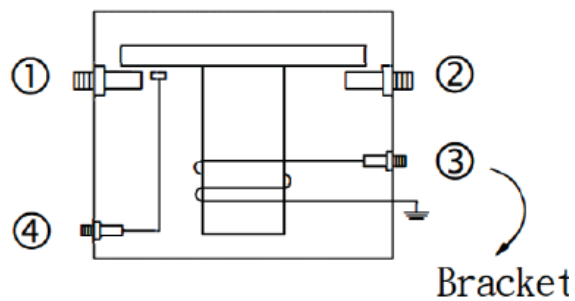

### Electrical Specifications

Make and Break Rating	24VDC 100A
Coil Resistance	$16 \pm 1$ Ohm
Operating Voltage	<20VDC
Release Voltage	>4.8VDC
Operation Temperature	-40°C~80°C

### Material Specifications

Phenolic body	
Copper terminals	
5/16"-18 Thread terminals with lock washers	
Mechanical Life	500,00
Electrical Life	50,000

Rev	Date of issue	Revision Notes	Designed	Approved
B	03-09-2020	Initial Drawing	RC	OF