

PART NUMBER	REV	FIRST USED
466905-1	AA	854040-3

TERMINAL NAME:	
AMP MODU MOD IV & V	
	85969
	86492
	87195
	87309
	87523
	102680
	87354
	103847
	FORIEGN
	141097
	141760
TERM APPL SPEC 114-25003	

VISIBLE PAD LTR	CRIMPING DATA		
	CRIMP HEIGHT	WIRE SIZE	
A	.027 ±.002	24	
B	NOT	USED	
C	.035 ±.002	20	
D	.031 ±.002	22	
CRIMP	SIZE	TYPE	RANGE
WIRE	.055	F	24-22 Δ_3
INSUL Δ_4	.062	F	.055 MAX
FEED	APPL INST	SET UP GAGE	LAYOUT
.300	SEE CUSTOMER MANUAL	-	484A
WIRE STRIP LENGTH .141-.188			

SIM TO HOM 466562

466905

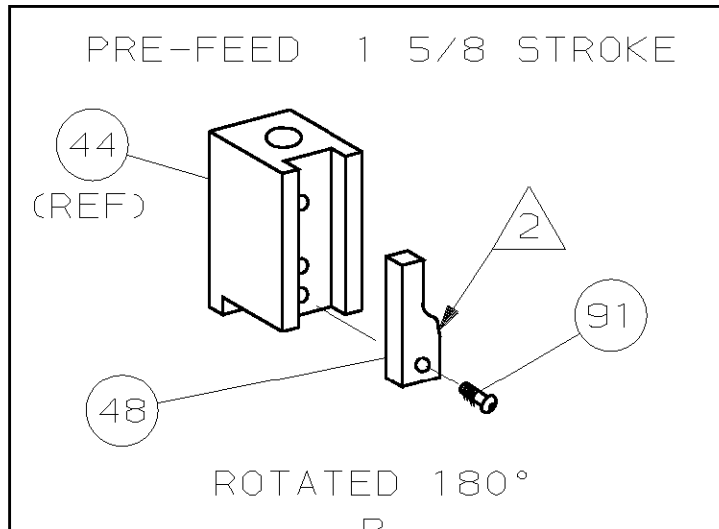
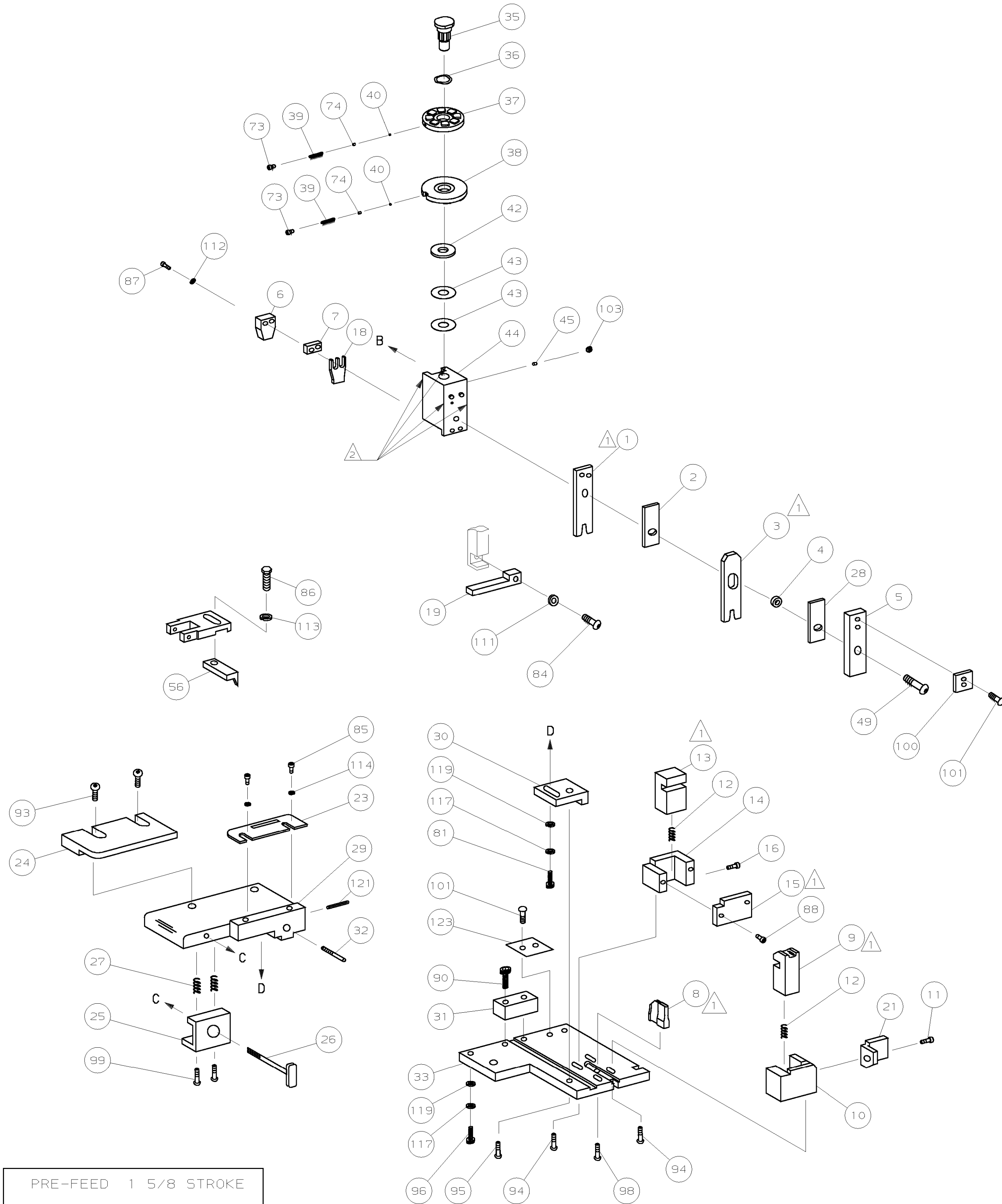

- Δ_1 RECOMMENDED SPARE PARTS.
- Δ_2 GREASE LIGHTLY.
- Δ_3 WIRE SIZE #20 ONLY WHEN APPROVED BY APPLICATOR ENG.
- Δ_4 INSUL CRIMP HEIGHT .062 MAX.

					125
					124
1	-	B	690701-2	PLATE, SERIAL NO.	123
					122
1	-	A	4-21028-0	PIN, SLT SPR (#10x.75) ST GDE PL	121
					120
2	-	A	21899-2	WASHER, FLAT (#10) S G ADJ BLK	119
					118
2	-	A	21024-5	WASHER, LOCK (#10) ADJ BLOCK	117
					116
					115
2	-	A	21024-2	WASHER, LOCK (#4) FRONT STP GUIDE	114
REF	-	A	21024-4	WASHER, LOCK (#8) FEED FINGER	113
2	-	A	21024-4	WASHER, LOCK (#8) DEP-HOLD	112
REF	-	A	21024-4	WASHER, LOCK (#8) STRIPPER	111
					110
					109
					108
					107
					106
					105
					104
1	-	A	21009-2	SCR, 5KT SET (1/4-20x.25 LW) RAM	103
					102
4	-	A	21017-2	SCR, DRIVE (#2x.19) ID PLATE	101
1	-	B	819347-1	PLATE, IDENTIFICATION	100
2	-	A	2-21002-9	SCR, BHC (10-32x.75) DRAG	99
1	-	A	22733-8	SCR, BHC (8-32x.38 LW) ANVIL	98
					97
1	-	A	3-21000-8	SCR, SHC (10-32x.88) MOUNTING	96
1	-	A	2-22733-1	SCR, BHC (10-32x.50) SG ADJ BLK	95
4	-	A	22733-9	SCR, BHC (8-32x.50) SHEAR-TERM SUP	94
2	-	A	2-21002-2	SCR, BHC (8-32x.50) R STP GDE	93
					92
					91
1	-	A	1-21002-7	SCR, SHC (6-32x.50) CAM	90
2	-	A	2-21000-7	SCR, SHC (8-32x.50) SCR BLK	89
					88
2	-	A	1-21000-8	SCR, SHC (6-32x.25) REAR SHEAR PL	87
2	-	A	2-21000-8	SCR, SHC (8-32x.62) DEP-HOLD DOWN	86
REF	-	A	2-22603-0	SCR, HEX HD (8-32x.31) FEED FINGER	85
2	-	A	1-21000-3	SCR, SHC (4-40x.25) F ST GUIDE	84
REF	-	A	22733-9	SCR, BHC (8-32x.50 SL) STRIPPER	83
					82
					81
1	-	A	3-21000-4	SCR, SHC (10-32x.38) SG ADJ BL	80
					79
					78
2	-	B	463310-6	BLADE, STRIPPING (#22)	77
					76
					75
2	-	A	690603-1	SPRING, ASSIST	74
2	-	A	23030-1	SCR, SHC (6-32x.25) CP DISC	73
					72
					71

REF	QTY	REV	PART NO	DESCRIPTION	ITEM NO
					70
					69
					68
					67
					66
					65
					64
					63
					62
					61
					60
					59
					58
					57
					56
					55
					54
					53
					52
					51
					50
1	-	A	7-21002-9	BOLT, CRIMPER (5/16x1.00)	49
1	-	A	690602-6	CAM, PRE-FEED 1.62 STROKE	48
					47
					46
1	-	A	690191-1	PLUG, NYLON	45
1	-	C	455673-1	RAM	44
2	-	A	690125-1	WASHER, LAMINATED	43
1	-	A	690124-1	WASHER, RAM	42
					41
2	-	A	23241-6	BALL, STEEL	40
2	-	A	690170-1	SPRING, COMPRESSION	39
1	-	C	690142-1	DISC, INSULATION	38
1	-	B	5-455829-9	DISC, WIRE	37
1	-	A	22480-5	WASHER, SPRING	36
1	-	B	690212-1	POST, RAM	35
					34
1	-	C	462544-1	PLATE, BASE SPECIAL	33
1	-	A	690432-3	SCREW, ADJUSTMENT	32
1	-	B	462543-1	BLOCK, SCREW SPECIAL	31
1	-	B	455689-1	BLOCK, STRIP GUIDE ADJ	30
1	-	C	455671-5	PLATE, STRIP GUIDE	29
1	-	C	1-455888-0	SPACER, FRONT SHEAR DEP	28
2	-	A	1-22282-3	SPRING, DRAG	27
1	-	B	690546-1	LEVER, DRAG RELEASE	26
1	-	B	679754-1	DRAG, TERMINAL	25
1	-	D	6-690504-4	GUIDE, STRIP (REAR)	24
1	-	A	690438-1	GUIDE, STRIP (FRONT)	23
					22
1	-	A	463756-1	GUIDE, SCRAP	21
					20
1	-	C	462615-6	STRIPPER	19
1	-	B	690518-1	HOLDER, TERMINAL	18
					17
1	-	A	690461-1	STOP, SHEAR (REAR)	16
1	-	B	1-690691-1	PLATE, SHEAR (REAR)	15
1	-	B	681023-1	HOLDER, SHEAR (REAR)	14
1	-	C	690463-1	SHEAR, FLOAT (REAR)	13
2	-	A	5-22280-0	SPRING, SHEAR	12
1	-	B	690461-2	STOP, SHEAR (FRONT)	11
1	-	B	462548-1	HOLDER, SHEAR (FRONT) SP	10
1	-	B	462547-1	SHEAR, FLOAT (FRONT) SP	9
1	-	C	805887-1	ANVIL	8
1	-	C	4-240641-1	SPACER, DEPRESSOR (REAR)	7
1	-	B	690468-1	DEPRESSOR, SHEAR (REAR)	6
1	-	A	462838-1	DEPRESSOR, SHEAR (FRONT) SP	5
1	-	B	238011-8	SPACER, BLOCK CRIMPER	4
1	-	C	9-456134-8	CRIMPER, INSULATION	3
1	-	C	455888-3	SPACER, CRIMPER	2
1	-	C	217885-1	CRIMPER, WIRE	1

REV	U/M	DWG SIZE	PART NO	DESCRIPTION	ITEM NO
-1					

REV	U/M	DWG SIZE	PART NO	DESCRIPTION	ITEM NO
-1					

LOC A
DIST 66

AMP 1756 REV 12-89 15-JUN-01 08:29:04 amp14442

AMP Incorporated Harrisburg, PA 17105-3608

STRIPPER CRIMPER APPLICATOR

SCALE: 1 OF 1 REV AA

CUSTOMER AND ASSEMBLY DRAWING

THIS DRAWING IS A CONTROLLED DOCUMENT.

RELEASED FOR PUBLICATION JUN 23, 1998 BY AMP INCORPORATED. ALL RIGHTS RESERVED. © COPYRIGHT 1998