

PART NO.	LENGTH
847341002	1.50M +31.75/-0 (4' 11.06") +1.25"/-0"
847341001	2.00M +44.45/-0 (6' 6.75") +1.75"/-0"
847341003	3.00M +63.50/-0 (9' 10.12") +2.50"/-0"
847341004	5.00M +101.60/-0 (16' 4.85") +4.00"/-0"
847341005	0.15M +25.40/-0 (0' 5.91") +1.00"/-0"
847341905	0.27M +19mm-0 (0' 10.63") +.75"-0"

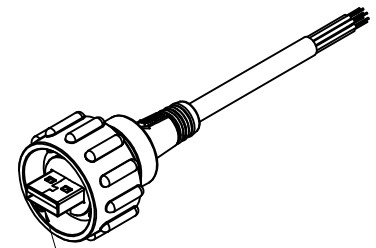

BAYONET STYLE LOCKING INTERFACE

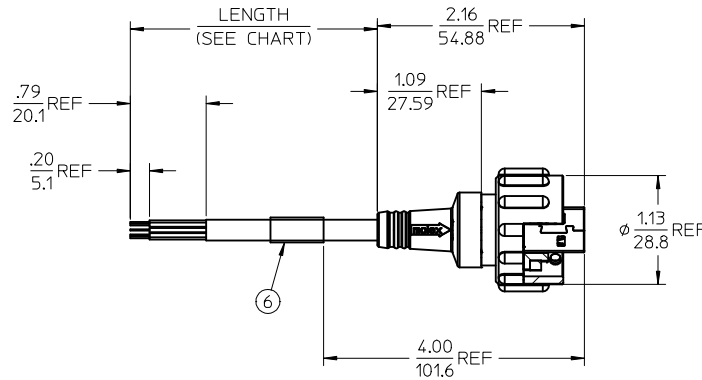

NOTES:

1. MATERIAL: SEE TABLE
2. FINISHES: SEE TABLE
3. CABLES:

A) CABLE FOR ASSEMBLIES ≤0.8M (800mm) LG;  
 OUTER JACKET: PVC,  $\phi 5.50 \pm 0.3$ , BLACK  
 (2) 28AWG SHIELDED TWISTED PAIRS WITH ALUMINUM/MYLAR SHIELD.  
 WITH STRANDED TINNED COPPER DRAIN WIRE.  
 (1) 28AWG SHIELDED TWISTED PAIR WITH ALUMINUM SHIELD.  
 (2) 28AWG INSULATED CONDUCTORS, STRANDED, TINNED COPPER  
 CABLE SHIELD: BRAIDED TINNED COPPER WIRE  
 CABLE: UL2725 FILE: E164571

B) CABLE FOR ASSEMBLIES >0.8M(800mm)LG;  
 OUTER JACKET: PVC,  $\phi 6.50 \pm 0.3$ , BLACK  
 (2) 26AWG SHIELDED TWISTED PAIRS WITH ALUMINUM/MYLAR SHIELD.  
 WITH STRANDED TINNED COPPER DRAIN WIRE.  
 (1) 28AWG SHIELDED TWISTED PAIR WITH ALUMINUM/MYLAR SHIELD.  
 (2) 22AWG CONDUCTORS STRANDED TINNED COPPER  
 CABLE SHIELD: BRAIDED TINNED COPPER WIRE  
 CABLE: UL2725 FILE: E164571

4. CABLE TEMPERATURE: 80°C, VOLTAGE: 30V & FLAME RATING: VW-1 RATING
5. CABLE LENGTHS GREATER THAN USB3.0 SPECIFICATION SHALL BE END USER QUALIFIED IN APPLICATION.
6. CONNECTOR MEETS USB3.0 SPECIFICATION.
7. CONNECTOR TESTED FOR CONTINUITY.
8. TYPE A CONNECTOR:  
 SHELL: PHOSPHOR BRONZE, NI PLATED  
 CONTACTS: PHOSPHOR BRONZE, GOLD PLATED 30MICRONS MIN. OVER NICKEL.
9. PLUG CONNECTOR MATES WITH MOLEX USB3.0 RECEPTACLE 84733
10. PLUG CONNECTOR MATES WITH DUST CAP 847000003
11. CONNECTOR IS RATED IP67 WHEN MATED TO A MOLEX DUST CAP OR MOLEX MATING CONNECTOR.
13. ASSEMBLY IS RoHS COMPLIANT

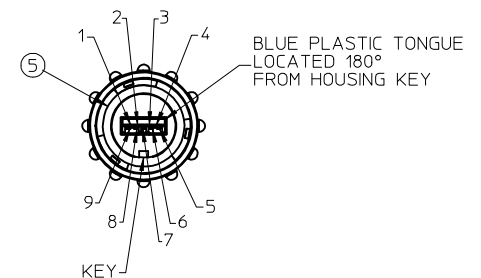
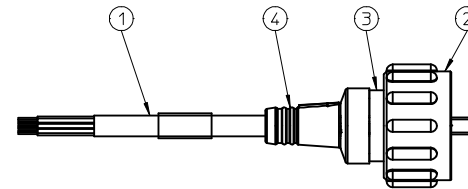

PIN OUT

P1	Color	Signal	Notes
1	RED	VBUS	
2	WHITE	D-	
3	GREEN	D+	
4	BLACK	GND	
5	BLUE	StdA_SSRX-	
6	YELLOW	StdA_SSRX+	
7	DRAIN WIRE		H.S. TUBING
8	PURPLE	Std_SSTX-	
9	ORANGE	Std_SSTX+	
SHELL		BRAID	H.S. TUBING

ITEM	QTY.	DESCRIPTION	MATERIAL	FINISH
6	1	WRAP LABEL	PLASTIC FILM	YELLOW
5	1	GASKET SEAL	NITRILE	BLACK
4	1	OVERMOLD	PVC	BLACK
3	1	HOLDER	POLYESTER	BLACK
2	1	COUPLING RING	POLYESTER	BLACK
1	1	USB TYPE-A PLUG SHIELDED PIGTAIL	BRASS/PLASTIC	N/A

<b>UPDATE NOTES</b> EC NO: IPGZ2015-0592 DRW:BRUPERT 2015/02/24 CHKD: APPR: BWOODMAN 2015/05/22	QUALITY SYMBOLS ▽=0 ▽=0	GENERAL TOLERANCES (UNLESS SPECIFIED) <table border="1"> <thead> <tr> <th></th> <th>mm</th> <th>INCH</th> </tr> </thead> <tbody> <tr> <td>4 PLACES</td> <td>± .005</td> <td>± .0005</td> </tr> <tr> <td>3 PLACES</td> <td>± .005</td> <td>± .0005</td> </tr> <tr> <td>2 PLACES</td> <td>± 0.13</td> <td>± .010</td> </tr> <tr> <td>1 PLACE</td> <td>± 0.3</td> <td>± .010</td> </tr> <tr> <td>0 PLACE</td> <td>± .005</td> <td>± .0005</td> </tr> </tbody> </table>		mm	INCH	4 PLACES	± .005	± .0005	3 PLACES	± .005	± .0005	2 PLACES	± 0.13	± .010	1 PLACE	± 0.3	± .010	0 PLACE	± .005	± .0005	DIMENSION STYLE <b>IN/MM</b>	SCALE <b>1:1</b>	DESIGN UNITS <b>INCH</b>	THIRD ANGLE PROJECTION
		mm	INCH																					
	4 PLACES	± .005	± .0005																					
	3 PLACES	± .005	± .0005																					
2 PLACES	± 0.13	± .010																						
1 PLACE	± 0.3	± .010																						
0 PLACE	± .005	± .0005																						
DRAWN BY: BRUPERT DATE: 2014/03/17 CHECKED BY: DATE:		APPROVED BY: BWOODMAN DATE: 2014/03/25		<b>USB3.0 PLUG CABLE ASSY</b>																				
MATERIAL NO. <b>SEE CHART</b>		DOCUMENT NO. <b>SD-84734-001</b>			SHEET NO. <b>1 OF 1</b>																			
DRAFT WHERE APPLICABLE MUST REMAIN WITHIN DIMENSIONS																								