

1

2

3

4

5

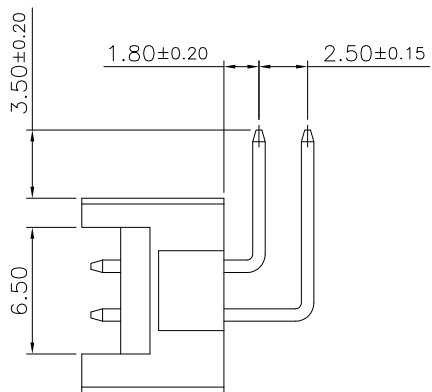
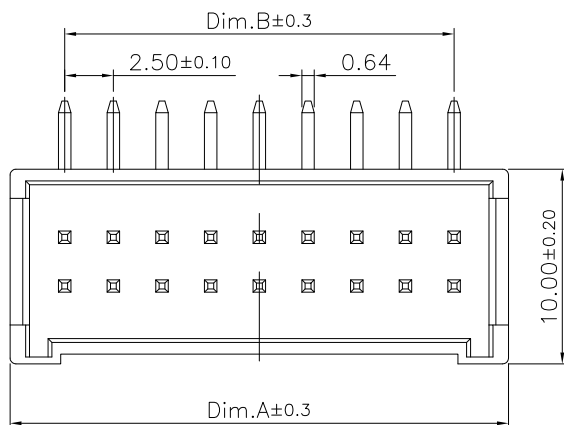

## Specifications:

Current Rating: 3.0A AC,DC  
 Voltage Rating: 250V AC,DC  
 Contact Resistance: 20m ohm.Max  
 Insulation Resistance: 1000M ohm.Min  
 Withstanding Voltage: 1000V AC/Minute  
 Operating Temperature Range: -25°C ~ +85°C

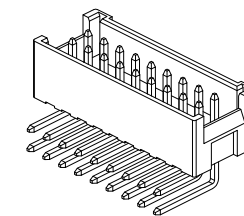

## Material:

Insulator: Nylon 66+15%GF (UL94V-0)  
 Insulator Color: White  
 Terminal: Brass  
 Finish: Tin Plated

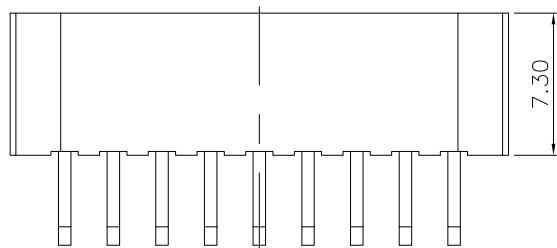

## Dimension Information:

Circuits	Dim.A	Dim.B
8	13.10	7.50
10	15.60	10.00
12	18.10	12.50
14	20.60	15.00
16	23.10	17.50
18	25.60	20.00
20	28.10	22.50

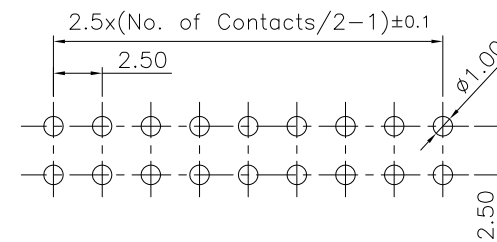

P.C.B Layout

RoHS Compliant

DRAWN:

GENERAL TOLERANCE:

.X=±0.20  
 .XX=±0.15

# CnC Tech

Industrial Cable and Connector Technology

CHECKED:

UNIT: MM

DESCRIPTION: WIRE-TO BOARD HEADER, 2.5mm,  
 R/A, TIN PLATED, SIDE LOCK

SIZE

APPROVAL:

SCALE: 1:1

SHEET: 1 / 2

PART NO:

53025-XX-0200-01

A4

REV

DATE

FILE

BY

PROJECTION:

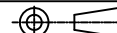

A

B

C

D