

LOC	DIST	P	F	ZONE	LTR	DESCRIPTION	DATE	APPD
AF	50					C1 REVISED PER ECR-19-014370	27SEP2019	JA-PKS

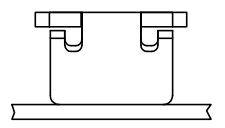

- 1 CONTINUOUS STRIP ON REELS WITH TERMINALS LOCATED ON 5.59±0.08 [.220±.003] CENTERS. SLOT ACCEPTS 0.36-0.57mm [#27-#23] AWG COPPER MAGNET WIRE. SINGLE OR DOUBLE WIRE OF THE SAME SIZE AND TYPE. ALUMINIUM RANGE IS 0.51-0.64 mm [#24-#22] AWG. ALUMINIUM WIRE RANGE APPLIES FOR POST TIN PLATED PARTS ONLY.
- 2 REELED ON PLASTIC REELS WITHOUT PAPER.

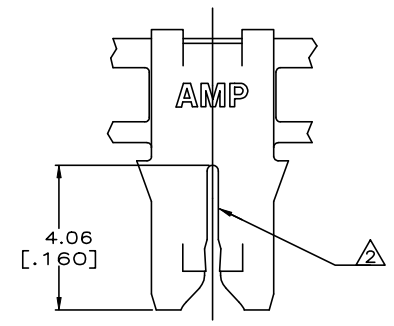
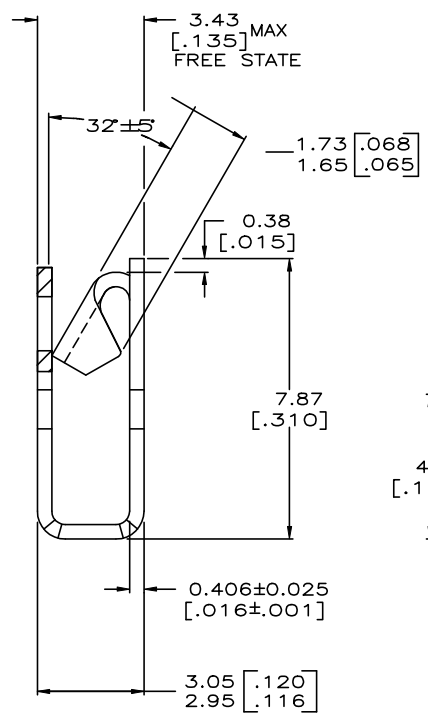
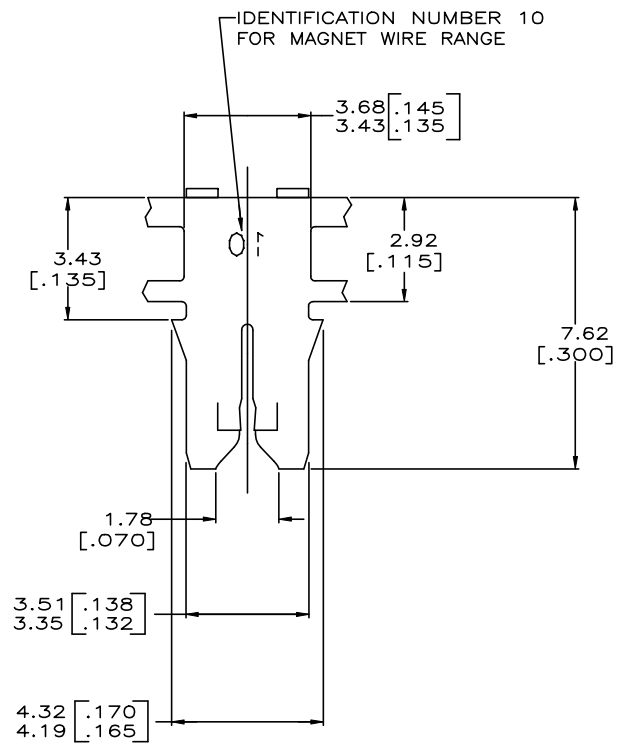

63754

DO NOT SCALE PRINT. UNLESS SPECIFIED		DR 10/22/93 MICHAEL S. FEHER		SPLICE FREE		3		63754-1	
DIMENSIONS IN mm [INCHES]		CHK 10/25/93 JEFF R. RUTH		SPLICE		REELING		PART NO	
TOLERANCES ON :		APPD 10/26/93 NELSON E. NEFF		TE Connectivity  NAME TERMINAL, POKE-IN, 300 SERIES MAG-MATE™					
2 PLC DEC ± 0.25 [.010]		APPD 10/26/93 TERRY L. SHUTTER							
3 PLC DEC ± -		PRODUCT SPEC 108-2012							
ANGLES ± -		APPLICATION SPEC 114-2046		SIZE C 00779		DRAWING NO C=63754		SHEET 10F 1	
MATERIAL 4M BRASS		WEIGHT -		SCALE 10:1					
FINISH 0.002032 [.000080] MIN TIN PLATE									

THIS DRAWING IS A CONTROLLED DOCUMENT FOR AMP INCORPORATED. IT IS SUBJECT TO CHANGE AND THE CONTROLLING ENGINEERING ORGANIZATION SHOULD BE CONTACTED FOR THE LATEST REVISION.