

F

E

D

C

B

A

F

E

D

C

B

A

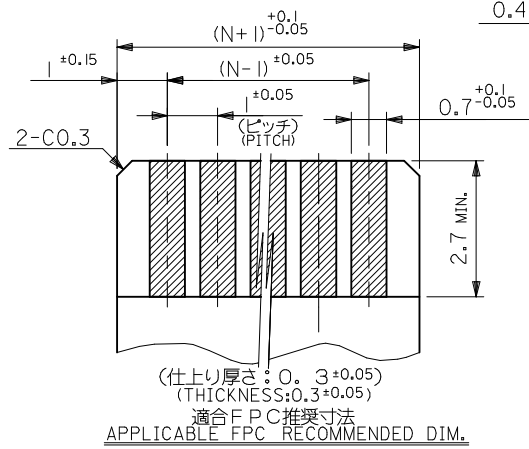
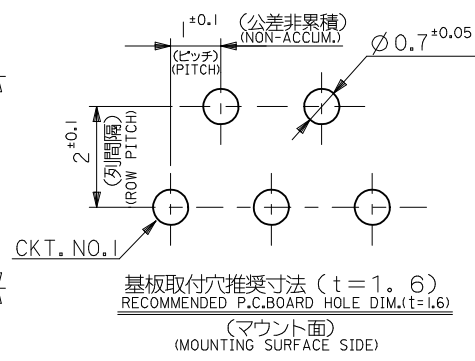
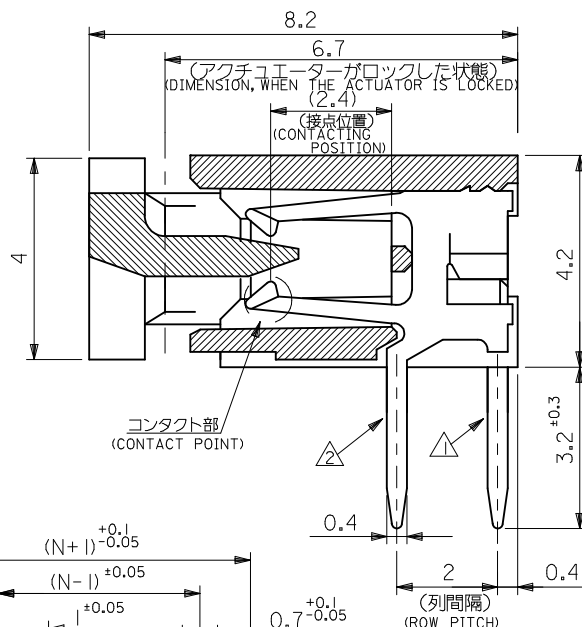
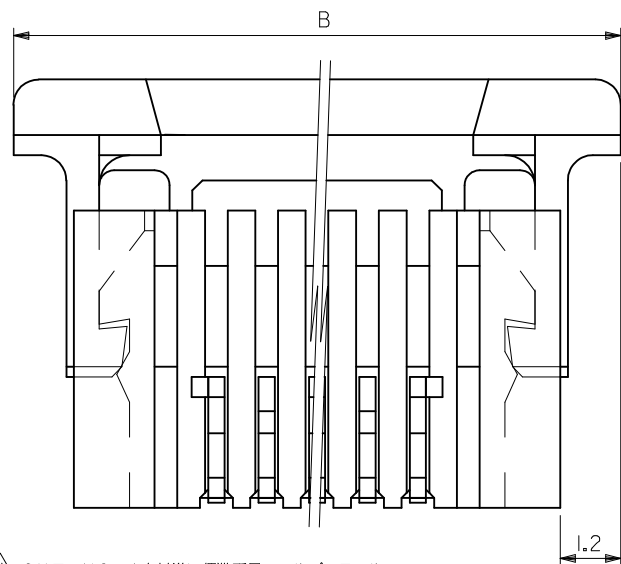
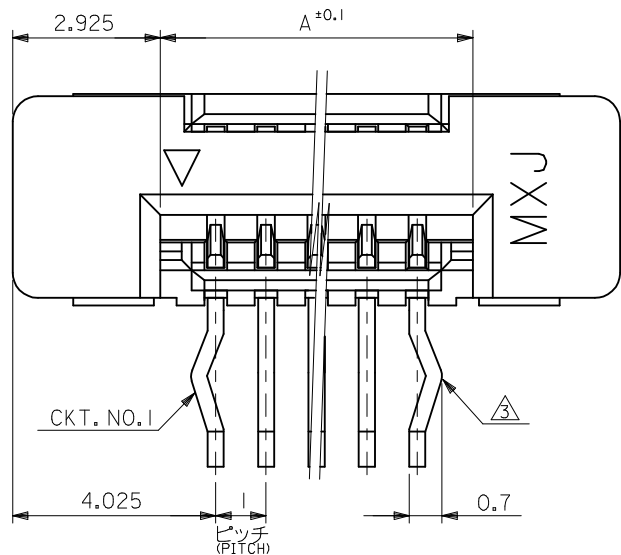

適合FPC推奨寸法
APPLICABLE FPC RECOMMENDED DIM.

FPCについて:
打抜き方向は導体側から補強板を推奨致します。補強フィルム材質はポリアイミドを推奨致します。
接着剤は熱硬化接着剤を推奨致します。
ABOUT FPC:
RECOMMENDED PUNCHER DIRECTION : FROM CONDUCTOR SIDE TO STIFFENER BOARD SIDE.
RECOMMENDED MATERIAL :
STIFFENER FILM : POLYIMIDE
BONDING AGENT :
THERMOSETTING BONDING AGENT

- 注記:
NOTES:
- ① CKT. NO. 1を基準に偶数番目のソルダータール。EVEN NUMBER SOLDER TAIL.
 - ② CKT. NO. 1を基準に奇数番目のソルダータール。ODD NUMBER SOLDER TAIL.
 - ③ ソルダータールキックは、△のソルダータールの両端部に設ける。KINK TO BE APPLIED FOR THE BOTH END OF ODD NUMBER SOLDER TAIL.
4. 材 料: ターミナル:リン青銅、ニッケル下地 銅ビスマスマメッキ (t=0.32)
MATERIAL: TERMINAL:PHOSPHOR BRONZE, TIN-BISMUTH OVER NICKEL PLATING (t=0.32)
ハウジング: 66ナイロン, UL94V-0
HOUSING: 66NYLON,UL94V-0
アクチュエーター: ポリエステル, UL94V-0
ACTUATOR: POLYESTER,UL94V-0
5. 本製品は 52043-**10 の鉛フリー品である。
THIS PRODUCT IS LEAD FREE OF 52043-**10.

| | | | |
|-----------|-----|--------------|------------|
| 11.05 | 5.2 | 52043-0419 | 4 |
| B | A | MATERIAL NO. | 極数 CKT. |
| MODEL NO. | | 52043-**19 | |

| | | | | | | | | | |
|---|--|-----------|--|----------------------|---|----------------------------------|---------------------------|--|--|
| REVISED EC NO: J2017-0269 DRWNGES 2016/11/17 CHKD: APPR:MSASAO 2016/12/26 | GENERAL TOLERANCES (UNLESS SPECIFIED) | | DIMENSION STYLE MM ONLY | | SCALE 10:1 | DESIGN UNITS METRIC | THIRD ANGLE PROJECTION | | |
| | 0.25 UNDER | UNDER | ± | DRAWN BY YWADA | DATE 2004/05/19 | TITLE 1.0 FPC CONN. Z.I.F R/A | | | |
| | 0.25 OVER | 0.5 UNDER | ± | CHECKED BY MSASAO | DATE 2004/05/19 | -LEAD FREE- molex | | | |
| | 0.5 OVER | 1.0 UNDER | ± | APPROVED BY | DATE | | | | |
| 0 OVER | 10 UNDER | ±0.2 | MATERIAL NO. SEE TABLE | | DOCUMENT NO. SD-52043-002 | SHEET NO. 1 OF 1 | | | |
| 10 OVER | 30 UNDER | ±0.25 | SIZE A3 | | THIS DRAWING CONTAINS INFORMATION THAT IS PROPRIETARY TO MOLEX ELECTRONIC TECHNOLOGIES, LLC AND SHOULD NOT BE USED WITHOUT WRITTEN PERMISSION | | | | |
| 30 OVER | | ±0.3 | DRAFT WHERE APPLICABLE MUST REMAIN WITHIN DIMENSIONS | | | | | | |