

PC card drilling dimensions(after plating)
(thickness ≤ 3.20±0.30mm)

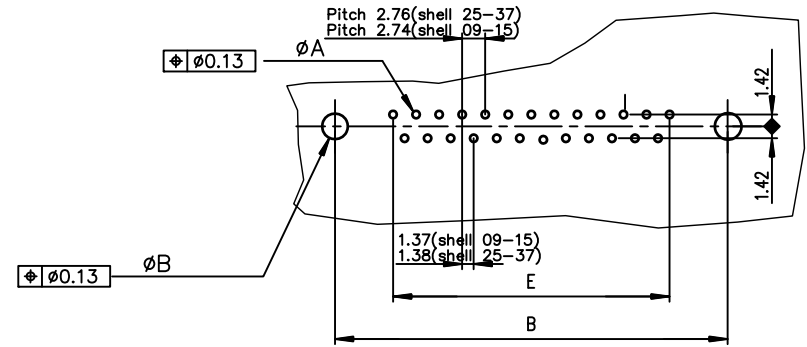

ROHS PART NUMBER

SHELL	A±0.38	B±0.12	C±0.10	D±0.25	E±0.07	PART NUMBER	PART NUMBER
09	30.81	24.99	16.96	16.21	10.96	D09S91C4GI00LF	D09S91C6GI00LF
15	39.14	33.32	25.18	24.54	19.18	D15S91C4GI00LF	D15S91C6GI00LF
25	53.03	47.04	39.12	38.25	33.12	D25S91C4GI00LF	D25S91C6GI00LF
37	69.32	63.50	55.68	54.71	49.68	D37S91C4GI00LF	D37S91C6GI00LF
						200 Mating	500 Mating

GENERAL CHARACTERISTICS AND ROHS INFORMATIONS:
SEE DRAWING C01-8646-0001

mat'l. code				surface ISO 1302 ✓		tolerance ISO 406 ISO 1101		projection		product family D-SUB	
ltr				ecn no		dr		date		title	
A				-		JAR		1996-09-17		FEMALE CONNECTOR DELTA D EUROPE	
B				LS05-004		MPE		2005-02-15		STRAIGHT PRESS-FIT	
C				LS06-0097		LGO		2006-07-28		scale 2:1	
D				LS06-0140		LGO		2006-09-22		dr	
E				111-0062		RPK		2011-04-05		engr	
F				ELX-I-24020		AAB		2016-06-06		chr	
										appd	
sheet index				revision		F				sheet 1 of 1	
				sheet		1				size A3	
										type Product Customer Drawing	