

P	LTR	DESCRIPTION	DATE	DWN	APVD
	E1	6 POS PART 1-282845-4 ADDED	29 JUN 2020	SS	PS

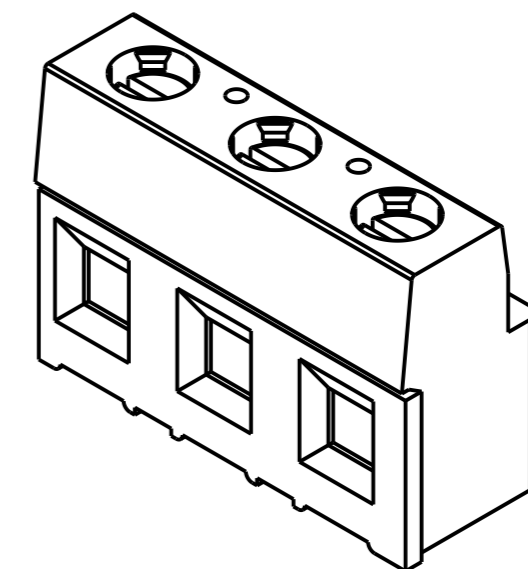

282845-3 AS SHOWN

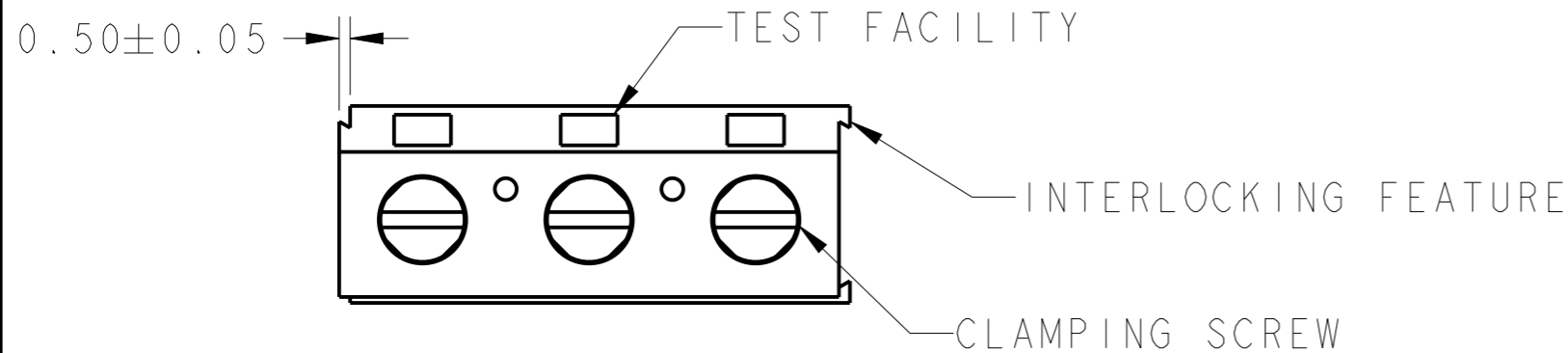
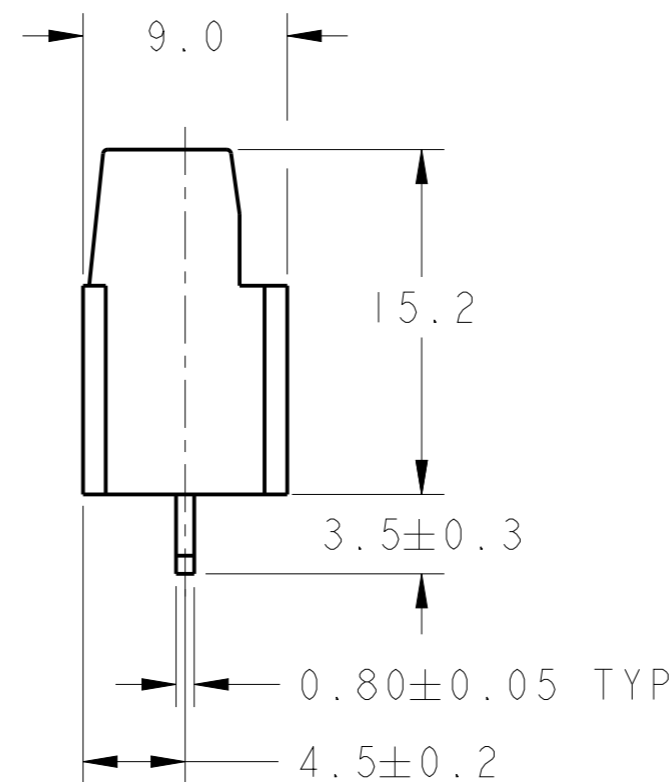
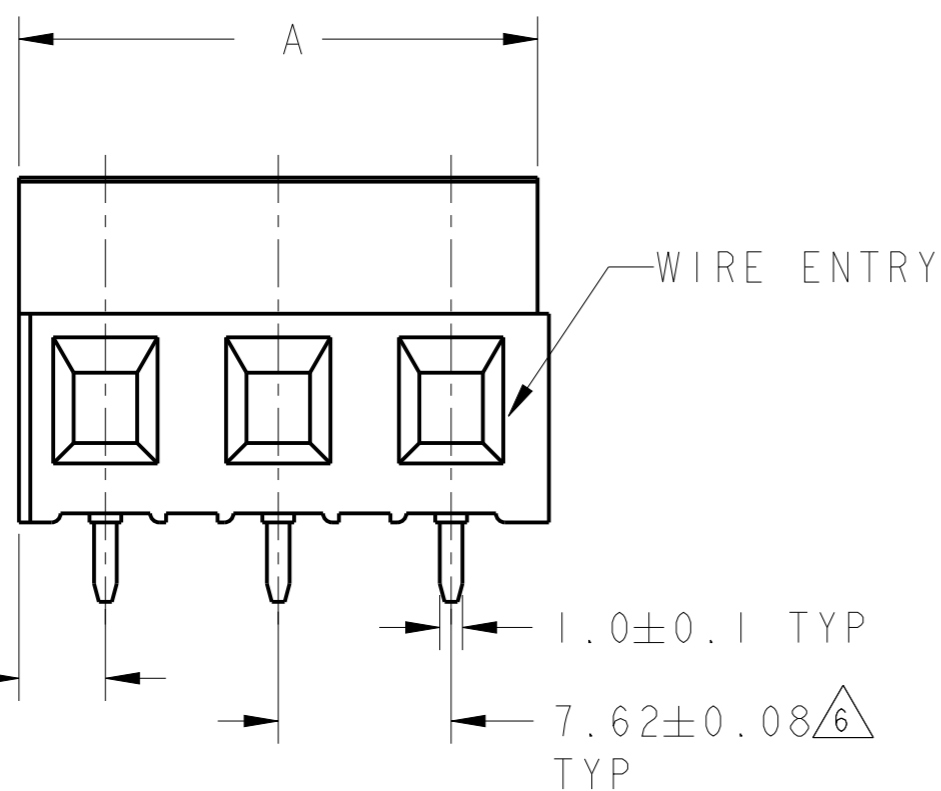

-	45.72	6	$\triangle 9$	1-282845-4
$\triangle 7$	SEE SHEET 2	22.86	3	1-282845-3
$\triangle 7$	SEE SHEET 2	68.58	9	$\triangle 8$ 1-282845-2
$\triangle 7$	SEE SHEET 2	22.86	3	1-282845-1
$\triangle 7$	SEE SHEET 2	15.24	2	1-282845-0
$\triangle 7$	SEE SHEET 2	15.24	2	282845-9
$\triangle 7$	SEE SHEET 2	22.86	3	282845-8
$\triangle 7$	SEE SHEET 2	15.24	2	282845-7
$\triangle 7$	SEE SHEET 2	15.24	2	282845-6
$\triangle 7$	SEE SHEET 2	22.86	3	282845-5
-	22.86	3		282845-3
-	15.24	2		282845-2
MARKING		DIM A	POS	PART NUMBER

RECOMMENDED PC BOARD LAYOUT

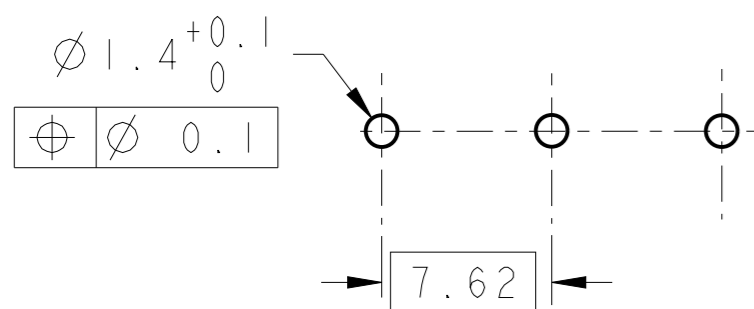

THIS DRAWING IS A CONTROLLED DOCUMENT.		DWN E. ZANOLINI 16AUG2001	 TE Connectivity	
DIMENSIONS: mm		CHK D. BIEVENOUR 16AUG2001		
TOLERANCES UNLESS OTHERWISE SPECIFIED:		APVD D. BIEVENOUR 16AUG2001	NAME TERMINAL BLOCK PCB MOUNT SIDE WIRE ENTRY, STACKING W/INTERLOCK, 7.62mm PITCH	
0 PLC $\pm$ -		PRODUCT SPEC	RESTRICTED TO	
1 PLC $\pm$ .3		APPLICATION SPEC	SIZE	CAGE CODE
2 PLC $\pm$ .25		114-20079	A3	00779
3 PLC $\pm$ -		WEIGHT	DRAWING NO	
4 PLC $\pm$ -		-	C=282845	
ANGLES $\pm$ -		CUSTOMER DRAWING	SCALE	SHEET
$\pm 2^\circ$			3:1	1 OF 2
MATERIAL $\triangle 1$	FINISH $\triangle 1$		REV	E1

P	LTR	DESCRIPTION	DATE	DWN	APVD
-		SEE SHEET 1	-	-	-

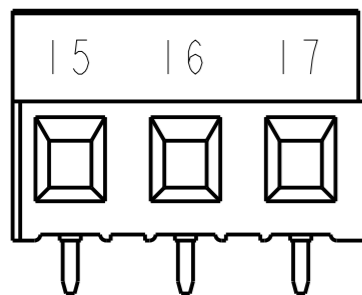

P/N 282845-5 AS SHOWN

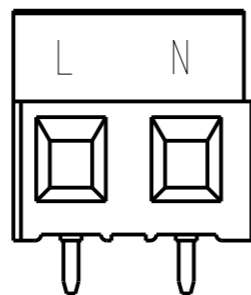

P/N 282845-6 AS SHOWN

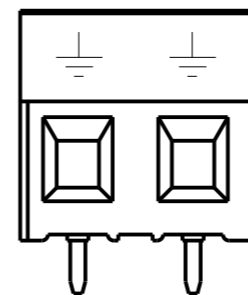

P/N 282845-7 AS SHOWN

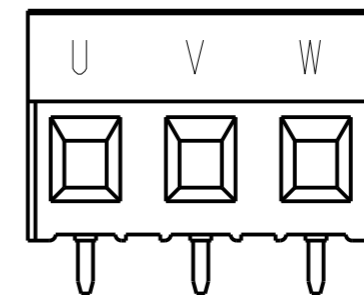

P/N 282845-8 AS SHOWN

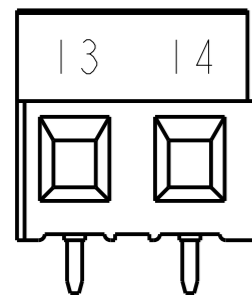

P/N 282845-9 AS SHOWN

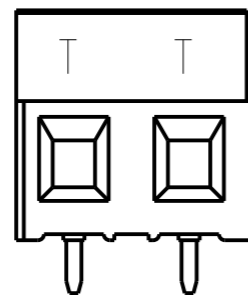

P/N 1-282845-0 AS SHOWN

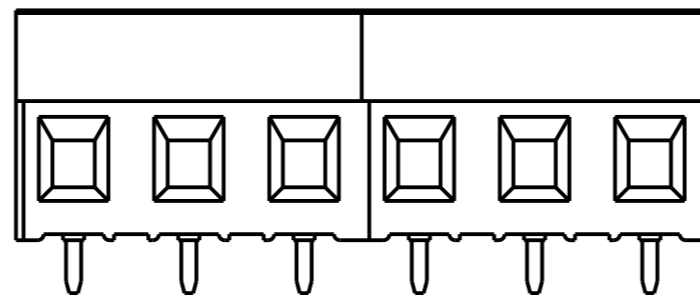

P/N 1-282845-4 AS SHOWN

1. MATERIALS AND FINISH  
 HOUSING: PA 6-6, UL 94-V0, COLOR GREEN.  
 CLAMP: BRASS, NICKEL PLATED.  
 TERMINAL: BRASS, TIN PLATED.  
 CLAMPING SCREW: M3, BRASS, NICKEL PLATED

- 2. SUITABLE FOR 1,6-2,4mm. PCB THICKNESS.
- 3. END-TO-END STACKABLE W/INTERLOCK WITHOUT LOSS OF CENTERLINE SPACING.
- 4. WIRE SIZE RANGE : 30-12 AWG
- 5. RECOGNIZED UNDER THE COMPONENT PROGRAM OF UNDERWRITERS LABORATORIES INC. FILE NO E60677.

- 6. NOT CUMULATIVE TOLERANCE.
- 7. INK MARKING, BLACK COLOR
- 8. P/N 1-282845-2 IS OBTAINED BY GLUING AND ASSEMBLING TOGETHER No.1 CONNECTOR P/N 282845-6, No.1 CONNECTOR P/N 282845-7, No.1 CONNECTOR P/N 282845-8 AND No.1 CONNECTOR P/N 1-282845-0
- 9. P/N 1-282845-4 IS OBTAINED BY INTERLOCKING 2 NO. OF CONNECTOR P/N 282845-3.

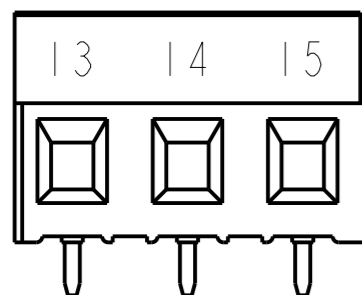

P/N 1-282845-1 AS SHOWN

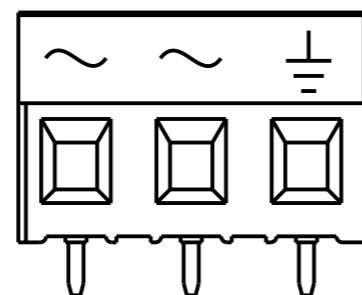

P/N 1-282845-3 AS SHOWN

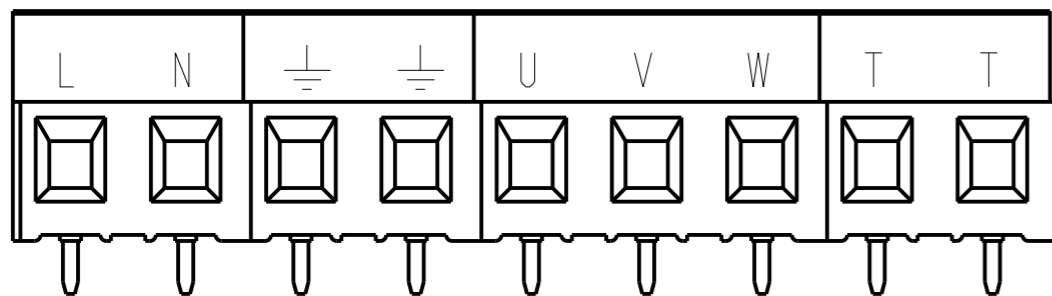

P/N 1-282845-2 AS SHOWN

THIS DRAWING IS A CONTROLLED DOCUMENT.

DIMENSIONS:	TOLERANCES UNLESS OTHERWISE SPECIFIED:
mm	
0 PLC	±0
1 PLC	±.3
2 PLC	±.25
3 PLC	±0
4 PLC	±0
ANGLES	±2°

MATERIAL	FINISH
1	1

DWN	16AUG2001
E. ZANOLINI	
CHK	16AUG2001
D. BIEVENOUR	
APVD	16AUG2001
D. BIEVENOUR	
PRODUCT SPEC	108-20166
APPLICATION SPEC	114-20079
WEIGHT	-

<b>TE</b> TE Connectivity			
NAME TERMINAL BLOCK PCB MOUNT SIDE WIRE ENTRY, STACKING W/INTERLOCK, 7.62mm PITCH			
SIZE	CAGE CODE	DRAWING NO	RESTRICTED TO
A3	00779	C=282845	-
CUSTOMER DRAWING		SCALE	SHEET
		2:1	2 OF 2
		REV	E1