

APPROVED: \_\_\_\_\_  
 DATE: \_\_\_\_\_ TITLE: \_\_\_\_\_

Rev	AWO #	Description	Date	Appr
-		UPDATE SPEC.	10/01/16	
A		ADDED LED SCHEMATIC	7/9/19	AY/AY1

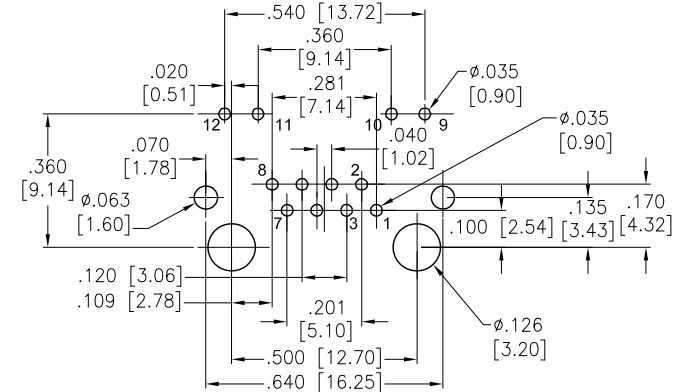

RECOMMENDED PCB LAYOUT

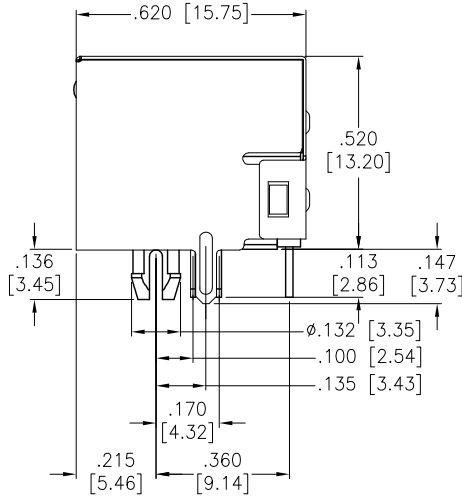
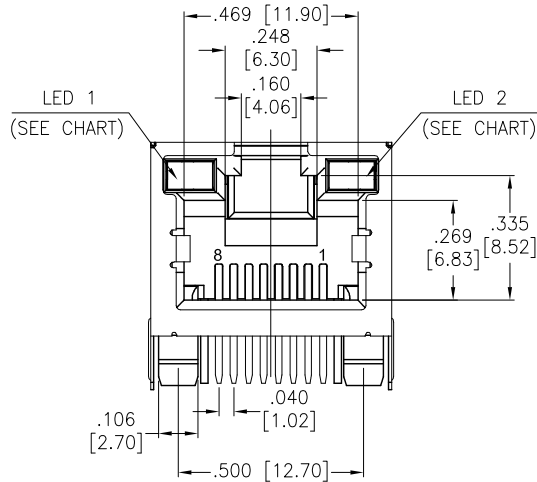
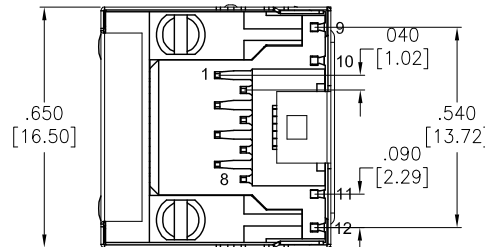

**SPECIFICATIONS:**

**Material:**  
 Insulator: PBT, glass reinforced, rated UL 94V-0  
 Insulator color: Black  
 Contacts: Phosphor Bronze  
 Shield: Brass, Nickel plated  
 Contacts Plating:  
 Round contact  
 Gold over Nickel underplate overall  
 Flat contact  
 Gold over Nickel underplate on contact area,  
 Tin over Nickel underplate on solder tails

**Electrical:**  
 Voltage rating: 150 VAC rms  
 Current rating: 1.5 Amp  
 Contact resistance: 20 mohms max.  
 Insulation resistance: 1000 Mohms min @ 500 VDC  
 Dielectric withstanding voltage:  
 Contact to Contact: 1,000 VDC or AC Peak for 1 minute  
 Contact to Screen and Test panel: 1,500 VDC or AC Peak for 1 minute

**Temperature Rating:**  
 Operating temperature: -40°C to +85°C  
 Environmental:  
 Lead free, RoHS compliant.



Part Number	LED 1 Color	LED 2 Color
MTJ-88ARX1-FSM-LD	Green	Green
MTJ-88ARX1-FSM-LG	Yellow	Green
MTJ-88ARX1-FSM-LH	Green	Yellow
MTJ-88ARX1-FSM-LP	Yellow/Green	Yellow/Green
MTJ-88ARX1-FSM-LV	Green	Yellow/Green
MTJ-88ARX1-FSM-L16	Green/Yellow	Green/Yellow

UNLESS OTHERWISE SPECIFIED ALL DIMENSIONS ARE MM [INCHES] TOLERANCES: EXCEPT AS NOTED INCHES HOLES .X ±.10 Ø.X ±.10 .XX ±.020 Ø.XX ±.015 .XXX ±.015 Ø.XXX ±.010		<b>ADAM TECH</b> INTERCONNECTS		909 Rahway Avenue, Union, NJ 07083 Phone: 908-687-5000 Fax: 908-687-5710
		TITLE: MODULAR TELEPHONE JACK, R/A, 8P8C SHIELDED WITH LED'S		
APPROVALS		DATE		
DRAWN	SLS	10/01/16		
CHECKED				
APPROVED				
SIZE	PART NO.	REV.		
X	MTJ-88ARX1-FSM-LX	A		
REF:	S00005C	SCALE:	NTS	SHEET 1 OF 2

6

5

4

3

2

1

APPROVED: \_\_\_\_\_

DATE: \_\_\_\_\_ TITLE: \_\_\_\_\_

Rev	AWO #	Description	Date	Appr
		SEE SHT 1 OF 2 FOR REVISION		

### LED SCHEMATIC

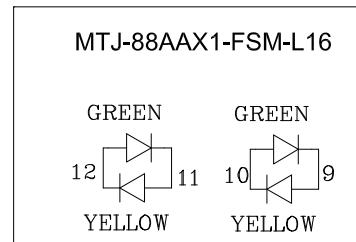
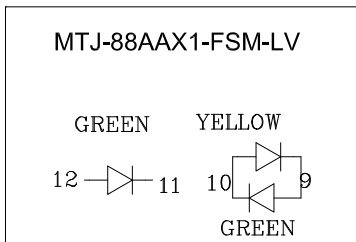
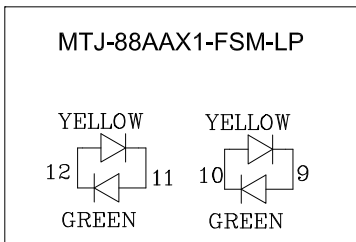
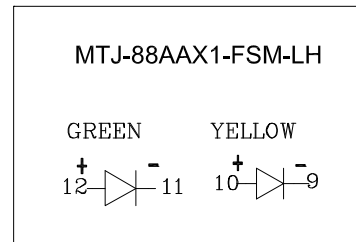
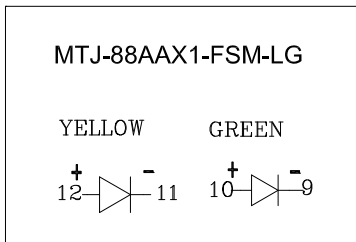
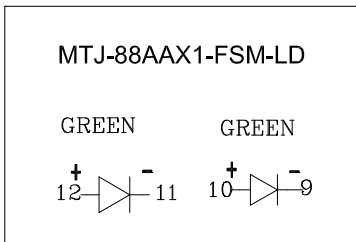

UNLESS OTHERWISE SPECIFIED  
ALL DIMENSIONS ARE MM [INCHES]  
TOLERANCES: EXCEPT AS NOTED

INCHES		HOLES	
.X	± .10	Ø.X	±.10
.XX	± .020	Ø.XX	±.015
.XXX	± .015	Ø.XXX	±.010

APPROVALS		DATE
DRAWN	SLS	10/01/16
CHECKED		
APPROVED		

**ADAM TECH INTERCONNECTS**

909 Rahway Avenue,  
Union, NJ 07083  
Phone: 908-687-5000  
Fax: 908-687-5710

TITLE <b>MODULAR TELEPHONE JACK, R/A, 8P8C SHIELDED WITH LED'S</b>		
SIZE <b>X</b>	PART NO. <b>MTJ-88ARX1-FSM-LX</b>	REV. <b>A</b>
REF: S00005C	SCALE: NTS	SHEET 2 OF 2

6

5

4

3

2

1