

REVISIONS					
P	LTR	DESCRIPTION	DATE	DWN	APVD
	L1	REVISED PER ECO-20-014158	07OCT20	RK	MZ

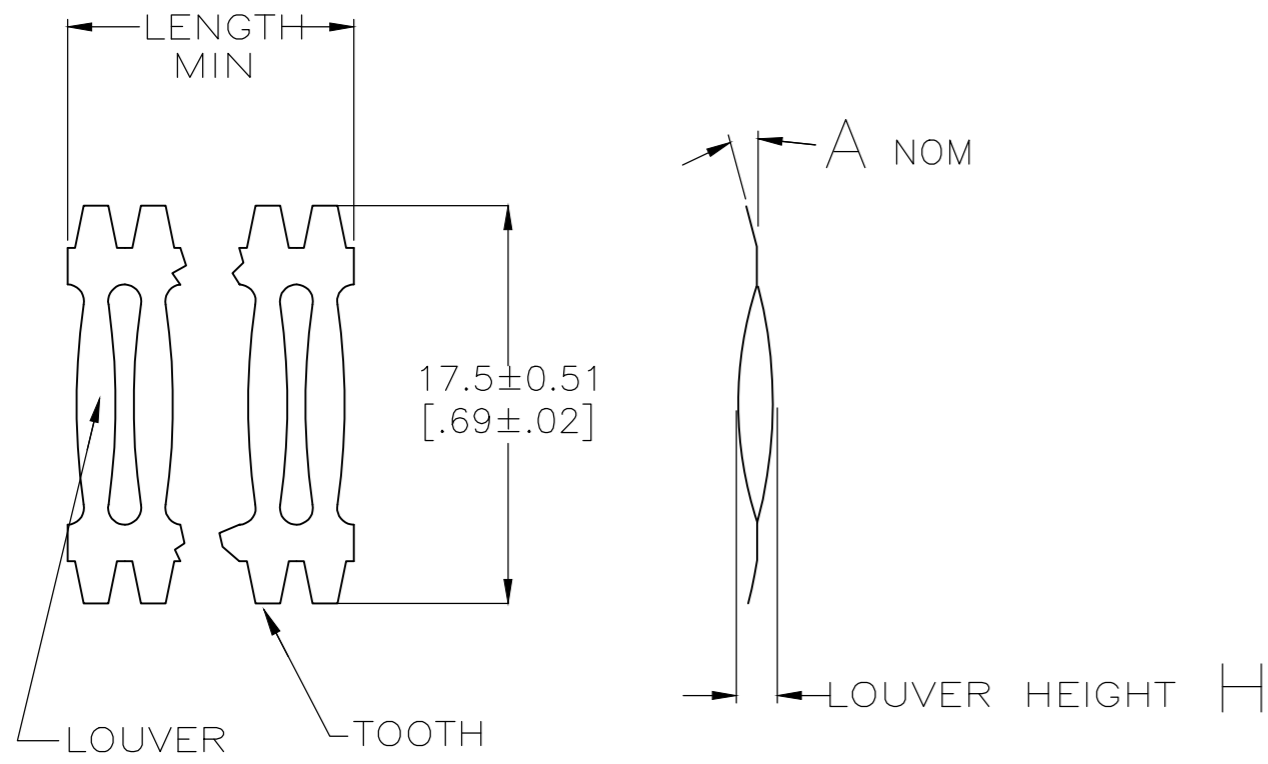

- 1 FINISH-SILVER PLATE 2.54µm[100µ"] THICK MIN
- 2 FINISH-SILVER PLATE 5.08µm[200µ"] THICK MIN
- 3 FINISH-NICKEL PLATE 2.54µm[100µ"] THICK MIN
- 4 FINISH-NICKEL PLATE 1.02µm[40µ"] THICK MIN
- 5 FINISH-GOLD PLATE .25µm[10µ"] THICK MIN
- 6 FINISH-GOLD PLATE 1.27µm[50µ"] THICK MIN
- 7 FINISH-TIN PLATE 7.62µm[300µ"] THICK MIN
- 8 LENGTH-23 LOUVERS (2.3 INCHES).
- 9
- 10
- 11 PLATING NOTES TO BE INTERPRETED AS FOLLOWS: 1-4 AS 1 OVER 4.
- 12 PRODUCT IS SOLD BY THE FOOT.
- 14 10 LOUVERS 25.4mm (1.0).
- 15 PRELIMINARY PART NUMBER.
- 16 P/N 3-192004-0 IS CUT TO A LENGTH OF 19.50 INCHES
- 17 6 LOUVERS 15.2mm(.60 IN)
- 18 OBSOLETE PARTS: OBSOLETE CIS STREAMLINING PER D.RENAUD/D.SINISI
- 19 3 LOUVERS 7.62±0.25[.300±.010] IN LENGTH. EDGES OF CONTACT WHERE STRIPS WERE CUT TO LENGTH WILL BE PLATED.

LOUVER HEIGHT H	LENGTH	MAT'L	PLATING (NOTE NO.)	TOOTH ANGLE A	MAT'L THK T	REF	PART NUMBER
OBSOLETE	1.19/1.34[.047/.053]	SEE NOTE 19	BeCu	6-4	15°	0.15[.006]	3-192004-2
OBSOLETE	1.19/1.34[.047/.053]	SEE NOTE 17	BeCu	2-4	15°	0.15[.006]	3-192004-1
OBSOLETE	1.19/1.34[.047/.053]	SEE NOTE 16	BeCu	2-4	45°	0.15[.006]	3-192004-0
OBSOLETE	1.19/1.34[.047/.053]	SEE NOTE 12	BeCu	7	15°	0.15[.006]	2-192004-9
OBSOLETE	1.19/1.34[.047/.053]	SEE NOTE 14	BeCu	2-4	15°	0.15[.006]	2-192004-8
OBSOLETE	1.24/1.40[.049/.055]	SEE NOTE 8	BeCu	2-4	15°	0.20[.008]	2-192004-7
OBSOLETE	1.24/1.40[.049/.055]	SEE NOTE 12	BeCu	7	15°	0.20[.008]	2-192004-6
OBSOLETE	1.19/1.34[.047/.053]	20.1m[792"]	BeCu	1-4	15°	0.10[.004]	2-192004-5
OBSOLETE	1.19/1.34[.047/.053]	20.1m[792"]	BeCu	1-4	15°	0.15[.006]	2-192004-4
OBSOLETE	1.19/1.34[.047/.053]	20.1m[792"]	BeCu	UNPL	15°	0.15[.006]	2-192004-3
OBSOLETE	--	--	--	--	--	--	2-192004-2
OBSOLETE	--	--	--	--	--	--	2-192004-1
OBSOLETE	1.19/1.34[.047/.053]	20.1m[792"]	BeCu	UNPL	15°	0.10[.004]	01323 2-192004-0
OBSOLETE	1.24/1.40[.049/.055]	SEE NOTE 12	BeCu	2-4	15°	0.20[.008]	01029 1-192004-9
OBSOLETE	1.24/1.40[.049/.055]	SEE NOTE 12	BeCu	UNPL	15°	0.20[.008]	01322 1-192004-8
OBSOLETE	1.14[.045] MIN	SEE NOTE 12	CNCL	UNPL	45°	0.15[.006]	01066 1-192004-7
OBSOLETE	1.19/1.34[.047/.053]	SEE NOTE 12	BeCu	6-4	45°	0.15[.006]	01023 1-192004-6
OBSOLETE	1.19/1.34[.047/.053]	SEE NOTE 12	BeCu	5-4	45°	0.15[.006]	01037 1-192004-5
OBSOLETE	1.19/1.34[.047/.053]	SEE NOTE 12	BeCu	2-4	45°	0.15[.006]	01013 1-192004-4
OBSOLETE	1.19/1.34[.047/.053]	SEE NOTE 12	BeCu	UNPL	45°	0.15[.006]	01011 1-192004-3
OBSOLETE	1.14[.045] MIN	SEE NOTE 12	CNCL	UNPL	15°	0.15[.006]	01022 1-192004-2
OBSOLETE	1.19/1.34[.047/.053]	SEE NOTE 12	BeCu	6-4	15°	0.15[.006]	01015 1-192004-1
OBSOLETE	1.19/1.34[.047/.053]	SEE NOTE 12	BeCu	5-4	15°	0.15[.006]	01036 1-192004-0
OBSOLETE	1.19/1.34[.047/.053]	SEE NOTE 12	BeCu	3	15°	0.15[.006]	01020 192004-9
OBSOLETE	1.19/1.34[.047/.053]	SEE NOTE 12	BeCu	2-4	15°	0.15[.006]	01005 192004-8
OBSOLETE	1.19/1.34[.047/.053]	SEE NOTE 12	BeCu	UNPL	15°	0.15[.006]	01003 192004-7
OBSOLETE	1.19/1.34[.047/.053]	SEE NOTE 12	BeCu	2-4	45°	0.10[.004]	01049 192004-6
OBSOLETE	1.19/1.34[.047/.053]	SEE NOTE 12	BeCu	3	15°	0.10[.004]	01058 192004-5
OBSOLETE	1.19/1.34[.047/.053]	SEE NOTE 12	BeCu	2-4	15°	0.10[.004]	01002 192004-4
OBSOLETE	1.19/1.34[.047/.053]	SEE NOTE 12	BeCu	UNPL	15°	0.10[.004]	01017 192004-3
OBSOLETE	1.09/1.24[.043/.049]	SEE NOTE 12	BeCu	2-4	15°	0.08[.003]	01001 192004-2
OBSOLETE	1.09/1.24[.043/.049]	SEE NOTE 12	BeCu	UNPL	15°	0.08[.003]	01021 192004-1

THIS DRAWING IS A CONTROLLED DOCUMENT.

DWN 08-12-91 RA JAYNE
CHK 08-12-91 RA JAYNE

DIMENSIONS: mm [INCHES] TOLERANCES UNLESS OTHERWISE SPECIFIED:
0 PLC ± -
1 PLC ± -
2 PLC ± 0.5 [.02]
3 PLC ± 0.25 [.010]
4 PLC ± -
ANGLES ± -

MATERIAL SEE TABLE FINISH SEE TABLE WEIGHT -

PRODUCT SPEC -
APPLICATION SPEC -

NAME CONTACT BAND,FEM STRIP

SIZE A2 CAGE CODE 00779 DRAWING NO C=192004 RESTRICTED TO -

CUSTOMER DRAWING SCALE NTS SHEET 1 OF 1 REV L1