

## Flush-type connector - SACCBP-MS-8CON-M16/2,0-PUR SCO - 1419438

Please be informed that the data shown in this PDF Document is generated from our Online Catalog. Please find the complete data in the user's documentation. Our General Terms of Use for Downloads are valid (<http://download.phoenixcontact.com>)



Flush-type plug, shielded, 8-pos., M12, A-coded, rear/screw mounting with M16 thread, with 2 m cable, 8 x 0.25 mm<sup>2</sup>



### Key commercial data

Packing unit	1 1
Weight per Piece (excluding packing)	140.0 GRM
Custom tariff number	85444290
Country of origin	Germany

### Technical data

#### Dimensions

Length of cable	2 m
-----------------	-----

#### Ambient conditions

Degree of protection	IP67
----------------------	------

#### General

Rated current at 40°C	2 A
Rated voltage	30 V
Number of positions	8
Contact resistance	≤ 3 mΩ
Insulation resistance	≥ 100 MΩ
Coding	A - standard
Standards/regulations	M12 connector IEC 61076-2-101
Status display	No
Surge voltage category	II
Pollution degree	3

# Flush-type connector - SACCBP-MS-8CON-M16/2,0-PUR SCO - 1419438

## Technical data

### General

Mounting type	Rear mounting M16 x 1.5 With flat nut
---------------	---------------------------------------

### Material

Inflammability class according to UL 94	V0
Contact material	CuZn
Contact surface material	Au
Contact carrier material	PA 66
Material, knurls	Zinc die-cast, nickel-plated
Sealing material	NBR

### Cable

Cable type	PUR halogen-free black
Cable abbreviation	Li9Y-V1-C-V1-11Y
AWG signal line	24
Wire colors	Brown, white, green, yellow, gray, pink, blue, red
Overall twist	8 wires around filler to the core
Shielding	Braided copper wires
Optical shield covering	85 %
External sheath, color	Black-gray RAL 7021
External cable diameter	5.90 mm
Cable weight	54 kg/km
Outer sheath, material	PUR
Material, filler	PE
Conductor material	Bare Cu litz wires

## Classifications

### eCl@ss

eCl@ss 4.0	27140815
eCl@ss 4.1	27140815
eCl@ss 5.0	27143423
eCl@ss 5.1	27143423
eCl@ss 6.0	27279220
eCl@ss 7.0	27440103
eCl@ss 8.0	27440103

### ETIM

ETIM 2.0	EC001297
----------	----------

# Flush-type connector - SACCBP-MS-8CON-M16/2,0-PUR SCO - 1419438

## Classifications

### ETIM

ETIM 3.0	EC002061
ETIM 4.0	EC002061
ETIM 5.0	EC002061

### UNSPSC

UNSPSC 6.01	31251501
UNSPSC 7.0901	31251501
UNSPSC 11	31251501
UNSPSC 12.01	31251501
UNSPSC 13.2	39121413

## Approvals

### Approvals

---

Approvals

GOST / GOST

---

Ex Approvals

---

Approvals submitted

---

### Approval details

GOST 
--

GOST 
--

## Accessories

Accessories

Plug for cable screw gland

# Flush-type connector - SACCBP-MS-8CON-M16/2,0-PUR SCO - 1419438

## Accessories

Screw plug - SACC-M16-SEALING PLUG SET - 1453368



M16 screw plug for unused M12 housing cutouts

## Drawings

Dimensioned drawing

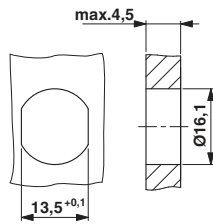

Housing cutout for M16 fastening thread, mounting panel with feed-through hole (alternatively with surface as protection against rotation)

Schematic diagram

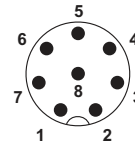

Pin assignment of M12 male connector, 8-pos., A-coded, view of socket side

Cable cross section



PUR halogen-free black shielded [PUR]

Dimensioned drawing

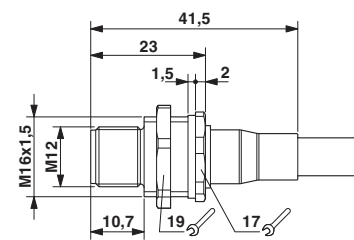

M12 flush-type connector

## Flush-type connector - SACCBP-MS-8CON-M16/2,0-PUR SCO - 1419438

Circuit diagram

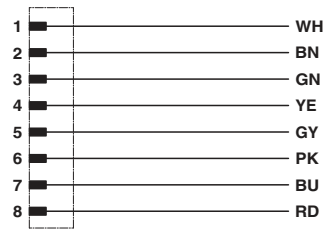

Contact assignment of the M12 plugs