

RECOMMENDED P.C. BOARD HOLE PATTERN FOR STRAIGHT PINS

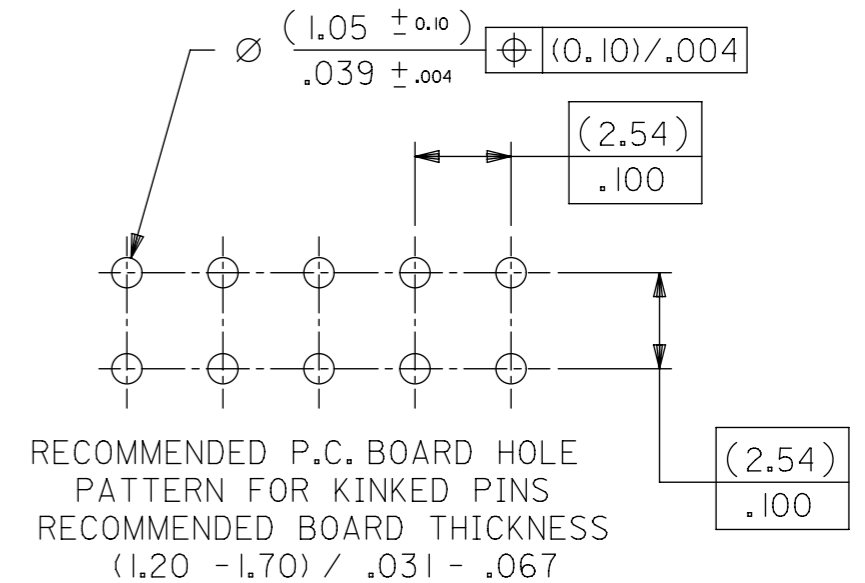

RECOMMENDED P.C. BOARD HOLE PATTERN FOR KINKED PINS
RECOMMENDED BOARD THICKNESS (1.20 - 1.70) / .031 - .067

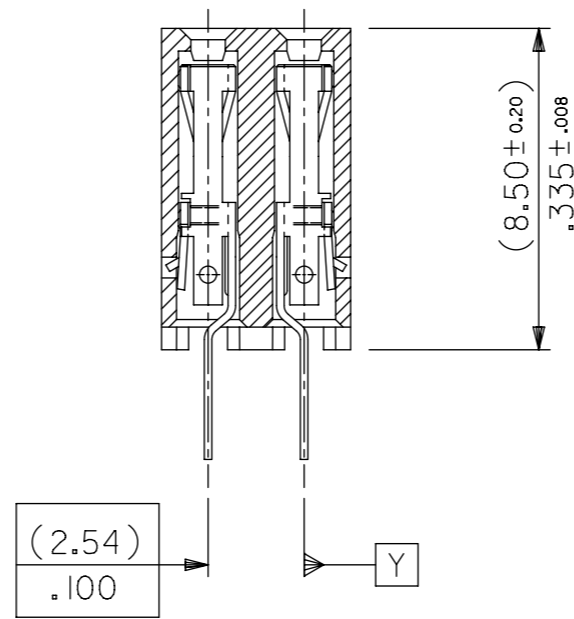

SECTION C-C

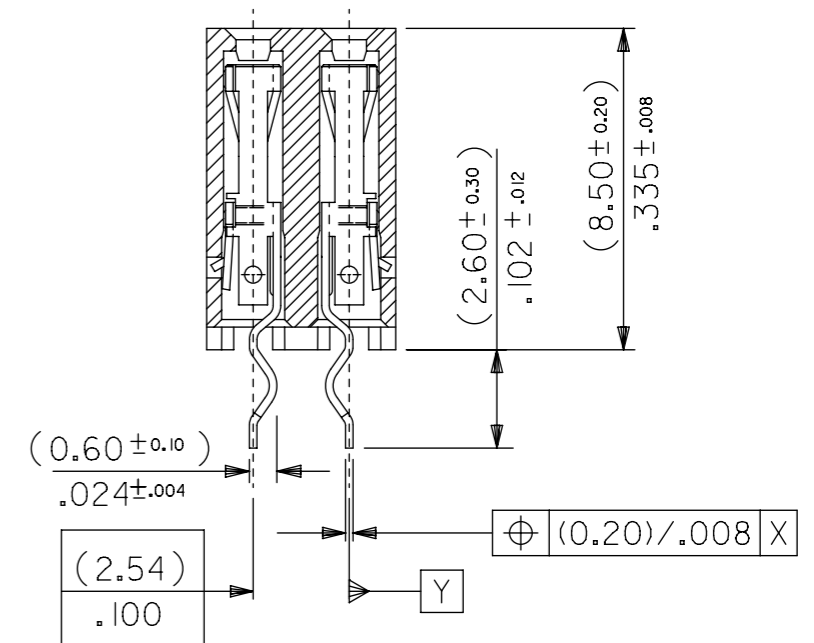

SECTION C-C

NOTES

- 1) CONTACT-PLATED PHOSPHOR BRONZE.
- 2) HOUSING-15% GLASS FILLED POLYESTER. COLOUR-BLACK.
- 3) COMPATIBLE WITH PCB HOLE PATTERN.
- 4) FOR (0.635)/.025 SQ. MALE PINS THE LENGTH MUST BE (5.65)/.222 MIN & (7.00)/.276 MAX. TO ENSURE GOOD CONNECTION WITH CONTACT.

6	AF
5	AD
4	AD
3	AD
2	AG
1	AH

THIS DRAWING CONTAINS INFORMATION THAT IS PROPRIETARY TO MOLEX ELECTRONIC TECHNOLOGIES, LLC AND SHOULD NOT BE USED WITHOUT WRITTEN PERMISSION											
DIMENSION UNITS		SCALE		CURRENT REV DESC: MIGRATED						molex	
mm		1:1									
GENERAL TOLERANCES (UNLESS SPECIFIED)				EC NO: 615440		DRWN: MKP		2019/04/10		C-GRID III DUAL ROW VERTICAL P.C. BOARD CONNECTOR	
4 PLACES ±		±		CHK'D: NMANE02		2019/04/12		PRODUCT CUSTOMER DRAWING			
3 PLACES ±		±		APPR: MRAMAKRISHNA		2019/04/12		DOCUMENT NUMBER		DOC TYPE DOC PART REVISION	
2 PLACES ±		0.05 ±		INITIAL REVISION:		DRWN: DB		21/07/86		SDA-90151 PSD 001 AJ	
1 PLACE ±		0.1 ±		ANGULAR TOL ± °		DRAFT WHERE APPLICABLE MUST REMAIN WITHIN DIMENSIONS		THIRD ANGLE PROJECTION		DRAWING SERIES MATERIAL NUMBER CUSTOMER SHEET NUMBER	
0 PLACES ±		±				A3-SIZE 90151		SEE TABLE		GENERAL MARKET 1 OF 6	

10
PART NO. SEE CHART
SDA-90151
DWG. NO.

PART NO. STRAIGHT PINS	PART NO. KINKED PINS	NO. OF CKTS.	DIM. " A "	DIM. " B " (^{+0.00})(^{-.012})	QTY. PER TUBE
90151-2X04	90151-3X04	4	(2.54) .100	(5.08) .200	105
↑ 06	↑ 06	6	(5.08) .200	(7.62) .300	72
08	08	8	(7.62) .300	(10.16) .400	52
10	10	10	(10.16) .400	(12.70) .500	44
12	12	12	(12.70) .500	(15.24) .600	36
14	14	14	(15.24) .600	(17.78) .700	30
16	16	16	(17.78) .700	(20.32) .800	26
18	18	18	(20.32) .800	(22.86) .900	24
20	20	20	(22.86) .900	(25.40) 1.000	22
22	22	22	(25.40) 1.000	(27.94) 1.100	20
24	24	24	(27.94) 1.100	(30.48) 1.200	18
26	26	26	(30.48) 1.200	(33.02) 1.300	16
28	28	28	(33.02) 1.300	(35.56) 1.400	14
30	30	30	(35.56) 1.400	(38.10) 1.500	14
32	32	32	(38.10) 1.500	(40.64) 1.600	13
34	34	34	(40.64) 1.600	(43.18) 1.700	12
36	36	36	(43.18) 1.700	(45.72) 1.800	12
38	38	38	(45.72) 1.800	(48.26) 1.900	11
40	40	40	(48.26) 1.900	(50.80) 2.000	11
42	42	42	(50.80) 2.000	(53.34) 2.100	11
44	44	44	(53.34) 2.100	(55.88) 2.200	10
46	46	46	(55.88) 2.200	(58.42) 2.300	10
48	48	48	(58.42) 2.300	(60.96) 2.400	9
50	50	50	(60.96) 2.400	(63.50) 2.500	8
52	52	52	(63.50) 2.500	(66.04) 2.600	8
54	54	54	(66.04) 2.600	(68.58) 2.700	8
56	56	56	(68.58) 2.700	(71.12) 2.800	7
58	58	58	(71.12) 2.800	(73.66) 2.900	7
60	60	60	(73.66) 2.900	(76.20) 3.000	7
↓ 62	↓ 62	62	(76.20) 3.000	(78.74) 3.100	7
90151-2X64	90151-3X64	64	(78.74) 3.100	(81.28) 3.200	6

PLATING VERSION A

PRE-PLATED HOT DIP TIN
1.0 TO 2.5 um (.000040" TO .000100").

PLATING VERSION E

1.27 TO 1.78 um (.000050" TO .000070") NICKEL
OVERALL, 0.38 TO 0.64 um (.000015" TO .000025")
GOLD ON CONTACT AREA (OVER NICKEL).
3 TO 5 um (.000120" TO .000200") TIN
ON SOLDER TAILS (OVER NICKEL).

PLATING VERSION F.

1.27 TO 1.78 um (.000050" TO .000070") NICKEL
OVERALL, 0.76 TO 1.0 um (.000030" TO .000040")
GOLD ON CONTACT AREA (OVER NICKEL).
3 TO 5 um (.000120" TO .000200") TIN
ON SOLDER TAILS (OVER NICKEL).

PLATING VERSION G.

1.27 TO 1.78 um (.000050" TO .000070") NICKEL
OVERALL, 0.125 um MIN. (.000005" MIN.) GOLD FLASH
ON CONTACT AREA (OVER NICKEL).
3 TO 5 um (.000120" TO .000200") TIN
ON SOLDER TAILS (OVER NICKEL).

PLATING VERSION N.

1.27 TO 1.78 um (.000050" TO .000070") NICKEL
OVERALL, 0.76 TO 2.6 um (.000030" TO .000100")
GOLD ON CONTACT AREA (OVER NICKEL).
4 um (.000120") MINIMUM TIN
ON SOLDER TAILS (OVER NICKEL).

STANDARD PRODUCTS

90151-XX YY

INDICATES NO. OF CIRCUITS.

- PLATING CODE.
1 = VERSION A.
2 = VERSION E.
3 = VERSION F.
4 = VERSION N.
5 = VERSION G.

SEE CHART

THIS DRAWING CONTAINS INFORMATION THAT IS PROPRIETARY TO MOLEX ELECTRONIC TECHNOLOGIES, LLC AND SHOULD NOT BE USED WITHOUT WRITTEN PERMISSION									
DIMENSION UNITS		SCALE		CURRENT REV DESC: MIGRATED				molex	
mm		1:1							
GENERAL TOLERANCES (UNLESS SPECIFIED)				EC NO: 615440		C-GRID III DUAL ROW		VERTICAL P.C. BOARD CONNECTOR	
4 PLACES ±		MM		DRWN: MKP		2019/04/10			
3 PLACES ±		INCH		CHK'D: NMANE02		2019/04/12			
2 PLACES ± 0.05				APPR: MRAMAKRISHNA		2019/04/12		PRODUCT CUSTOMER DRAWING	
1 PLACE ± 0.1				INITIAL REVISION:				DOCUMENT NUMBER	
0 PLACES ±				DRWN: DB		21/07/86		SDA-90151	
ANGULAR TOL ± °				APPR:				PSD 001 AJ	
DRAFT WHERE APPLICABLE MUST REMAIN WITHIN DIMENSIONS				THIRD ANGLE PROJECTION		DRAWING		SERIES	
				A3-SIZE		90151		MATERIAL NUMBER	
						SEE TABLE		CUSTOMER	
						GENERAL MARKET		SHEET NUMBER	
						2 OF 6			

SEE CHART
SDA-90151

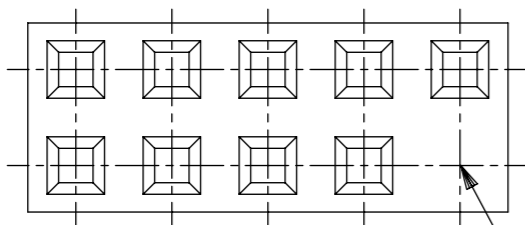

90151-XXYY

INDICATES NO. OF CIRCUITS.

PLATING CODE.

- 41 = VERSION A.
- 42 = VERSION E.
- 43 = VERSION N.
- 44 = VERSION F.

TYPICAL POSITION
VOID

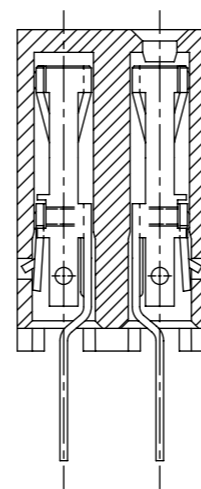
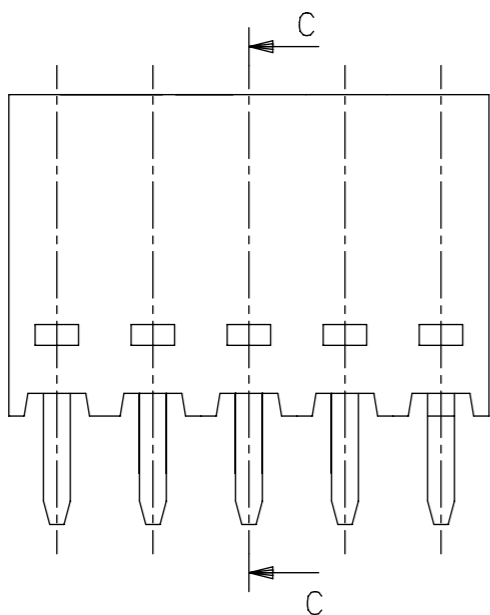

SECTION C-C

PART NUMBER	CKT. SIZE	PIN VOID	QTY. PER TUBE
90151-4424	2 X 12	5	36
90151-4114	2 X 7	1,13.	55
90151-4340	2 X 20	2,4,6,8,12,13,15,16,23 24,26,27,28,30,33, 34,35,36,37,38,40.	11
90151-4322	2 X 11	1,4,5,6,7,8,9,10,11,14 15,16,17,18,19,20,21.	20
90151-4206	2 X 3	3,4	72
90151-4420	2 x 10	1	22

NOTES

- 1) FOR DIMENSIONS SEE SHEET 1.
- 2) FOR PLATING CODE DEFINITIONS SEE SHEET 2.

NON-STANDARD PRODUCTS

THIS DRAWING CONTAINS INFORMATION THAT IS PROPRIETARY TO MOLEX ELECTRONIC TECHNOLOGIES, LLC AND SHOULD NOT BE USED WITHOUT WRITTEN PERMISSION									
DIMENSION UNITS mm		SCALE 1:1		CURRENT REV DESC: MIGRATED				molex	
GENERAL TOLERANCES (UNLESS SPECIFIED)				EC NO: 615440					
		MM	INCH	DRWN: MKP		2019/04/10		C-GRID III DUAL ROW VERTICAL P.C. BOARD CONNECTOR	
4 PLACES		±	±	CHK'D: NMANE02		2019/04/12		PRODUCT CUSTOMER DRAWING	
3 PLACES		±	±	APPR: MRAMAKRISHNA		2019/04/12		DOCUMENT NUMBER	
2 PLACES		± 0.05	±	INITIAL REVISION:				SDA-90151	
1 PLACE		± 0.1	±	DRWN: DB		21/07/86		DOC TYPE	
0 PLACES		±	±	APPR:				PSD	
ANGULAR TOL		±	°					DOC PART	
DRAFT WHERE APPLICABLE MUST REMAIN WITHIN DIMENSIONS		THIRD ANGLE PROJECTION		DRAWING		SERIES		REVISION	
				A3-SIZE		90151		AJ	
				MATERIAL NUMBER		CUSTOMER		SHEET NUMBER	
				SEE TABLE		GENERAL MARKET		3 OF 6	

PART NO. SEE CHART
 DWG. NO. SDA-90151

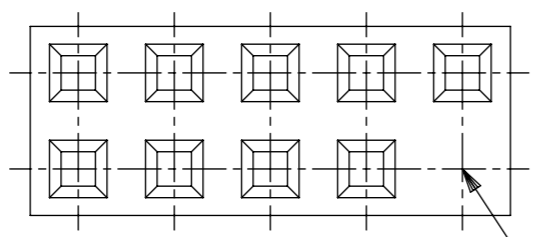

TYPICAL VOID SHOWN

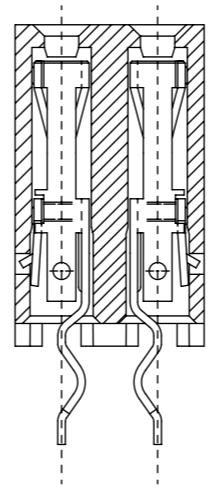
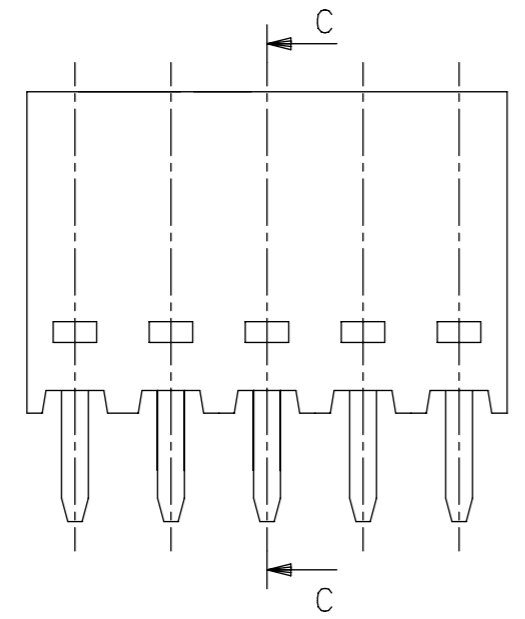

SECTION C-C

PART NO.	CKT SIZE	CONTACT VOIDS	MOULDING COLOUR	PLATING TYPE	QTY. PER TUBE
90151-9216	2 X 8	1, 2, 15, 16	WHITE	E	26

NOTES

1) FOR ALL UNSTATED NOTES AND DIMENSIONS SEE SHEET 1.

NON STANDARD PRODUCTS

THIS DRAWING CONTAINS INFORMATION THAT IS PROPRIETARY TO MOLEX ELECTRONIC TECHNOLOGIES, LLC AND SHOULD NOT BE USED WITHOUT WRITTEN PERMISSION									
DIMENSION UNITS		SCALE		CURRENT REV DESC: MIGRATED				molex	
mm		1:1							
GENERAL TOLERANCES (UNLESS SPECIFIED)									
		MM	INCH	EC NO: 615440		2019/04/10		C-GRID III DUAL ROW	
4 PLACES		±	±	DRWN: MKP		2019/04/12		VERTICAL P.C. BOARD CONNECTOR	
3 PLACES		±	±	CHK'D: NMANE02		2019/04/12		PRODUCT CUSTOMER DRAWING	
2 PLACES		± 0.05	±	APPR: MRAMAKRISHNA		2019/04/12		DOCUMENT NUMBER	
1 PLACE		± 0.1	±	INITIAL REVISION:				SDA-90151	
0 PLACES		±	±	DRWN: DB		21/07/86		DOC TYPE	
ANGULAR TOL		±	°	APPR:				PSD	
DRAFT WHERE APPLICABLE MUST REMAIN WITHIN DIMENSIONS		THIRD ANGLE PROJECTION		DRAWING		SERIES		MATERIAL NUMBER	
				A3-SIZE		90151		CUSTOMER	
								GENERAL MARKET	
								SHEET NUMBER	
								4 OF 6	

PART NO. SEE CHART
 DWG. NO. SDA-90151

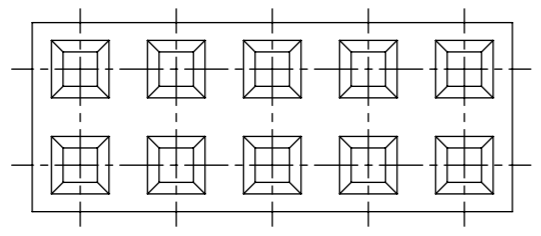

PART NO.	CKT SIZE	CONTACT VOID POSITIONS	MOULDING COLOUR	PLATING TYPE	QTY. PER TUBE
90151-8164	2 X32	1, 2, 63, 64	BLACK	E	12
90151-8138	2 X19	1, 2, 37, 38	BLACK	E	22
90151-8124	2 X12	1, 2, 23, 24	BLACK	E	18
90151-8114	2 X 7	1, 2, 13, 14	BLACK	E	73

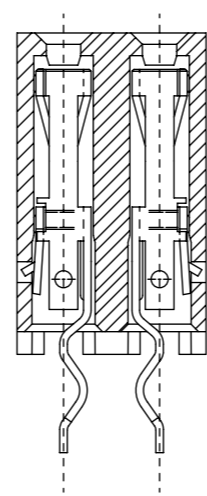
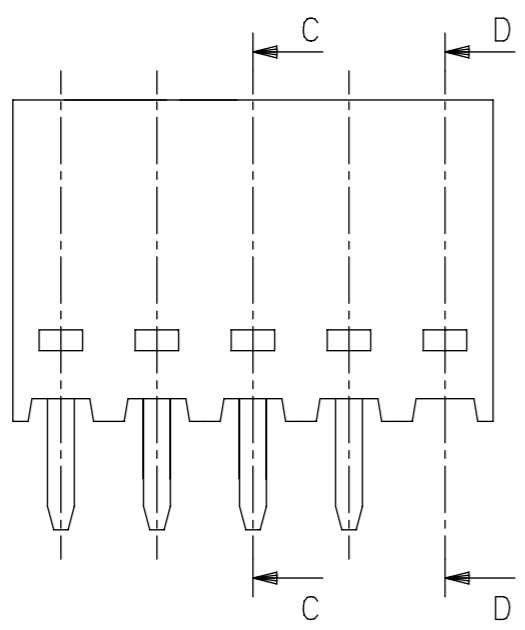

SECTION C-C
 (LOADED CONTACTS)

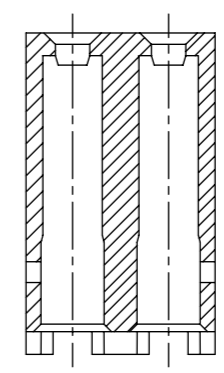

SECTION D-D
 (CONTACTS REMOVED FOR VOID POSITIONS)

NOTES

1) FOR ALL UNSTATED NOTES AND DIMENSIONS SEE SHEET 1.

NON STANDARD PRODUCTS

THIS DRAWING CONTAINS INFORMATION THAT IS PROPRIETARY TO MOLEX ELECTRONIC TECHNOLOGIES, LLC AND SHOULD NOT BE USED WITHOUT WRITTEN PERMISSION									
DIMENSION UNITS		SCALE		CURRENT REV DESC: MIGRATED				molex	
mm		1:1							
GENERAL TOLERANCES (UNLESS SPECIFIED)				EC NO: 615440				C-GRID III DUAL ROW	
		MM	INCH	DRWN: MKP		2019/04/10		VERTICAL P.C. BOARD CONNECTOR	
4 PLACES		±	±	CHK'D: NMANE02		2019/04/12		PRODUCT CUSTOMER DRAWING	
3 PLACES		±	±	APPR: MRAMAKRISHNA		2019/04/12			
2 PLACES		± 0.05	±	INITIAL REVISION:				DOCUMENT NUMBER	
1 PLACE		± 0.1	±	DRWN: DB				SDA-90151	
0 PLACES		±	±	APPR:				PSD 001 AJ	
ANGULAR TOL		± °		THIRD ANGLE PROJECTION				DOC TYPE	
DRAFT WHERE APPLICABLE MUST REMAIN WITHIN DIMENSIONS				DRAWING		SERIES		REVISION	
				A3-SIZE		90151		5 OF 6	
				MATERIAL NUMBER		CUSTOMER		SHEET NUMBER	
				SEE TABLE		GENERAL MARKET		5 OF 6	

PART NO. SEE CHART
 DWG. NO. SDA-90151

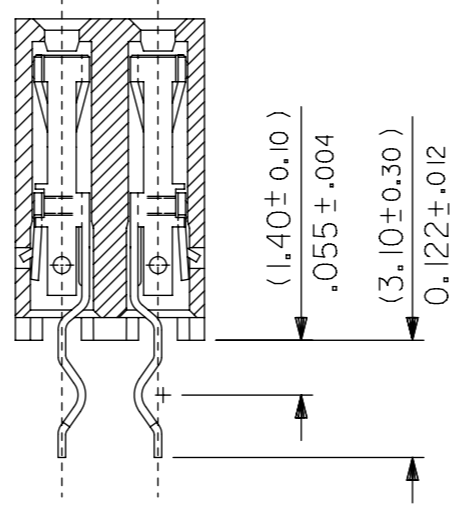
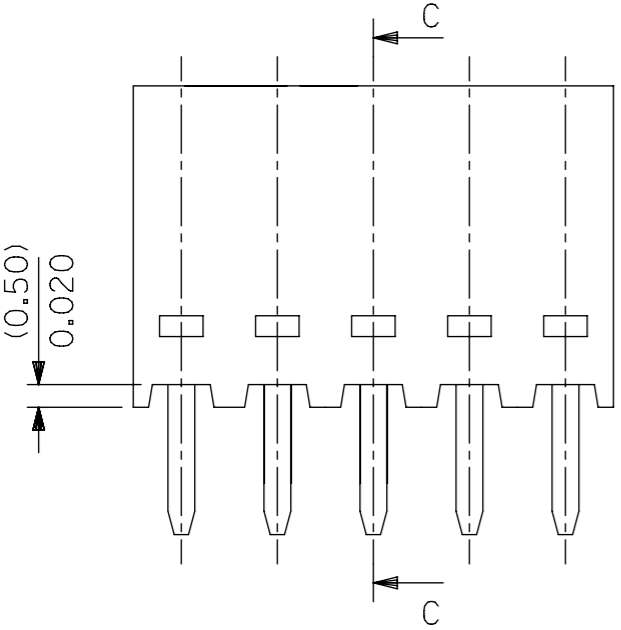
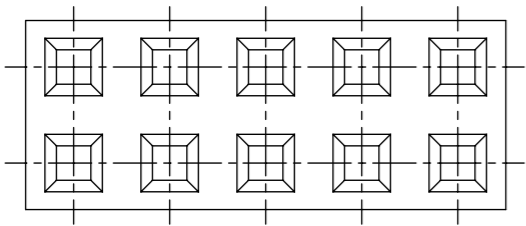

SECTION C-C

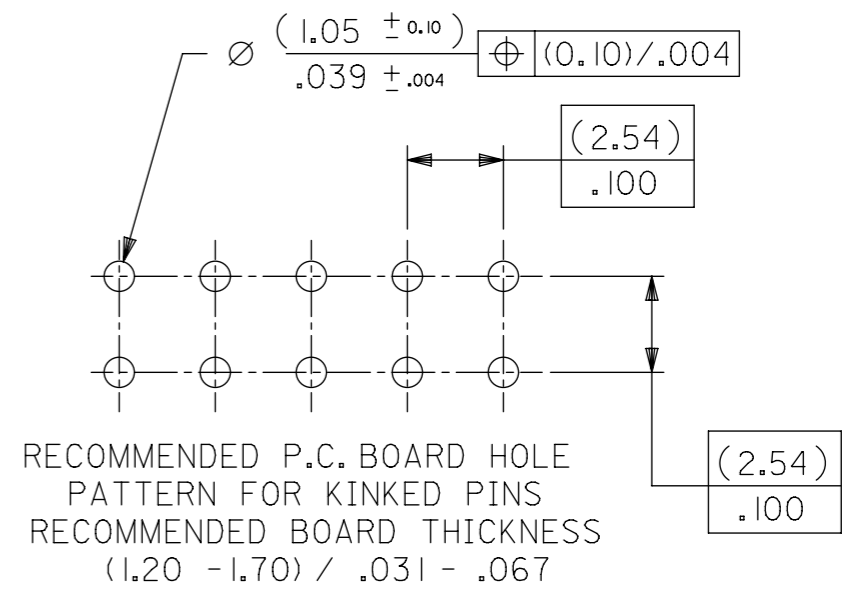

PART No.	CKT SIZE	MOULDING COLOUR	QUANTITY PER TUBE	PLATING VERSION
90151-5238	38	BLACK	11	E

NOTES
 1) FOR ALL UNSTATED NOTES AND DIMENSIONS SEE SHEET 1.

NON STANDARD PRODUCT

THIS DRAWING CONTAINS INFORMATION THAT IS PROPRIETARY TO MOLEX ELECTRONIC TECHNOLOGIES, LLC AND SHOULD NOT BE USED WITHOUT WRITTEN PERMISSION											
DIMENSION UNITS		SCALE		CURRENT REV DESC: MIGRATED				molex			
mm		1:1									
GENERAL TOLERANCES (UNLESS SPECIFIED)				EC NO: 615440		C-GRID III DUAL ROW VERTICAL P.C. BOARD CONNECTOR					
4 PLACES ±		±		DRWN: MKP 2019/04/10		PRODUCT CUSTOMER DRAWING					
3 PLACES ±		±		CHK'D: NMANE02 2019/04/12							
2 PLACES ±		0.05 ±		APPR: MRAMAKRISHNA 2019/04/12		DOCUMENT NUMBER: SDA-90151 DOC TYPE: PSD DOC PART: 001 REVISION: AJ					
1 PLACE ±		0.1 ±		INITIAL REVISION:							
0 PLACES ±		±		DRWN: DB 21/07/86							
ANGULAR TOL ± °		± °		APPR:							
DRAFT WHERE APPLICABLE MUST REMAIN WITHIN DIMENSIONS				THIRD ANGLE PROJECTION		DRAWING: A3-SIZE		SERIES: 90151		MATERIAL NUMBER: SEE TABLE CUSTOMER: GENERAL MARKET SHEET NUMBER: 6 OF 6	