

P	LTR	DESCRIPTION	DATE	DWN	APVD
	B2	ECO-20-015836	09NOV2020	RR	SH

NOTES:

- MATERIAL:
 - HOUSING: PA9T WITH 30% GF, UL 94V-0, COLOR: BLACK. OR LCP WITH 30% GF, UL 94V-0, COLOR: BLACK.
 - CAP: PA9T WITH 30% GF, UL 94V-0, COLOR: BLACK. OR LCP WITH 30% GF, UL 94V-0, COLOR: BLACK.
 - CONTACTS: BRASS.
 - SHELL: SPCC.
- FINISH:
 - CONTACTS: GOLD FLASH PLATED ON CONTACT AREA, 2.54um[100u"] MIN. MATTE-TIN PLATED ON SOLDER TAIL, 1.27um[50u"] MIN. NICKEL UNDERPLATED OVER ALL.
 - SHELL: 2.54um[100u"] MIN. NICKEL OR PLATED. OR 2.54um[100u"] MIN. BLACK NICKEL PLATED.
- RECOMMENDED PCB THICKNESS: 1.2mm.
- REFLOW SOLDER CAPABLE TO 260°C PER TE TEST SPEC. 109-201, CONDITION B.
- NO BOARD LOCK FUNCTION.
- LOW HALOGEN SPECIFICATION: (P/N: 2041127-4)
 - CHLORINE(Cl): 900ppm MAX.
 - BROMINE(Br): 900ppm MAX.

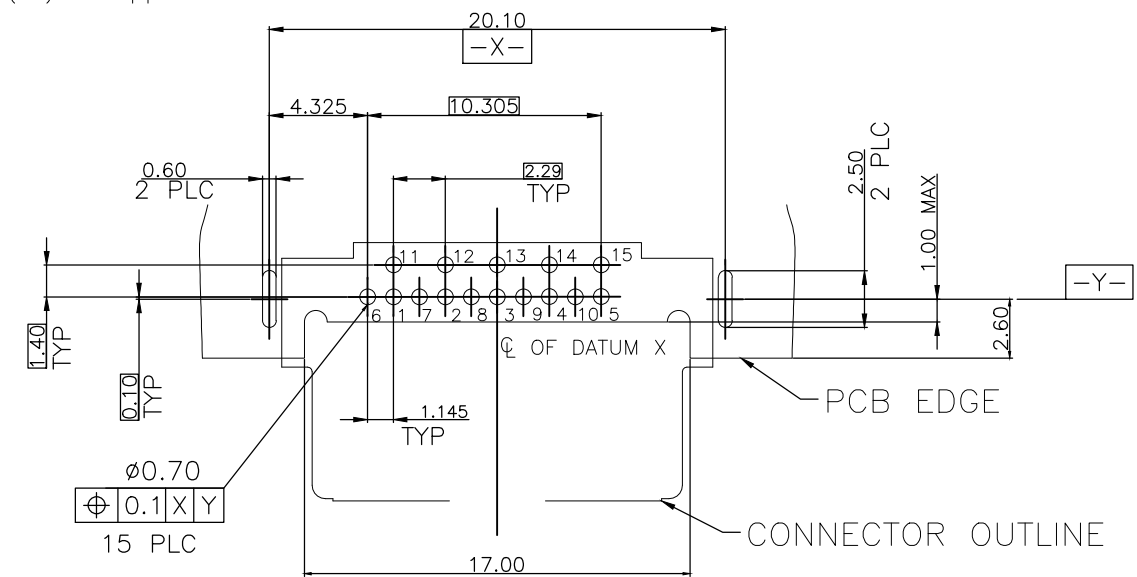
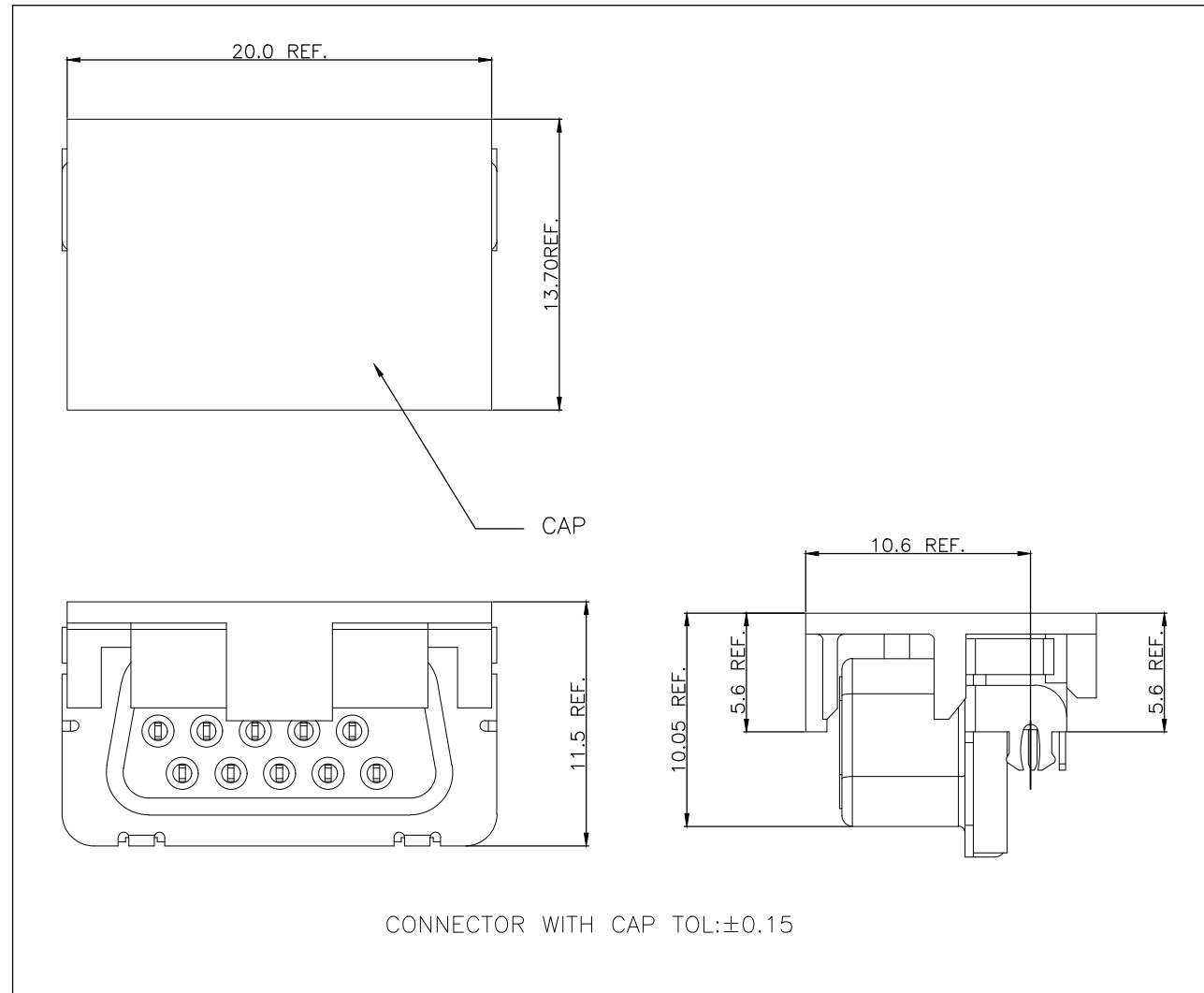

5 RECOMMENDED P.C.B LAYOUT(T=1.20mm)
TOP VIEW, TOLERANCE: ±0.05

OBSOLETE

OBSOLETE	6	LOW HALOGEN	BLACK NICKEL	LCP	LCP	2041127-4
OBSOLETE		WITH	NICKEL	PA9T	PA9T	2041127-1
		HALOGEN	SHELL PLATING	CAP MATERIAL	HOUSING MATERIAL	PART NUMBER

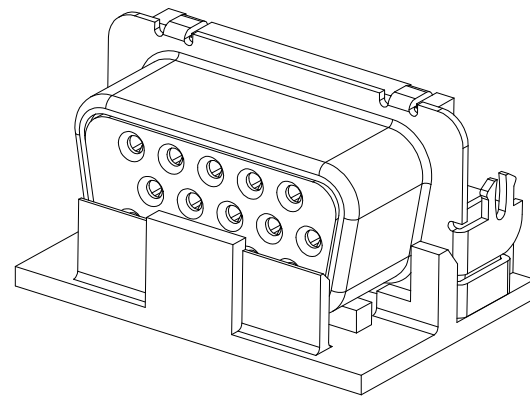

THIS DRAWING IS A CONTROLLED DOCUMENT.		DWN	B. HSING	05MAR2009	TE Connectivity D-SUB, 15P, R/A, SLIM, RVS, DIP					
DIMENSIONS: mm		CHK	S. CHIEN	05MAR2009				NAME		
TOLERANCES UNLESS OTHERWISE SPECIFIED:		APVD	W. KODAMA	05MAR2009				PRODUCT SPEC		
0 PLC ± - 1 PLC ± 0.30 2 PLC ± 0.20 3 PLC ± 0.15 4 PLC ± - ANGLES ± 3 Deg		APPLICATION SPEC		108-57751						
MATERIAL	SEE NOTE	FINISH	SEE NOTE	WEIGHT	0	SIZE	A3			
				CUSTOMER DRAWING	CAGE CODE	00779	DRAWING NO			
				SCALE	1:1	SHEET	1 OF 5			
				RESTRICTED TO		REV	B2			