

10 9 8 7 6 5 4 3 2 1

**NOTES :**

**I- MATERIAL:**

- HOUSING: POLYAMIDE FIBER GLASS FILLED UL 94-V0 COLOR BLACK.
- TERMINAL: PHOSPHOR BRONZE .

**PLATING:**

POST PLATE 0.00127-0.00152/.000050-.000060 GOLD IN CONTACT AREA.  
0.00190/.000075 MIN PURE TIN IN TAIL AREA BOTH OVER 0.00127/.000050 MIN NICKEL OVERALL.

- 2- JACK FOR MATING WITH FCC 68 PLUGS 90075 MOLEX SERIES.
- 3- PCB THICKNESS : 1.57 / .062
- 4- PRODUCT SPECIFICATION PS-95002
- 5- APPLICATION SPECIFICATION AS-95001
- 6- PACKAGING SPECIFICATION PK-95002

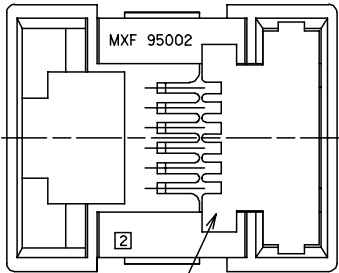

CAP

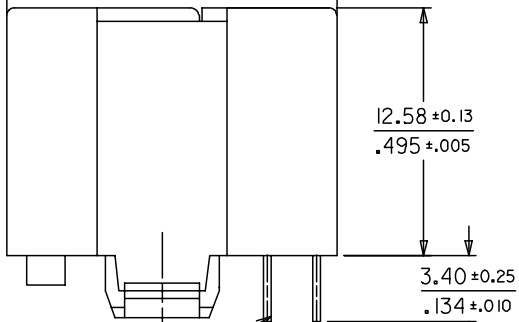
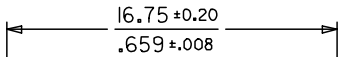

TERMINAL

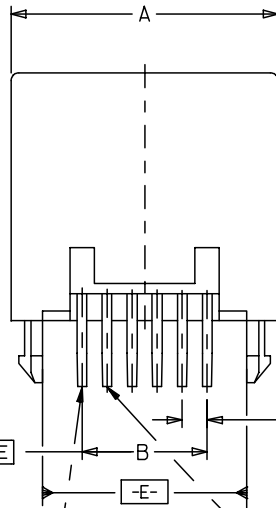
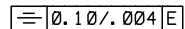

CIRCUIT I (4-CIRCUIT)  
CIRCUIT I (6-CIRCUIT)

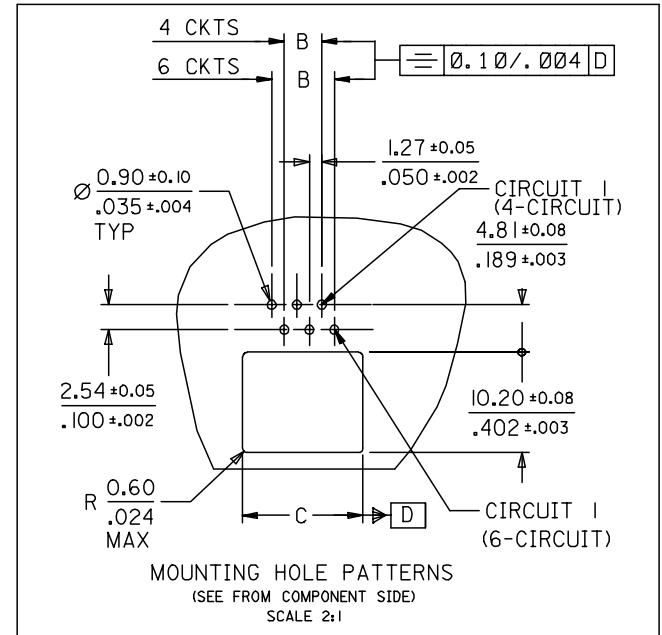

MOUNTING HOLE PATTERNS  
(SEE FROM COMPONENT SIDE)  
SCALE 2:1

P/N	HOUSING SIZE	CKTS	DIM		
			A ±0.13	B $\begin{matrix} +0.05 \\ -0.10 \\ \pm.002 \\ \pm.004 \end{matrix}$	C $\begin{matrix} \pm 0.08 \\ \pm.003 \end{matrix}$
95002-2447	POS 4	4 CKTS	11.50	3.81	10.20
			.453	.150	.402
95002-2647	POS 6	4 CKTS	13.55	3.81	12.20
			.533	.150	.480
95002-2667	POS 6	6 CKTS	13.55	6.35	12.20
			.533	.250	.480

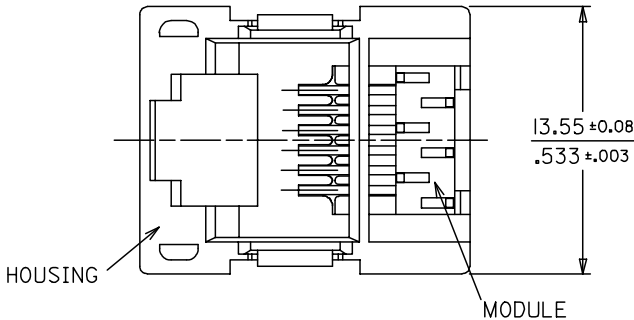

HOUSING

MODULE

<b>ENTER DESCRIPTION</b> EC NO: MG2005-0107 DRAWN: KNOLLER 2004/09/22 CHKD: FCARABET 2004/09/22 APPR: KNOLLER 2004/09/24	<b>QUALITY SYMBOLS</b> ▽=0 ▽=0	<b>GENERAL TOLERANCES (UNLESS SPECIFIED)</b>	DIMENSION STYLE MM/IN	SCALE 4:1	DESIGN UNITS METRIC	THIRD ANGLE PROJECTION
			4 PLACES ± --- ± --- 3 PLACES ± --- ± .006 2 PLACES ± 0.15 ± .010 1 PLACE ± 0.25 ± --- ANGULAR ± .5 °	DRAWN BY ER 99/02/25	DATE 99/02/25	
REV C	DRAFT WHERE APPLICABLE MUST REMAIN WITHIN DIMENSIONS	SEE CHART	MATERIAL NO.	DOCUMENT NO.	SHEET NO.	
			FB 99/02/25	SD-95002-002	1 OF 1	

9 8 7 6 5 4 3 2 1