

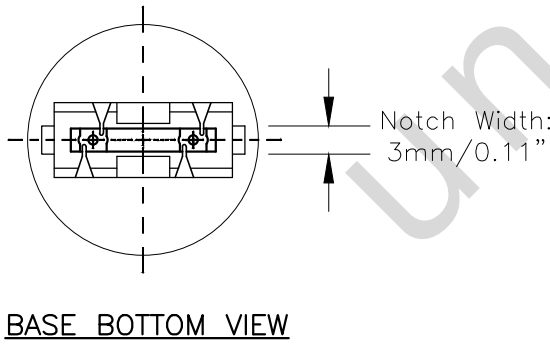

| PART NO. | BASE TYPE | DESIGN VOLTS | DESIGN AMPS | MSCD | FILAMENT TYPE | AVERAGE LIFE HOURS |
|----------|-----------------------------|----------------|----------------------|------------------|---------------|--------------------|
| 4157LL | D.F. Plastic Wedge W2.5X16q | 12.8V 14.0V | 2.23 ±5% 0.59 ±8% | 32±10% 3 ±12% | C-6 C-6 | 4,000 10,000 |

| REVISIONS | | | |
|-----------|--|------------|----------|
| REV # | DESCRIPTION | DATE | APPROVED |
| 1 | ISSUED | 06/26/2006 | D.C. |
| 2 | REVISED TOP AMPS/ADDED FILAMENT DISTANCE | 03/23/2018 | R.M. |
| 3 | ADDED BASE MATERIAL/REVISED LIFE | 03/05/2020 | R.M. |

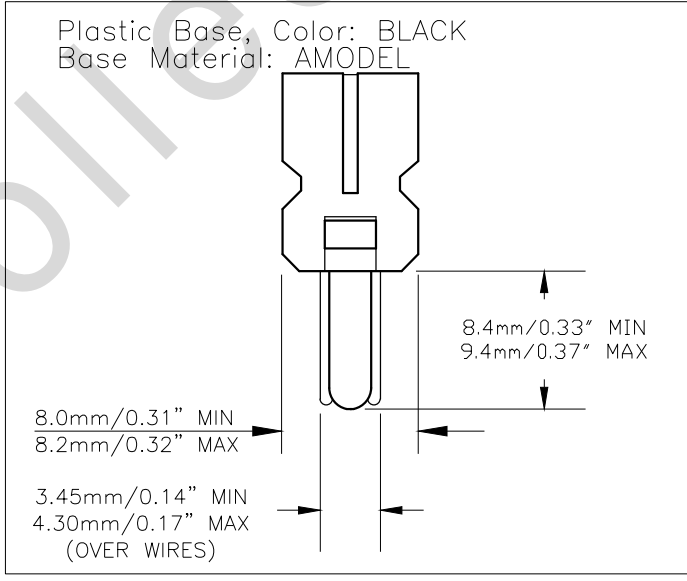
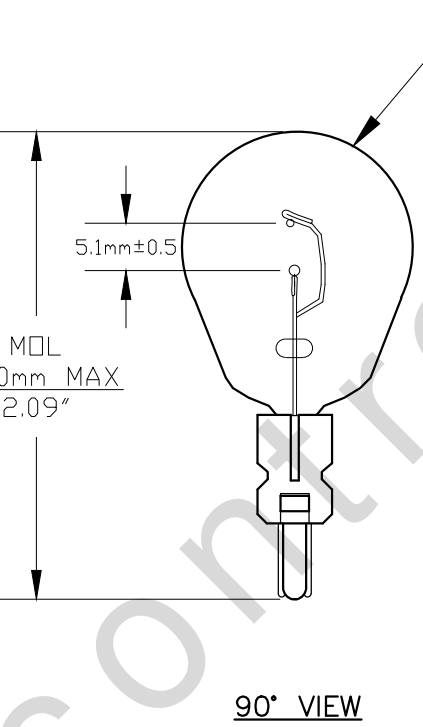
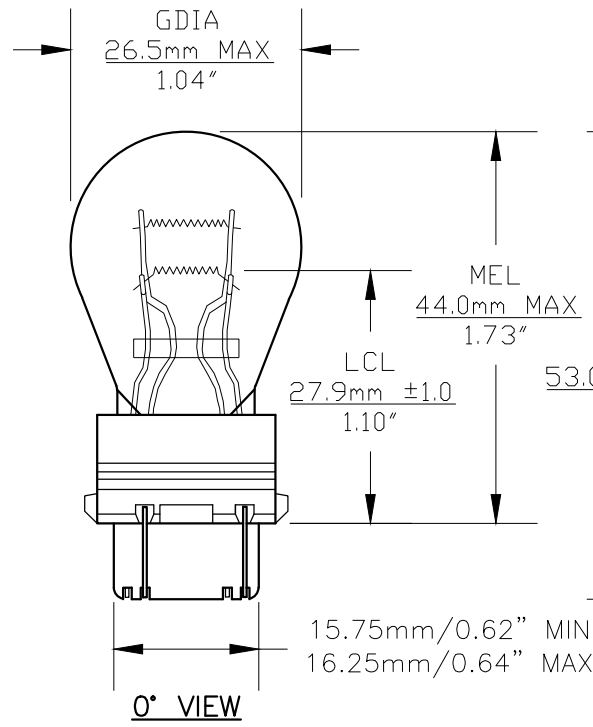

Note: Made according to SAE specifications



| | | | |
|---|-------------------|-----------------------------|-------------------------------|
| UNLESS OTHERWISE SPECIFIED: DIMENSIONS ARE IN INCHES TOLERANCES | | CEC INDUSTRIES LTD | |
| DECIMALS .XX ± .05 | ANGULAR ± 0.5° | 599 BOND STREET | LINCOLNSHIRE, IL 60069 |
| .XXX ± .010 | FRACTIONAL ± 1/64 | TITLE LIGHT BULB NO. 4157LL | |
| DRAWN D. C. | DATE 06/26/2006 | SIZE A | FSCM NO. DWG NO. 4157LL REV 3 |
| CHECKED | DESIGN | SCALE | PLOT SCALE SHEET 1 OF 1 |
| MATERIAL | FILE 4157LL.pdf | DRAWING NOT TO SCALE | |