

APPROVED: \_\_\_\_\_  
 DATE: \_\_\_\_\_ TITLE: \_\_\_\_\_

Rev	AWO #	Description	Date	Appr
-		RELEASED	2/9/21	

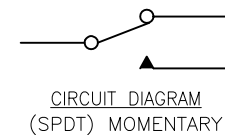

SPECIFICATIONS:  
 Material:  
 Movable Contact: Copper Alloy, Silver Plated  
 Terminal: Copper Alloy, Silver Plated  
 Electrical:  
 Voltage rating: 120VAC or 38VDC  
 Current rating: 1 Amps  
 Contact resistance: 10 m $\Omega$  max  
 Insulation resistance: 1,000 Mohms min  
 Dielectric withstanding voltage: 1,500V RMS @Sea level  
 Temperature Rating:  
 Operating temperature:  $-30^{\circ}\text{C}$  to  $+85^{\circ}\text{C}$   
 Environmental:  
 Lead free, RoHS compliant

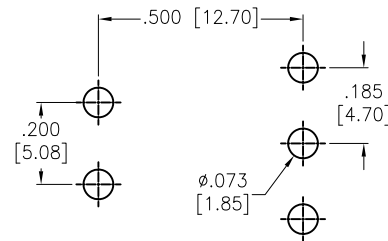
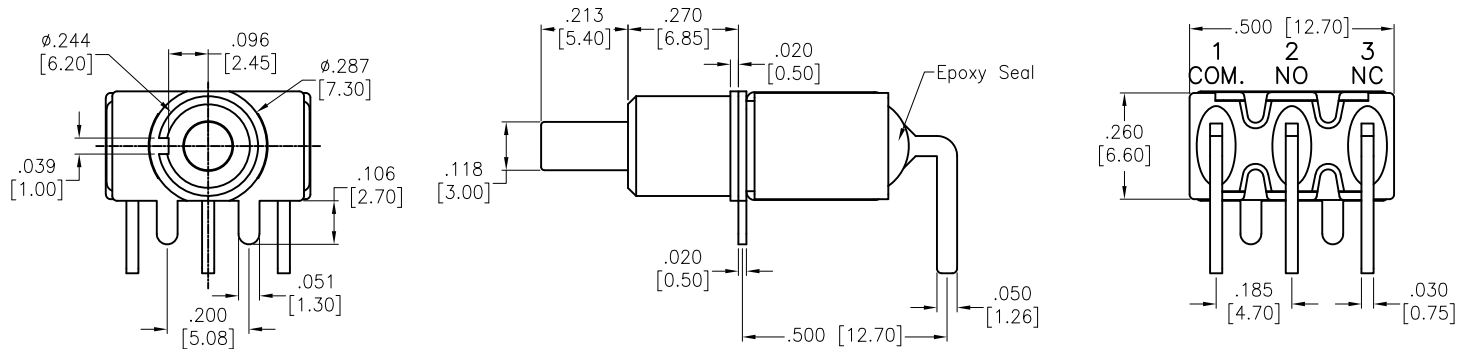

UNLESS OTHERWISE SPECIFIED ALL DIMENSIONS ARE INCHES [MM] TOLERANCES: EXCEPT AS NOTED INCHES HOLES		<b>ADAM</b> <b>TECH</b>		909 Rahway Avenue, Union, NJ 07083 Phone: 908-687-5000 Fax: 908-687-5710	
.X $\pm .10$		$\phi$ .X $\pm .10$		TITLE	
.XX $\pm .020$		$\phi$ .XX $\pm .015$		SNAP-ACTING PUSH BUTTON SWITCH, R/A, THRU-HOLE SPDT, ON-MOMENTARY, SILVER PLATED, PCB TYPE	
.XXX $\pm .015$		$\phi$ .XXX $\pm .010$		SIZE	
APPROVALS		DATE		PART NO.	
DRAWN	LH	2/8/21		SW-PB8-AB00B6QE-1	
CHECKED	AC	2/8/21		REV.	
APPROVED				-	
REF: S00198T		SCALE: NTS		SHEET 1 OF 1	