

| NO. | DATE     | DESCRIPTION       | BY |
|-----|----------|-------------------|----|
| 0   | 08/15/92 | RELEASED NPR 4365 |    |
| 1   |          | WAS 92-5002-001-1 |    |

SCREW #4-40 X 9.52 [L.375] LONG  
MATERIAL: CARBON STEEL  
FINISH: ZINC  
QTY: 2

AMP AND DATE CODE.  
(EITHER SIDE)

SHIELD MATERIAL: ALUMINUM  
FINISH: ANODIZE

SCREW #4-40 X 6.35 [L.250] LONG  
MATERIAL: CARBON STEEL  
FINISH: ZINC  
QTY: 4

CABLE CLAMP  
MATERIAL: CARBON STEEL  
FINISH: 5.08µm [L.000200] MIN ZINC  
QTY: 2

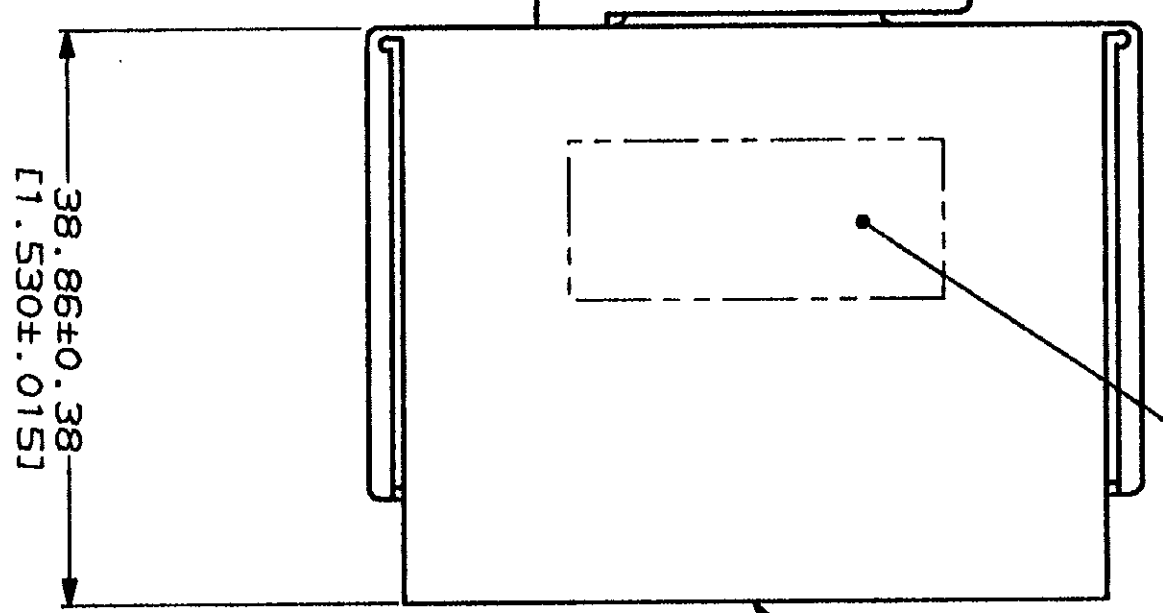
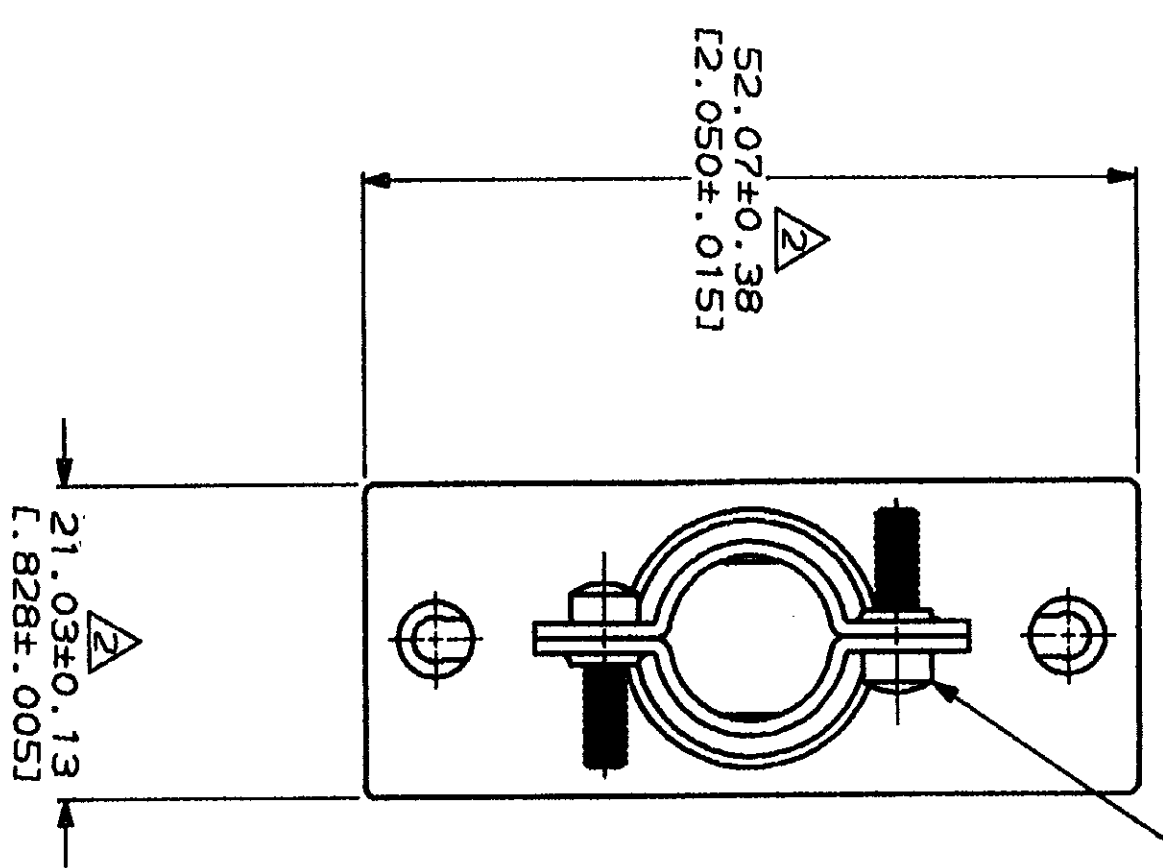

- 1. SCREW PACKAGED SEPARATELY.
- 2. DIMENSION APPLIES AT BASE OF BEND.
- 3. CABLE AREA: 3.787-5.933 [L.1491-.2336] SQ IN.

|   |  |   |                          |                                |                          |              |                  |                        |
|---|--|---|--------------------------|--------------------------------|--------------------------|--------------|------------------|------------------------|
| DO NOT SCALE PRINT.<br>UNLESS SPECIFIED DIMENSIONS IN MM [INCHES]<br>TOLERANCES ON:<br>2 PLC DEC # -<br>3 PLC DEC # -<br>ANGLES # -<br>MATERIAL |  | DR 09/15/92<br>C. DORNHART                      | CHK 09/17/92<br>R. STONE | APPD 09/17/92<br>G. STEINHAUER | APPD 09/17/92<br>C. RHOE | PRODUCT SPEC | APPLICATION SPEC | FINISH<br>SEE CALLOUTS |
| AMP<br>AMP Incorporated<br>Harrisburg, PA 17105-9608  |  | NAME<br>SHIELD KIT,<br>34 POSITION,<br>M SERIES |                          | SIZE<br>CAGE CODE<br>00779     | DRAWING NO<br>C-213753   | SCALE<br>2:1 | WEIGHT           | SEE CALLOUTS           |

213753-1  
PART NO

THIS DRAWING IS A CONTROLLED DOCUMENT FOR THE COMPANY. IT IS THE PROPERTY OF AMP INCORPORATED. IT IS TO BE KEPT IN CONFIDENTIALITY AND NOT TO BE REPRODUCED OR TRANSMITTED IN ANY FORM OR BY ANY MEANS, ELECTRONIC OR MECHANICAL, INCLUDING PHOTOCOPYING, RECORDING, OR BY ANY INFORMATION STORAGE AND RETRIEVAL SYSTEM. WITHOUT THE WRITTEN PERMISSION OF AMP INCORPORATED.