

THIS DRAWING IS A CONTROLLED DOCUMENT.

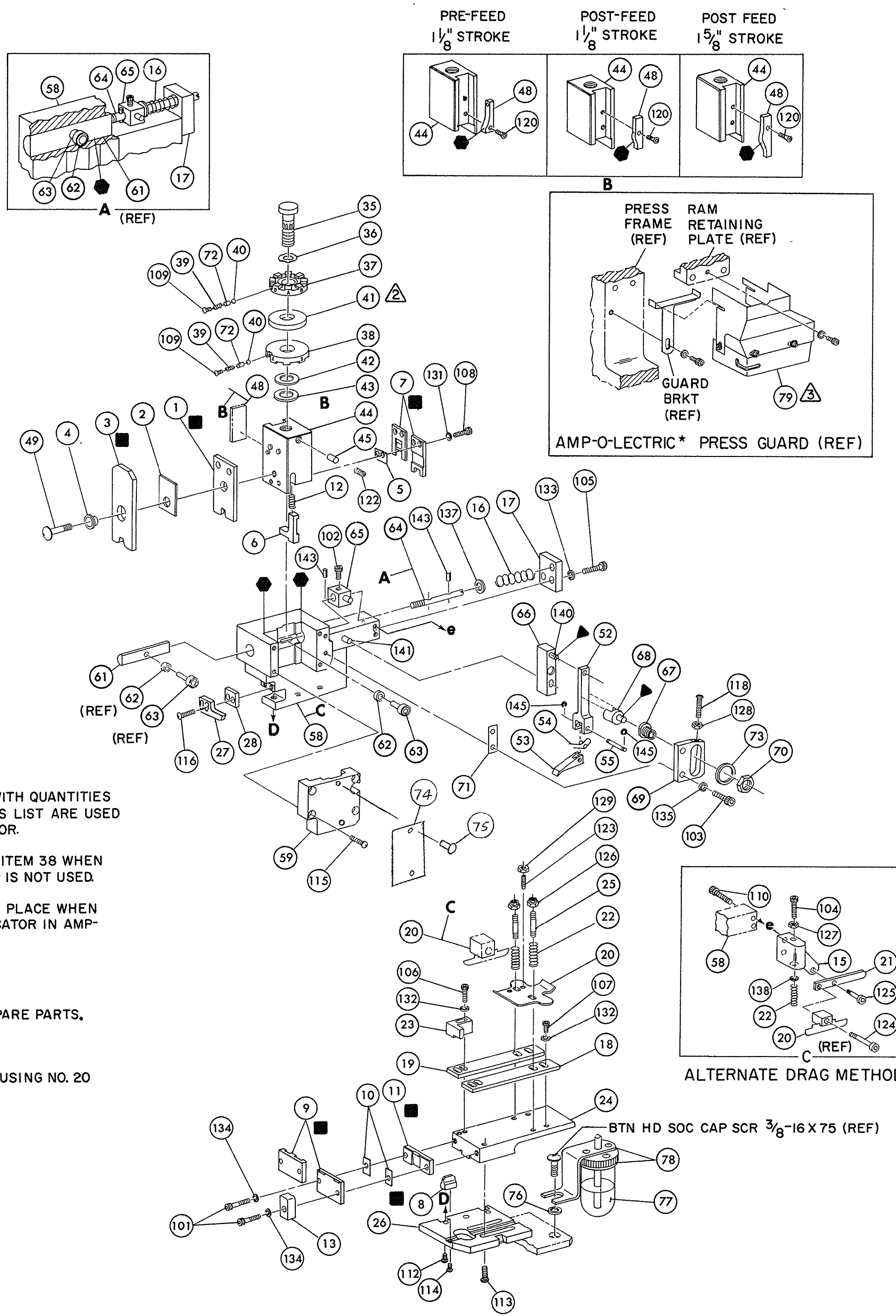

NOTES:

- 1. ONLY THE ITEMS WITH QUANTITIES SPECIFIED ON PARTS LIST ARE USED ON THIS APPLICATOR.
- ▲ USED IN PLACE OF ITEM 38 WHEN INSULATION CRIMP IS NOT USED.
- ▲ GUARD MUST BE IN PLACE WHEN OPERATING APPLICATOR IN AMP-O-LECTRIC PRESS.

KEY:

- RECOMMENDED SPARE PARTS.
- ▲ LUBRICATE DAILY USING NO. 20 MACHINE OIL.
- GREASE LIGHTLY.

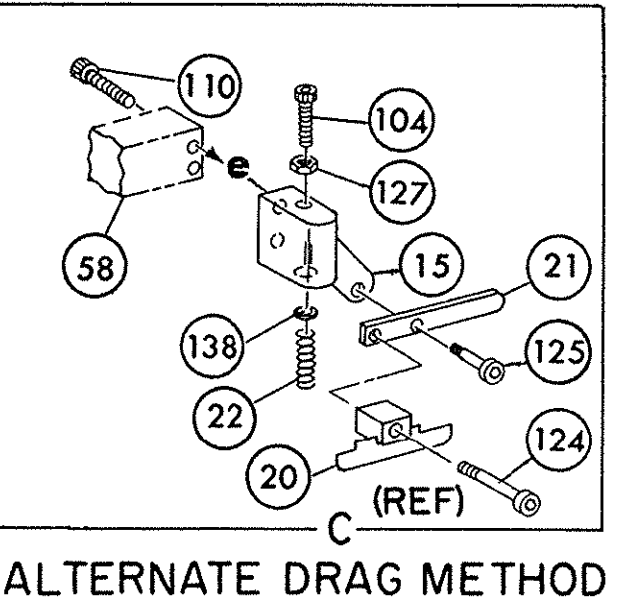

QTY	PART NO	DESCRIPTION	ITEM NO	QTY	PART NO	DESCRIPTION	ITEM NO
2	21045-3	RING, RETAINING 'C' (.187 DIA) FEED PIN	145	1	454220-1	CAP, RAM	59
			144	1	453736-1	HOUSING	58
2	5-21028-1	PIN, SLOT SPG (.12 DIA X .50) FD ADJ ROD	143				57
			142				56
1	1-21030-7	PIN, DOWEL (.187 DIA X 1.50) HOUSING	141	1	240624-1	PIN, FEED FINGER	55
1	1-21030-1	PIN, DOWEL (.187 DIA X .50) LEVER	140	1	691499-1	SPRING, FEED FINGER	54
			139	1	240635-1	FINGER, FEED	53
	22260-5	WASHER, FLAT (NO 6) DRAG SPRING	138	1	240634-1	LEVER, TERMINAL	52
1	21899-4	WASHER, FLAT (5/16 DIA) SCR ADJ	137				51
			136				50
2	21024-5	WASHER, LOCK (NO 10) FEED ADJ PLATE	135	1	7-21002-9	BOLT, CRIMPER	49
2	21024-5	WASHER, LOCK (NO 10) SHEAR PLATES	134	1	690501-4	CAM, POST FEED 1 5/8 STROKE	48
2	21024-5	WASHER, LOCK (NO 10) FEED ROD GUIDE	133				47
5	21024-4	WASHER, LOCK (NO 8) STRIP GUIDE	132				46
2	21024-4	WASHER, LOCK (NO 8) SHEAR BLADE	131	1	690191-1	PLUG, NYLON	45
			130	1	455674-1	RAM	44
2	21018-4	NUT, HEX MACH (4-40) DRAG	129	1	690125-1	WASHER, LAMINATED	43
1	21068-5	NUT, HEX MACH (6-32) FD ADJ PLATE	128	1	690124-1	WASHER, RAM	42
	21018-7	NUT, HEX MACH (10-32) DRAG SPRING	127			SPACER, DISC	41
2	21022-2	NUT, HEX SELF-LKG (8-32) DRAG STUD	126	2	23241-6	BALL, STEEL	40
	5-21004-7	SCR, SKT HD SHLD (250 DIA X .25) DRAG ARM	125	2	690170-1	SPRING, COMPRESSION	39
	21004-5	SCR, SKT HD SHLD (250 DIA X 1.00) DRAG	124	1	690142-1	DISC, INSULATION	38
2	4-21078-8	SCR, SKT SET OVAL POINT (4-40 X .75) DRAG	123	1	1-692155-3	DISC, WIRE	37
1	22651-9	SCR, SKT SET (1/4-20 X 25) (LOC-WEL) RAM	122	1	22480-5	WASHER, SPRING	36
			121	1	690212-1	POST, RAM	35
1	1-21002-7	SCR, BTN HD SKT CAP (6-32 X .38) CAM	120				34
			119				33
1	3-21064-2	SCR, RD HD MACH (6-32 X 1.50) FEED ADJ	118			APPLICATOR, BASIC (SUB ASSY)	32
			117				31
2	2-21002-2	SCR, BTN HD SKT CAP (8-32 X .50) STRIPPER	116				30
4	2-21002-9	SCR, BTN HD SKT CAP (10-32 X .75) HSG CAP	115				29
1	24073-2	SCR, BTN HD SKT CAP (8-32 X .38) (LOC-WEL) ANVIL	114	1	3-690451-2	SPACER, STRIPPER	28
4	3-21002-3	SCR, BTN HD SKT CAP (1/4-20 X .50) STR GDE PL	113	1	240639-1	STRIPPER	27
3	1-24073-9	SCR, BTN HD SKT CAP (1/4-20 X .75) BASE PL	112	1	455676-1	PLATE, BASE	26
			111	2	22354-8	DRAG, STUD	25
	2-21000-4	SCR, SKT HD CAP (6-32 X 1.00) DRAG ADAPTOR	110	1	455678-1	PLATE, STRIP GUIDE	24
2	3-23657-8	SCR, SKT HD CAP (6-32 X .25) (LOC-WEL) CP DISC	109	1	240825-1	PLATE, STRIP HOLD	23
2	2-21000-9	SCR, SKT HD CAP (8-32 X .75) SHEAR BLADE	108	2	4-22281-1	SPRING, DRAG	22
3	2-21000-6	SCR, SKT HD CAP (8-32 X .38) STRIP GUIDE	107		240636-1	LEVER, DRAG	21
2	2-21000-9	SCR, SKT HD CAP (8-32 X .75) STRIP GUIDE	106	1	454177-1	DRAG, STOCK	20
2	3-21000-7	SCR, SKT HD CAP (10-32 X .75) FD ROD GUIDE	105	1	458030-5	GUIDE, STRIP (REAR)	19
	3-21000-9	SCR, SKT HD CAP (10-32 X 1.00) DRAG SPRING	104	1	458031-5	GUIDE, STRIP (FRONT)	18
2	3-21000-6	SCR, SKT HD CAP (10-32 X .62) FD ADJ PLATE	103	1	454178-1	GUIDE, FEED ROD	17
1	3-21000-4	SCR, SKT HD CAP (10-32 X .38) PIVOT BLK	102	1	4-22284-9	SPRING, FEED RETURN	16
2	3-21000-8	SCR, SKT HD CAP (10-32 X .88) SHEAR PLATE	101			ADAPTER, DRAG	15
REF	455745-1	GUARD, WINDOW	79				14
	465184-9	LUBRICATOR ASSY	78			SPACER, HOLD DOWN	13
	455985-1	OIL, LUBRICATING	77			SPRING, HOLD DOWN	12
	454406-1	SPACER, LUB BRACKET	76	1	240644-1	PLATE, REAR SHEAR	11
2	21017-2	SCR, DRIVE (#2 X .19) ID PLATE	75			SPACER, SHEAR PLATE	10
1	461264-1	PLATE, IDENTIFICATION	74	1	690482-4	PLATE, FRONT SHEAR	9
1	458109-1	WASHER, FLAT (SPECIAL)	73	1	2-240693-3	ANVIL	8
2	690603-1	SPRING, ASSIST	72	1	690474-4	BLADE, SLUG	7
1	690517-1	SPACER	71			HOLD DOWN, TERMINAL	6
1	22594-8	NUT, HEX	70	1	5-240641-5	SPACER, SHEAR BLADE	5
1	240628-1	PLATE, ADJ	69	1	238009-1	SPACER, TUBULAR	4
1	240626-1	SHAFT, PIVOT	68	1	456134-6	CRIMPER, INSULATION	3
1	240633-1	BUSHING	67	1	455888-5	SPACER, INSULATION	2
1	455680-1	LEVER, INTERMEDIATE	66	1	456408-6	CRIMPER, WIRE	1
1	240629-1	BLOCK, PIVOT	65				
1	240632-2	SCREW, ADJ	64				
1	240659-3	PIN, CAM ROLLER	63				
1	240658-1	CAM, ROLLER	62				
1	454398-1	ROD, FEED	61				
			60				

REMARKS		NO	REV
APPL USED ON MACHINE PART NO		TO APPLY TERMINAL SPEC 114-5052	
CUSTOMER NAME		DISTRIBUTION	
ADDRESS		ORIGINAL	
CITY		CUSTOMER COPY	
		FIELD ENG COPY	

CRIMPING DATA					APPLICATOR WILL APPLY	
PAD LTR	CRIMP HEIGHT	WIRE SIZE	WIRE STRIP LENGTH	170030		
A	1.68	2.0				
B	1.55	1.75				
C	1.42	.85				
D	1.35	.5				
CRIMP	SIZE	TYPE	FEED	APPL INST		
WIRE	.110	F	1.040	A1 8039		
INSUL	.180	F				
WIRE RANGE	INSULATION RANGE	PRESS NO				
18-14	.085-.135					

REMARKS: AMPOMATOR

WIRE RANGE: 18-14 INSULATION RANGE: .085-.135 PRESS NO: [blank]

REVISION RECORD:

REV	DATE	DESCRIPTION
1	10/14/88	REV PER ECN R2859
2	11/18/88	REV PER ECN R2859

SET UP GAGE: 10-1 458638-1 59

DR: [blank]

CHKG: [blank]

LOC: [blank]

NO: 466249-1

NAME: MINIATURE QUICK CHANGE APPLICATOR

END FEED (.250 FASTON TAB)