

4

3

2

1

| REVISIONS | | |
|-----------|---------------------------|------------|
| LTR | DESCRIPTION | DATE |
| C | REVISED PER ECO-11-009061 | 05/02/2011 |

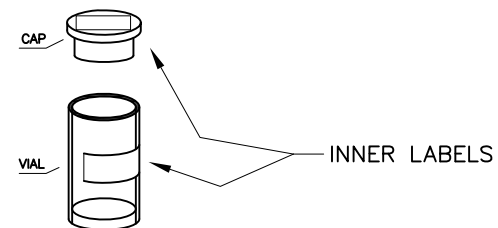
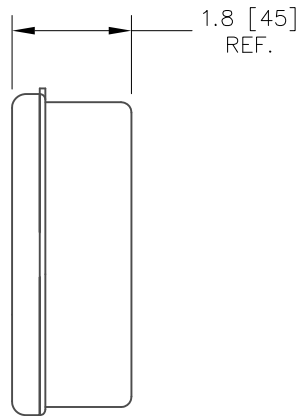
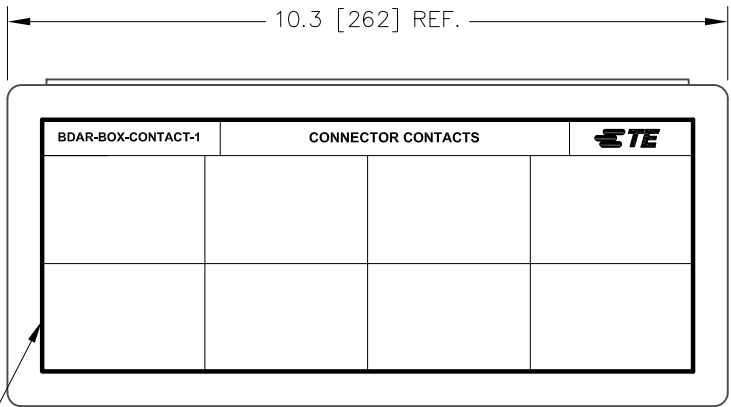
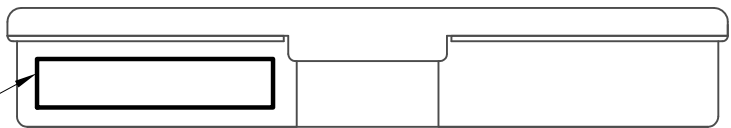
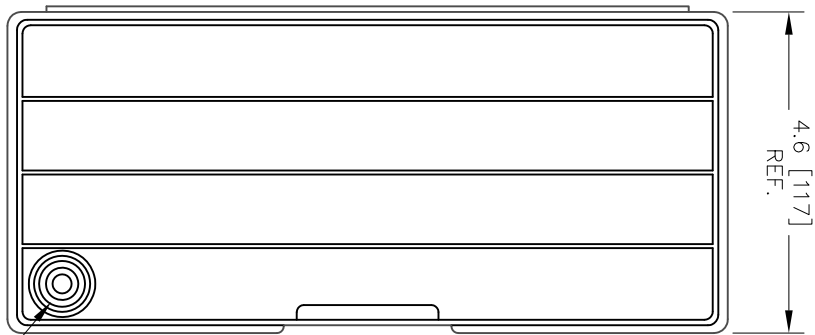

FIGURE 1: VIAL KIT



OUTER LABELS



ROUND VIAL AND CAP (SEE FIGURE 1: VIAL KIT)

NOTES:

1. EACH LINE ITEM SHALL BE PACKAGED AND LABELED IN INDIVIDUAL VIAL KIT.
2. SEE PAGE 2 FOR COMPONENTS' NSN, PART NUMBERS AND DESCRIPTIONS.

Raychem Devices
CUSTOMER DRAWING



| | | | |
|---|--------------------|--|----------------------------------|
| UNLESS OTHERWISE SPECIFIED DIMENSIONS ARE INCHES. METRIC DIMENSIONS ARE IN BRACKETS. DECIMAL TOLERANCES .XXX ± 0.005 [0.13 mm] .XX ± 0.01 [0.25 mm] .X ± 0.1 [0.50 mm] ANGLE TOLERANCE ANGLE ± 1 DEG. | REVISED UNGUYEN | TE Connectivity TITLE BDAR-BOX-CONTACT-1 | |
| | RPN 912922-000 | | |
| THIRD ANGLE PROJECTION | SIZE B | CODE IDENT. NO. 06090 | DWG. NO. MK-0020-101-CONTACT1 |
| © 2005-2011 Tyco Electronics Corporation. All rights reserved. | | SCALE: NTS | DO NOT SCALE THIS DRAWING |

If this document is printed it becomes uncontrolled. Check for the latest revision

4

3

2

1

4

3

2

1

TABLE 1: COMPONENTS

| ITEM | CUSTOMER PART NUMBER | NSN | DESCRIPTION | QTY |
|------|----------------------|------------------|-------------------|-----|
| 1 | 031-0900-001 | 5999-00-972-3361 | CONNECTOR CONTACT | 10 |
| 2 | 031-0905-000 | 5999-01-028-6782 | CONNECTOR CONTACT | 10 |
| 3 | M39029/70-388 | 5999-01-139-1579 | CONNECTOR CONTACT | 10 |
| 4 | M39029/69-385 | 5999-01-135-5053 | CONNECTOR CONTACT | 10 |
| 5 | CNS081900 | NA | CONNECTOR CONTACT | 10 |
| 6 | WTK2222S | 5999-00-005-3273 | CONNECTOR CONTACT | 10 |
| 7 | M28804/9-1 | 5999-01-106-7638 | CONNECTOR CONTACT | 10 |
| 8 | M28804/10-1 | 5999-01-110-7182 | CONNECTOR CONTACT | 10 |
| 9 | M39029/1-100 | 5999-00-402-2563 | CONNECTOR CONTACT | 35 |
| 10 | M39029/1-101 | 5999-00-137-5066 | CONNECTOR CONTACT | 25 |
| 11 | M39029/1-102 | 5999-01-032-1188 | CONNECTOR CONTACT | 15 |
| 12 | M39029/1-507 | 5999-01-193-0286 | CONNECTOR CONTACT | 10 |
| 13 | M39029/4-110 | 5999-00-146-8592 | CONNECTOR CONTACT | 10 |
| 14 | M39029/4-111 | 5999-00-172-8254 | CONNECTOR CONTACT | 10 |
| 15 | M39029/4-113 | 5999-00-408-5585 | CONNECTOR CONTACT | 10 |
| 16 | M39029/5-115 | 5999-00-172-8253 | CONNECTOR CONTACT | 15 |
| 17 | M39029/5-116 | 5999-01-045-3132 | CONNECTOR CONTACT | 10 |
| 18 | M39029/5-118 | 5999-01-070-3057 | CONNECTOR CONTACT | 10 |
| 19 | M39029/16-167 | 5999-01-007-6659 | CONNECTOR CONTACT | 35 |
| 20 | M39029/16-168 | 5999-01-041-6616 | CONNECTOR CONTACT | 25 |

TABLE 2: COMPONENTS (CONTINUED)

| ITEM | CUSTOMER PART NUMBER | NSN | DESCRIPTION | QTY |
|------|----------------------|------------------|-------------------|-----|
| 21 | M39029/16-169 | 5999-01-007-2673 | CONNECTOR CONTACT | 10 |
| 22 | M39029/18-177 | 5999-00-264-4881 | CONNECTOR CONTACT | 35 |
| 23 | M39029/18-178 | 5999-01-021-7037 | CONNECTOR CONTACT | 25 |
| 24 | M39029/18-179 | 5999-01-007-1982 | CONNECTOR CONTACT | 15 |
| 25 | M39029/22-191 | 5999-01-068-9548 | CONNECTOR CONTACT | 50 |
| 26 | M39029/22-192 | 5935-01-471-3669 | CONNECTOR CONTACT | 35 |
| 27 | M39029/22-193 | 5999-01-068-5196 | CONNECTOR CONTACT | 15 |
| 28 | M39029/29-212 | 5999-01-068-2590 | CONNECTOR CONTACT | 10 |
| 29 | M39029/29-213 | 5999-01-119-6239 | CONNECTOR CONTACT | 10 |
| 30 | M39029/30-217 | 5999-01-041-3754 | CONNECTOR CONTACT | 10 |
| 31 | M39029/30-218 | 5999-01-089-0801 | CONNECTOR CONTACT | 10 |
| 32 | M39029/30-219 | 5999-00-190-1887 | CONNECTOR CONTACT | 10 |
| 33 | M39029/31-229 | 5999-00-901-3238 | CONNECTOR CONTACT | 10 |
| 34 | M39029/31-235 | 5999-00-905-1879 | CONNECTOR CONTACT | 10 |
| 35 | M39029/31-627 | 5999-00-901-3239 | CONNECTOR CONTACT | 10 |
| 36 | M39029/32-248 | 5999-00-892-8156 | CONNECTOR CONTACT | 10 |
| 37 | M39029/32-254 | 5999-00-975-0554 | CONNECTOR CONTACT | 10 |
| 38 | M39029/32-260 | 5999-00-812-2082 | CONNECTOR CONTACT | 10 |
| 39 | M39029/56-348 | 5999-00-320-7459 | CONNECTOR CONTACT | 25 |
| 40 | M39029/56-351 | 5999-00-152-9574 | CONNECTOR CONTACT | 15 |

Raychem Devices
CUSTOMER DRAWING

If this document is printed it becomes uncontrolled. Check for the latest revision

| | | | |
|--|-------------------|---------------------------|----------------------------------|
| SIZE B | DWG. NO. 06090 | REV C | DWG. NO. MK-0020-101-CONTACT1 |
| SCALE: NTS | | DO NOT SCALE THIS DRAWING | |
| | | SHEET 2 OF 2 | |
| © 2005-2011 Tyco Electronics Corporation. All rights reserved. | | | |

4

3

2

1