

F

E

D

C

B

A

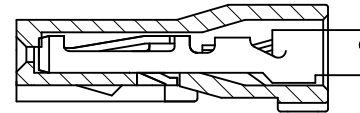
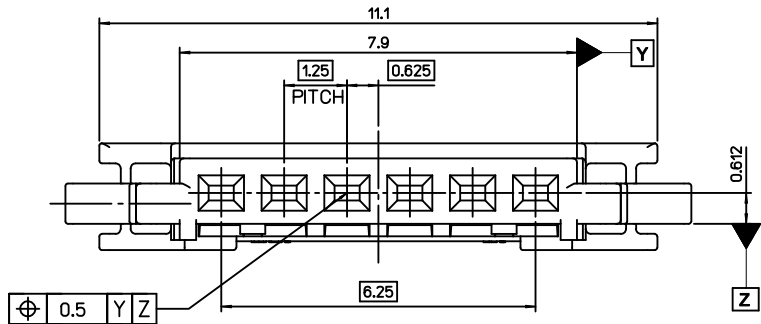

TERMINAL ASSEMBLY DRAWING
[REFERANCE]

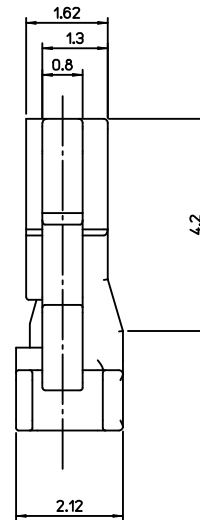
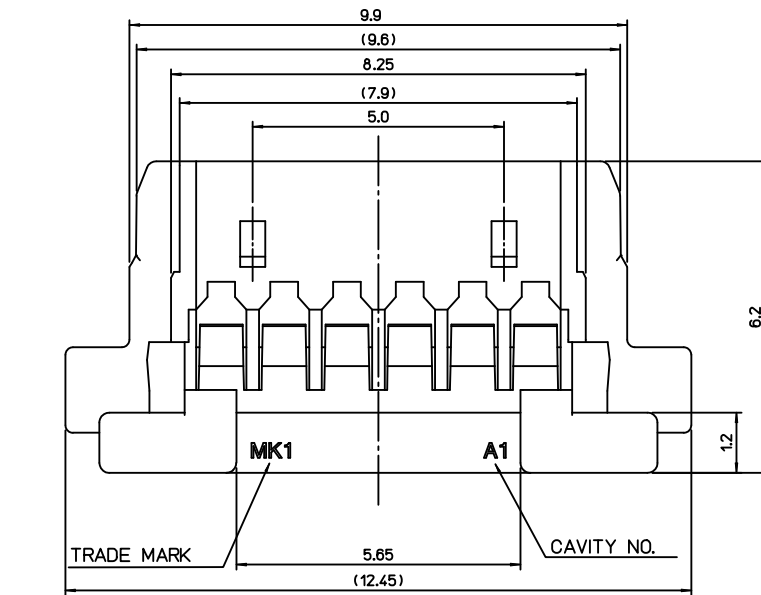
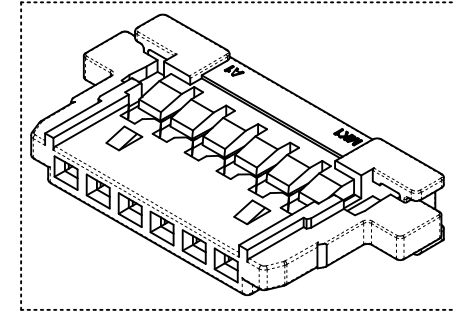

NOTES

- MATED WITH : 104078-0610
- MATERIALS
LIQUID CRYSTALPOLYMER (LCP,E130I)
GLASS FILLED,UL94V-0, NATURAL COLOR
- APPLICABLE TERMINAL : 104505-8003

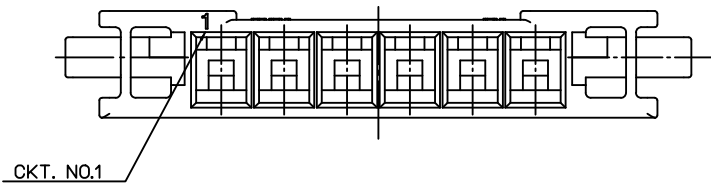

CKT. NO.1

NEW RELEASED
EC NO: KOR2011-0057
DRWN:CBCHIN 2010/12/02
CHKD:SH. CHU 2010/12/02
APPR:YUNSIKKIM 2010/12/02

QUALITY SYMBOLS
▽=0
▽=0

GENERAL TOLERANCES (UNLESS SPECIFIED)	
	mm
4 PLACES	± 0.15
3 PLACES	± 0.20
2 PLACES	± 0.25
1 PLACE	± 0.30
ANGULAR ± 1°	

DRAFT WHERE APPLICABLE
MUST REMAIN
WITHIN DIMENSIONS

DIMENSION STYLE	
MM ONLY	
DRAWN BY	DATE
JB. JIN	2010/06/29
CHECKED BY	DATE
SH. CHU	2010/06/29
APPROVED BY	DATE
YS00. KIM	2010/06/29
MATERIAL NO.	
1040770610	

SCALE	DESIGN UNITS	TITLE
10:1	METRIC	

ORDER NUMBER 104077-0610

THIRD ANGLE PROJECTION

1.25 W-T-B CONN.
HOUSING-6P
JIG TYPE

MOLEX INCORPORATED

DOCUMENT NO. SD-104077-002

SHEET NO. 1 OF 01