

PART NUMBER
94927-088LF & 94927-088BLF

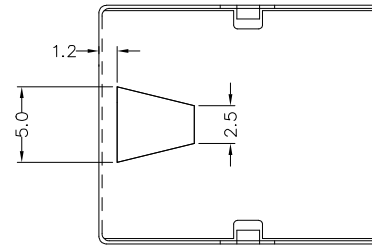

NOTES:

1. RECOMMENDED P.C.B. THICKNESS 1.60 MM
2. HOUSING MAT'L: NYLON 66, 25% GLASS REINFORCED.
3. CONTACTS: PHOS BRONZE ALLOY UNS-C51000, ϕ 0.460 ROUND WIRE, PLATING SEE TABLE.
- ④ METAL SHELL MATERIAL:
COPPER ALLOY, 0.20MM THICK.
FINISH: FOR 94927-XXX,TIN-LEAD, 100u" THICK MIN.
FOR 94927-XXX(B)LF,PURE BRIGHT TIN 80u" THICK MIN.
- ⑤ INSULATED TAPE: 3M COMPANY TAPE #5
6. PACKAGING PER GES-14-361, USING TUBE
7. IF LF P/N THE PRODUCT MEETS EUROPEAN UNION DIRECTIVES AND OTHER COUNTRY REGULATIONS AS DESCRIBED IN GS-22-008
8. THE HOUSING WILL WITHSTAND EXPOSURE TO 260° PEAK TEMPERATURE FOR 10 SECONDS IN A WAVE SOLDER APPLICATION WITH A 1.60mm MINIMUM THICK CIRCUIT BOARD
9. IF LF P/N PACKAGING MEETS GS-14-920 SPECIFICATION

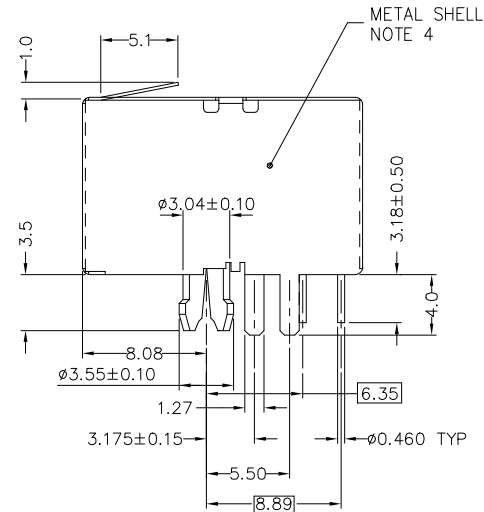
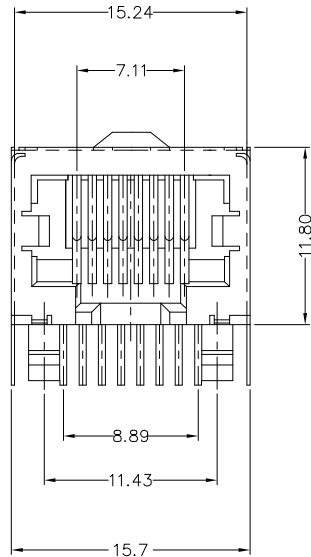

METAL SHELL
NOTE 4

INSULATED TAPE
NOTE 5

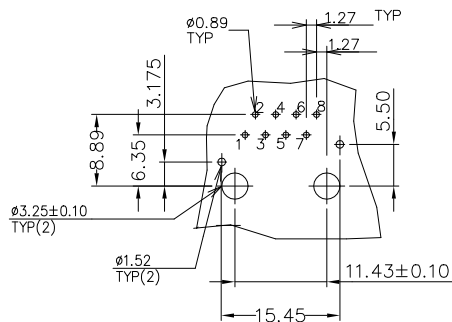

P.C.B. HOLE PATTERN VIEWED FROM TOP.

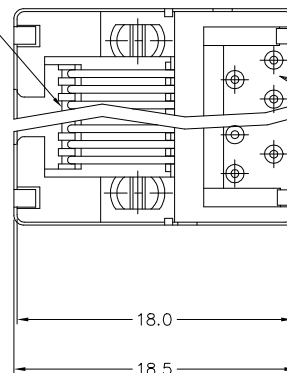

MOD JACK ASS'Y

PRODUCT NO	NUMBER OF POS.	LOADED POSITION	PLATING	HOUSING COLOR
94927-088	8	ALL POS.	5u" Au + high performance lubricant	GRAY
94927-088LF				
94927-088BLF	8	ALL POS.	5u" Au + high performance lubricant	BLACK

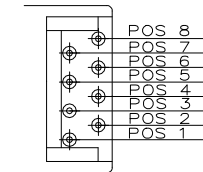

POS. NO. CONFIGURATION

mat'l. code		surface	tolerance	projection	product family
		ISO 1302	ISO 406/ISO 1101		MOD JACK
ltr	ecn no	dr	date	tolerances unless otherwise specified	title
B	T50286	CL	10/20/95	angles	LOW PROFILE PCB III 8 POS
C	T03-0443	WL	10/06/03	linear	MOD JACK, FULLY SHIELDED
D	N05-0030	YS	02/05/05	0° ± 2'	scale 1:1
E	ELX-N-011003	SH MIAO	03/25/12	dr	CL FENG 03/06/95
F	ELX-N-35956	DW	01/21/20	eng	TONY CHIEN 03/06/95
				chr	TONY CHIEN 03/06/95
				appd	JENN TSAO 03/06/95
sheet index	revision sheet	F	1	Amphenol FCI	
					product family
					MOD JACK
					title
					LOW PROFILE PCB III 8 POS
					MOD JACK, FULLY SHIELDED
					dwg no
					94927
					sheet 1 of 1
					size
					A4
					type
					Product Customer Drawing