

This document is the property of Amphenol Corporation and is delivered on the express condition that it is not to be disclosed, reproduced or used, in whole or in part, for manufacture or sale by anyone other than Amphenol Corporation without its prior consent, & that no right is granted to disclose or to use any information in this document.

CUSTOMER DRAWING

REVISIONS

SYM	ECN	DESCRIPTION	DATE	APPROVED
4	CDXXXX	FOLLOW SFF TA 1002 V1.1	Feb.02,2018	YH
5	CDXXXX	ADD AIC CARD	May.28,2018	YH
6	CDXXXX	REVISE THE BOARD LOCK LENGTH	Jul.04,2018	YH
7	CDXXXX	REVISE THE PCB GOLD FINGER	Jul.18,2018	YH
8	CDXXXX	REVISE THE DRAWING	Jul.18,2018	YH
9	CDXXXX	UPDATED BY SFF TA 1002 REV 1.1.2	Oct.12,2018	YH
10	CD1489	UPDATED BY SFF TA 1002 REV 1.1.3	Nov.08,2018	YH
11	CD1763	ADD PACKING	Jul.14,2019	YH

D

D

C

C

B

B

A

A

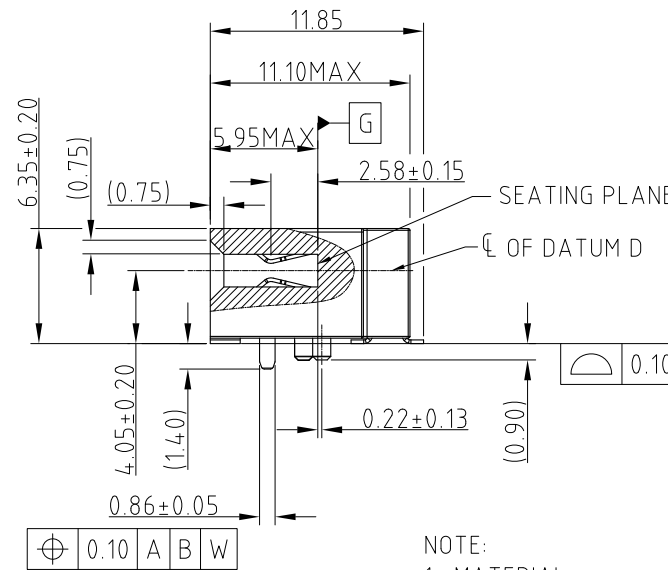
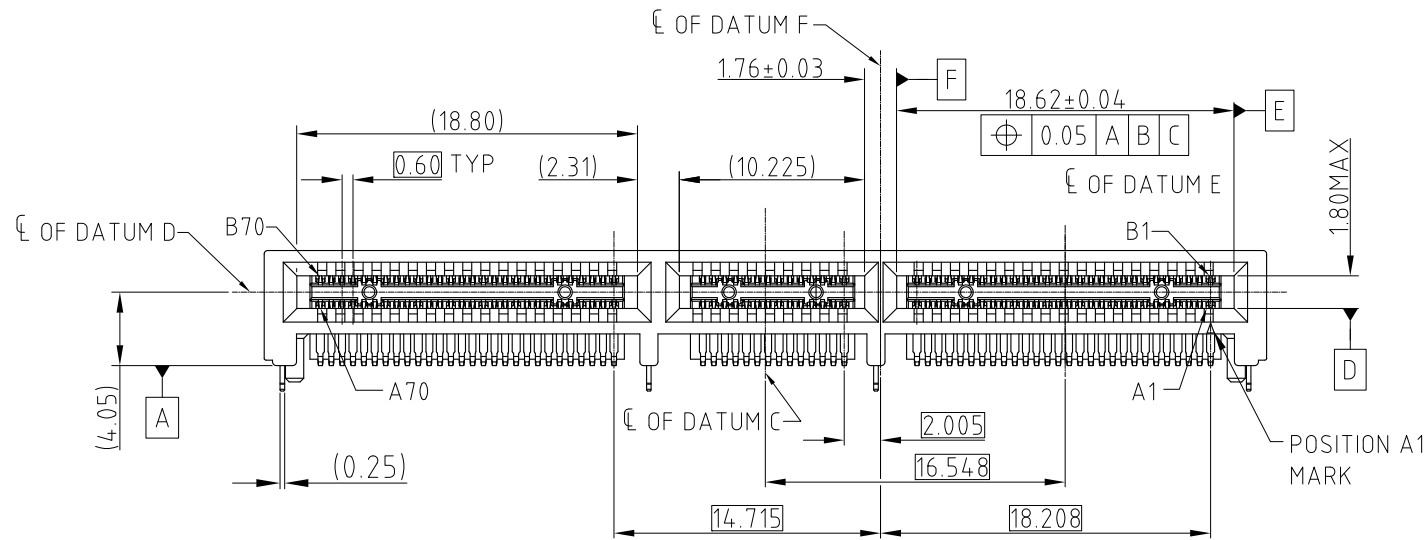
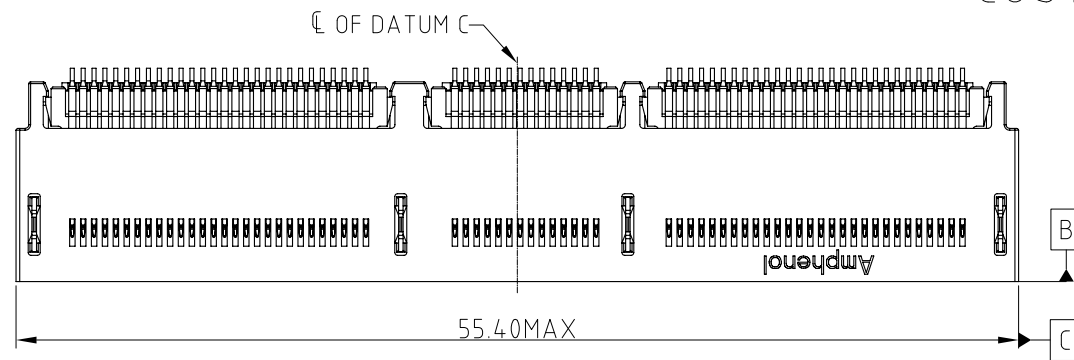

- NOTE:
- MATERIAL:
HOUSING: HIGH TEMPERATURE THERMOPLASTIC BLACK UL94-V0
CONTACT: COPPER ALLOY
BOARD LOCK: COPPER ALLOY
 - PLATING:
CONTACT: MATING AREA: Au THICKNESS PLEASE REFER TO PN SYSTEM, 1.27-2.54 μm NICKEL UNDERPLATED
SOLDER AREA: 1.27 μm MIN TIN OVER 1.27-2.54 μm NICKEL UNDERPLATED
BOARD LOCK: 1.27 MIN TIN OVER 1.27-2.54 μm NICKEL UNDERPLATED
 - ELECTRICAL PERFORMANCE:
RATED CURRENT: 1.1A/PIN UP TO 12PINS
LLCR: 30mΩ MAX, DELTA 15 mΩ.
INSULATION RESISTANCE: 1000MΩ MIN
 - DURABILITY: 200 CYCLES.
 - MATERIAL SHOULD BE FULFILLED AMPHENOL SPEC# S-SN-002 AND S-SN-004
 - ORDERING PN SYSTEM: ME101401020103X

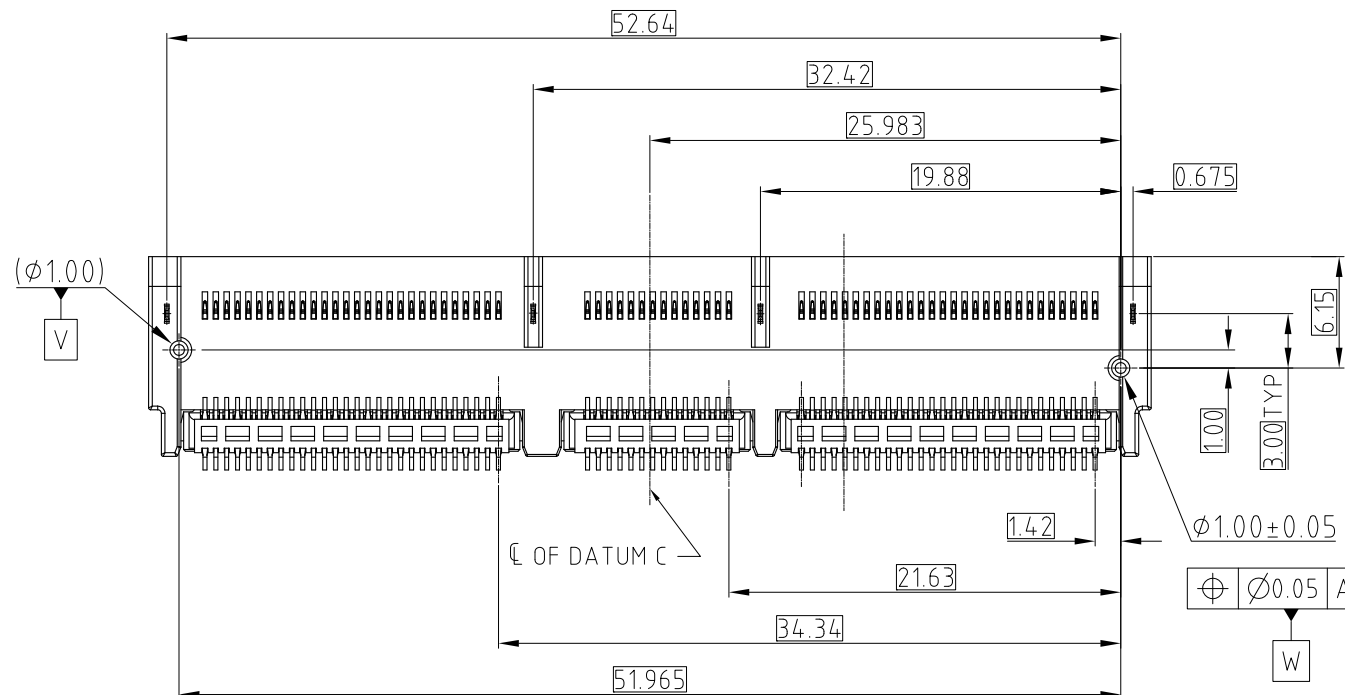

UNLESS OTHERWISE SPECIFIED TOLERANCES	
U.S.	METRIC
.X +/-	0.25
.XX +/-	0.20
.XXX +/-	0.15
FRACTIONS +/-	5°
ANGLES +/-	

FOR MATERIALS AND FINISHES SEE NOTES

REMOVE SHARP EDGES	
DIMENSIONS	
U.S.	INCHES
(METRIC)	(mm)

APPROVAL		DATE
DRAWN	Teng.Cao	Jul.14,2019
CHECKED	Ly.Yi	Jul.14,2019
APPROVED		
DRAWING FILE :		
INTERNAL\DRAWING\ME\C ME101401020103X		
ANGLE OF PROJECTION		

Amphenol		
TITLE		
MINI COOL EDGE CONNECTOR		
140P R/A 0.6MM PITCH 4.05		
SIZE	DRAWING NO.	REV.
A3	C ME101401020103X	11
SCALE	NONE	SHEET 1 OF 3

This document is the property of Amphenol Corporation and is delivered on the express condition that it is not to be disclosed, reproduced or used, in whole or in part, for manufacture or sale by anyone other than Amphenol Corporation without its prior consent, & that no right is granted to disclose or to use any information in this document.

CUSTOMER DRAWING

REVISIONS				
SYM	ECN	DESCRIPTION	DATE	APPROVED
		SEE SHEET 1		

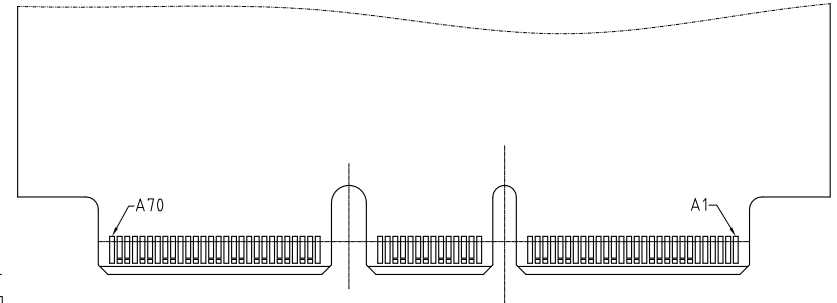
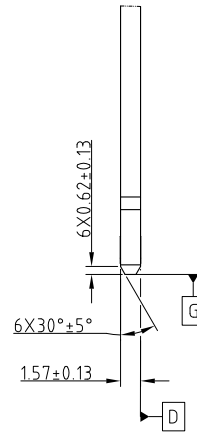
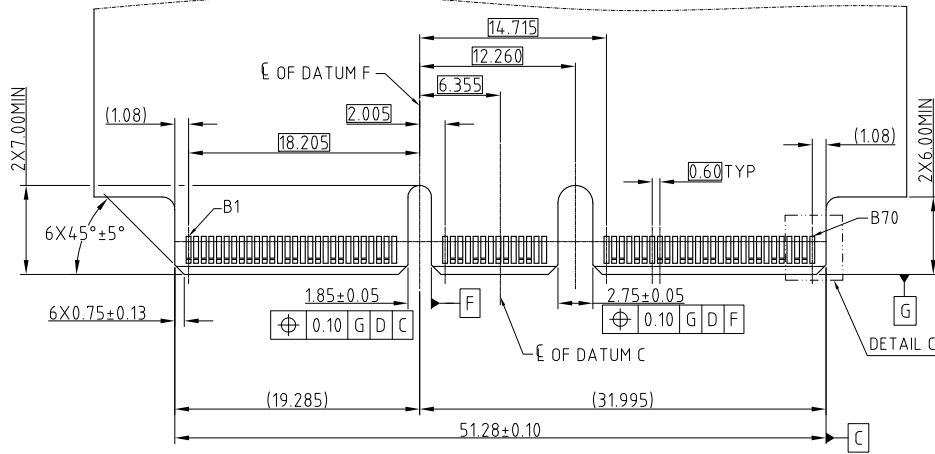

RECOMMENDED AIC MATING CARD

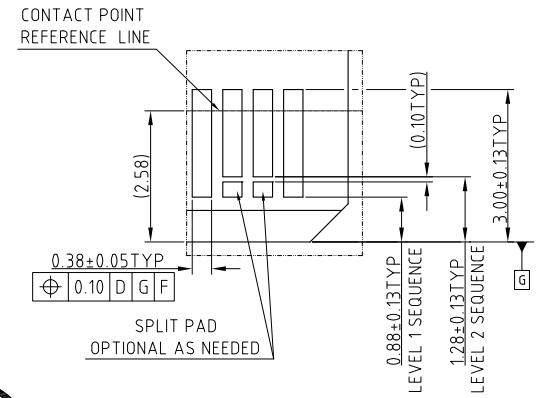

DETAIL C
SCALE 4:1

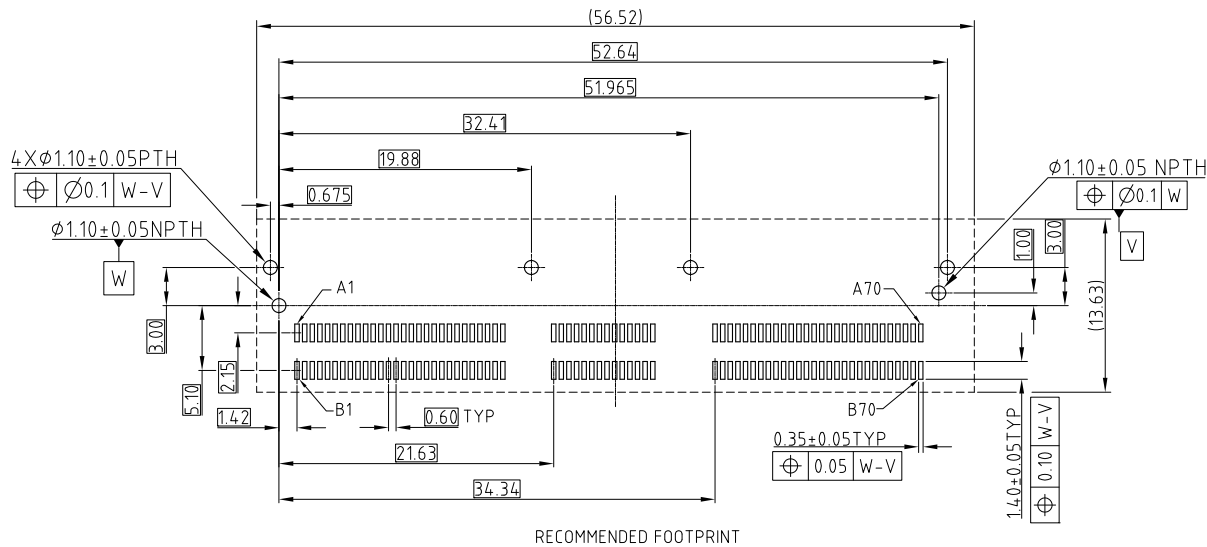

RECOMMENDED FOOTPRINT

UNLESS OTHERWISE SPECIFIED TOLERANCES U.S. METRIC X +/- 0.25 .XX +/- 0.20 .XXX +/- 0.15 FRACTIONS +/- ANGLES +/- 5° FOR MATERIALS AND FINISHES SEE NOTES	APPROVAL	DATE
	DRAWN Teng.Cao	Jul.14,2019
	CHECKED Ly.Yi	Jul.14,2019
	APPROVED	
REMOVE SHARP EDGES	DRAWING FILE :	
DIMENSIONS	INTERNAL_DRAWING_MEX_C_ME101401020103X	
—U.S.— INCHES	ANGLE OF PROJECTION	
(METRIC) (mm)		

Amphenol		
TITLE MINI COOL EDGE CONNECTOR 140P R/A 0.6MM PITCH 4.05		
SIZE	DRAWING NO.	REV.
A3	C ME101401020103X	11
SCALE	NONE	SHEET 2 OF 3

This document is the property of Amphenol Corporation and is delivered on the express condition that it is not to be disclosed, reproduced or used, in whole or in part, for manufacture or sale by anyone other than Amphenol Corporation without its prior consent, & that no right is granted to disclose or to use any information in this document.

CUSTOMER DRAWING

REVISIONS				
SYM	ECN	DESCRIPTION	DATE	APPROVED
		SEE SHEET 1		

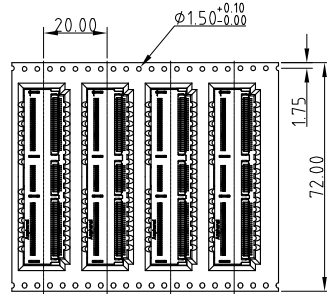

SEE DETAIL A

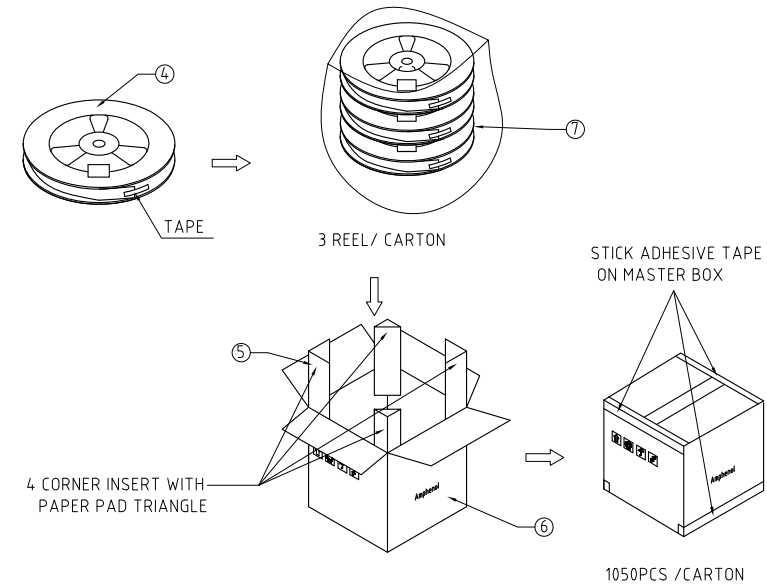
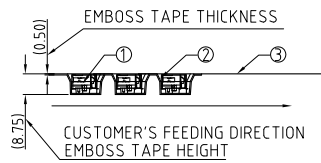
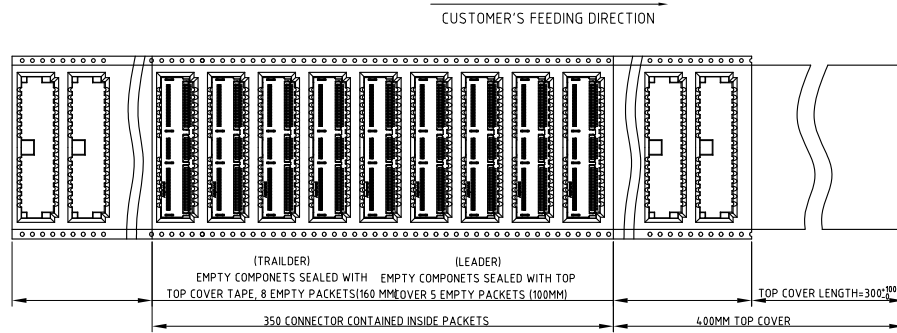
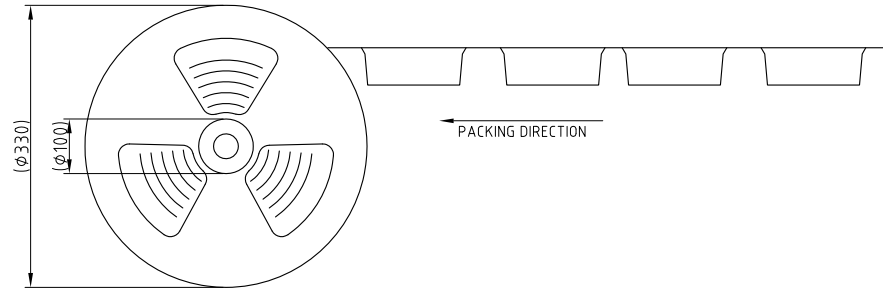

THIS PAGE FOR REFERENCE ONLY

7	PLASTIC BAG	
6	PAPER PAD TRIANGLE	CORRUGATED FIBERBOARD
5	MASTER BOX	CORRUGATED FIBERBOARD
4	PP REEL	PP
3	TOP COVER TAPE	PET
2	EMBOSS TAPE	POLYSTYRENE
1	Connector	
ITEM	DESCRIPTION	MATERIAL



UNLESS OTHERWISE SPECIFIED TOLERANCES		APPROVAL	DATE	<h1>Amphenol</h1>		
	U.S.	DRAWN	Teng.Cao			Jul.14,2019
	METRIC	CHECKED	Ly.Yi			Jul.14,2019
		APPROVED				
X +/- 0.25 .XX +/- 0.20 .XXX +/- 0.15 FRACTIONS +/- ANGLES +/- 5°		DRAWING FILE :		TITLE		
FOR MATERIALS AND FINISHES SEE NOTES		INTERNAL_DRAWING_MEX_C_ME101401020103X		MINI COOL EDGE CONNECTOR		
REMOVE SHARP EDGES		ANGLE OF PROJECTION		140P R/A 0.6MM PITCH 4.05		
DIMENSIONS				SIZE DRAWING NO.		
—U.S.— INCHES				A3 C ME101401020103X		
(METRIC) (mm)				REV. 11		
		SCALE	NONE	SHEET 3 OF 3		