

DRAWING MADE IN THIRD ANGLE PROJECTION

THIS DRAWING IS UNPUBLISHED. RELEASED FOR PUBLICATION .19  
 © COPYRIGHT 19 BY AMP INCORPORATED. ALL INTERNATIONAL RIGHTS RESERVED.

LOC		DIST		REVISIONS			
ZONE	LTR	DESCRIPTION	DATE	APPD			
G	86	P	F	C	Add tin plating reference	12JUN2017	MV

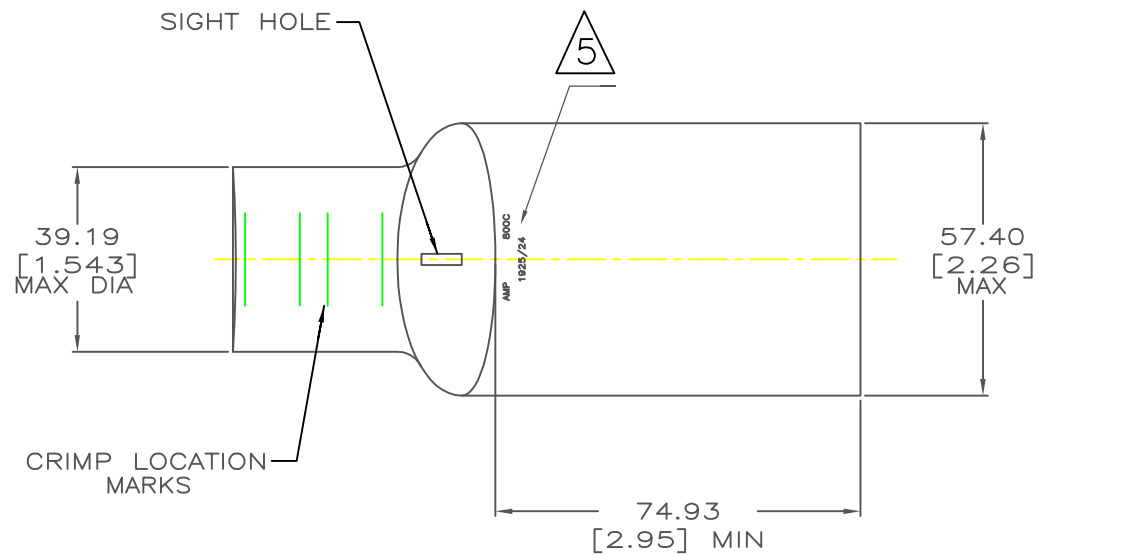

- 1 CIRCULAR MIL RANGE: 750-850 MCM
- 2 CLEANED, UNPLATED
- 4 TIN PL 0.00381[.000150]  
MIN THK PER ASTM B 545
- 5 STAMPED AMP 800C 1925/24

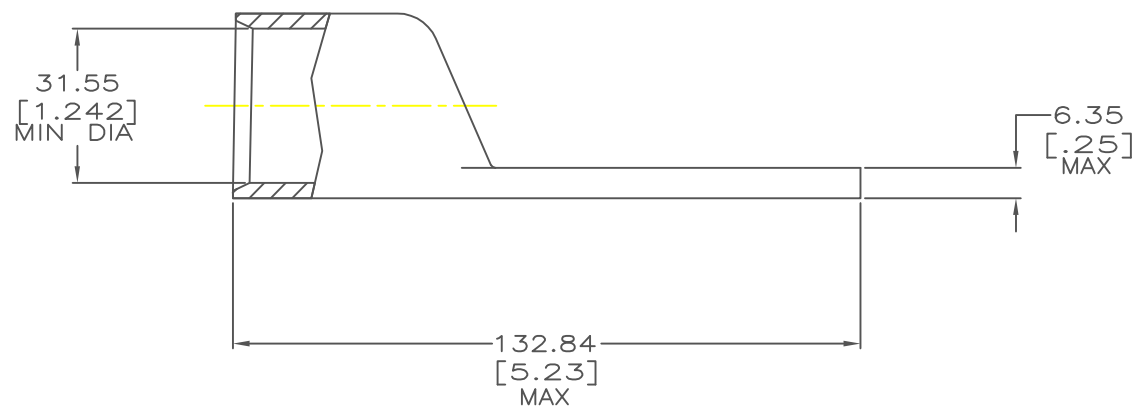

696279

DO NOT SCALE PRINT. UNLESS SPECIFIED		DR 24JAN01 JR RUTH		FINISH		696279-2	
DIMENSIONS IN mm [INCHES]		CHK 24JAN01 MS FEHER		AMP INCORPORATED Harrisburg, Pa. 17105		696279-1	
TOLERANCES ON :		APPD 24JAN01 M SPICER		NAME		PART NO	
2 PLC DEC ± 0.51[.020]		APPD 24JAN01 M SPICER		TERMINAL, AMPPOWER™ WIRE SIZE: 800 MCM			
3 PLC DEC ± -		PRODUCT SPEC					
ANGLES ± -		APPLICATION SPEC		SIZE		DRAWING NO	
MATERIAL		-		C 00779		696279	
ANNEALED COPPER ASTM B-75		WEIGHT .821 LB		SCALE 1:1		SHEET 10F 1	
FINISH							
SEE NOTES							

