

Materials:
 Frame: PA66, UL94-V2
 Insert: ABS - UL94 HB

USB-C Specification:
 Maximum Rated Current - 3A
 Maximum Power - 60W
 Withstanding Voltage - 100V for 1 minute.
 Contact Resistance - 40 Milli-ohms Max.
 Insulation Resistance - 100 Mega-ohms Min.
 Insertion Life - 5,000 Cycles.

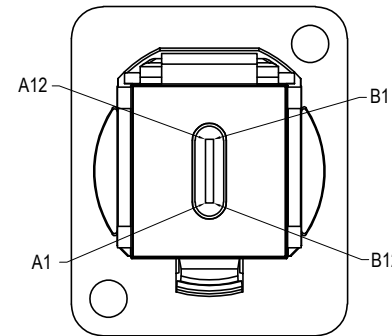

ISS.	AMEND	DATE
1	ISSUED	02/09/19
2	USAGE NOTES	07/10/19
3	ADD WHITE VARIANTS	25/06/21

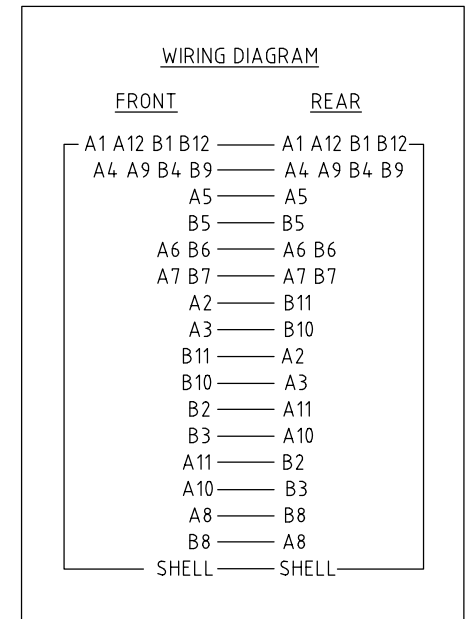

FUNCTIONALITY IS AFFECTED BY CABLE QUALITY, LENGTH AND CABLE WIRING CONFIGURATION.
 NOT COMPATIBLE FOR POWER DELIVERY (PD) CHARGING.

PART NO.	COLOUR	DESCRIPTION
CP30201	BLACK	HOLE Ø3.50 x CSK 82° x Ø5.85
CP30201W	WHITE	
CP30201X	BLACK	PLAIN HOLE Ø2.50
CP30201XW	WHITE	

RoHS
COMPLIANT

TOLERANCE
 NO DEC. PLACE ± 0.50
 1 DEC. PLACE ± 0.20
 2 DEC. PLACE ± 0.10
 HOLE Ø ± 0.10
 ANGLES ± 1/2°
 UNLESS OTHERWISE STATED

Cliff Electronic Components Ltd.

76 Holmetherpe Avenue, Holmetherpe Industrial Estate,
 Redhill, Surrey, RH1 2PF, England, UK
 Tel: 01737-771375 Fax: 01737-766012 Website: www.cliffuk.co.uk

DIMENSIONS IN MILLIMETERS UNLESS OTHERWISE STATED. WORK TO DIMENSIONS. REMOVE ALL BURRS. IF IN DOUBT ASK.

3rd ANGLE PROJECTION:

MATERIAL: SEE NOTES

FINISH: CLEAN

DRAWN: D.P.J.

APPROVED: T.J.O.

TITLE: FT USBC FEMALE-FEMALE

DRWG. No. **CP30201**

DO NOT SCALE

FORM: A4DRWG-