

LOADING PATTERN MATING SIDE

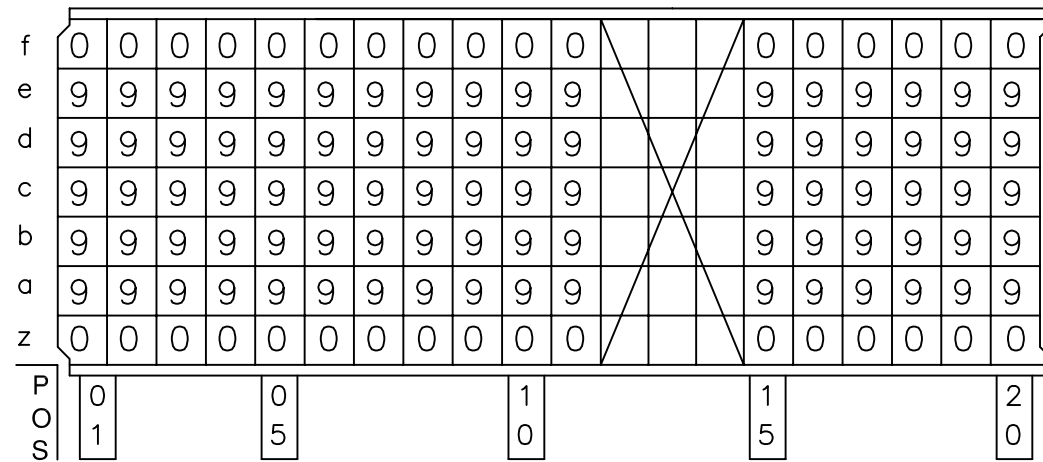

LOADED CONNECTOR ASSEMBLY (FOR EXAMPLE)

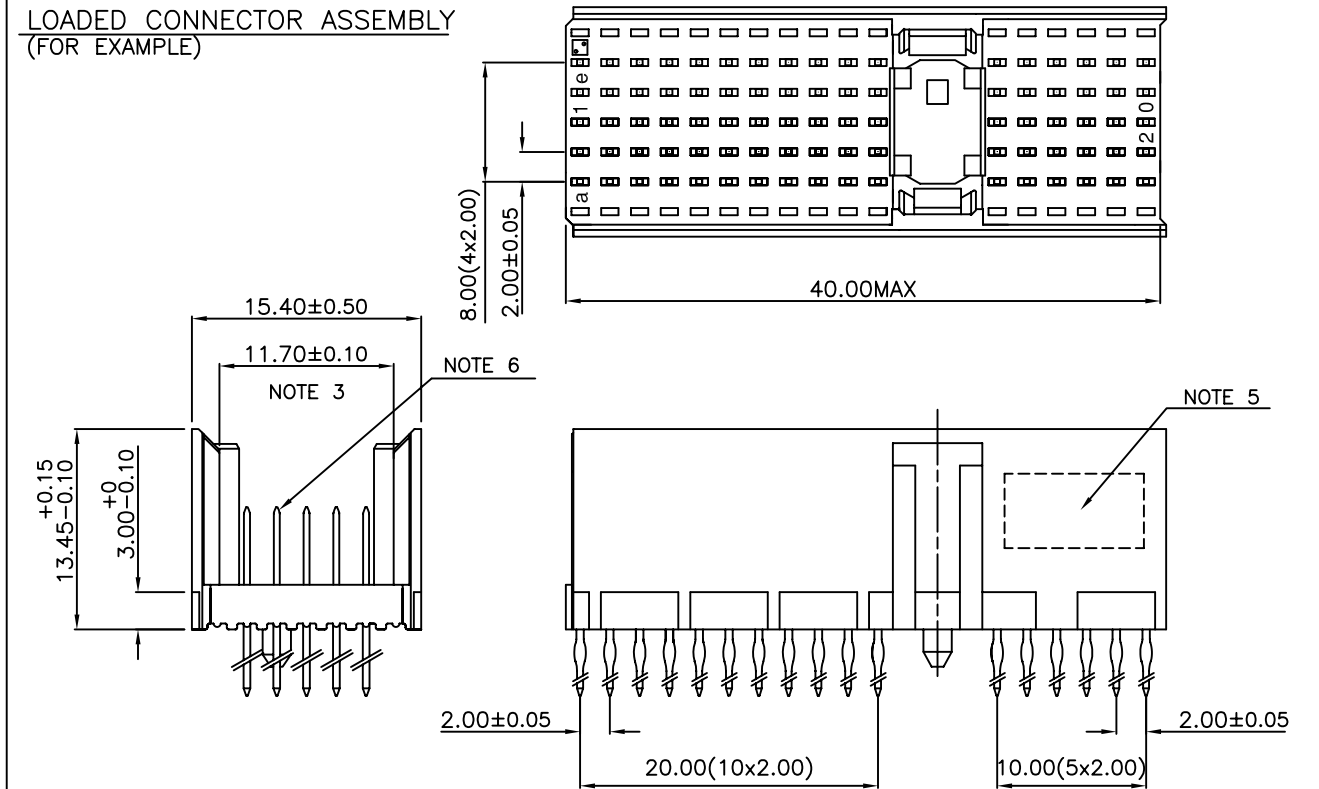

CONTACT OVERVIEW

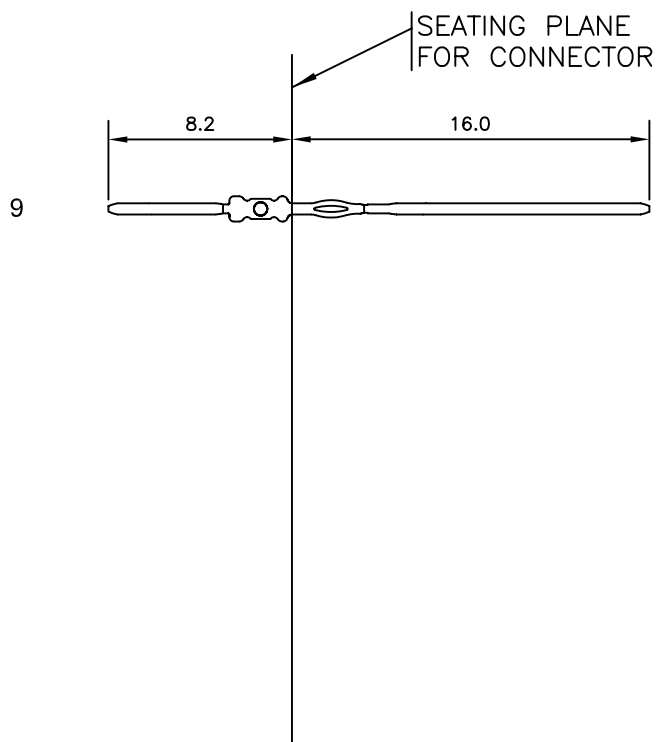

LAY-OUT P.C.B.-HOLE

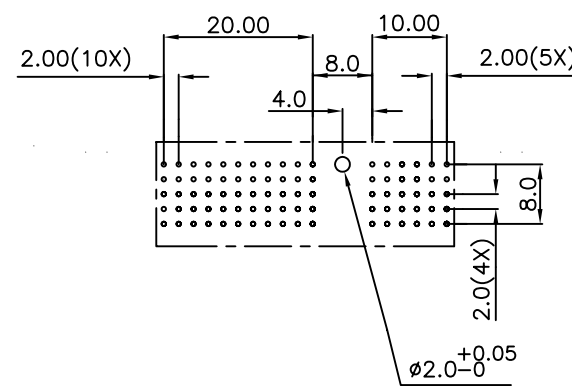

LEAD FREE INDICATOR : LF = LEAD FREE (DIGIT 15 & 16)

HM2P28PN5110

PLATING CODE (DIGIT 13 AND 14) (REF DRW NO. BS,C , 201844 , 003)

NOTES

- THIS PRODUCT IS CSA APPROVED.
- THIS PRODUCT IS UL RECOGNIZED.
- MEASURED AT THE BOTTOM.
- MATERIAL CONTACT: PHOSPHORBRONZE
HOUSING: CREAM WHITE GLASS FILLED POLYESTER UL-94V0
- CONNECTOR PRINTED WITH P/N AND DATE CODE.
- FOR ACTUAL CONTACT LOADINGS, SEE LOADING PATTERN MATING SIDE.
- SHAPE OF CONNECTOR HOUSING CAN ALTER DEPENDING ON PRODUCTION LOCATION
- THE PRODUCT (LF) MEETS EUROPEAN UNION DIRECTIVES AND OTHER COUNTRY REGULATIONS AS DESCRIBED IN GS-22-008
- FOR RECOMMENDED PTH DIMENSIONS REFER DRAWING : BS, A , 201572 , 001

CATALOG NO: HM2P28PN5110----

| | | | | | | | |
|---------------------------|----------------|---------------------|-------------------------------|---------------------------------------|----------------------------------------------|--------------------------|------|
| mat'l. code SEE NOTE 4 | | surface ISO 1302 | tolerance ISO 406 ISO 1101 | projection | product family MILLIPACS | | |
| ltr | ecn no | dr | date | tolerances unless otherwise specified | title | | |
| A | 103-0008 | JAY | 2003-05-22 | angles | MPACS 5+2R STR HDR PF CONN TYPE A 11+ 6 POS. | | |
| B | 103-0063 | MINI | 2003-01-12 | linear | | | |
| C | 105-0171 | MINI | 2005-09-23 | 0°±1° | | | |
| D | 106-0077 | MINI | 2006-06-17 | dr | JAYADEEP P 2003-05-22 | | |
| E | 111-0112 | MINI | 2011-06-07 | enr | BIJU K PAUL 2003-05-22 | | |
| | | | | chr | ALEX BABU 2011-06-07 | | |
| | | | | appd | ALEX BABU 2011-06-07 | | |
| sheet index | revision sheet | E | 1 | | scale - | | |
| | | | | | dwg no | sheet 1 of 1 | size |
| | | | | | BS, C , 203028, 009 | | A3 |
| | | | | | type | Product Customer Drawing | |