

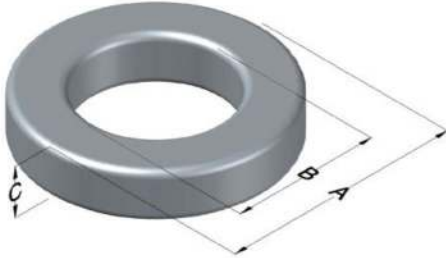

**0077192A7**

110 Delta Drive  
 Pittsburgh, PA 15238  
 NAFTA Sales: (1)800-245-3984  
 HK Sales : (852)3102-9337  
 magnetics@spang.com  
 www.mag-inc.com



Kool M $\mu$ Permeability ( $\mu$ )	A <sub>L</sub> (nH/T <sup>2</sup> )	Core Marking			Coating Color
		Lot Number	Part Number	Inductance Grade	
60	138 ± 8%	XXXXXX	77192A7	N/A	Black

Dimensions	Uncoated		Coated Limits			Packaging
	(mm)	(in)	(mm)	(in)		
OD (A)	57.15	2.250	58.04	2.285	max	Cardboard cut-outs Box Qty= 80 pcs
ID (B)	26.39	1.039	25.58	1.007	min	
HT (C)	15.24	0.600	16.13	0.635	max	

Electrical Characteristics			Physical Characteristics						
Watt Loss @ 100 kHz, 100mT max(mW/cm <sup>3</sup> )	DC Bias min (oersteds)		Voltage Breakdown wire to wire min (V <sub>AC</sub> )	Break Strength min (kg)	Window Area W <sub>A</sub> (mm <sup>2</sup> )	Cross Section A <sub>e</sub> (mm <sup>2</sup> )	Path Length L <sub>e</sub> (mm)	Volume V <sub>e</sub> (mm <sup>3</sup> )	Weight (g)
	750	80%							
	39.0	87.0							

Winding Information					Temperature Rating				
Winding Length Per Turn				Wound Coil Dimensions (mm)			Curie Temp: 500°C		
Winding Factor	(mm)	Winding Factor	(mm)	40% Winding Factor	OD	62.0			
					HT	24.0			
0%	64.6	40%	77.8	Completely Full Window	Max OD	75.7			
					Max HT	34.0			
20%	71.2	45%	79.8	Surface Area (mm <sup>2</sup> )					
25%	72.9	50%	81.6						
30%	74.1	60%	85.6						
35%	76.3	70%	90.1	Unwound Core		8,500			
				40% Winding Factor		12,000			
								Coating Temp (Continuous up to): 200°C	
								Notes:	

