

DESCRIPTION	MATERIAL	FINISH
GROMMET	FLUOROSILICONE 40/50 BLEND PER MIL-R-25988	COLOR: BLUE
SPLICE ASSEMBLY HOUSING	EPOXY	COLOR: BLACK
CONTACT FEMALE SOCKET	BERYLLIUM COPPER PER QQ-C-533	GOLD PLATE PER MIL-G-45204
CLIP CONTACT RETAINING	BERYLLIUM COPPER PER QQ-C-533 OR STAINLESS STEEL PER QQ-S-766	NONE
SHRINK TUBE	PER MIL-1-23053/8	COLOR TRANSPARENT
CONTACTS $\triangle 3$	PER M39029/1-102	GOLD PLATE PER MIL-G-45204

LOC	DIST	REVISIONS			
P	LYR	DESCRIPTION	DATE	DWN	APVD
A		REV PER OG3D-0450-00	5-01	CT	DM

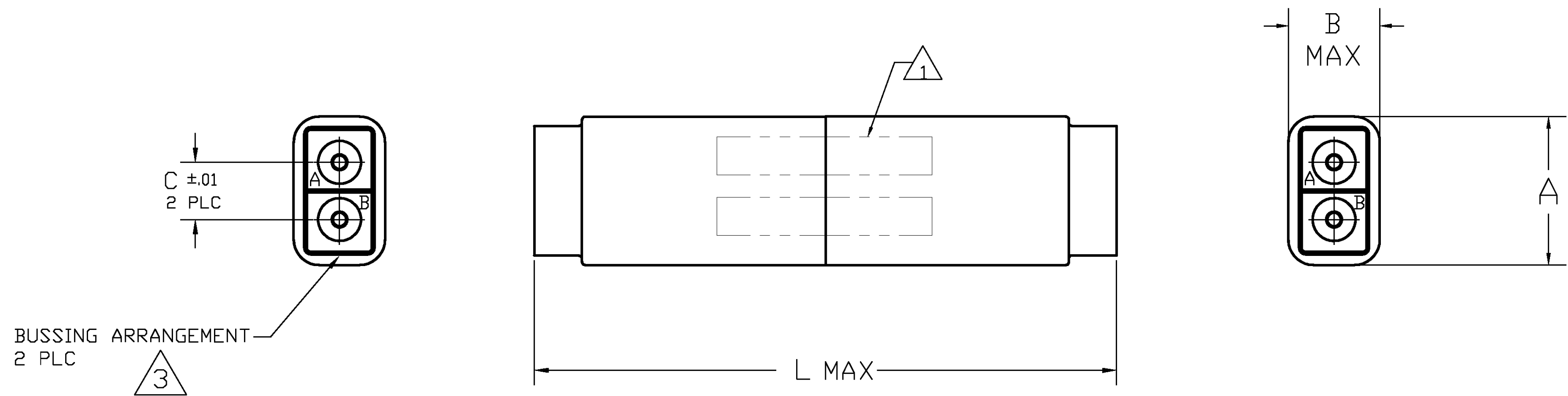

- $\triangle 1$ MARK WIRE SPLICE WITH *AMP*, AMP PART NO. AND DATE CODE .060 MINIMUM HIGH CHARACTERS AT APPROXIMATE AREA SHOWN.
- $\triangle 2$ A QUANTITY OF 4 CONTACTS ARE SUPPLIED WITH WIRE SPLICE.
- $\triangle 3$ MARK WIRE SPLICE BUSSING ARRANGEMENT BOTH ENDS AS SHOWN.

1.522	.13	.275	.400	$\triangle 3$	CLASS C	22	1-592582-5
1.522	.13	.275	.400	$\triangle 3$	CLASS A	20	1-592582-4
1.522	.13	.275	.400	$\triangle 3$	CLASS C	20	1-592582-3
1.922	.13	.300	.500	$\triangle 3$	CLASS B	16	1-592582-2
1.922	.13	.300	.500	$\triangle 3$	CLASS C	16	1-592582-1
1.552	.13	.275	.400	$\triangle 3$	CLASS C	20	1-592582-0
1.552	.13	.275	.400	$\triangle 3$	CLASS C	22	592582-9
1.552	.13	.275	.400	$\triangle 3$	CLASS B	22	592582-8
1.552	.18	.275	.400	$\triangle 3$	CLASS C	22	592582-7
1.992	.18	.300	.500	$\triangle 3$	CLASS B	16	592582-6
1.992	.18	.300	.500	$\triangle 3$	CLASS C	16	592582-5
1.992	.18	.300	.500	$\triangle 3$	CLASS A	16	592582-4
1.552	.13	.275	.400	$\triangle 3$	CLASS B	20	592582-3
1.552	.13	.275	.400	$\triangle 3$	CLASS C	20	592582-2
1.552	.13	.275	.400	$\triangle 3$	CLASS D	20	592582-1
L MAX	C	B MAX	A	REMARKS	MIL-T-8174 CLASS (A, B OR C)	SIZE	PART NO

THIS DRAWING IS A CONTROLLED DOCUMENT.

DWN: C. C. THOMAS 08MAY01 11/99
CHK: D. MILLER
APVD: D. MILLER 11/99

AMP Incorporated
Harrisburg Pa. 17105

PRODUCT SPEC: WIRE SPLICE ASSY, T.J, SIZE 16, 20 & 22

APPLICATION SPEC: -

SIZE: A1 CAGE CODE: 00779 DRAWING NO: C-592582

RESTRICTED TO: -

CUSTOMER DRAWING SCALE: 1:1 SHEET: 1 OF 1 REV: A