

LOC		DIST		REVISIONS			
P	LTN	DESCRIPTION	DATE	DMN	APVD		
D3		Dimensions updated, ECR-07-009742	25APR2007	JM	GM		
E		SEE ECR-11-009284 AND ECR-11-009557	09MAY2011	JM	GS		
E1		ECR-18-008069	25FEB2019	KC	PT		

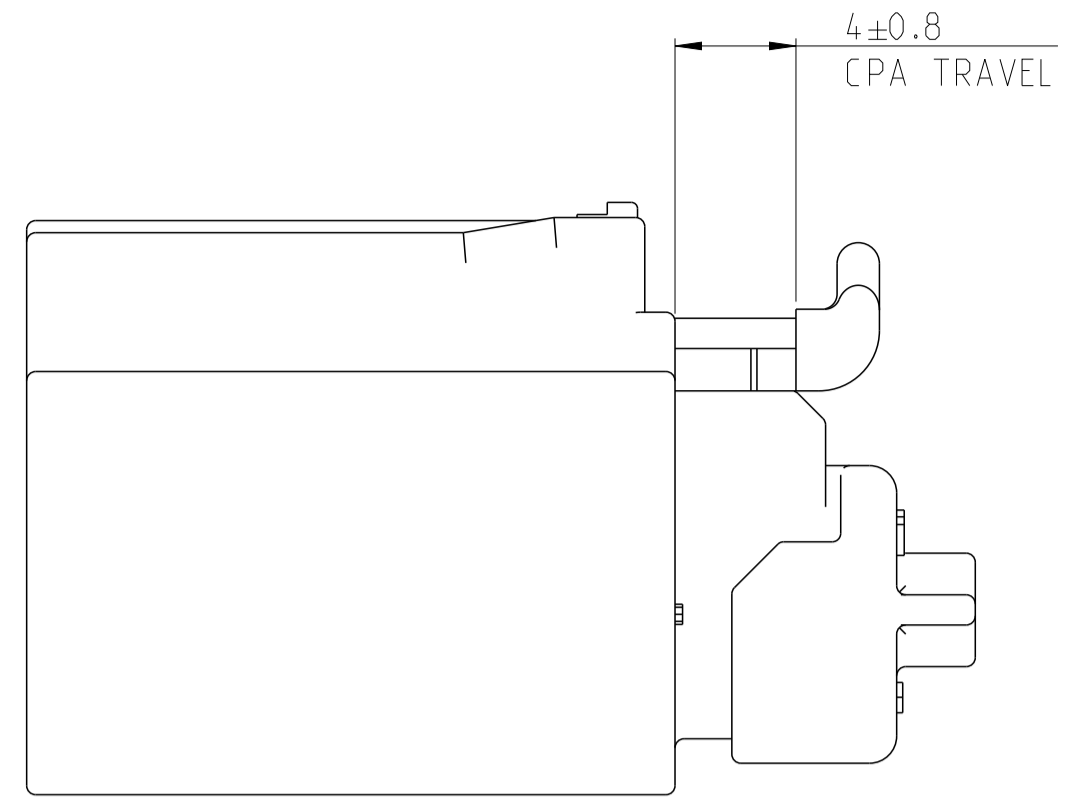

SECTION A-A
 SHOWN WITH TPA
 AND CPA (OPTIONAL)
 IN THEIR PRE-LOADED POSITIONS

PIN-OUT CHART			
	3	4	1438188-2 1719256-2 9-1419167-9
	2		9-1419167-5 1-1719256-3
			1719256-1 9-1419167-8 1419168-1 0-1419168-2 8-1419167-0 9-1419167-1 9-1419167-2 9-1419167-3
1	2	3	4
TERMINAL HOLE POSITION		ASSEMBLY PART NUMBER	
CAVITIES WITH A NUMERIC SYMBOL INDICATE CLOSED TERMINAL HOLE POSITIONS			
BLANK CAVITIES INDICATE OPEN TERMINAL HOLE POSITIONS			

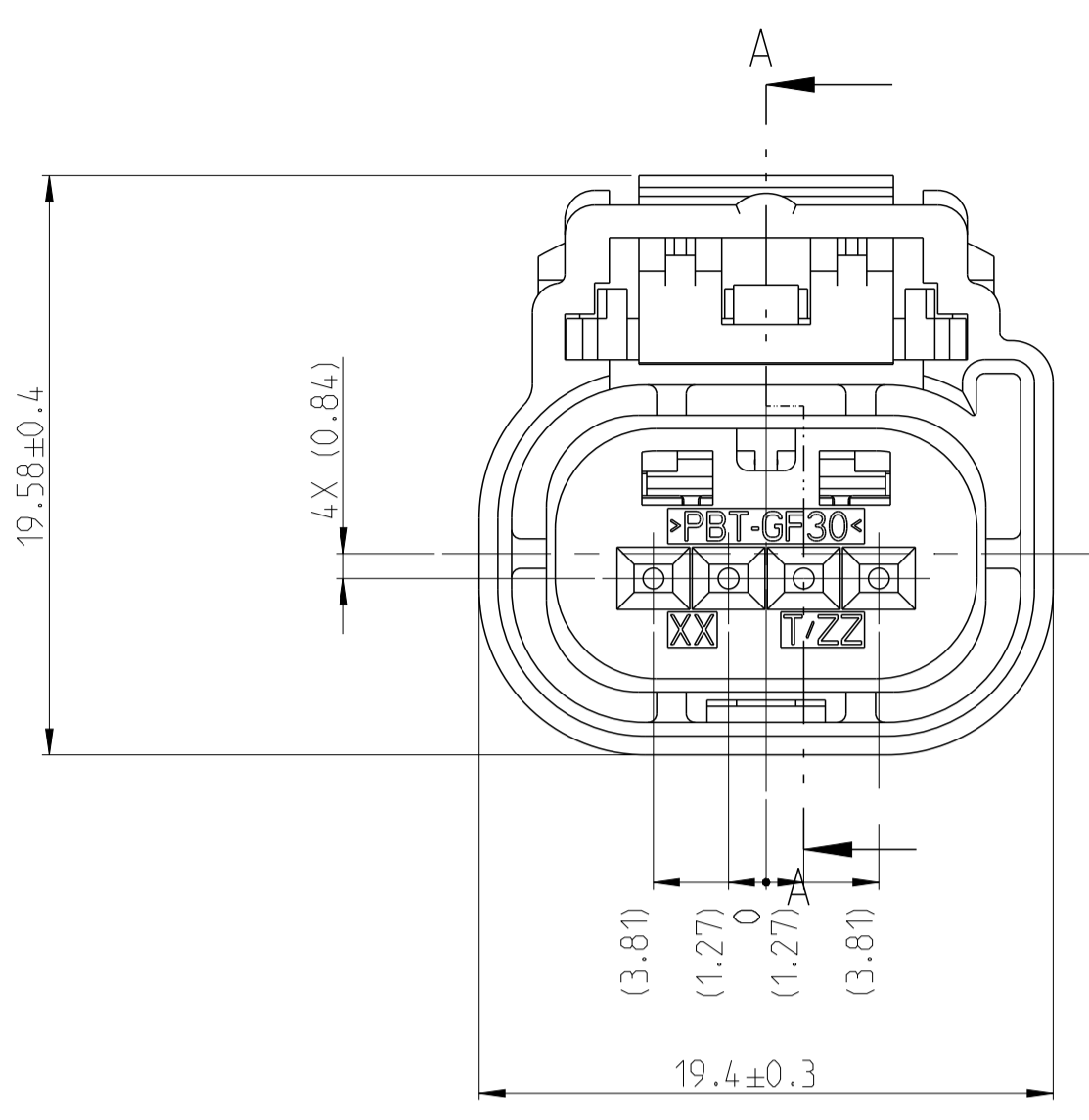
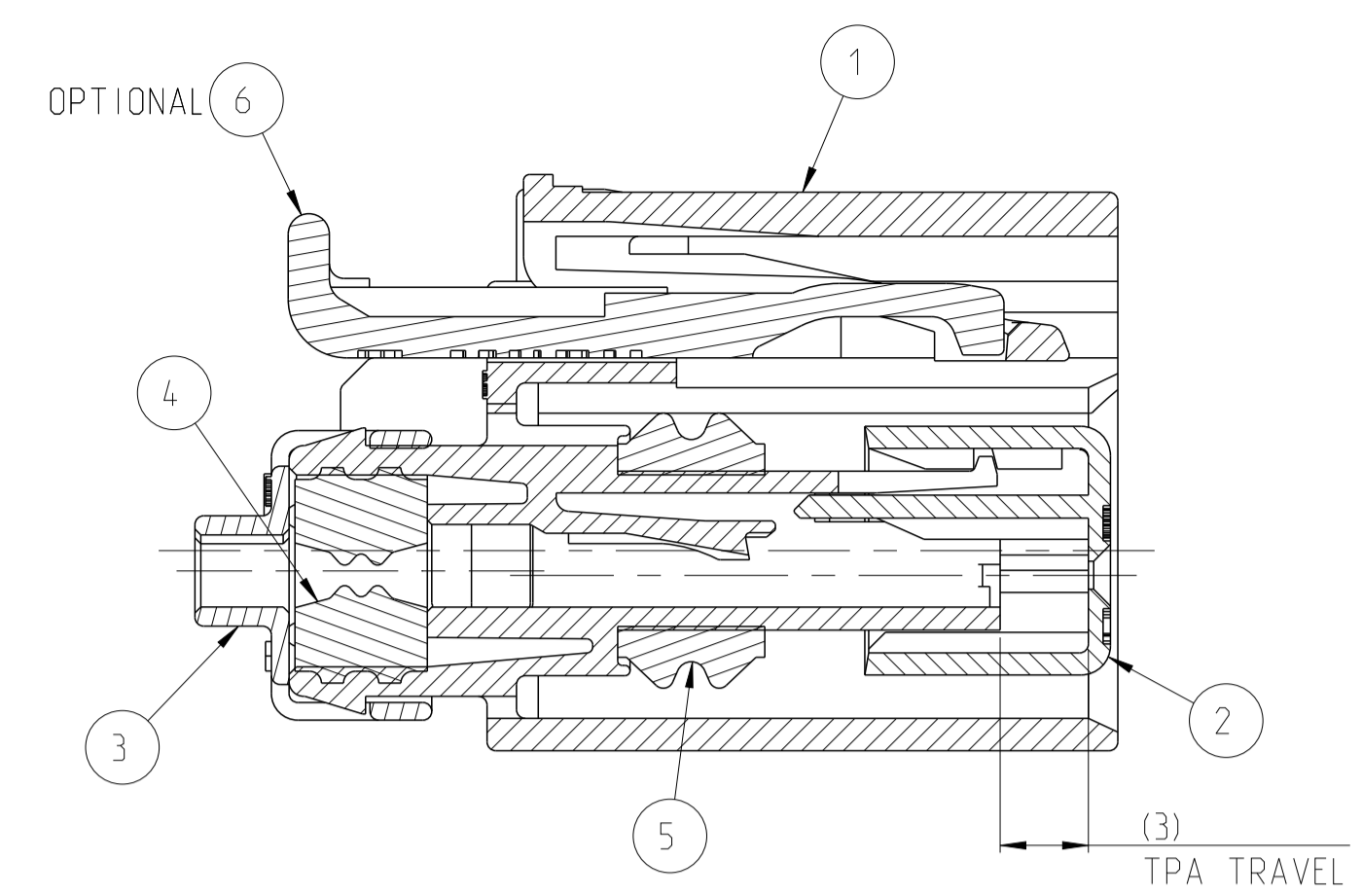
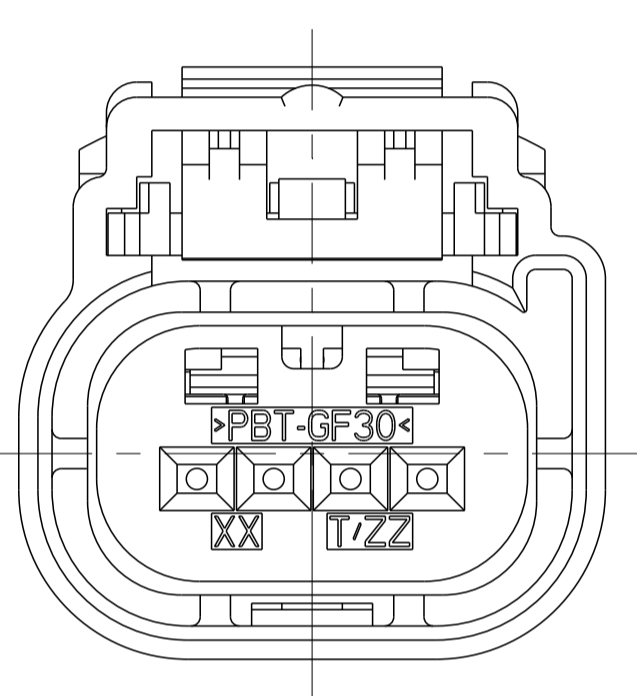

KEYING OPTION "A"

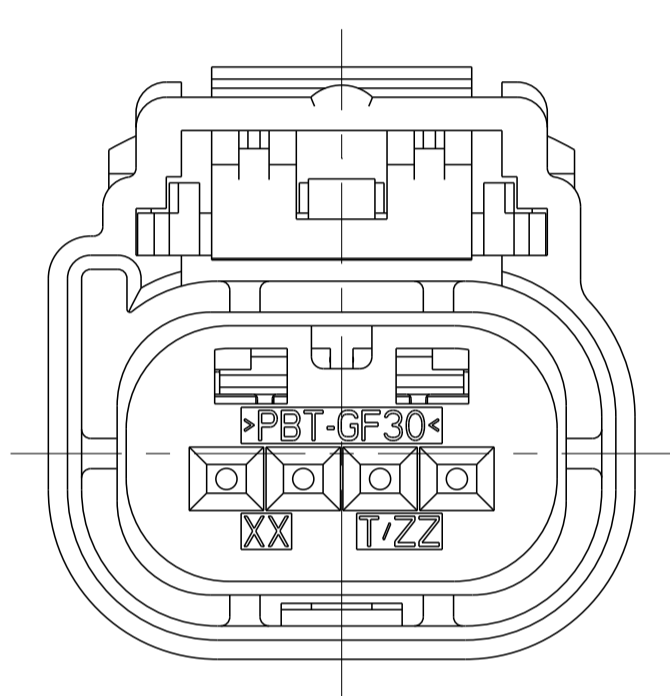

KEYING OPTION "B"

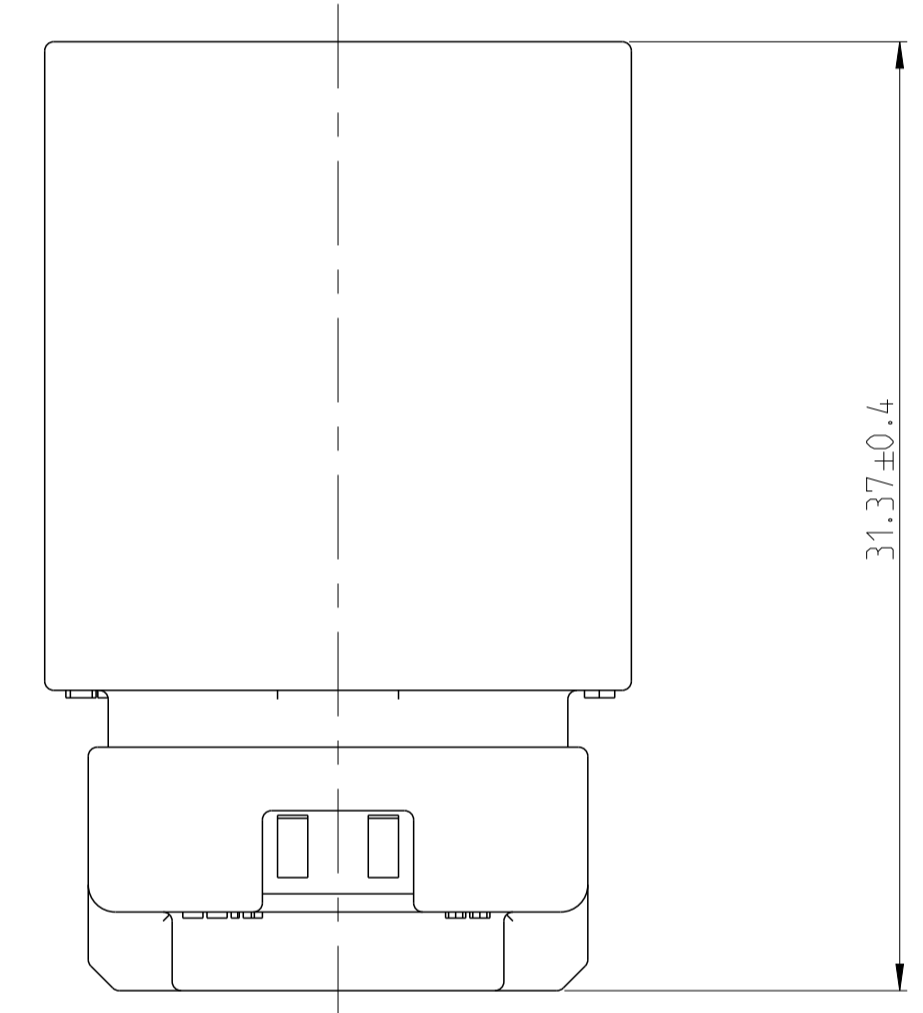

31.37±0.4

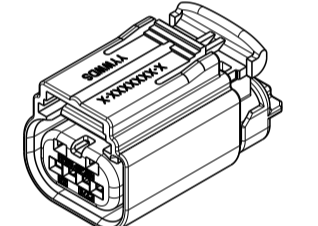
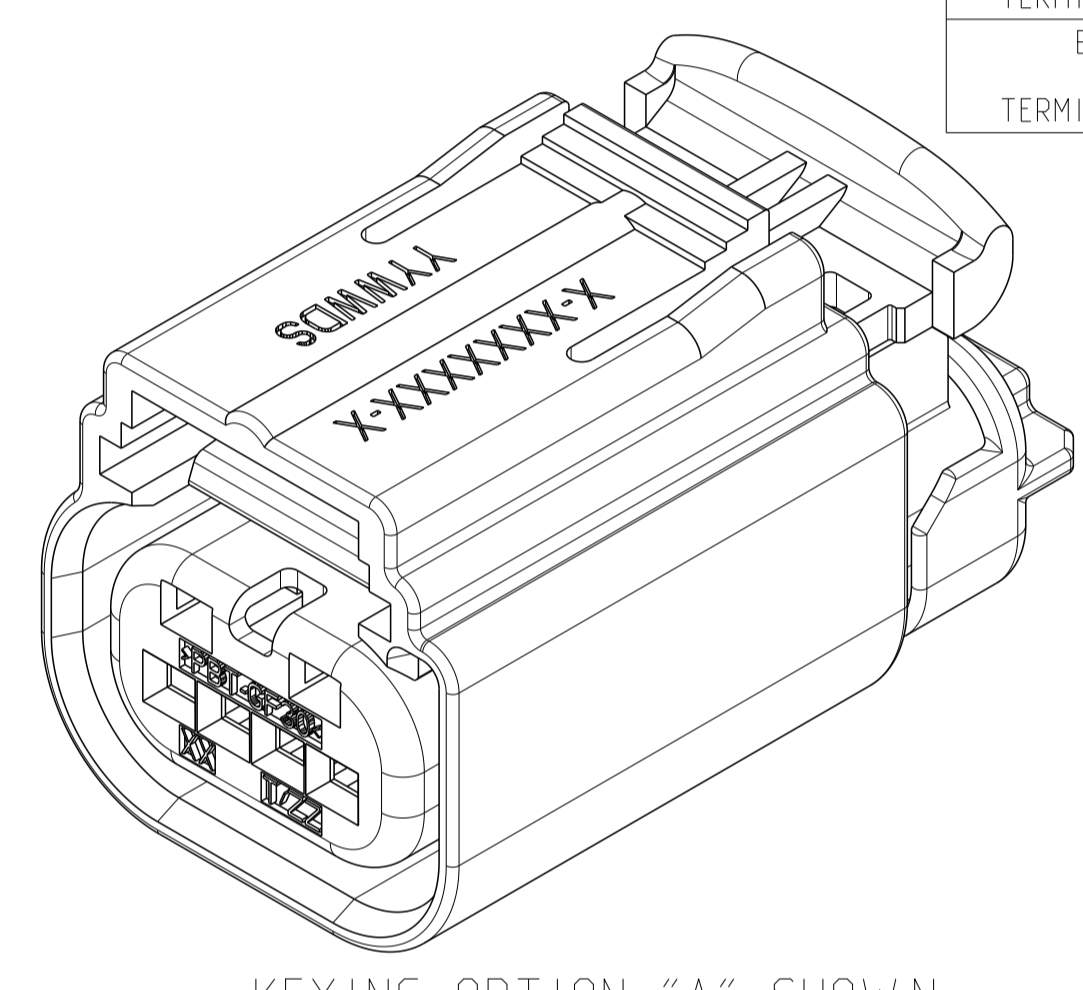
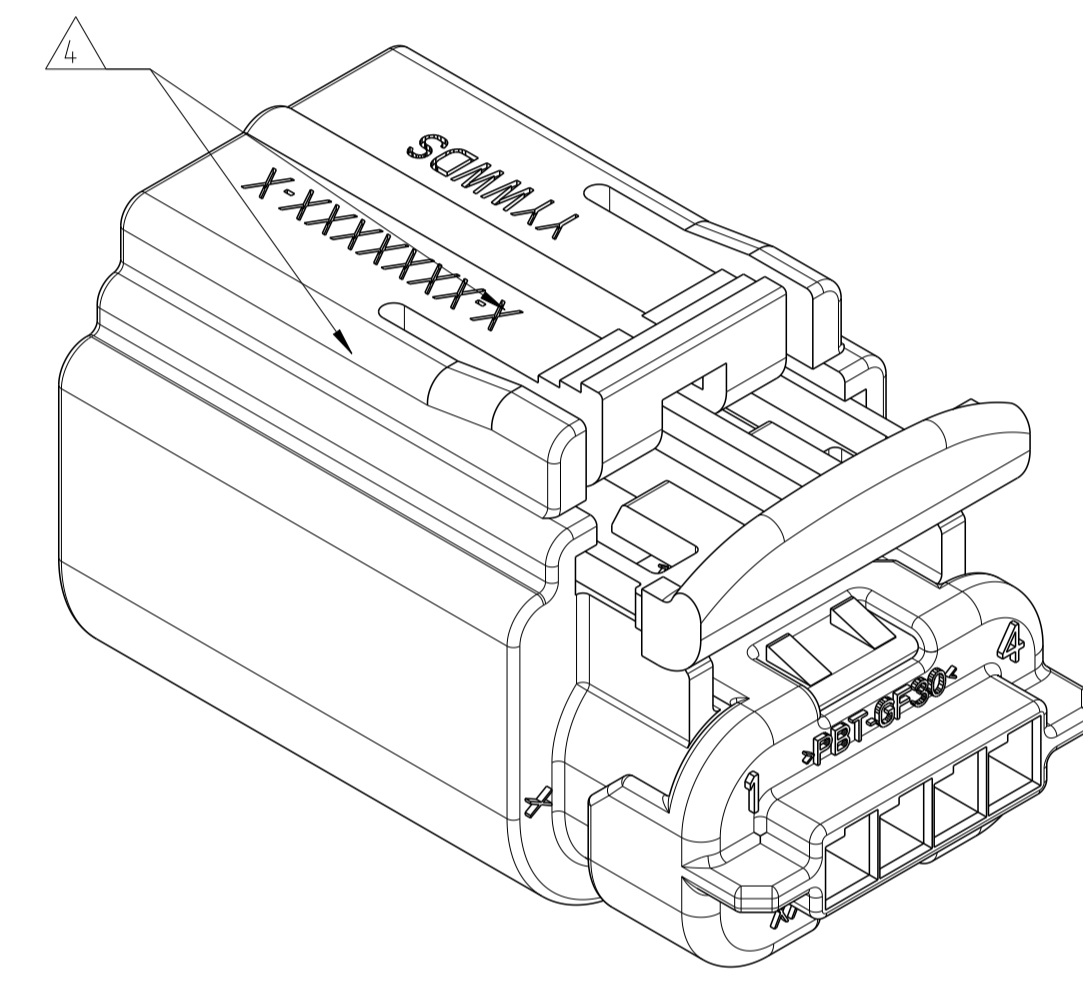

SCALE 1:1

KEYING OPTION "A" SHOWN
 SEE NOTE 5 FOR APPLICABLE
 HEADER INTERFACE INFORMATION

1. APPLICABLE TERMINAL PART NUMBERS (SOLD SEPARATELY):
 FOR TIN APPLICATIONS: 1393367 AND 1393366.
 FOR GOLD APPLICATIONS: 1393365 AND 1393364.
 FOR TERMINATION AND REELING OPTIONS
 SEE DRAWINGS 1393367, 1393366, 1393365, AND 1393364.

2. COMPATIBLE WIRE SIZES FOR MAT SEAL DESIGN 1.19 TO 2.06 O.D.
 (22-18 AWG, 0.35-0.75 mm2)

3. TPA AND CPA (OPTIONAL) ARE SHIPPED IN THEIR PRE-LOADED POSITIONS. ALL ASSEMBLIES ARE TO BE BULK PACKAGED.

4. TE ASSEMBLY PART NUMBER (X-XXXXXX-X) AND TRACEABILITY CODE (YY = TWO DIGIT YEAR, WW = TWO DIGIT WEEK, D = ONE DIGIT DAY OF THE WEEK, S = ONE DIGIT SHIFT NUMBER) ARE PRINTED IN THIS LOCATION.

5. APPLICABLE HEADER INTERFACE DRAWING 1438198 IS AVAILABLE UPON REQUEST. A COPY OF THIS DRAWING CAN BE OBTAINED FROM THE TE PRODUCT MANAGER, VIA YOUR TE SALES REPRESENTATIVE OR CUSTOMER SERVICE.

6. PART ASSEMBLY WEIGHT WITHOUT TERMINALS:
 WITHOUT CPA: 5.70 GRAMS
 WITH CPA: 6.10 GRAMS

7. THESE PART NUMBERS ARE NOT RELEASED FOR PRODUCTION. PLEASE CONTACT YOUR TE SALES REPRESENTATIVE FOR AVAILABILITY AND PRICING.

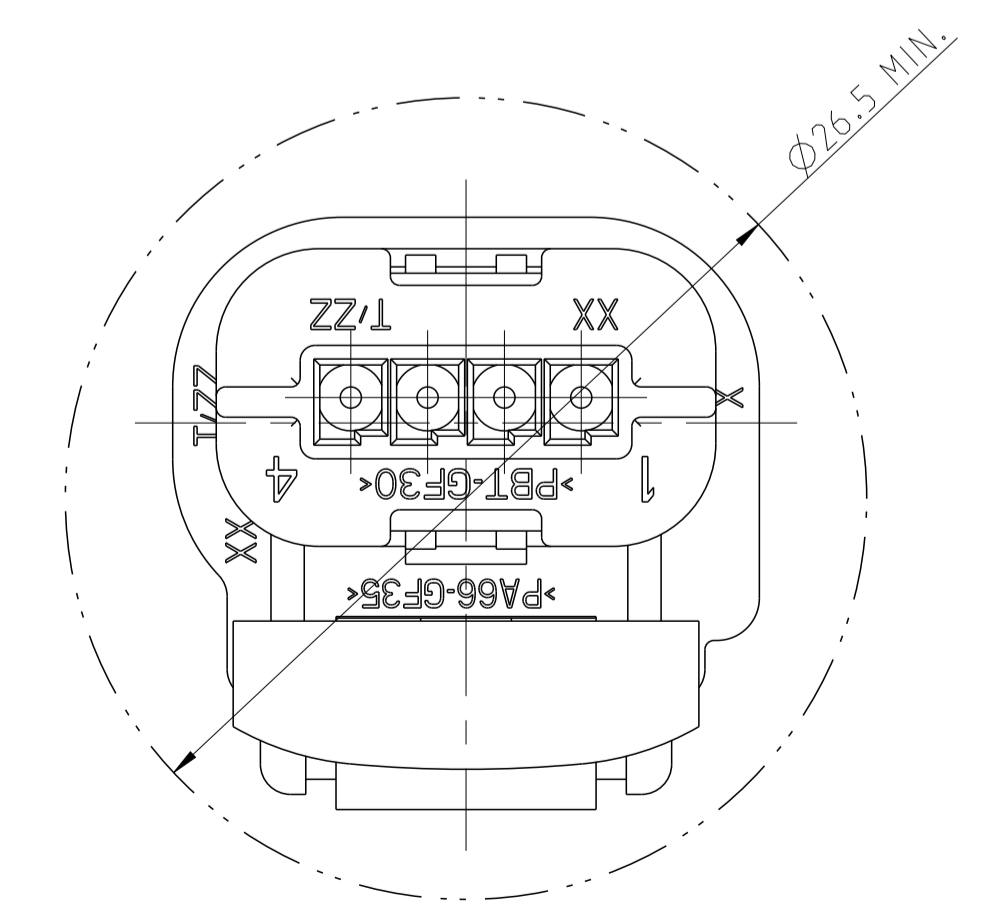

MINIMUM FEED THROUGH CONDITION
 WITH 1mm CLEARANCE ALL AROUND

SUPERSEDED ASSY PNS											
ASSEMBLY PART NUMBERS											
ASSEMBLY REVISION											
1	1										6
1	1	1	1	1	1	1	1	1	1	1	5
1	1	1	1	1	1	1	1	1	1	1	4
1	1	1	1	1	1	1	1	1	1	1	3
1	1	1	1	1	1	1	1	1	1	1	2
		1									1
			1								1
				1							1
1	1										1
QUANTITY											
ITEM											
DESCRIPTION											
MATERIAL											
COLOR/FINISH											

DIMENSIONS:		TOLERANCES UNLESS OTHERWISE SPECIFIED:		APVD		NAME	
mm	0 PLC	#	±0.3	APVD	M. FORISKA	16JAN2002	TE Connectivity
	1 PLC	#	±0.10	CHK	M. FORISKA	19FEB2002	
	2 PLC	#	±0.10	APVD	A. SHUMAN	19FEB2002	
	3 PLC	#	±0.10	CHK	M. FORISKA	19FEB2002	
	4 PLC	#	±0.10	APVD	A. SHUMAN	19FEB2002	
	ANGLES	#	±0.1	CHK	M. FORISKA	19FEB2002	
MATERIAL	FINISH			WT	SEE NOTE 8	A1 00779	C=9-1419167-0
THIS DRAWING IS A CONTROLLED DOCUMENT.				CUSTOMER DRAWING		SCALE 4:1 SHEET 1 OF 1 REV E1	