

ITEM NO.	PART NUMBER	DESCRIPTION	QTY.	COMPONENT NOTES
1	50-00129	Connector, dc plug, 5.5x2.5xL18.5 mm, molding style, spring contacts	1	
2	30-00395	Wire, 2C TS, 18 AWG, UL2468, 300V, 80C, 4.4 mm, VW-1, PVC	1	
3	24-00006	Overmold	1	PVC, black

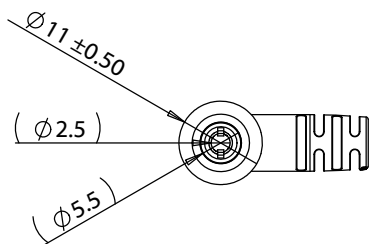
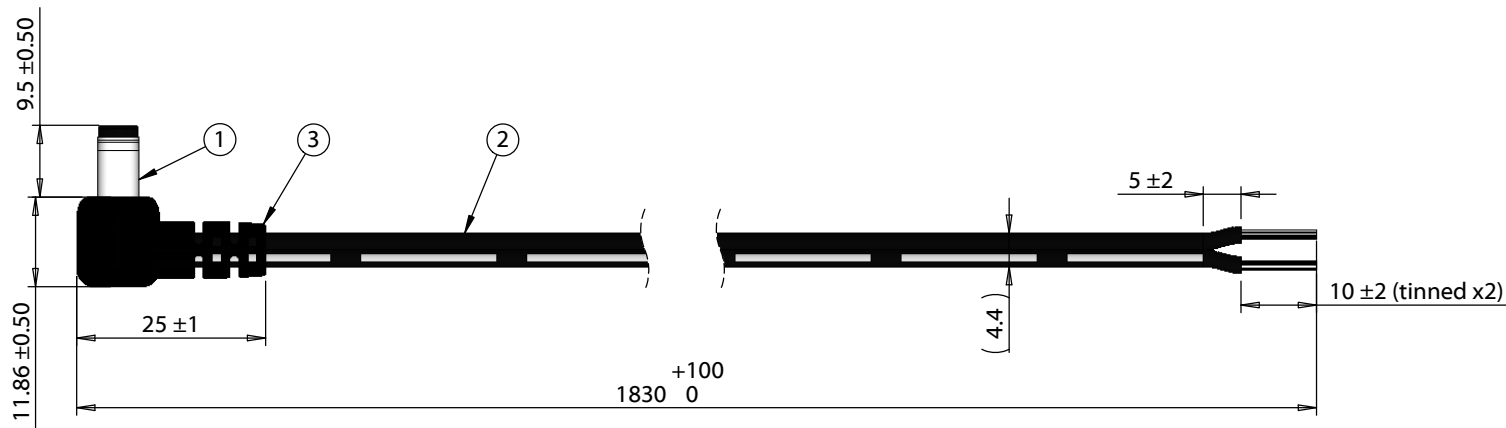

Notes:
Functionally equivalent components may be substituted
Cable rated for 48 V, 7 A

Wiring Diagram	
50-00129	wire color
center	black with stripe
sleeve	black

Revision:	Date:	Description:	Prepared:	Notes:	<h1>TENSILITY</h1> <p>tel 1.541.323.3228 800 877.670.7118 fax 1.541.323.4202 web tensility.com</p>
A	7/28/2017	Initial release	JC <small>Digitally signed by JC Date: 2020.04.09 13:12:46 -07'00'</small>	RoHS compliant	
			Verified: AW <small>Digitally signed by AW Date: 2020.04.09 15:27:42 -07'00'</small>	Function test: no open, no short circuit, no intermittent	
			Dimensions are in millimeters. Tolerances: X: ± 0.5 mm X.X: ± 0.3 mm X.XX: ± 0.05 mm	Description: Cable, 1830 mm, 5.5x2.5x9.5 mm 90° 50-00129 dc plug to 10 mm tinned, 18 AWG, UL2468, 30-00395 wire	
Scale: 1:1		Part number: A 10-02509		Sheet 1 of 1	

5

4

3

2

1