

order number	lens name
0703-109-000-20	Apo-Rodagon HR 0.5x 5.6/75
0703-109-000-21	Apo-Rodagon HR 0.5x 8.0/75

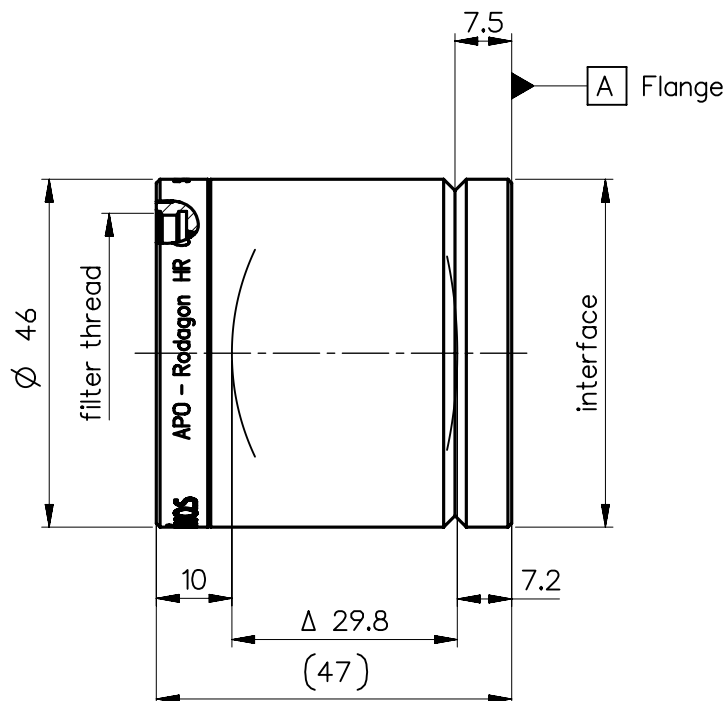

Specification		ON	7608-9111
image circle max. (mm)	62	working distance (mm)	172 - 273
focal length f' (mm)	76.9	interface	V-groove Ø 46 h7
magnification β' [range]	-0.5 [-0.35 ... -0.65]	filter thread	M37 x0.75
spectral range λ (nm)	400 - 750	weight (g)	195

schematic diagram		*) in air		
design includes CCD cover glass:		no		
SF (mm)	-64.1	f-stop	Ø EnP	Ø Exp
S'F' (mm) *)	61.8	5.6	13.7	13.7
HH' (mm) *)	1.8	8.0	9.6	9.7
SH (mm)	12.8			
S'H' (mm) *)	-15.1			
S'EnP (mm)	12.2			
S'Exp (mm) *)	-15.8			

NX PROTECTIVE NOTE "DIN ISO 16016" TO BE OBSERVED	EU-D	AL-T1A	US-D	US-ML	not export controlled
	REV	ECC	DATE	APPROVED	PDM Status Freigabe
	a	Neuausg			-
	b	14-0184	13.11.14	Schiffe	
c	18-0468	09.07.18	Denk		
				SCALE 1:1	
				MATERIAL	
				TITLE	
				APO-Rodagon HR 0.5x	
				DRAWING NO.	
				0703-109-100-00-0001c	SHEET 1
				REPLACES	OF 1
DIN A 4	ALL DIMENSIONS ARE IN MM AND INCLUDE SURFACE TREATMENT				

Apo-Rodagon

MTF at ratio 0.5x f/ 5.6

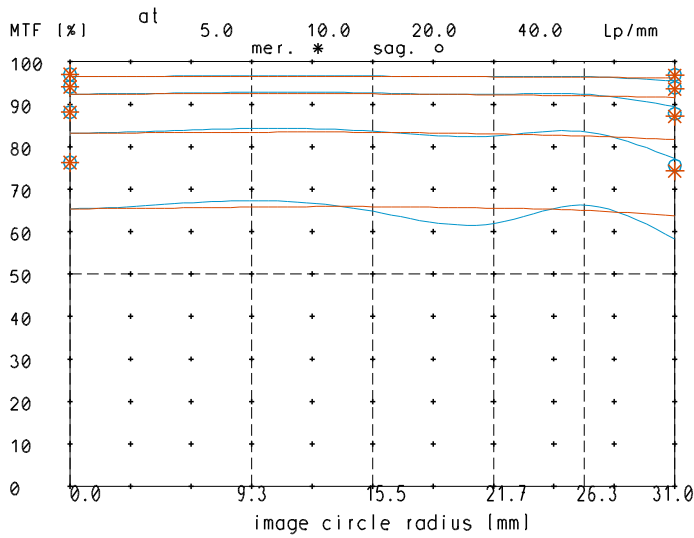

relative light fall-off at ratio 0.5x

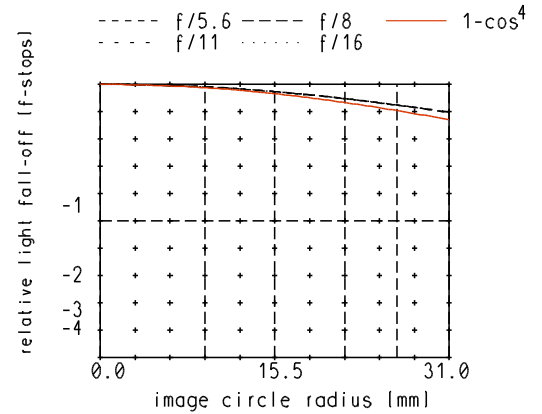

MTF at ratio 0.5x f/ 8

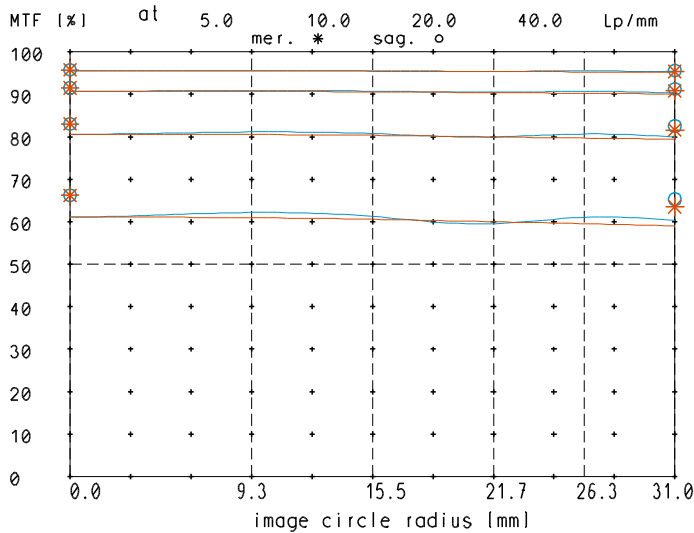

Distortion at ratio 0.35x to 0.65x

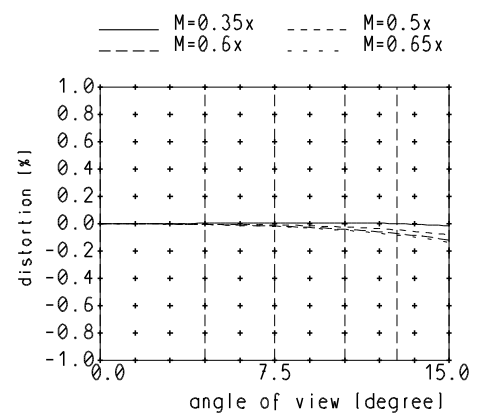

— sagittal, ○ Diffraction limited value
— meridional * Diffraction limited value

Longitudinal color aberration at ratio 0.5x

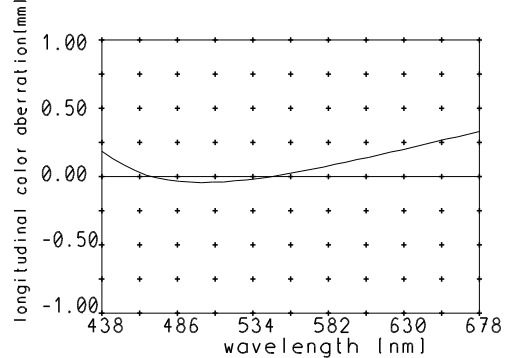

Named frequencies (line pairs/mm) in modular transfer function (MTF) as well as diagrams of relative light fall-off, distortion and longitudinal color aberration refer to film plane.