

MODEL NUMBER	DCB-3510-FF-SMA-02
REV.	D1

- NOTES:
- 1.0 ELECTRICAL SPECIFICATIONS:
 - 1.1 FREQUENCY RANGE: 250 MHz to 18.5 GHz
 - 1.2 IMPEDANCE: 50 OHMS, NOM.
 - 1.3 VSWR: 1.35:1 MAX.
 - 1.4 INSERTION LOSS: 0.5dB MAX.
 - 1.5 INSERTION LOSS AT 1 KHz: > 60dB
 - 1.6 DC WORKING VOLTAGE: 200 VOLTS, MIN.
 - 1.7 OPERATING TEMPERATURE: -65°C to +125°C
 - 1.8 TYPE: INNER ONLY

2.0 MARKING: MARK UNIT AS SHOWN
(REF.: INK-04702-27-03)

3.0 DIMENSIONS IN PARENTHESIS ARE IN
MILLIMETERS.

SMA FEMALE CONN.
PER MIL-PRF-39012

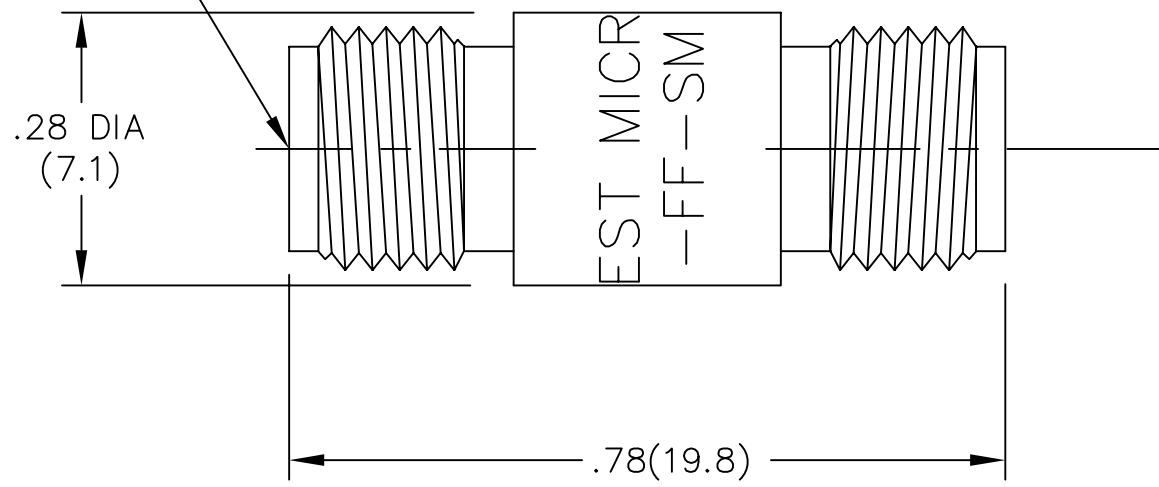

DWG NO. WAS: 03973-01-00

REV.	DESCRIPTION	DATE
-	RELEASED	3/5/82
A	ECR 2201	5/23/83
B	ECR 6545	7/10/89
C	ECN 12424	2/11/93
D	ECN 12489	3/16/93
D1	ADDED TITLEBLOCK	5/25/05

UNLESS OTHERWISE NOTED DIMENSIONS ARE IN INCHES AND TOLERANCES ARE: 3 PLACE DECIMALS ±.005 2 PLACE DECIMALS ±.02 FRACTIONS ±1/64 PARALLELITY: T.I.R. FLATNESS: T.I.R. CONCENTRICITY: T.I.R. ANGLES AND PERPENDICULARITY:	FSCM NO. 34078	MIDWEST MICROWAVE	
	NOTICE: The information contained in this drawing is proprietary and must not be used without the permission of Midwest Microwave	TITLE DC BLOCK	
	DRAWN/DATE A.BEATTY 2/12/93	ENG./DATE G.KOZAK 2/18/93	DRAWING NUMBER DCB-3510-FF-SMA-02
	CHECKED/DATE M.HOLLMAN 2/17/93	APPROVED/DATE	SCALE: 5=1 SHEET 1 of 1