

公差非累積
NON-ACCUMULATIVE

基板取付穴推奨寸法
RECOMMENDED P.C. BOARD HOLE DIM.

NOTES

- MATERIAL
 WAFER : 66NYLON, UL94V-0 (COLOR : IVORY)
 PIN : 黄銅 BLASS, □0.635
 PLATING : 錫めっき (5µm以上) 、銅下地 (2.5µm以上)
 TIN PLATING (5µm MIN.), COPPER UNDER PLATING (2.5µm MIN.)
- 6極以上に適用。
 TO BE APPLIED FOR 6CKT. AND MORE THAN 6CKT.
- 5極以下はロック部スリットなし。
 NO SLIT IS PROVIDED FOR 5CKT. AND LESS THAN 5CKT.

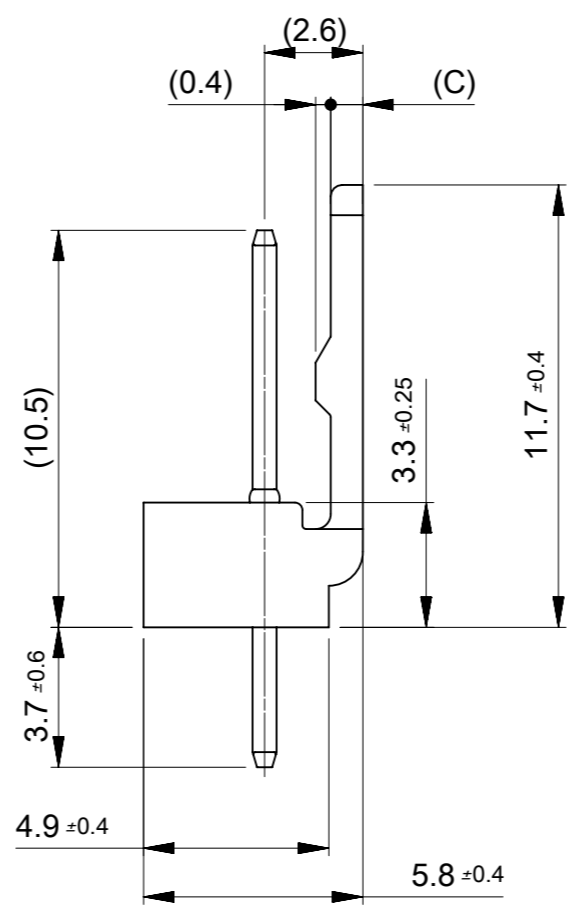
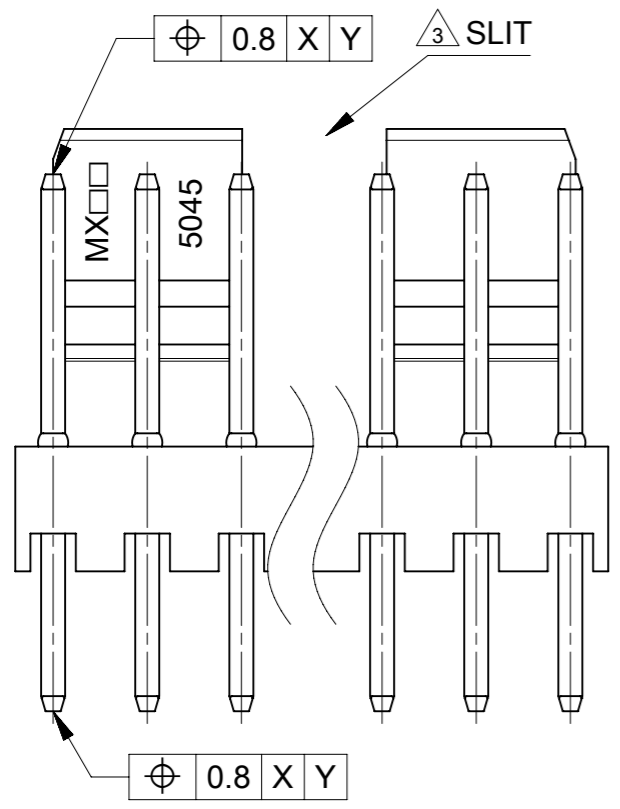

0.85	7.5	7.5	22044045	5045-04F	4
1	2.5	2.5	22044025	5045-02F	2
(C)	B	(A)	ORDER No.	PARTS No.	CKT.

THIS DRAWING CONTAINS INFORMATION THAT IS PROPRIETARY TO MOLEX ELECTRONIC TECHNOLOGIES, LLC AND SHOULD NOT BE USED WITHOUT WRITTEN PERMISSION

DIMENSION UNITS	SCALE	CURRENT REV DESC: OBSOLETE PART NUMBERS			
mm	5:1				
GENERAL TOLERANCES (UNLESS SPECIFIED)					
ANGULAR TOL	± 3.0 °	MINI-LATCH 2.5 HEADER ASSY FLANGE PIN TYPE TIN PLATING			
4 PLACES	±	PRODUCT CUSTOMER DRAWING			
3 PLACES	±	EC NO: 650267	2020/10/27	DOCUMENT NUMBER	
2 PLACES	± 0.2	DRWN: SKANDB	2020/12/10	50450000	PSD 000 A1
1 PLACE	± 0.2	CHK'D: GGA	2020/12/10	DOC TYPE DOC PART REVISION	
0 PLACES	± 0.2	APPR: GGA	2020/12/10	SHEET NUMBER	
DRAFT WHERE APPLICABLE MUST REMAIN WITHIN DIMENSIONS		INITIAL REVISION:	2017/04/25	MATERIAL NUMBER	
THIRD ANGLE PROJECTION		DRWN: SOBARA01	2017/05/24	CUSTOMER	
DRAWING		APPR: TKANEKO	2017/05/24	GENERAL	
A3-SIZE		SERIES	5045	SEE TABLE	
SERIES		1 OF 1			