

REVISIONS					
P	LTR	DESCRIPTION	DATE	DWN	APVD
F		REVISED PER ECN-22-189373	14DEC2022	LP	RL

1 2
SPRING SPACER

1 2
COMPRESSION SPRING

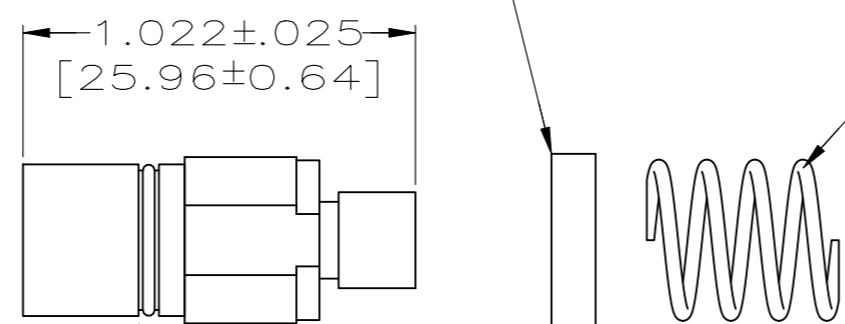

O-RING
MAT'L: BUNA-N (NITRILE)

1 2
DUMMY INSERT

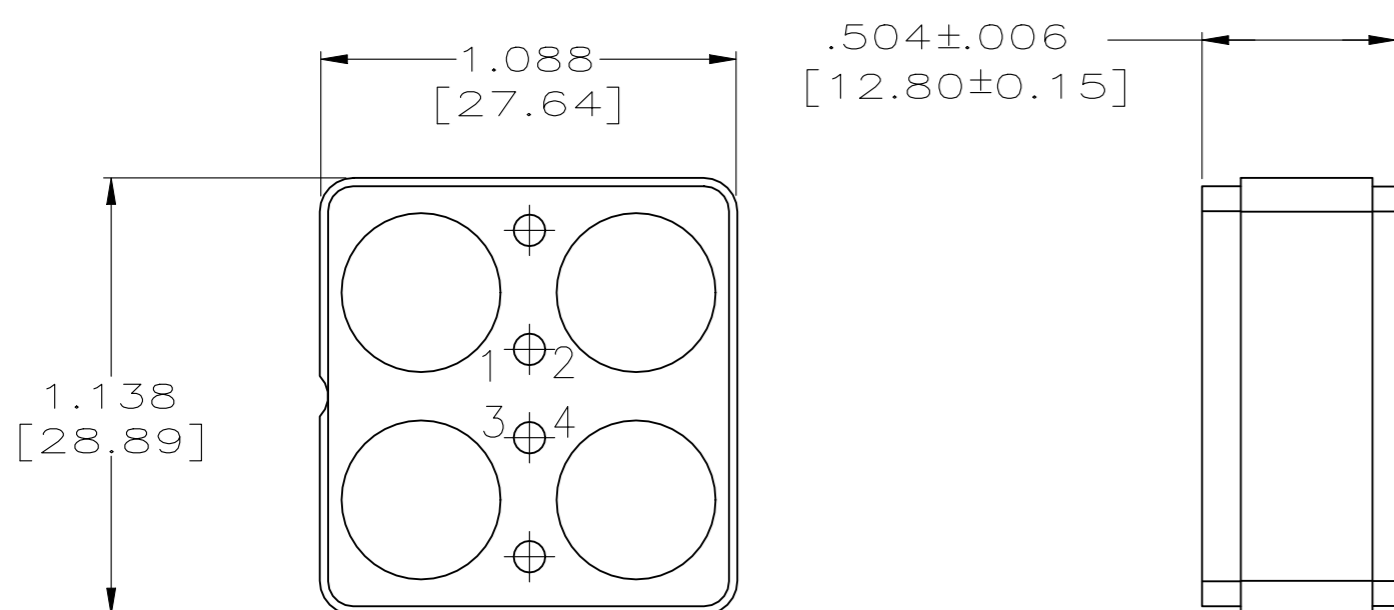

MATING FACE

INSERT
MAT'L: ALUMINUM ALLOY
FINISH: ELECTROLESS NICKEL

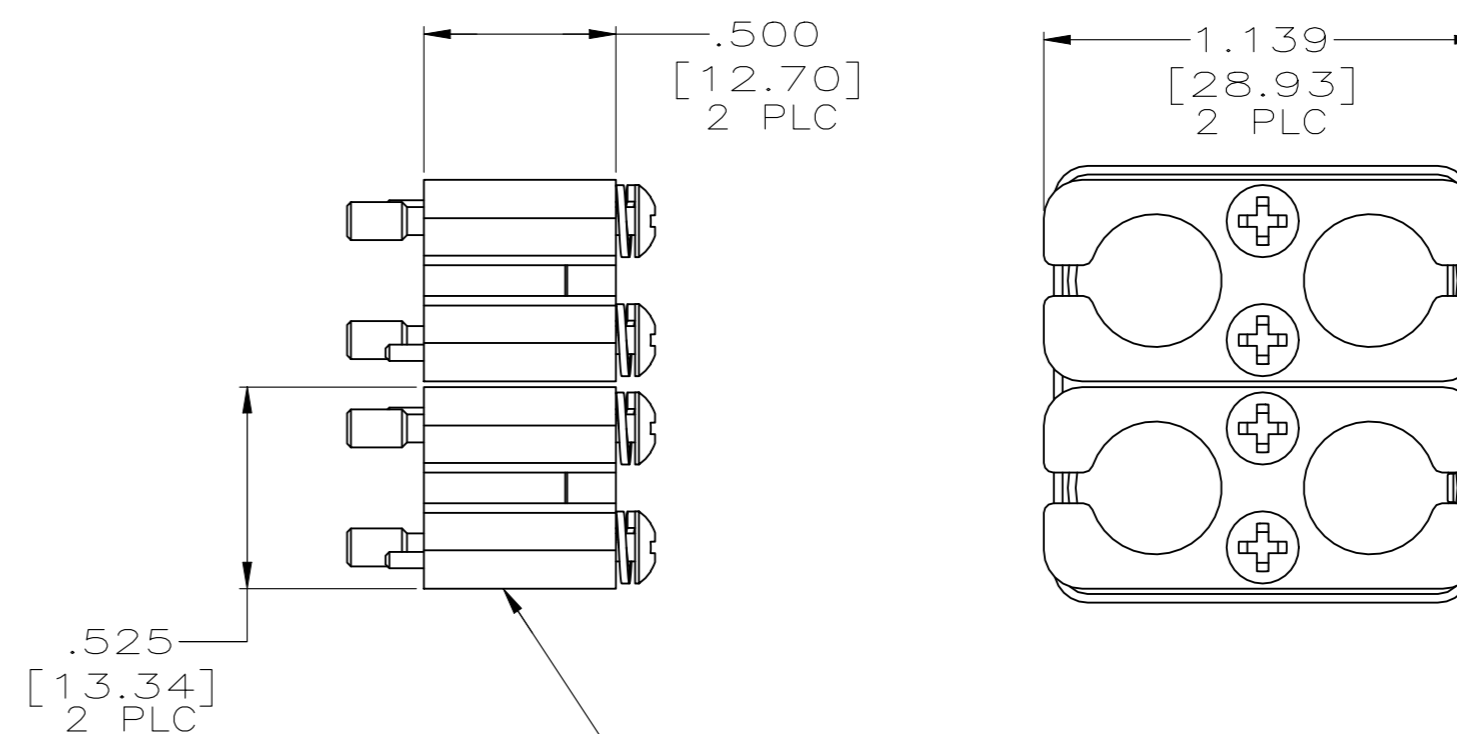

HOLD DOWN
MAT'L: ALUMINUM ALLOY
FINISH: ELECTROLESS NICKEL

- 1 ONE DUMMY INSERT, SPRING SPACE, O-RING AND COMPRESSION SPRING SUPPLIED TO PLUG UNUSED CAVITY. INSTALLATION AND LOCATION DETERMINED BY CUSTOMER.
- 2 FOUR DUMMY INSERTS, SPRING SPACERS, O-RING AND COMPRESSION SPRINGS SUPPLIED TO PLUG UNUSED CAVITIES. INSTALLATION TO BE DONE BY CUSTOMER.
- 3. CUSTOMER TO LUBRICATE O-RING WITH LUBRICANT COMPATIBLE WITH NITRILE RUBBER (RECOMMENDED DOW CORNING 55 O-RING LUBRICANT).
- 4 ELECTROLESS NICKEL PLATING OF INSERT, HOLD DOWN PLATE AND SPRING SPACER DOES NOT CONTAIN INTENTIONAL ADDITIONS OF LEAD AND CADMIUM PER DFE STANDARD 230-700.
- 5 PRELIMINARY - NOT RELEASED FOR PRODUCTION

2 4	5-1484662-2
2 4 5	1484662-3
2	1484662-2
1	1484662-1
REMARKS	PART NUMBER

THIS DRAWING IS A CONTROLLED DOCUMENT.		DWN	C.C.THOMAS	2-5-02			
DIMENSIONS: INCHES		CHK	S.GLATFELTER	2-5-02			
TOLERANCES UNLESS OTHERWISE SPECIFIED:		APVD	S.GLATFELTER	2-5-02	NAME		
0 PLC ± -		PRODUCT SPEC		INSERT KIT,RCPT,4 POSN., MINI EB,ARINC 600			
1 PLC ± -		APPLICATION SPEC		SIZE			
2 PLC ± -		-		CAGE CODE			
3 PLC ± .005 [0.13]		-		DRAWING NO			
4 PLC ± -		-		RESTRICTED TO			
ANGLES ± -		-		SCALE			
FINISH		-		SHEET			
-		-		1 OF 1			
-		-		REV			
-		-		F			