

PART NUMBER: 357-127

CUSTOMER PRINT

**NOTES:**

1. USE WITH CXA TOOL NO.: 359-21
2. ALL DIMENSIONS FOR REFERENCE ONLY

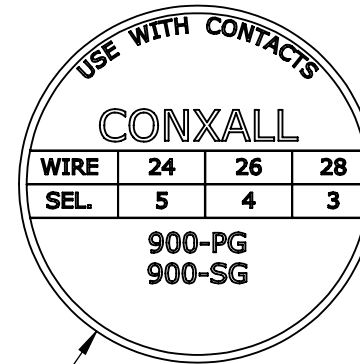
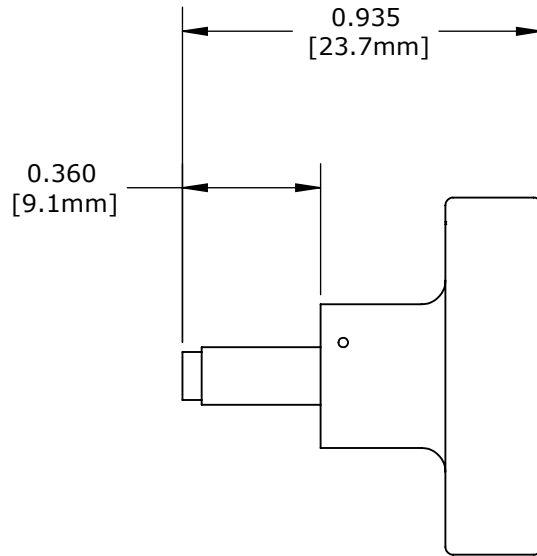

Ø 0.930 [23.6mm]

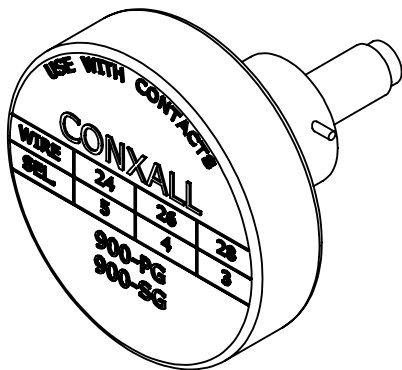

# PROPRIETARY

THIS DOCUMENT CONTAINS CONFIDENTIAL INFORMATION PROPRIETARY TO CONXALL CORPORATION. ANY REPRODUCTION, DISCLOSURE, OR USE OF THIS DOCUMENT / INFORMATION IS EXPRESSLY PROHIBITED UNLESS AUTHORIZED IN WRITING BY CONXALL CORPORATION.

DIMENSIONS IN BRACKET [ ] ARE METRIC.

|  |         |            |                                 |   |
|--|---------|------------|---------------------------------|---|
| B  | AN      | 06-15-17   | CREATED SHEET PER DOR 17-7819JS |   |
| REV.   | INIT.   | DATE       | DESCRIPTION                     |   |
| ALL INFORMATION ILLUSTRATED IS THE PROPERTY OF "CONXALL CORPORATION." UNAUTHORIZED DUPLICATION OR DISTRIBUTION OF THIS DOCUMENT IS PROHIBITED. |         |            | ORIG. DRAWN BY: PAK             | DATE: 06-10-11                              |
| ALL UNITS ARE IN FEET, INCHES, FRACTION OF INCHES AND DECIMALS.  |         |            | CHECKED BY:                     | <p>601 E. WILDWOOD VILLA PARK, IL 60181</p> |
|  |         |            | APPROVED BY:                    |   |
| SCALE  |         | SIZE       | SHEET                           |   |
| NTS  |         | A          | 1 OF 1                          |   |
| FILE:  | 357-127 | DIRECTORY: | SLW                             | PART NUMBER: 357-127                        |
|  |         |            |                                 | REV B                                       |

▷ = CRITICAL CHARACTERISTIC FLAG PER SPEC. XXXX