



GT Series

High performance gas tub coaxial protection for RF signals. Perform well in applications where a high voltage let-through is acceptable, yet good RF performance is essential.

Environmental

Operating Temperature	<95% non-condensing
Vibration	-55 C to + 85 C

Features

- High surge current capability
- High power configurations available
- ±60 Vdc configurations available (DT models)
- Weatherized

Standards and Certificates

- IEC 61000-4-5
- IEC 60529 IP67 (DT-NFF, DT-NFM)
- Bellcore #TA-NWT-00487 (DT-NFF, DT-NFM)
- Procedure 4.11, Wind Driven (120 MPH) (DT-NFF, DT-NFM)
- RoHS compliant (GT-NFF-AL, GT-NFM-AL, GTH-NFF-AL, GTH-NFM-AL, GT-TFF-AL, GT-TFM-AL, DT-NFF, DT-NFM)
- CE (GT-NFF-AL, GT-NFM-AL, GTH-NFF-AL, GTH-NFM-AL, GT-TFF-AL, GT-TFM-AL)

GT-NFF-AL

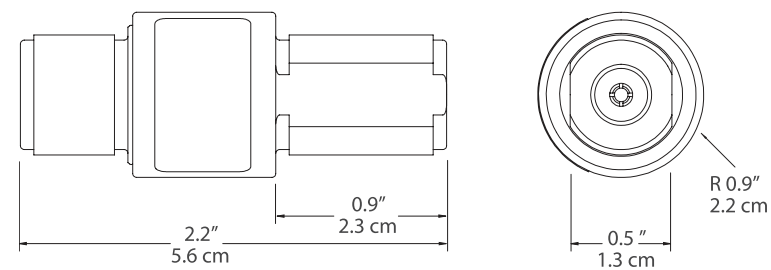

GT-NFSF-AL

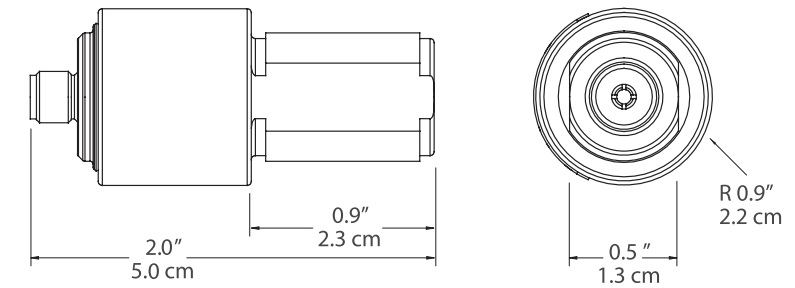

DT-NFM

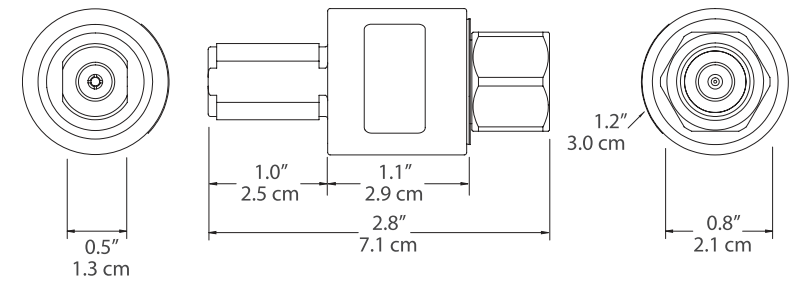

GT-TFF-AL

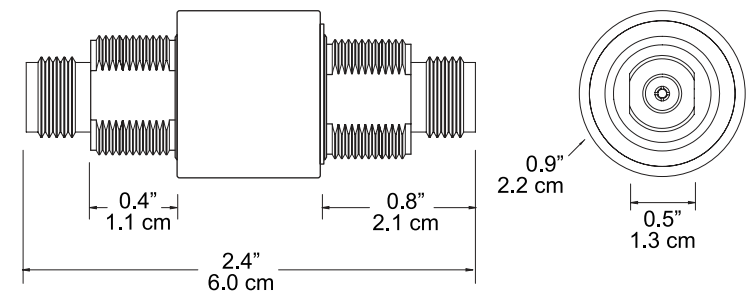

	Frequency Range	RF Power	Insertion Loss	VSWR		Max Continuous Operating Current	Max Surge Current	Surge Side Connector	Protected Side Connector	
GT-NFF-AL	DC to 7.0 GHz	90 W @ 30 MHz, 9 W @ 3 GHz	≤0.1 dB @ DC to 3.0 GHz, ≤0.25 dB @ 3.0 to 7.0 GHz	≤1.1:1 DC to 3.0 GHz, ≤1.2:1 3.0 to 4.0 GHz, ≤1.4:1 4.0 to 7.0 GHz		10 A	20 kA 8/20 μs per IEC 61000-4-5	N Female	N Female	GT-NFF-AL
GT-NFSF-AL	DC to 7.0 GHz	90 W @ 30 MHz, 9 W @ 3 GHz	≤0.1 dB @ DC to 3.0 GHz, ≤0.25 dB @ 3.0 to 7.0 GHz	≤1.1:1 DC to 3.0 GHz, ≤1.2:1 3.0 to 4.0 GHz, ≤1.4:1 4.0 to 7.0 GHz		10 A	20 kA 8/20 μs per IEC 61000-4-5	N Female	N Female	GT-NFSF-AL
GT-NFM-AL	DC to 7.0 GHz	90 W @ 30 MHz, 9 W @ 3 GHz	≤0.1 dB @ DC to 3.0 GHz, ≤0.25 dB @ 3.0 to 7.0 GHz	≤1.1:1 DC to 3.0 GHz, ≤1.2:1 3.0 to 4.0 GHz, ≤1.4:1 4.0 to 7.0 GHz		10 A	20 kA 8/20 μs per IEC 61000-4-5	N Female	N Male	GT-NFM-AL
GTH-NFF-AL	DC to 7.0 GHz	1 kW @ 30 MHz, 300 W @ 3 GHz	≤0.1 dB @ DC to 3.0 GHz, ≤0.25 dB @ 3.0 to 7.0 GHz	≤1.1:1 DC to 3.0 GHz, ≤1.2:1 3.0 to 4.0 GHz, ≤1.4:1 4.0 to 7.0 GHz		10 A	20 kA 8/20 μs per IEC 61000-4-5	N Female	N Female	GTH-NFF-AL
GTH-NFM-AL	DC to 7.0 GHz	1 kW @ 30 MHz, 300 W @ 3 GHz	≤0.1 dB @ DC to 3.0 GHz, ≤0.25 dB @ 3.0 to 7.0 GHz	≤1.1:1 DC to 3.0 GHz, ≤1.2:1 3.0 to 4.0 GHz, ≤1.4:1 4.0 to 7.0 GHz		10 A	20 kA 8/20 μs per IEC 61000-4-5	N Female	N Male	GTH-NFM-AL
GT-TFF-AL	DC to 7.0 GHz	1 kW @ 30 MHz, 300 W @ 3 GHz	≤0.1 dB @ DC to 3.0 GHz, ≤0.25 dB @ 3.0 to 5.0 GHz, ≤0.5 dB @ 5.0 to 7.0 GHz	≤1.1:1 DC to 2.0 GHz, ≤1.2:1 2.0 to 3.0 GHz, ≤1.4:1 3.0 to 7.0 GHz		10 A	20 kA 8/20 μs per IEC 61000-4-5	TNC Female	TNC Female	GT-TFF-AL
GT-TFM-AL	DC to 7.0 GHz	1 kW @ 30 MHz, 300 W @ 3 GHz	≤0.1 dB @ DC to 3.0 GHz, ≤0.25 dB @ 3.0 to 5.0 GHz, ≤0.5 dB @ 5.0 to 7.0 GHz	≤1.1:1 DC to 2.0 GHz, ≤1.2:1 2.0 to 3.0 GHz, ≤1.4:1 3.0 to 7.0 GHz		10 A	20 kA 8/20 μs per IEC 61000-4-5	TNC Female	TNC Male	GT-TFM-AL
DT-NFF	DC to 3.0 GHz	40 W @ 30 MHz	≤0.1 dB @ DC to 1.0 GHz, ≤0.25 dB @ 1.0 to 3.0 GHz	≤1.1:1 DC to 1.0 GHz		10 A	4 kA 8/20 μs per IEC 61000-4-5	N Female	N Female	DT-NFF
DT-NFM	DC to 3.0 GHz	40 W @ 30 MHz	≤0.1 dB @ DC to 1.0 GHz, ≤0.25 dB @ 1.0 to 3.0 GHz	≤1.1:1 DC to 1.0 GHz, ≤1.15:1 DC to 3.0 GHz		10 A	4 kA 8/20 μs per IEC 61000-4-5	N Female	N Male	DT-NFM