

Features

- Digital Temperature Compensation

STANDARD SPECIFICATIONS	
PARAMETERS	MAX (Unless otherwise noted)
Frequency Range (MHz)	8.000 ~ 40.000
Temperature Range	
Operating (T _{OPR})	See table below
Storage (T _{STG})	-40°C ~ +85°C
Supply Voltage (V _{DD}) (±5%)	+3.0V±5%
Input Current (I _{DD})	2.0 mA
Initial Frequency Tolerance @ 25°C (after reflow) (T5CV: V _c = 1.65V) ¹	±2.0 PPM
Frequency Stability	
Over Temperature Range	See table below
Over Supply Voltage Change (3.0V±5%)	±0.2 PPM
Over Load Change [10kΩ//10pF]±10%	±0.2 PPM
Output Voltage Level	0.8V _{p-p} min
Output Load	[10kΩ//10pF]±10%
Pullability (V _c = 1.65V ±1.0V) ¹	±3 ~ ±20 PPM min
Aging per year	±1.0 PPM
Startup Time (T _s)	2.0 mS Max
Phase Noise @ 1kHz offset	-130 dBc/Hz Typical
Reflow Soldering Temp	260°C / 10 Seconds x 2
Moisture Sensitivity Level (MSL)	1
Termination Finish	Au over Ni
Lead-Free	Yes
RoHS/REACH Compliant	Yes

DIMENSIONS / MECHANICAL SPECIFICATIONS	
<p>Top View</p>	<p>1.5 Max</p>
<p>Bottom View</p>	
<p>Recommended Solder Pad Layout</p> <p>Dimensions in mm</p>	
<p>Pin Connections</p> <p>#1 V_c #3 Output #2 GND #4 V_{DD}</p>	

*Dimensional drawing is for reference to critical specifications defined by size measurements. Certain non-critical visual attributes, such as side

Available Options by Stability & Operating Temp				
Operating Temperature	±1 PPM	±1.5 PPM	±2 PPM	±2.5 PPM
-30 ~+85°C	O	O	O	O
-40 ~+85°C	X	O	O	O

Key: O=Available, X=Not Available

¹For proper operation, a control voltage (V_c) must be applied to pin 1 of VCTCXO's. All specifications subject to change without notice.

FT5CV

(Former FOX914E)

5.0mm x 3.2mm

CSW VCTCXO



TAPE SPECIFICATIONS (mm)							REEL SPECIFICATIONS (mm)						
A	B	C	D	E	F	REEL QTY	G	H	I	J	K	L	M
ø1.5	4.0	8.0	5.5	12.0	1.7	-T1 = 1,000	2.0	ø13	ø21	ø80	ø180	13.5	2.0

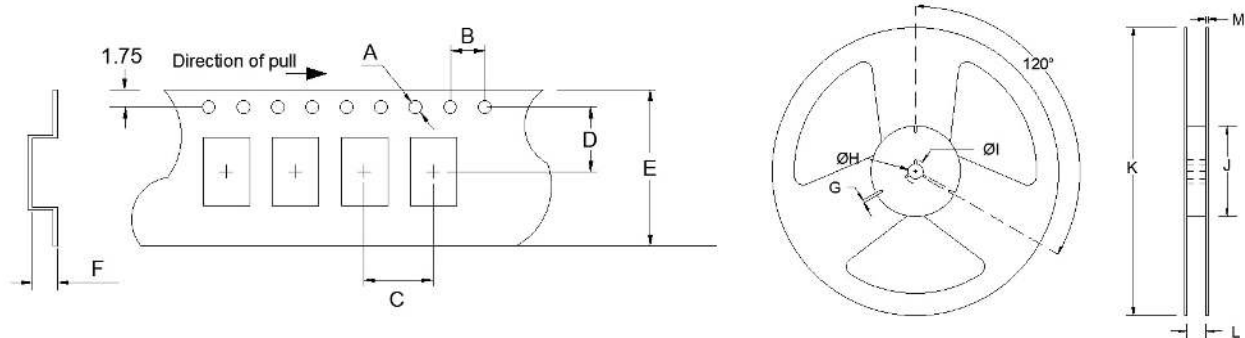

Available Options & Part Identification for VCTCXO Model T5CV¹

Sample PN: **FT5CVDPK25.0-T1**

F	T5CV	D	P	K	25.0	-T1
Fox	Model Number T5CV = VCTCXO	Voltage D = +3.0V±5%	Stability T = ±1.0 PPM S = ±1.5 PPM R = ±2.0 PPM P = ±2.5 PPM	Operating Temperature K = -30 to +85°C M = -40 to +85°C	Frequency (MHz)	Values Added Options Blank = Bulk T1 = 1,000 pcs

¹ Not all frequencies in the frequency range, or every combination of stability, temp range, and voltage available. See stabilities/operating temp table.

Reliability Test Conditions

Please contact Abracon Quality Assurance department